

FOR LEASE

7602 Waters Avenue,
Between Eisenhower Drive & Mall Blvd.



Suite 100 & Suite 2 -4524 RSF

**Rent: \$20.50 RSF(MG) includes Operating Expenses;
3% Annual Increases; 3 Year
Term Minimum;
Tenant pays for its Utilities
and other Services.**

No Auto Repair Uses Allowed



Call: Gary Mankin, **CCIM**,
Re/Max Savannah
(p) +1 912 355 7711 (p) +1 912 650 2720
(m) +1 404 590 3076 gwmankin@gmail.com



This Information is provided for advertising and general information purposes only and is subject to errors, omissions, prior sales/leases and withdrawal without notice. NO REPRESENTATION OR WARRANTY IS GIVEN, EXPRESS OR IMPLIED, AS TO THE ACCURACY OF THE INFORMATION contained herein. You assume without limitation all risk, all liability for loss and damages resulting from reliance on this information. **Tenant/Buyer has the responsibility to verify all information contained herein.**

FOR LEASE

7602 Waters Avenue,
2424 RSF & 2100 RSF (between Eisenhower Drive & Mall Blvd.)

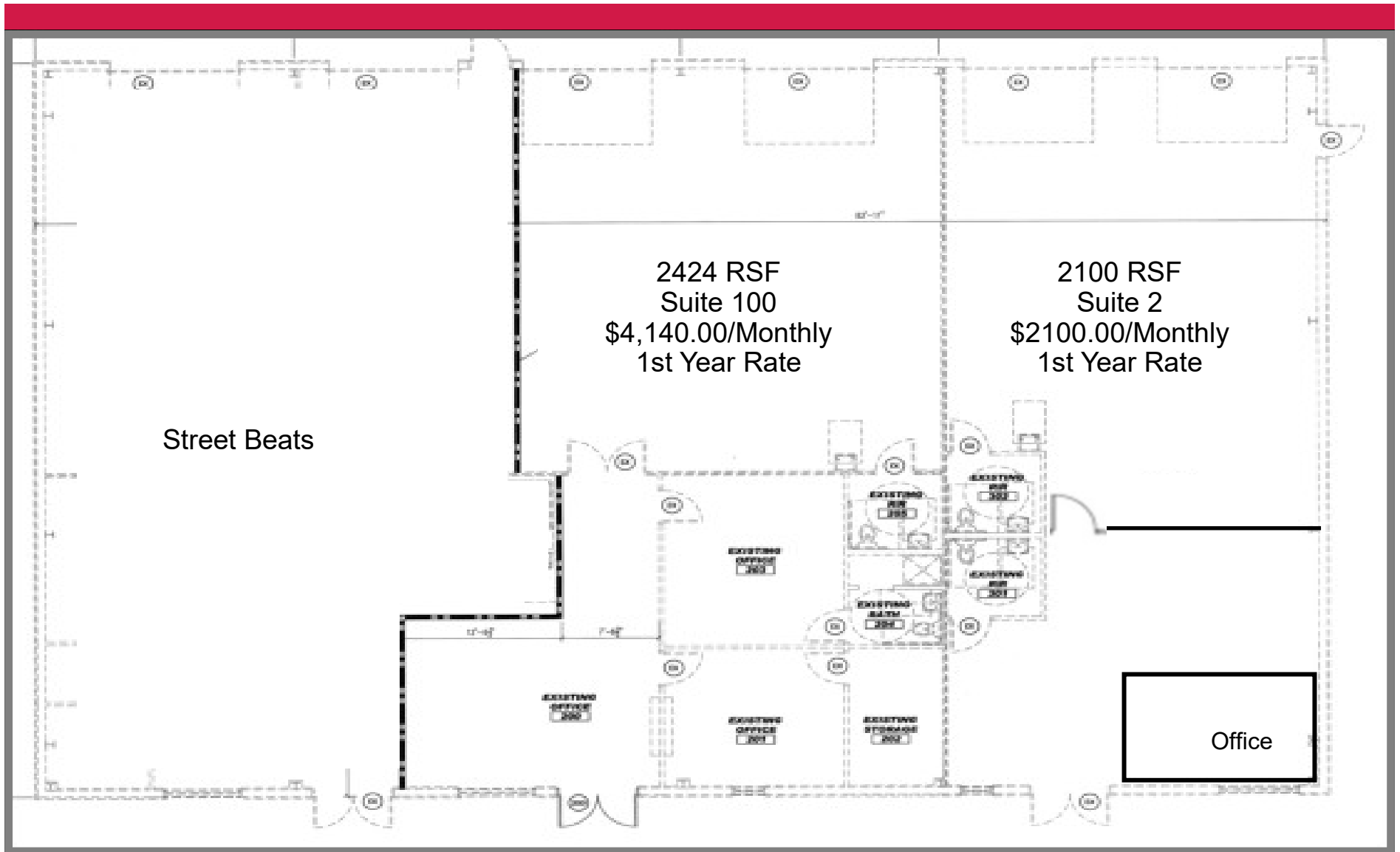

This Information is provided for advertising and general information purposes only and is subject to errors, omissions, prior sales/leases and withdrawal without notice. NO REPRESENTATION OR WARRANTY IS GIVEN, EXPRESS OR IMPLIED, AS TO THE ACCURACY OF THE INFORMATION contained herein. You assume without limitation all risk, all liability for loss and damages resulting from reliance on this information. **Tenant/Buyer has the responsibility to verify all information contained herein.**