

Las Vegas Industrial Park

4842-4856 Judson Ave. | Las Vegas, NV 89115

Industrial for Lease

±5,629-11,258 SF



Leasing Information:
702.221.8226

Lincoln

Craig Summers

#NRE:S.0077796

Vice President
(702) 487-9811

Craig.Summers@lpc.com

Mel Koich

#NRE:BS.0040505

Senior Vice President
(702) 561-8787

Mel.Koich@lpc.com

4755 Dean Martin Drive
Las Vegas, NV 89013

www.lpc.com

Las Vegas Industrial Park

4842-4856 Judson Ave. | Las Vegas, NV 89115

Industrial for Lease

±5,629-11,258 SF



Features:

- 24 FT. warehouse clearance
- Fully sprinklered property
- Grade level loading
- All units have mezzanine storage
- 2.21/1,000 parking ratio
- Concrete tilt up construction
- Built in 2007
- Unincorporated Clark County
- Power 250A 120/208 V 3P 4W
- 250A 277 / 480 V 3P 4W
- Asking Rate \$1.30/PSF MG

Craig Summers
(702) 487-9811
Craig.Summers@lpc.com

Mel Koich
(702) 561-8787
Mel.Koich@lpc.com

Lincoln

Las Vegas Industrial Park

4842-4856 Judson Ave. | Las Vegas, NV 89115

Industrial for Lease

±5,629-11,258 SF

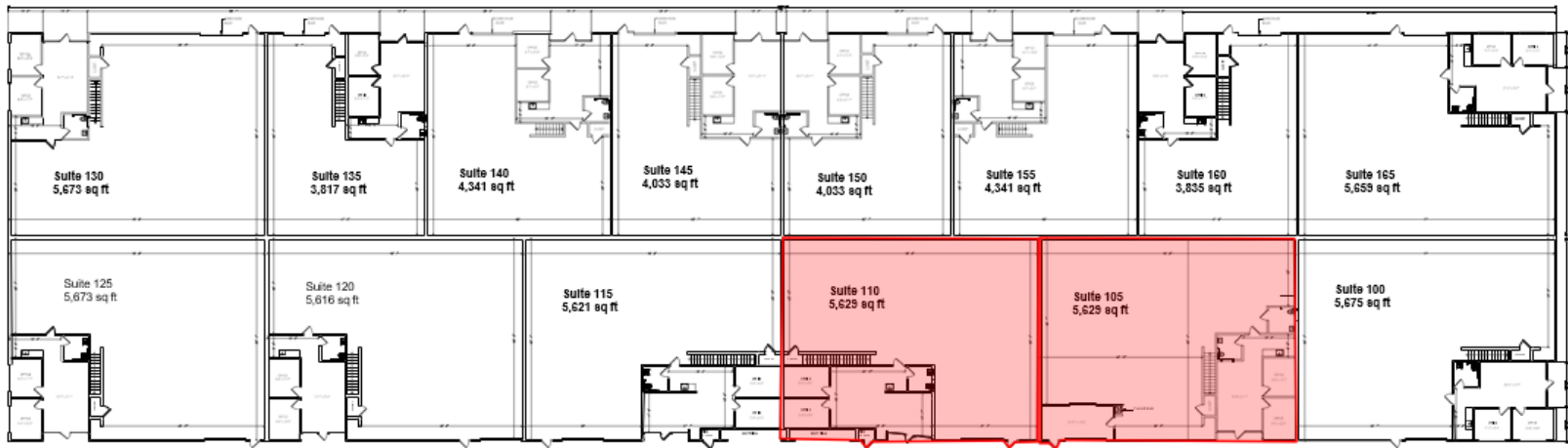

Judson Ave. ↓

Suite #	Total SF	Office SF	Warehouse SF	Mezzanine SF	Clearance Height	Grade Door	Rate
105	±5,629	±730	±4,169	±730	24 FT	1	\$1.30 MG
110	±5,629	±730	±4,169	±730	24 FT	1	\$1.30 MG

Craig Summers
 (702) 487-9811
 Craig.Summers@lpc.com

Mel Koich
 (702) 561-8787
 Mel.Koich@lpc.com

Lincoln

Las Vegas Industrial Park

4842-4856 Judson Ave. | Las Vegas, NV 89115

Industrial for Lease

±5,629-11,258 SF

Location Overview



Craig Summers
(702) 487-9811
Craig.Summers@lpc.com

Mel Koich
(702) 561-8787
Mel.Koich@lpc.com

Lincoln