



SterlingCMG
COMMERCIAL MANAGEMENT

Start-Up Space Available at MonTEC

1121 East Broadway Street
Missoula, Montana

BioScience and Tech-Focused Business Incubator

Exclusively Managed by:

Jessica Morina

Jessica@SterlingCMG.com

406.290.9800 Ext 704

Opportunity Overview

Sterling Commercial Management Group is proud to present 1121 East Broadway Street, home to Montana Technology Enterprise Center, also known as “MonTEC.”

“MonTEC is a high-growth, technology-focused business incubator that is building a community of high-growth enterprises on the Clark Fork River by connecting people and linking them with support services to help get their venture on the right track.”

With multiple spaces available, including lab and office space, this unique offering also features secure access, a shared break room/kitchen, and large conference rooms for your diverse needs.

This is a BioScience and Tech-Focused Business Incubator space; proposed tenants must meet eligibility criteria. Please inquire for further details.



Address	1121 East Broadway Street
Property Type	Office/Lab
List Rate	Inquire for further details
Estimated NNN	Inquire for further details

[!\[\]\(17413706fd4997a1a4bdf85c6864eee1_img.jpg\) See Listing for Current Availability.](#)

Interactive Links

 Link to Listing

 Street View

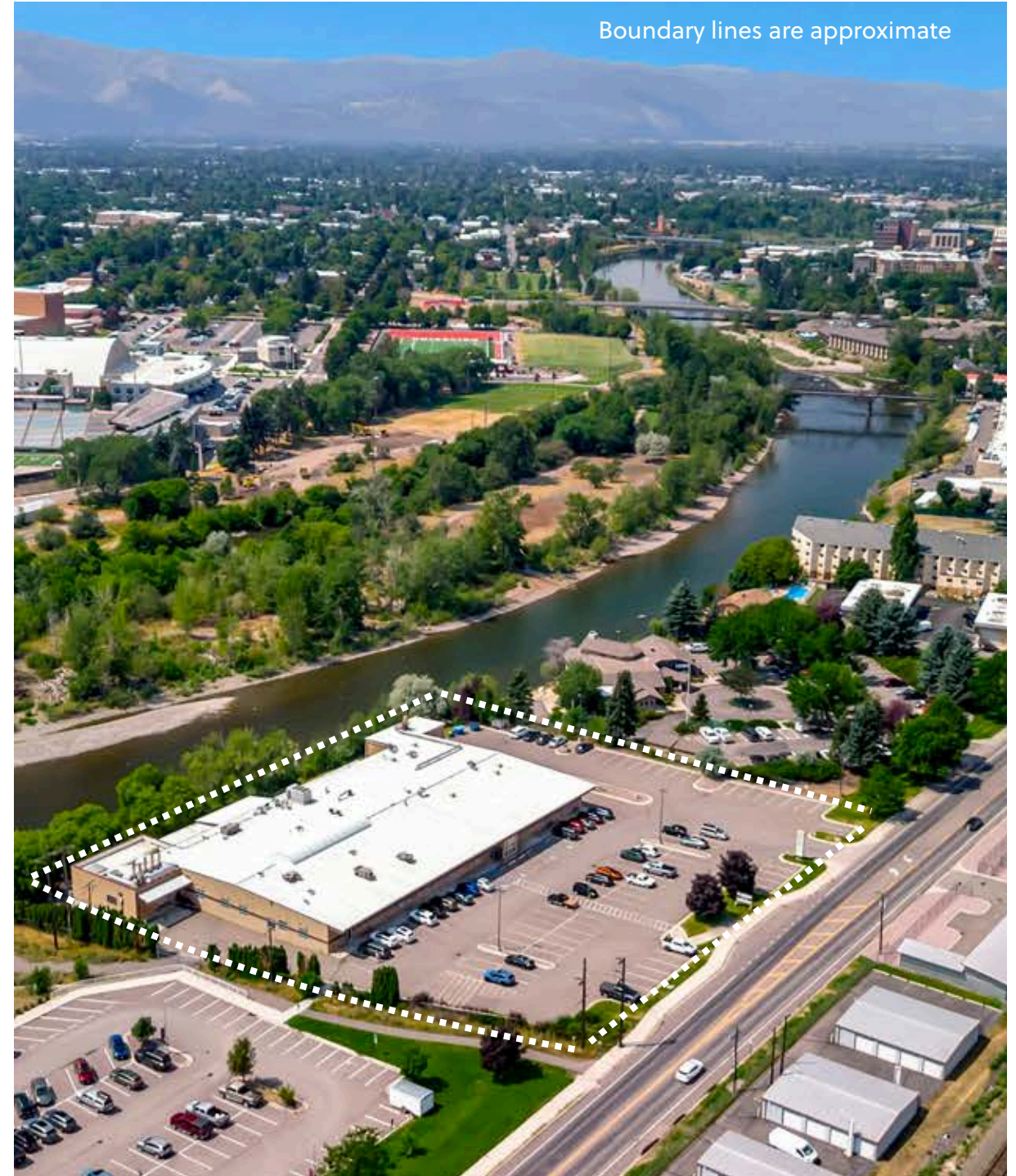

Interactive Links

Property Details

Address	1121 East Broadway Street
Property Type	Office/Lab
Geocode	04-2200-22-4-06-08-0000
Traffic Count	±6,831 (AADT 2023)
Year Built/Renovated	1982/2001
Parking	Ample parking in dedicated lot
Access	East Broadway Street
Amenities	Secured entrance, shared conference room, common break areas





Easily accessible location on East Broadway next to the Missoula College



Secure building with keycard access



MonTEC is a BioScience and Technology-focused business incubator making it the perfect place for start-ups



Dedicated parking lot



Multiple spaces available within the building

Tech-Incubator Spaces for Lease

“MonTEC is a high-growth, technology-focused business incubator that is building a community of high-growth enterprises on the Clark Fork River by connecting people and linking them with support services to help get their venture on the right track.”



Boundary lines are approximate

Location Overview

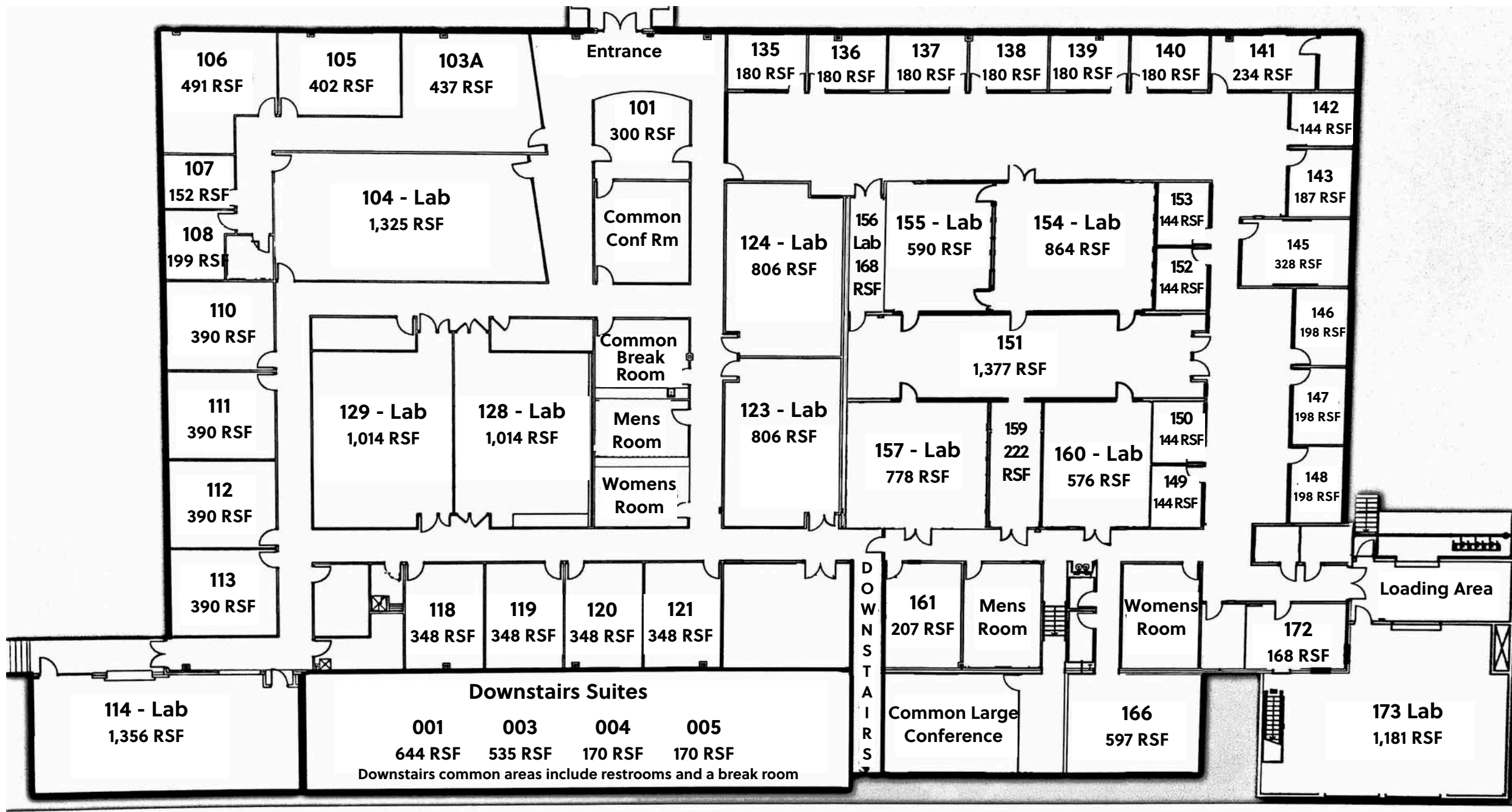

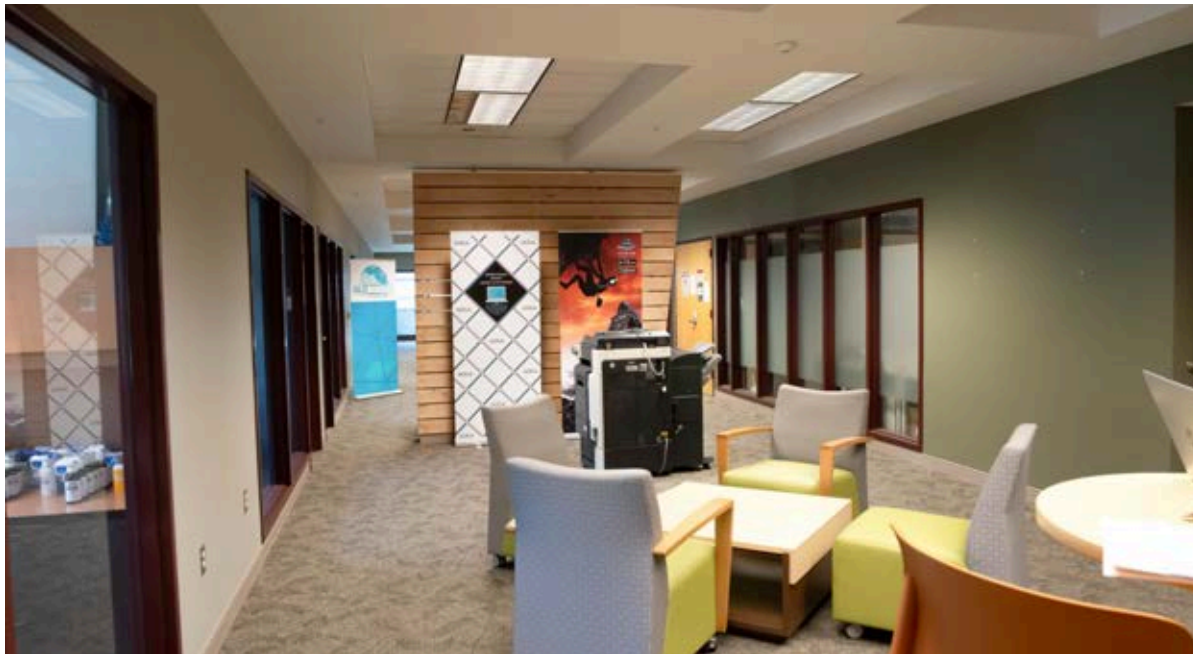

Interior Images



Images represent the general quality, finishes, and furnishings of office spaces within the building. For information on currently available suites, please contact the leasing team.

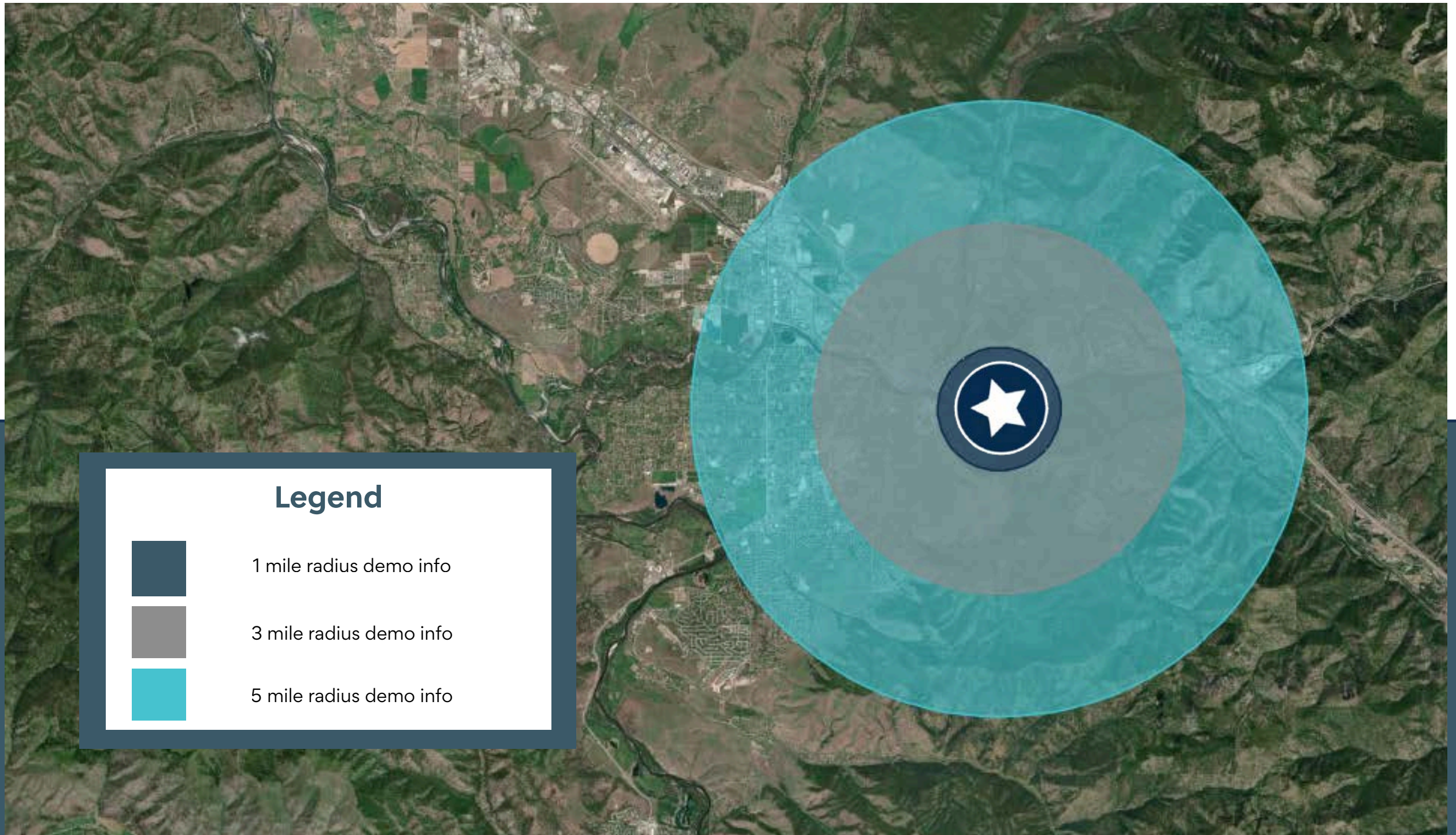

Legend



1 mile radius demo info



3 mile radius demo info



5 mile radius demo info

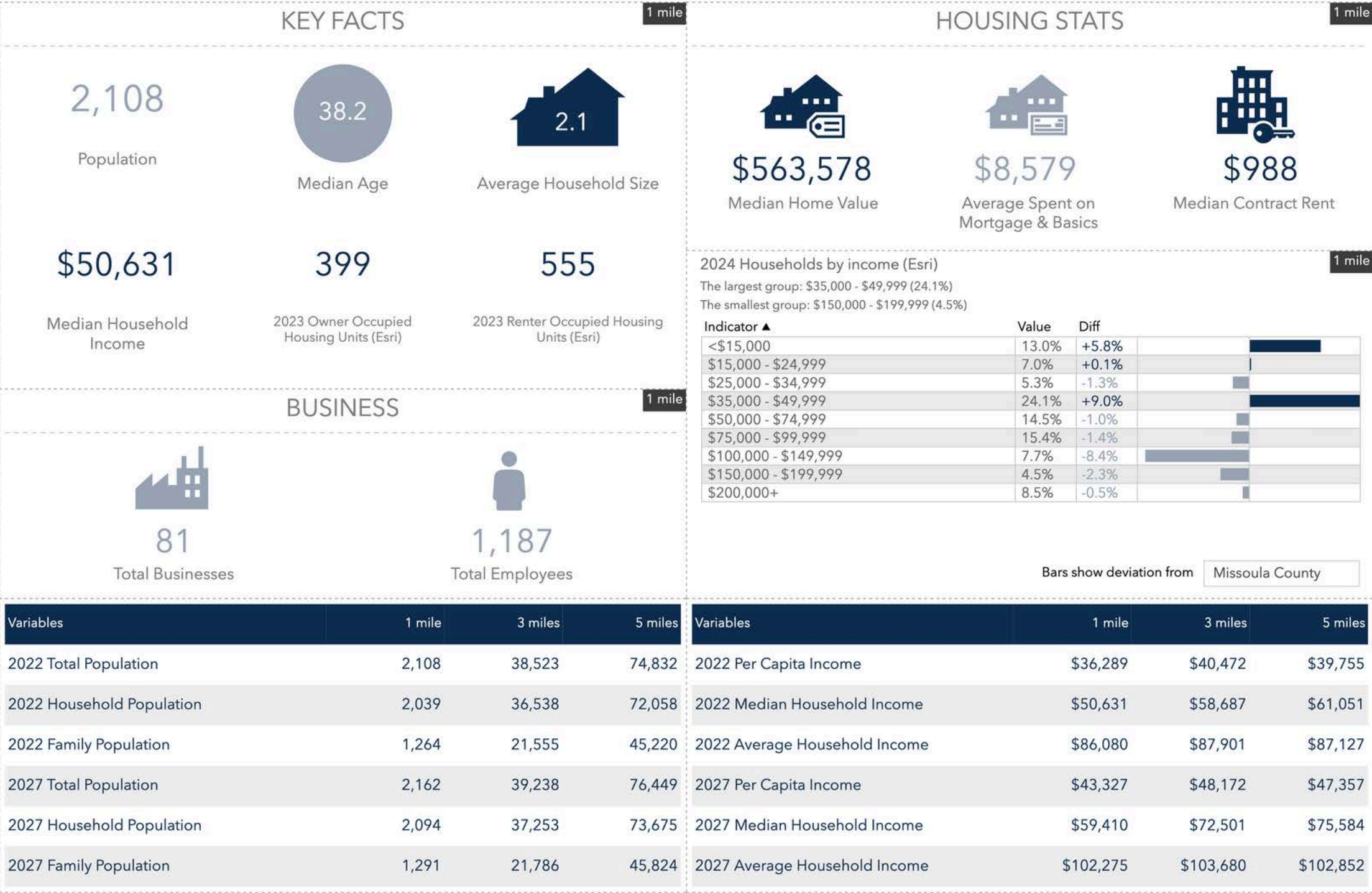

Missoula Air Service

Missoula International Airport offers direct flights to major cities on the west coast and midwest.



Missoula Access

Missoula offers strategic proximity to major cities in the Pacific Northwest, Midwest, and Canada.

Missoula is within a day's truck drive of cities across the Northwest, including major Canadian metros. Easy access to Interstate 90 and US Highway 93 means Montana's major cities including Billings, Bozeman, Butte, Helena, Great Falls, Kalispell and Missoula are within a half day's drive.

Access to rail and the Missoula International Airport round out the city's access to a multimodal transportation network.

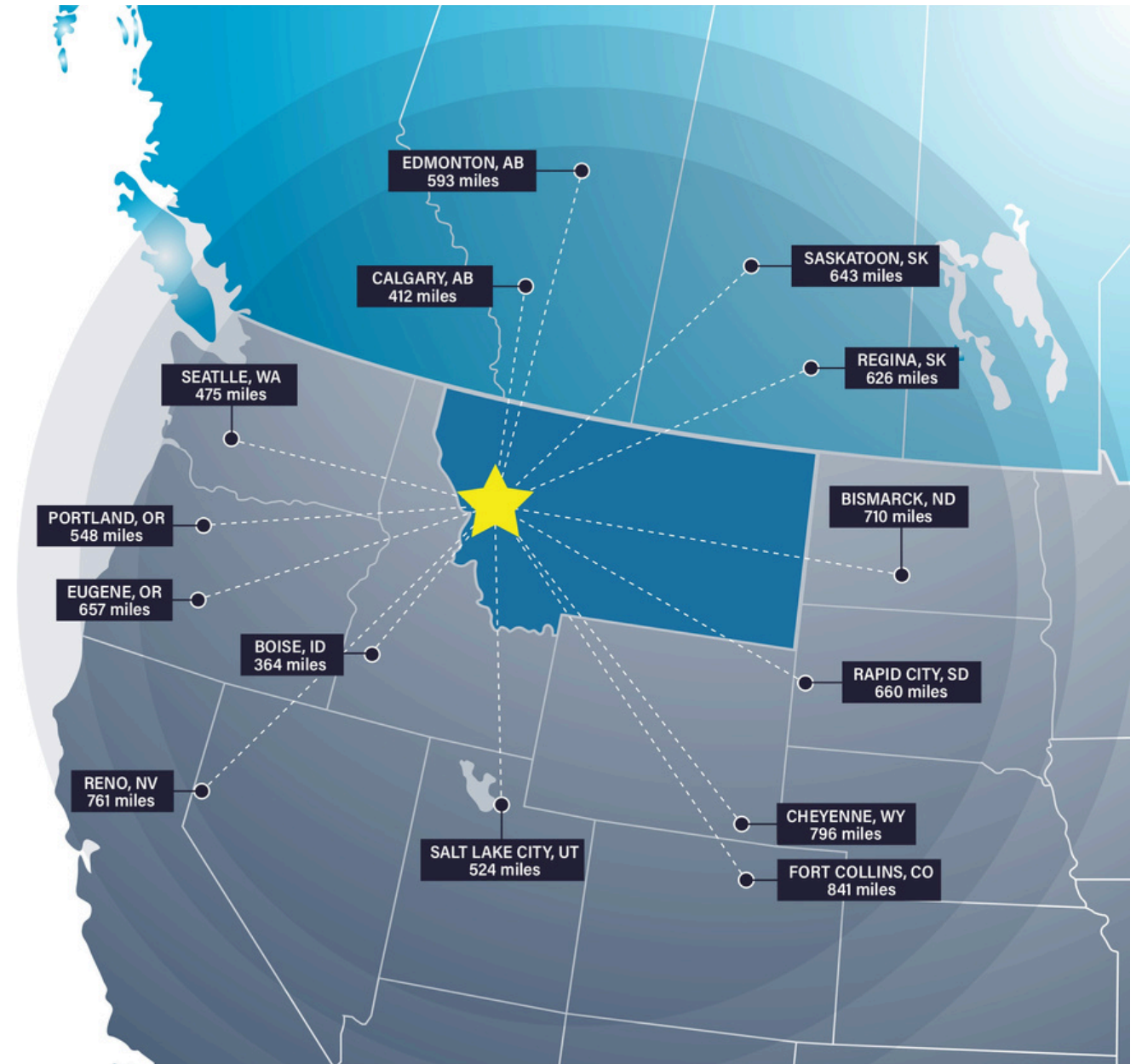

Top Employers

University of Montana

3,000+ employees

Missoula County Public Schools

3,000+ employees

St. Patrick Hospital

1000+ employees

Montana Rail Link

1,000+r employees

Community Medical Center

1000+ employees

Missoula County

500+ employees

City of Missoula

500+ employees

Allegiance Benefits

500+ employees

Noteworthy

Submittable



workiva



Pathlabs



Cognizant

PatientOne



Source: Montana Department of Labor & Industry | lmi.mt.gov & Zippia | zippia.com



ACCOLADES

#1 Most Fun City for Young People

Smart Assets

#2 Best Places to Live in the American West

Sunset Magazine

Top 10 Medium Cities for the Arts

2023 Southern Methodist University

#4 Best Small Cities in America to Start a Business

Verizon Wireless

#10 Best Small Metros to Launch a Business

CNN Money

#6 Best Cities for Fishing

Rent.com

#1 City for Yoga

Apartment Guide

Top 10 Cities for Beer Drinkers

2015, 2016, 2017, 2019, 2022

International Public Library of 2022

The International Federation of Library Associations World Congress

PEOPLE

12.5% Population Growth - 2012-2022

Missoula ranks among highest net migration cities in US

Median Age 34 Years Old

The median age in the US is 39

58.8% Degreed

Associates degree or higher, 18.7% have a graduate level degree

24.7% High Income Households

Incomes over \$100,000 a year

53.4% Renters

Top 5 Occupations

Office & Admin Support, Food Service, Sales, Transportation

ACCESS

16 Minutes

Average Commute Time

15.6% Multimodal Commuters

Walk or bike to work

81 Hours Saved

81 hours saved in commute yearly over national average

14 Non-Stop Air Destinations

With a recently upgraded terminal at the Missoula International Airport

62 Miles

Of bike lanes with a Gold rating from the League of American Bicyclists

12 Routes

Provided by a bus network across the City of Missoula

11 EV Charge Stations

Available to the public across Missoula

ECONOMY

Designated as a Tech Hub

Western Montana was one of 30 applicants out of 200 designated as a Tech Hub by the federal government and now eligible for millions of dollars in funding for research in smart, autonomous and remote sensing technologies.

Diversity Among Top Employers

University of Montana (education), Providence Health Services/St. Patrick's Hospital (medical), Community Medical Center (medical), Montana Rail Link (transportation), Neptune Aviation (aviation services)

High Labor Participation

Missoula consistently offers one of the highest labor force participation rates in the country.

Expanding Industries

Missoula has seen major growth in construction, professional, scientific, and manufacturing businesses over the past decade.

Growing Number of Technology Companies

Cognizant, onX, Submittable, and Lumenad are some leading tech firms in Missoula



Leasing Contact



JESSICA MORINA, CAM
Property Management Director

406-290-9800 x704
Jessica@sterlingcmg.com

Disclaimer

CONFIDENTIALITY & DISCLAIMER All materials and information received or derived from SterlingCRE Advisors its directors, officers, agents, advisors, affiliates, and/or any third party sources are provided without representation or warranty as to completeness, veracity, or accuracy, condition of the property, compliance or lack of compliance with applicable governmental requirements, developability or suitability, the financial performance of the property, the projected financial performance of the property for any party's intended use or any and all other matters. Neither SterlingCRE Advisors its directors, officers, agents, advisors, or affiliates makes any representation or warranty, express or implied, as to accuracy or completeness of any materials or information provided, derived, or received. Materials and information from any source, whether written or verbal, that may be furnished for review are not a substitute for a party's active conduct of its own due diligence to determine these and other matters of significance to such party. SterlingCRE Advisors will not investigate or verify any such matters or conduct due diligence for a party unless otherwise agreed in writing. EACH PARTY SHALL CONDUCT ITS OWN INDEPENDENT INVESTIGATION AND DUE DILIGENCE. Any party contemplating or under contract or in escrow for a transaction is urged to verify all information and to conduct their own inspections and investigations including through appropriate third-party independent professionals selected by such party. All financial data should be verified by the party including by obtaining and reading applicable documents and reports and consulting appropriate independent professionals. SterlingCRE Advisors makes no warranties and/or representations regarding the veracity, completeness, or relevance of any financial data or assumptions. SterlingCRE Advisors does not serve as a financial advisor to any party regarding any proposed transaction. All data and assumptions regarding financial performance, including that used for financial modeling purposes, may differ from actual data or performance. Any estimates of market rents and/or projected rents that may be provided to a party do not necessarily mean that rents can be established at or increased to that level. Parties must evaluate any applicable contractual and governmental limitations as well as market conditions, vacancy factors, and other issues in order to determine rents from or for the property. Legal questions should be discussed by the party with an attorney. Tax questions should be discussed by the party with a certified public accountant or tax attorney. Title questions should be discussed by the party with a title officer or attorney. Questions regarding the condition of the property and whether the property complies with applicable governmental requirements should be discussed by the party with appropriate engineers, architects, contractors, other consultants, and governmental agencies. All properties and services are marketed by SterlingCRE Advisors in compliance with all applicable fair housing and equal opportunity laws.