

1250 Pittsford-Victor Road

Pittsford, NY



A REPUTATION FOR RESULTS



Scan for more details about
1250 Pittsford-Victor Road!

1250 Pittsford-Victor Road Pittsford, NY

1250 Pittsford-Victor Road is a two-building Class A business park located on Route 96 in Pittsford, New York. The property features spacious corporate suites, multi-story lobbies, quality interior finishes, abundant on-site parking and 24/7 property management.

1250 Pittsford-Victor Road's prominent location at Exit 28 of the Interstate 490 Expressway provides easy access to the New York State Thruway and downtown Rochester. Nearby retail conveniences include the Eastview Mall, Woodcliff Golf Club and the historic Bushnell's Basin shopping district.

Why Pittsford-Victor Road?

- Two Class A buildings on five acres, ranging from 38,300 to 52,500 SF
- Landscaped exterior
- Fine wood, marble and brass finishes
- Abundant on-site parking
- High-speed Internet service
- 24/7 property management and support



Site Plan

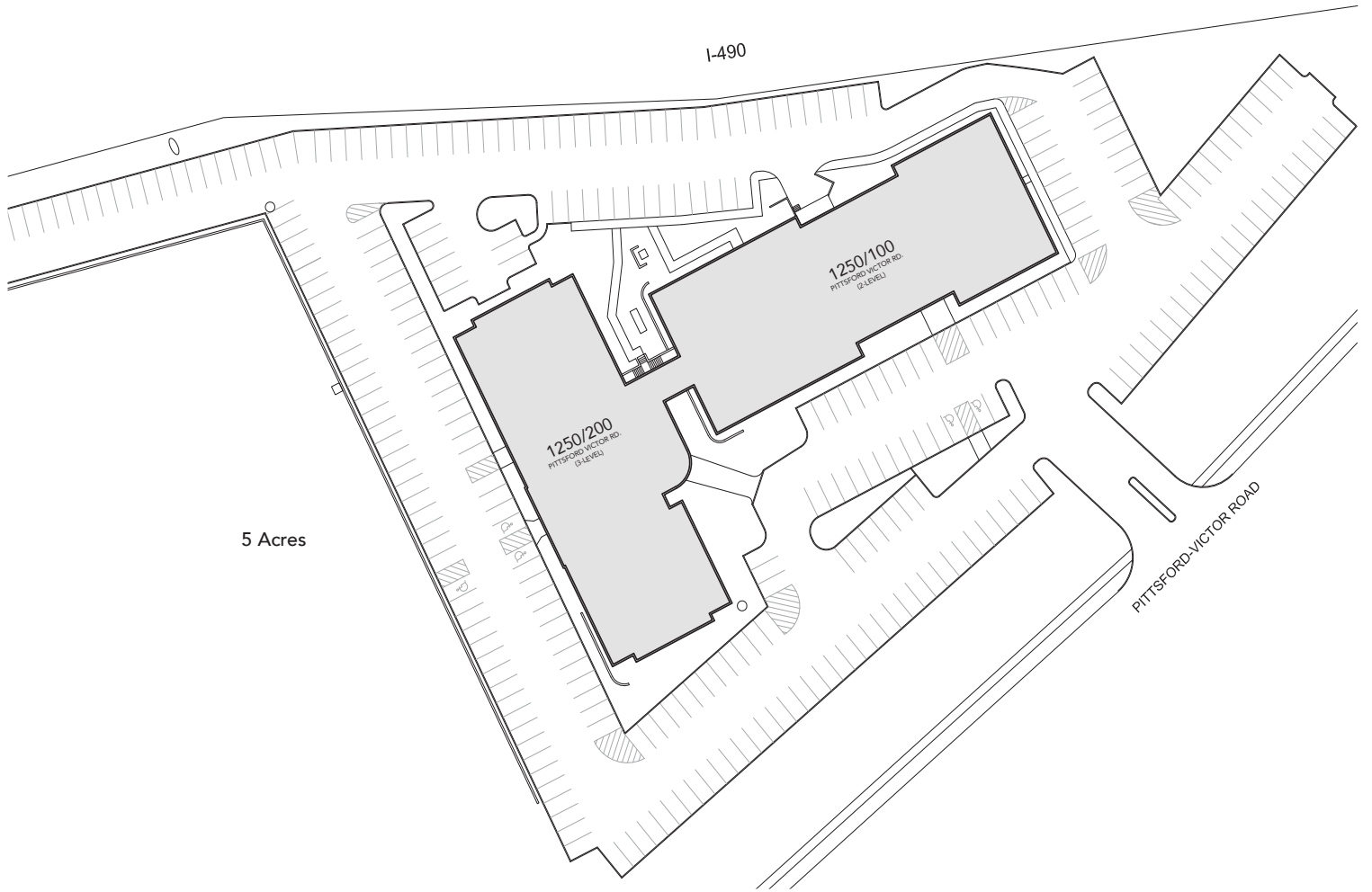

Location Highlights

On Route 96

Proximate to I-490 interchange

5 minutes to I-90 NYS Thruway

15 minutes to downtown Rochester

20 minutes to the Airport

2 minutes to Eastview Mall

3 minutes to Bushnell's Basin shopping district

Within walking distance to RTS Bus route

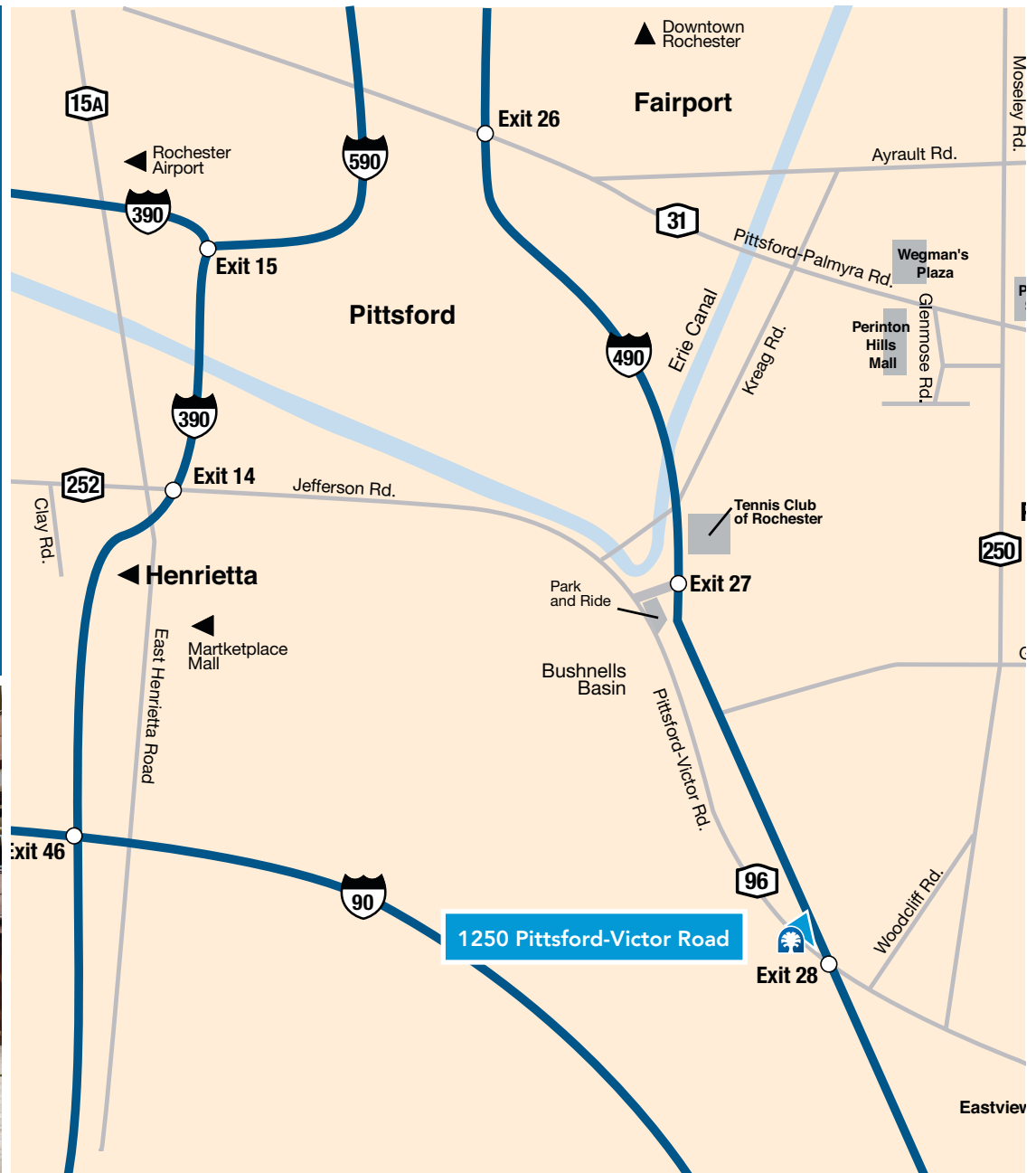

Impressive Class A office setting for image-conscious professionals



WillowBrook Office Park | 250 WillowBrook Office Park | Fairport, NY 14450 | 585.385.4430 | uniland.com