

# 15611

WEST 6TH AVENUE | GOLDEN, CO 80401  
UNINCORPORATED JEFFERSON COUNTY



South side facing Highway 6

## OWNER/USER INDUSTRIAL

**PRICE REDUCED** For Sale: ~~\$5,900,000~~ **\$5,600,000**  
For Lease: Inquire with Broker

15611 W. 6th Avenue, a.k.a. 655 McIntyre Street, offers the unique features of visibility to Highway 6, a high bay clear span warehouse, drive-in and dock high loading, fenced yard and ease of access to Highway 6, Highway 40 and I-70.

### PROPERTY DETAILS

Building SF	24,810 SF per County Record
Site Size	1.39 Acres
Clear Height	30' - 33'6"
Electrical	600 Amp 480 Volt 3 Phase
Loading	1 - 14' x 14' Drive-In 1 - 12' x 14' Drive-In 1 - 12' x 14' Dock High
Zoning	Jefferson County I-3
Traffic Counts	Approximately 80,000 vehicles per day on Hwy. 6

Offered Exclusively By:

**CHRIS BALL**

Broker  
303.332.6954  
chris@ballprop.com

# 15611

WEST 6TH AVENUE | UNINCORPORATED JEFFERSON COUNTY

## FIRST FLOOR

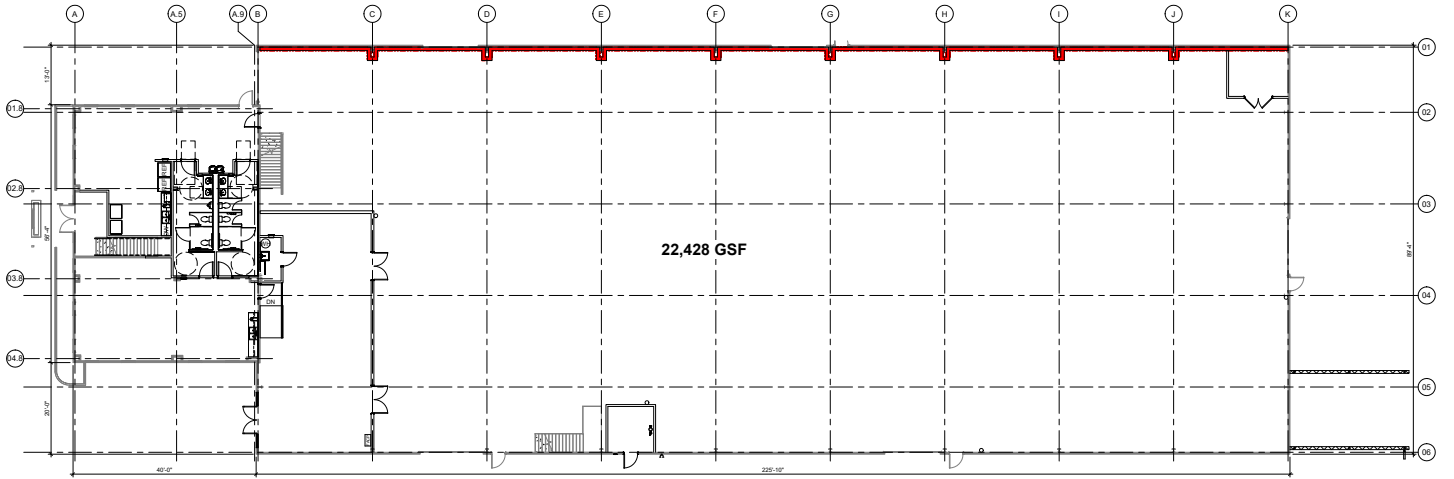

1 FIRST LEVEL FLOOR PLAN

SCALE: 1/4" = 1'-0"

## SECOND FLOOR

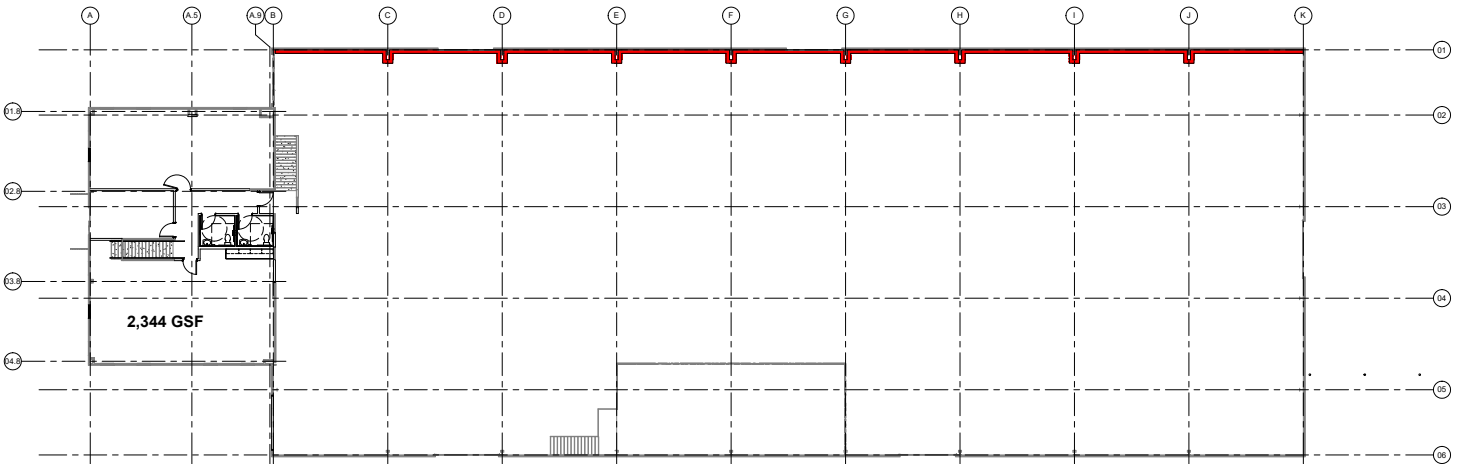

2 SECOND LEVEL FLOOR PLAN

SCALE: 1/4" = 1'-0"





# 15611 WEST 6TH AVENUE | GOLDEN, CO 80401

UNINCORPORATED JEFFERSON COUNTY

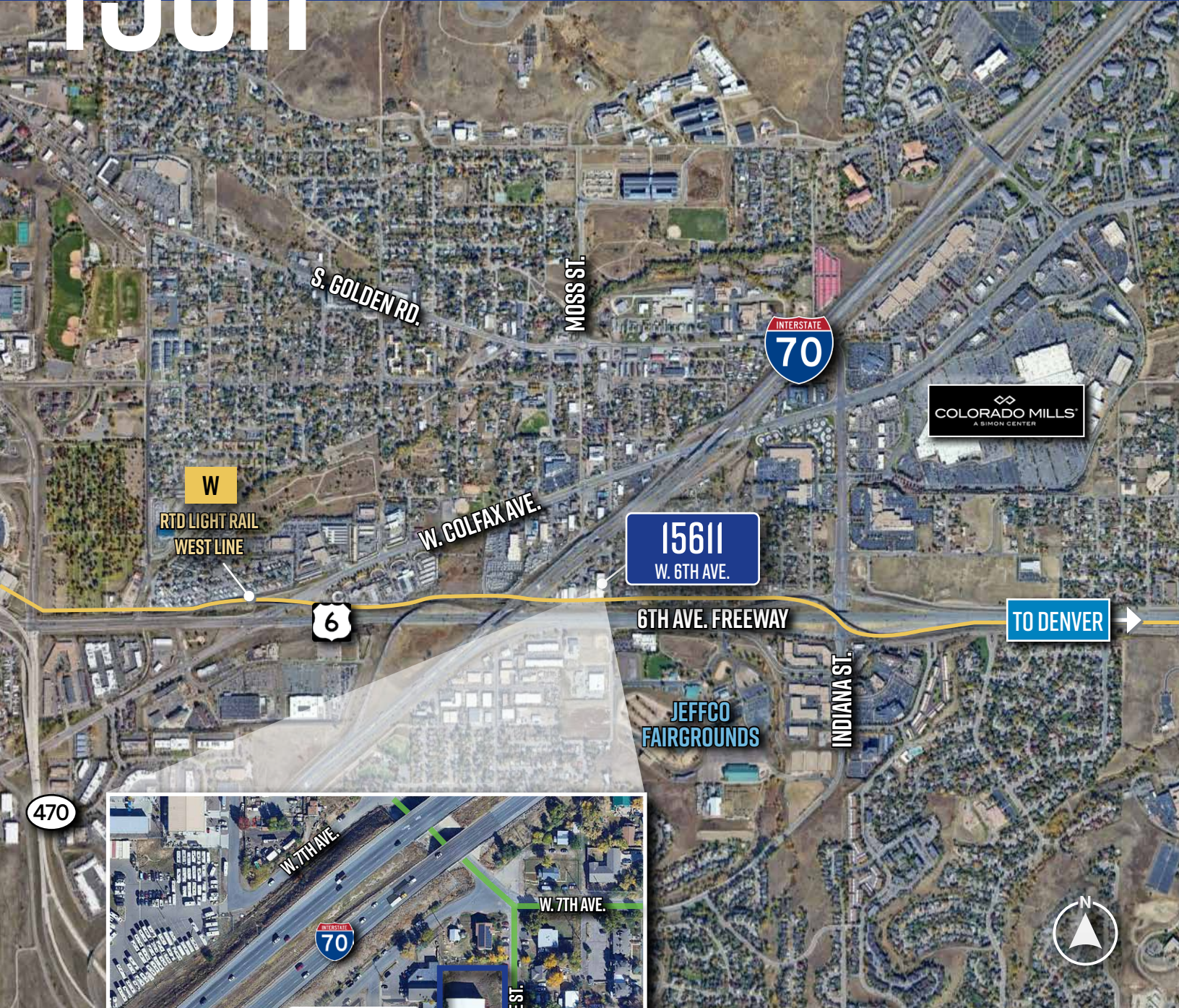

**W**  
RTD LIGHT RAIL  
WEST LINE

**15611**  
W. 6TH AVE.

**COLORADO MILLS**  
A SIMON CENTER

**TO DENVER** →

JEFFCO  
FAIRGROUNDS

470

W. 7TH AVE.

W. 7TH AVE.

MCINTYRE ST.

**15611**  
W. 6TH AVE.



## CONTACT



**CHRIS BALL**  
Broker  
303.332.6954  
chris@ballprop.com

The information contained herein has been obtained through sources deemed reliable but cannot be guaranteed as to its accuracy. Any information of special interest should be obtained through independent verification.