

PMF Real Estate Services is pleased to present:

**FOR LEASE**

# GREEN FIRS TOWNE CENTER

3800-3904 Bridgeport Way West, University Place, WA 98466

CONTENTS: 2 Site Plan | 3 Area Information | 4 Space Plans



## DOMINANT GROCERY ANCHORED CENTER

- Dual-grocery anchored by Safeway and Trader Joe's to create recession resistant customer traffic year round.
- HomeGoods and Rite Aid further draw consumers to make Green Firs a true destination shopping center for University Place.
- Synergistic mix of small shop tenants offering retail, restaurant and service options for customers.



**PMF REAL ESTATE SERVICES**  
*a PMF Investments Company*

**Deborah Oswald**

**Vice President, Brokerage**

C: 425-443-0221 P: 425-746-6066

[deborah@pmfinvestments.com](mailto:deborah@pmfinvestments.com)

**Blake Springer-Trybus**

**Associate Broker & Marketing Coordinator**

C: 425-785-9474 P: 425-746-6066

[blake@pmfinvestments.com](mailto:blake@pmfinvestments.com)

The information contained herein has been obtained from sources deemed to be reliable, however, PMF RES makes no representations or warranties to its accuracy. All information should be independently verified by prospective tenants and/or their representatives.

# GREEN FIRS TOWNE CENTER

# Site Plan



## LAST SPACE LEFT!

1,582sf—3824 Bridgeport

\$30.00/sf + \$8.00/sf NNN

Former Sally Beauty

Monument Signage Available



## EXCELLENT VISIBILITY

Pylon signage available on Bridgeport and 40th Ave.

## LOW VACANCY

Historically low vacancy due to strong anchor tenants and major arterial traffic.

## CENTRAL LOCATION

Located 1 block from UP City Hall and Civic Center, Curtis High School/Junior High, residential developments and the Fircrest Golf Club.



PMF REAL ESTATE SERVICES  
a PMF Investments Company

Deborah Oswald C: 425-443-0221 P: 425-746-6066 deborah@pmfinvestments.com

Blake Springer-Trybus C: 425-785-9474 P: 425-746-6066 blake@pmfinvestments.com

pmfinvestments.com 15015 Main Street, Suite 203, Bellevue, WA 98007

The information contained herein has been obtained from sources deemed to be reliable, however, PMF RES makes no representations or warranties to its accuracy. All information should be independently verified by prospective tenants and/or their representatives.

# GREEN FIRS TOWNE CENTER

# Area Information

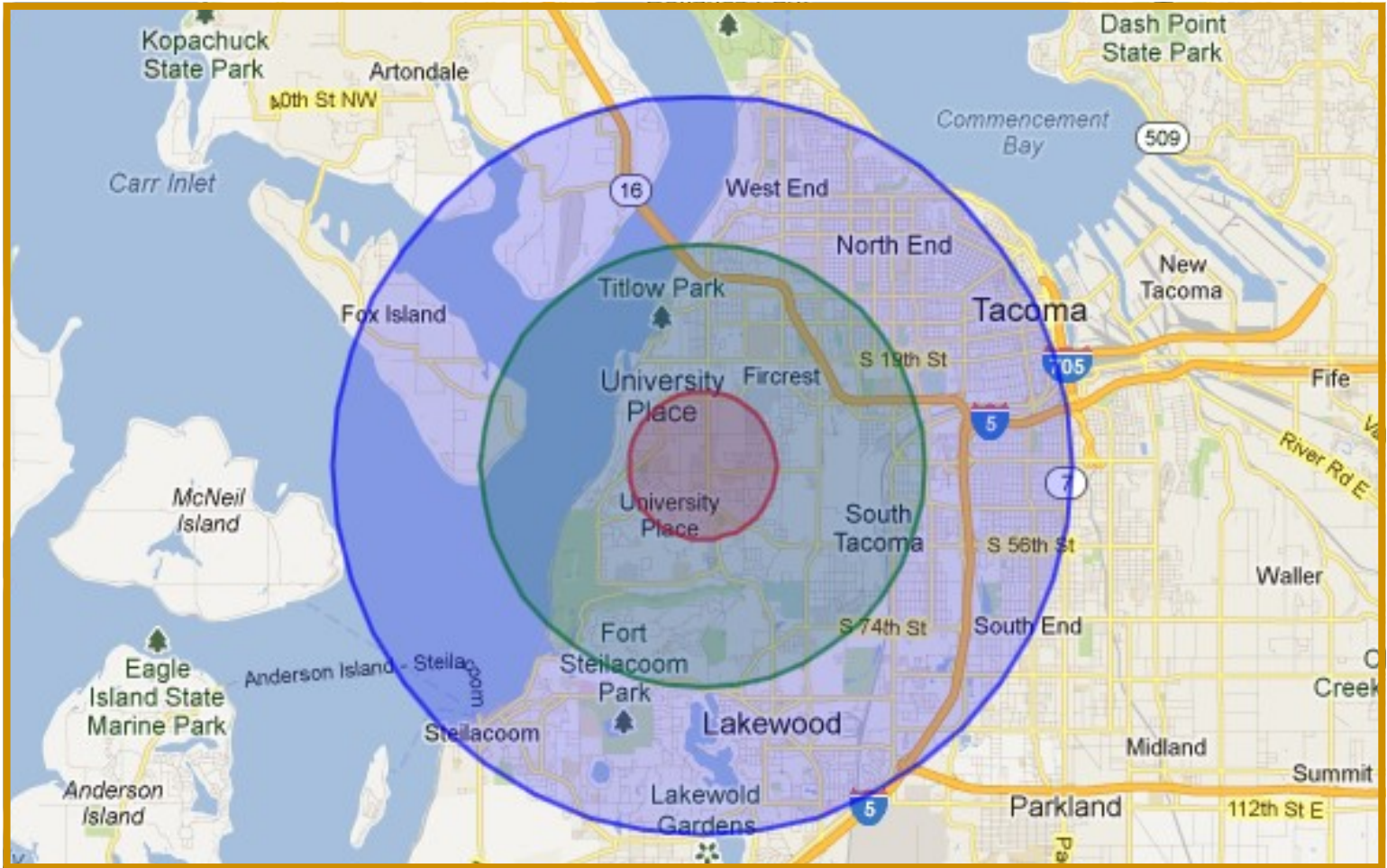

## Demographics

	1 Mile	3 Mile	5 Mile
Population	15,532	91,270	238,949
Average Income	\$89,366	\$76,146	\$76,581
# of Households	6,294	38,973	98,206

Green Firs sits along Bridgeport Way, the main thoroughfare through Fircrest, UP and Lakewood, stretching from the Tacoma Narrows Bridge south to the I-5.

University Place is a densely populated, high income suburban city in Pierce County. Sitting along the Puget Sound, UP is located directly in between Seattle and Olympia.



**PMF REAL ESTATE SERVICES**  
a PMF Investments Company

Deborah Oswald C: 425-443-0221 P: 425-746-6066 [deborah@pmfinvestments.com](mailto:deborah@pmfinvestments.com)  
 Blake Springer-Trybus C: 425-785-9474 P: 425-746-6066 [blake@pmfinvestments.com](mailto:blake@pmfinvestments.com)  
[pmfinvestments.com](http://pmfinvestments.com) 15015 Main Street, Suite 203, Bellevue, WA 98007

The information contained herein has been obtained from sources deemed to be reliable, however, PMF RES makes no representations or warranties to its accuracy. All information should be independently verified by prospective tenants and/or their representatives.

# GREEN FIRS TOWNE CENTER

# Space Plans

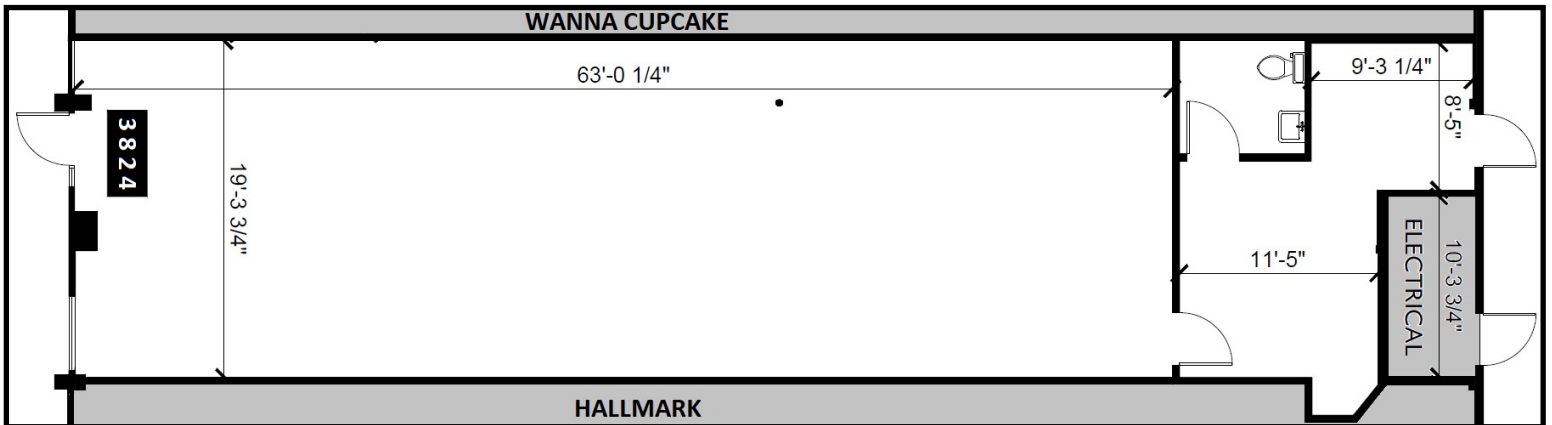

## 3824 Bridgeport Way West—Sally Beauty Supply Space

Former Sally Beauty retail space available. Open retail salesfloor, back stockroom and employee restroom. Monument signage available.



PMF REAL ESTATE SERVICES  
a PMF Investments Company

Deborah Oswald C: 425-443-0221 P: 425-746-6066 [deborah@pmfinvestments.com](mailto:deborah@pmfinvestments.com)  
Blake Springer-Trybus C: 425-785-9474 P: 425-746-6066 [blake@pmfinvestments.com](mailto:blake@pmfinvestments.com)  
[pmfinvestments.com](http://pmfinvestments.com) 15015 Main Street, Suite 203, Bellevue, WA 98007

The information contained herein has been obtained from sources deemed to be reliable, however, PMF RES makes no representations or warranties to its accuracy. All information should be independently verified by prospective tenants and/or their representatives.