

# Security Square Office Park

1721 Rolling Road  
Woodlawn, MD 21244

240,000 SQ. FT.  
OF CLASS A  
OFFICE SPACE  
AVAILABLE

**Security Square Office Park** is a proposed project consisting of two Class A office buildings fronting Rolling Road at Security Boulevard (Route 122) in Woodlawn, MD. The project is within one mile of both the Social Security Administration (SSA) national headquarters and the Centers for Medicare & Medicaid Services (CMS) headquarters. Both buildings are five stories each, consisting of four levels of office space over one level of covered parking. Floor plates are 30,000 SF per floor, totaling 120,000 SF of available space in each building.

# LOCATION OF SITE

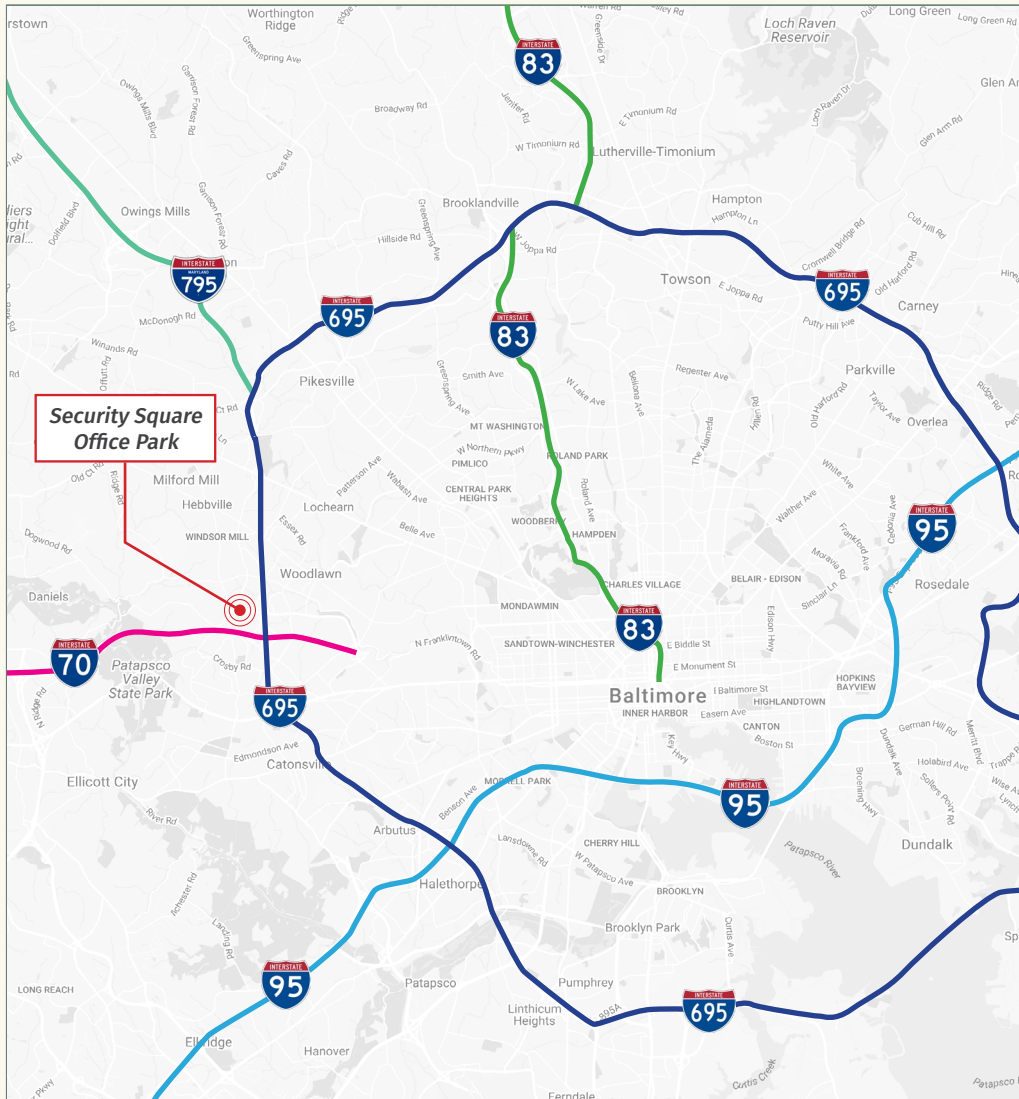

**25 mile radius**

**5 mile radius**

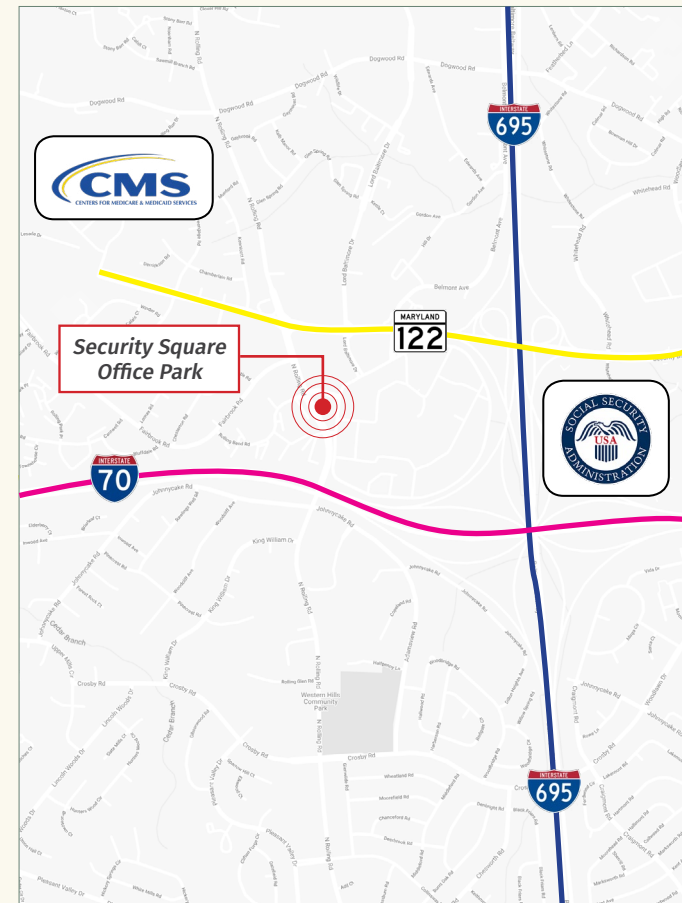

## CONTACT

Kevin Keane, Senior Vice President of Office Leasing | Phone: 410.581.2519 | Email: kevin@davidbrown.com  
Brent Mangum, Vice President of Office Leasing | Phone: 410.581.2518 | Email: brent@davidbrown.com





# ELEVATION OPTIONS



OPTION 1



OPTION 2

## CONTACT

Kevin Keane, *Senior Vice President of Office Leasing* | Phone: 410.581.2519 | Email: kevin@davidsbrown.com  
Brent Mangum, *Vice President of Office Leasing* | Phone: 410.581.2518 | Email: brent@davidsbrown.com



# FLOOR PLAN

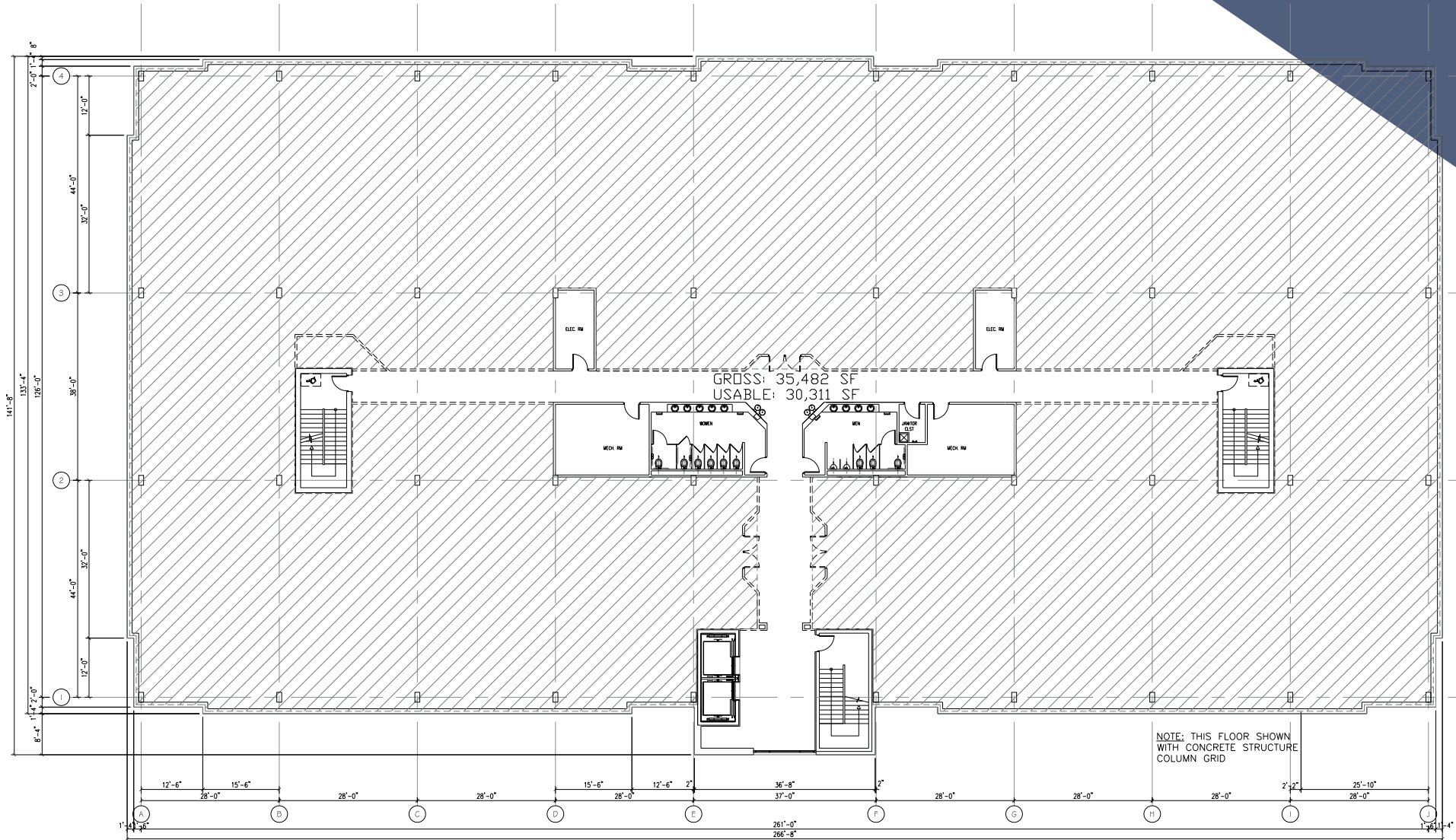

## CONTACT

Kevin Keane, *Senior Vice President of Office Leasing* | Phone: 410.581.2519 | Email: kevin@davidbrown.com  
 Brent Mangum, *Vice President of Office Leasing* | Phone: 410.581.2518 | Email: brent@davidbrown.com





# SITE PLAN



MARYLAND  
122

N ROLLING ROAD

PROP. 5-STORY  
121,800 SF OFFICE  
82 PS FIRST FLOOR

PROP. 5-STORY  
121,800 SF OFFICE  
83 PS FIRST FLOOR

INTERSTATE  
70

INTERSTATE  
695

INTERSTATE  
70

## CONTACT

Kevin Keane, *Senior Vice President of Office Leasing* | Phone: 410.581.2519 | Email: kevin@davidbrown.com  
Brent Mangum, *Vice President of Office Leasing* | Phone: 410.581.2518 | Email: brent@davidbrown.com

