

**FOR LEASE**



**2711 Alpine Road**  
Columbia, SC 29223

## **Flex Strip Center for Lease**

- Available:
  - Unit 100 -  $\pm 1,950$  SF
  - Unit 230 -  $\pm 2,100$  SF
- Located in the heart of the bustling I-77 Corridor of Northeast Columbia
- Less than  $\pm 2$  miles from the I-20 and I-77 interchange
- Dock High Roll-Up Door
- Office and Warehouse space
- Ample Auto and Truck Parking

**Lease Rate: \$10.00/SF NNN**

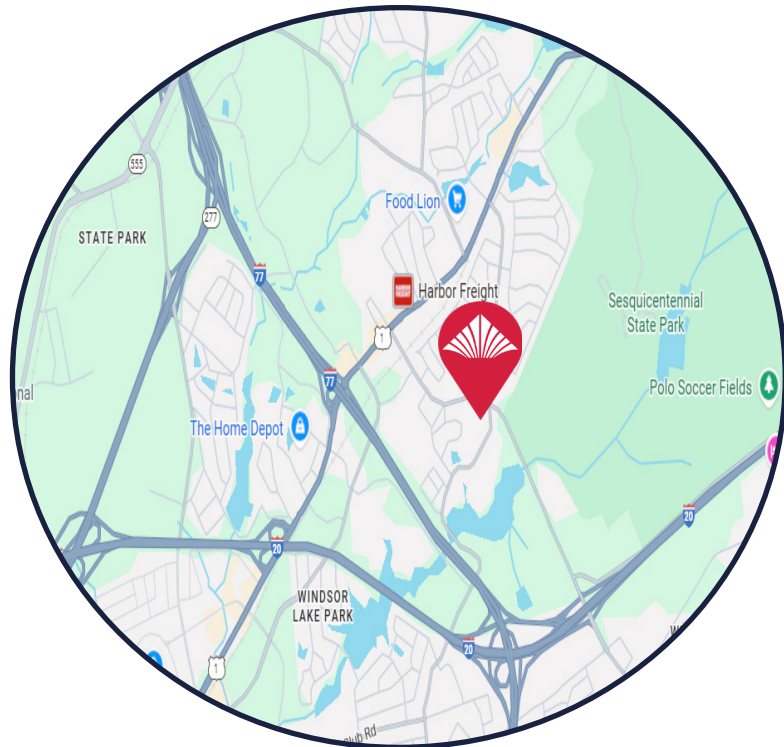

**CONTACT:**

**JOHN MILLS** | [jmills@wilsonkibler.com](mailto:jmills@wilsonkibler.com) | 803.255.8628

**BOO MOCA** | [boo@wilsonkibler.com](mailto:boo@wilsonkibler.com) | 803.255.8608

The information contained herein has been obtained from sources we believe to be reliable; however, Wilson Kibler has not conducted any investigation regarding these matters and makes no warranty or representation whatsoever regarding the accuracy or completeness of the information provided.

**Wilson Kibler**  
COMMERCIAL REAL ESTATE





# 2711 Alpine Road

Columbia, SC 29223

## WINDSOR SQUARE

### Business Center

2711 Alpine Road, Columbia, SC 29223

#### SITE PLAN—Phase I

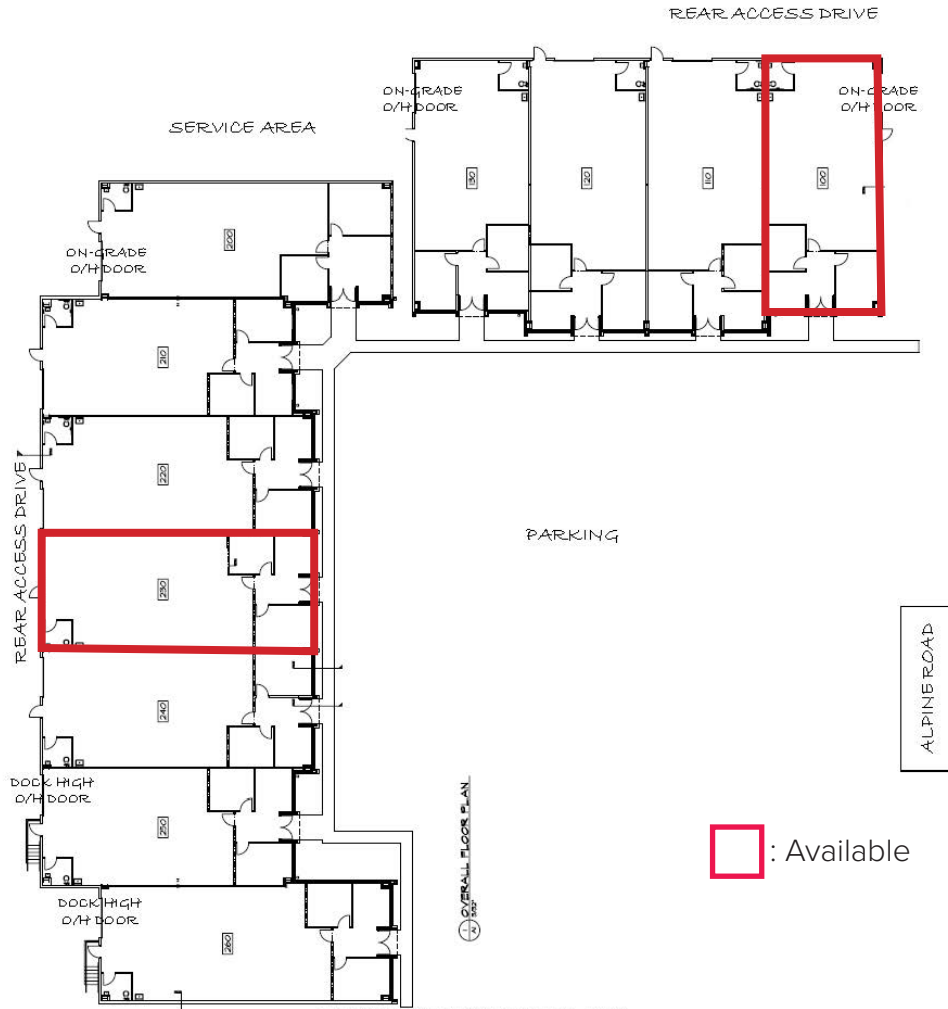

#### RESOURCE PROPERTIES, INC.

Real Estate Development • Construction • Brokerage • Property Management  
 PO Box 786, Irmo, SC 29063-0786 Email: @ResourcePropertiesInc.com  
 Office: (803) 735-1108 Fax: (803) 407-2688

R: 7/18/25

#### CONTACT:

JOHN MILLS | jmills@wilsonkibler.com | 803.255.8628

BOO MOCA | boo@wilsonkibler.com | 803.255.8608

**Wilson Kibler**  
 COMMERCIAL REAL ESTATE



The information contained herein has been obtained from sources we believe to be reliable; however, Wilson Kibler has not conducted any investigation regarding these matters and makes no warranty or representation whatsoever regarding the accuracy or completeness of the information provided.