

FOR LEASE - ENDCAP AVAILABLE!

13701-17 S. Cicero Avenue

CRESTWOOD, IL 60445

RETAIL



PROPERTY INFO

- + Space Available:
 - 13701 - Former Hair Salon $\pm 1,190$ SF
 - 13717 - Former Sub Restaurant $\pm 1,625$ SF
 - 13711 - Former Medical $\pm 2,080$ SF (not divisible)
- + Located at a signalized intersection
- + Traffic Counts: 40,200 vpd on S. Cicero Ave
- + Adjacent National Restaurants include McDonald's, Dunkin Donuts, Taco Bell, Panda Express, Starbucks, Potbelly, Portillo's, Raising Cane's, Chick-fil-A, Chipotle, Jersey Mike's, Popeye's & more!
- + Anchor Tenants in the Trade Area: Walmart, Menards, Target & more!
- + Other Surrounding Area Tenants: Dollar Tree, Party City, Kohl's, Burlington, PetSmart, Planet Fitness, Best Buy, & more!

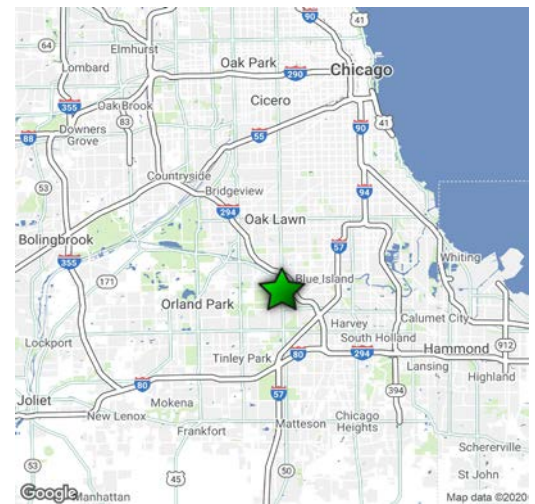

Demographic Report

	1 Miles	3 Miles
Population	10,214	85,335
Estimate Households	4,505	33,026
Average HH Income	\$80,762	\$90,704
Daytime Population	12,392	80,889

CONTACT US

Marcy Wood

+1 630 573 1287
marcy.wood@cbre.com

CBRE

700 Commerce Drive
Oak Brook, IL 60523

www.cbre.us/13701crestwood

CBRE

FOR LEASE- ENDCAP AVAILABLE!

13701-17 S. Cicero Avenue

CRESTWOOD, IL 60445

RETAIL

SITE PLAN

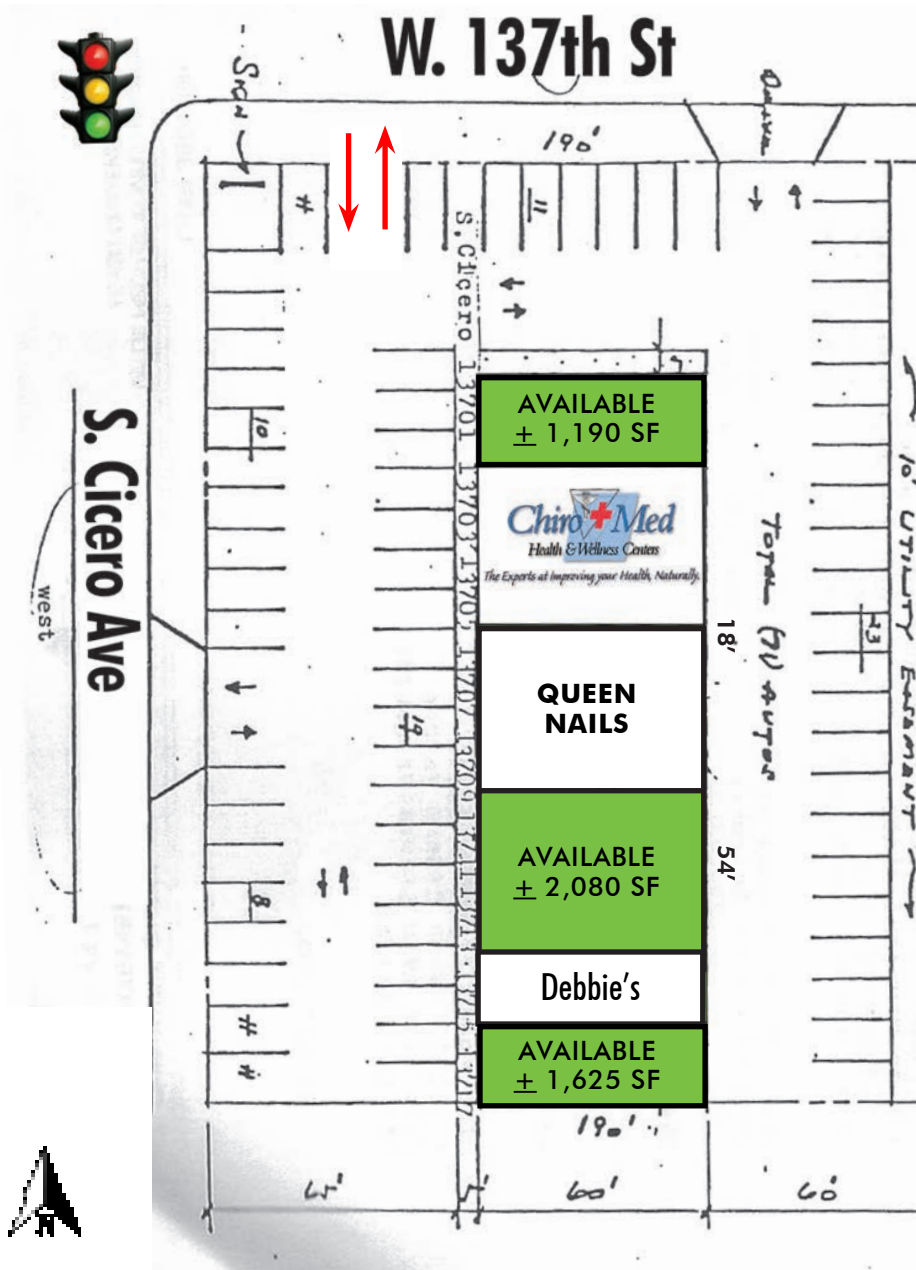

Space	Tenant	SF
13701	AVAILABLE	1,190
13703-05	Chiro + Med Pain Treatment	2,340
13707	Queen Nails	2,340
13709		
13711-14	AVAILABLE	2,080
13715	Debbie's	1,430
13717	AVAILABLE	1,625



FOR LEASE- ENDCAP AVAILABLE!

13701-17 S. Cicero Avenue

CRESTWOOD, IL 60445

RETAIL

AERIAL

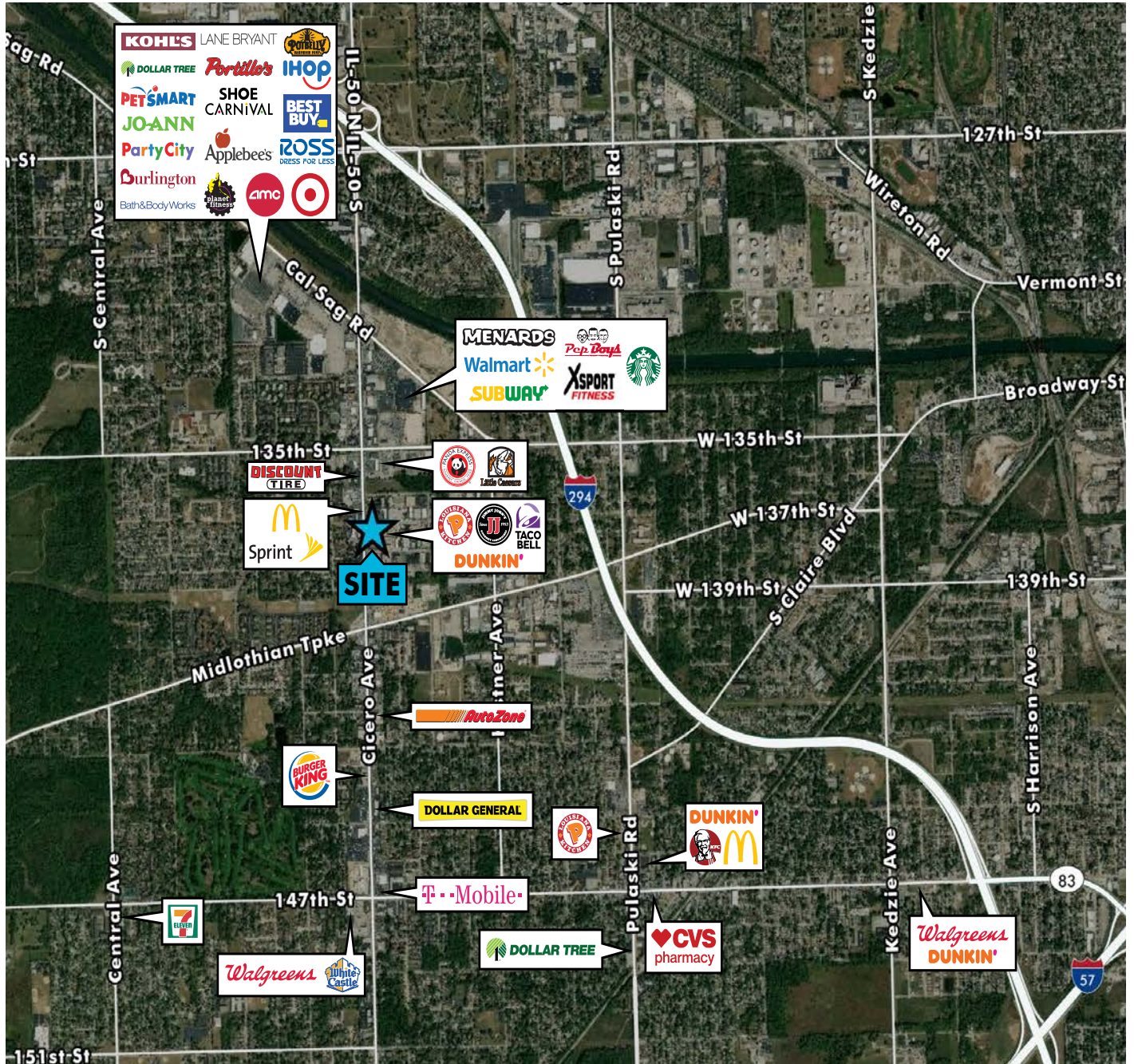

© 2020 CBRE, Inc. This information has been obtained from sources believed reliable. We have not verified it and make no guarantee, warranty or representation about it. Any projections, opinions, assumptions or estimates used are for example only and do not represent the current or future performance of the property. You and your advisors should conduct a careful, independent investigation of the property to determine to your satisfaction the suitability of the property for your needs. Photos herein are the property of their respective owners and use of these images without the express written consent of the owner is prohibited. CBRE and the CBRE logo are service marks of CBRE, Inc. and/or its affiliated or related companies in the United States and other countries. All other marks displayed on this document are the property of their respective owners.

www.cbre.us/13701crestwood

CBRE