

29,600 SF AVAILABLE W/ POTENTIAL EXTERIOR STORAGE

# 14329 NORTHDAL BLVD

Rogers, MN 55374

FOR SALE (AVAILABLE Q1 2025)



**Charlie Merwin**  
+1 612 347 9346  
charlie.merwin@cushwake.com

**Clint Moe**  
+1 952 221 1380  
clint.moe@cushwake.com

 **CUSHMAN &  
WAKEFIELD**

# PROPERTY HIGHLIGHTS

- Great owner/user or investment opportunity!
- Available Q1 2025 (immediate short-term leaseback possible)
- Fantastic location
- Heavy power (2200amps/208V/3phase)
- Dock and Drive-in loading
- Great accessibility via Highway 101
- Roof replaced in 2015
- Potential for 6,000 sf of exterior storage
- 15'-20' clear in warehouse
- Automotive uses allowed
- Large truckcourt that can accommodate 48' & 53' trailers
- Ability to multi-tenant
- Separated utilities



<b>Address</b>	14329 Northdale Blvd Rogers, MN 55374
<b>Building size</b>	4,046 SF Office <u>25,554 SF Warehouse</u> 29,600 SF Total
<b>Lot Area</b>	3.01 Acres
<b>Exterior Storage</b>	Up to 6,000 sf
<b>Year Built</b>	1983
<b>Roof</b>	2015
<b>Clear Height</b>	15' - 20'
<b>Dock-High Doors</b>	3 (4' high w/ levelers)
<b>Drive-in Doors</b>	8 (including 1 drive-thru bay)
<b>Zoning</b>	RC: Regional Employment Center (multiple uses allowed)
<b>2024 Taxes</b>	\$51,782 (\$1.75/sf)
<b>Sale Price</b>	Negotiable

# PHOTOS

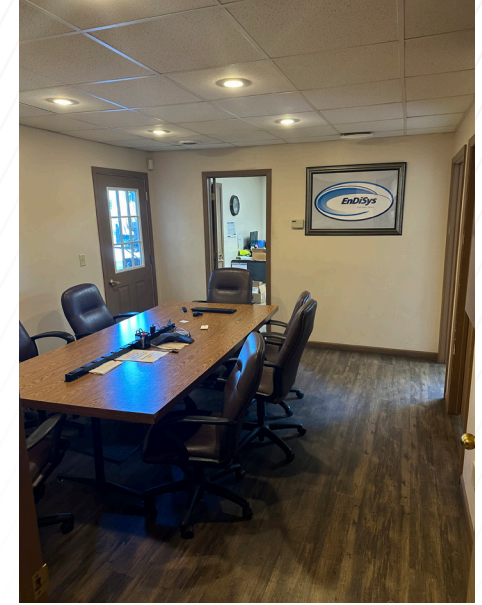

# THE LOCATION



# THE LOCATION

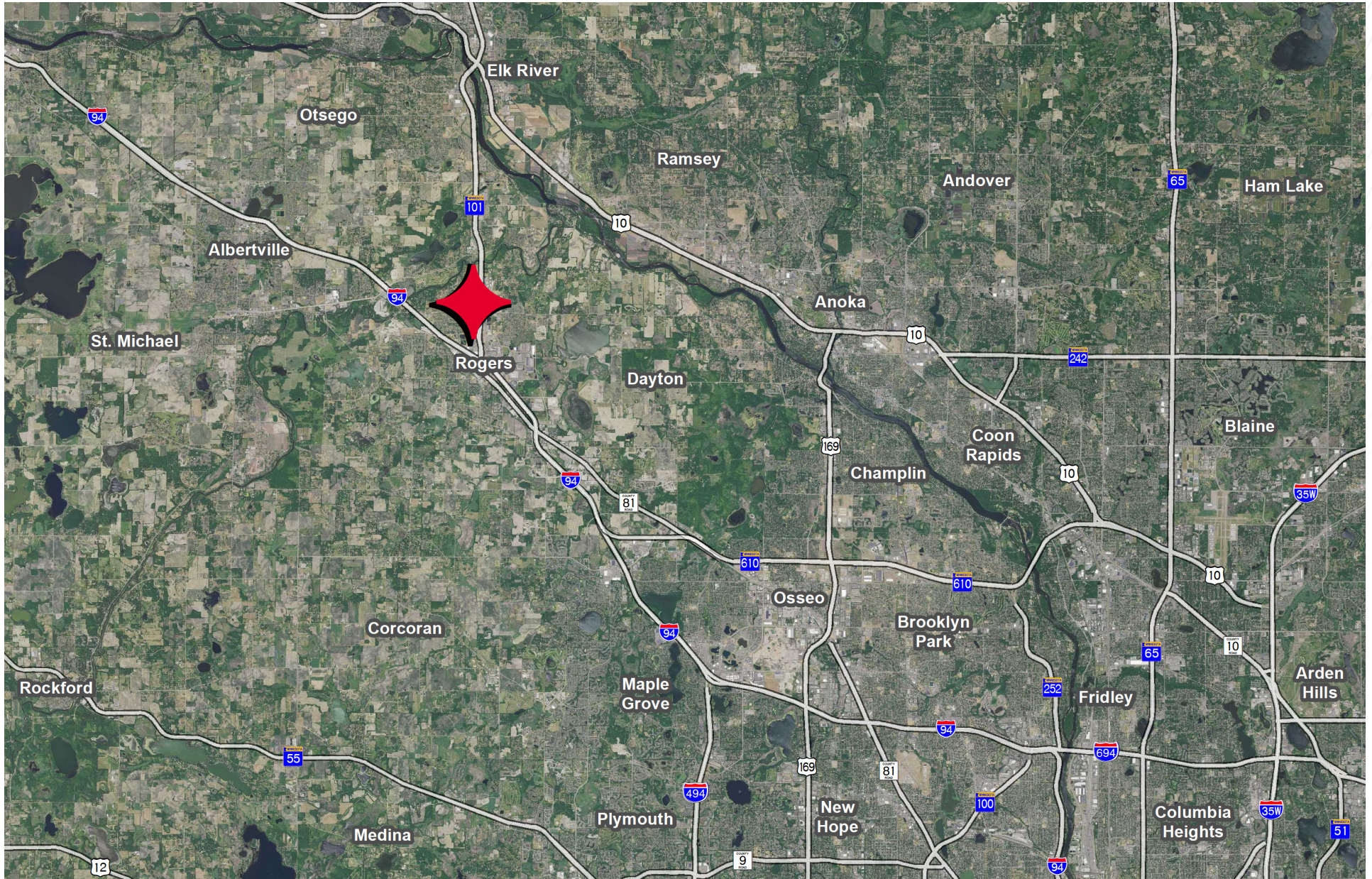

# CURRENT FLOOR PLAN

North



## LEGEND

- ▲ FIRE EXTINGUISHER
- ◆ HALON FIRE CONTROL
- EMERGENCY EXIT
- FIRST AID KIT
- EYE WASH STATION

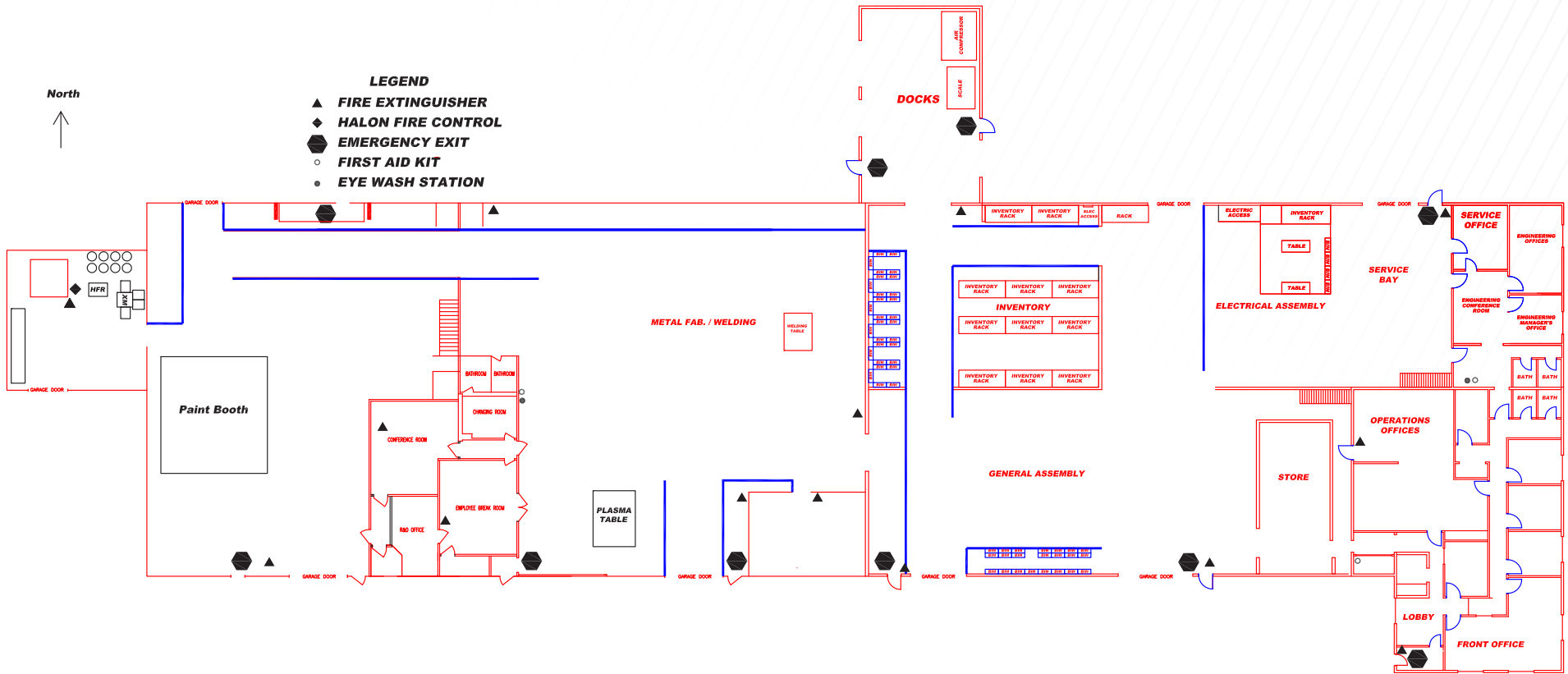

# MULTI-TENANT OPTION

## TENANT 2 SPACE

- \*1,546sf office
- \*13,254sf warehouse
- \*14,800sf total
- \*3 drive-ins
- \*1 dock (4' high)

## TENANT 1 SPACE

- \*2,500sf office
- \*12,300sf warehouse
- \*14,800sf total
- \*5 drive-ins (incl. 1 drive-thru bay)
- \*2 docks (4' high)

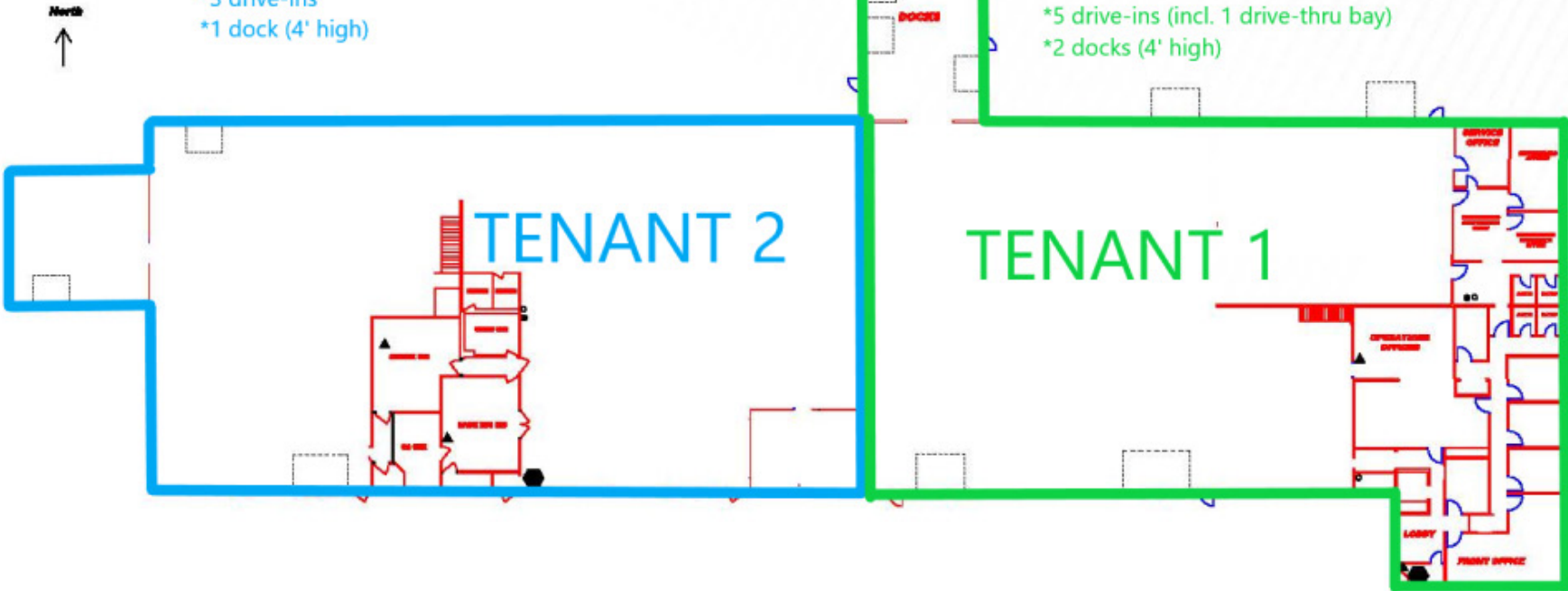





**FOR MORE INFORMATION, PLEASE CONTACT:**

**Charlie Merwin**  
+1 612 347 9346  
charlie.merwin@cushwake.com

**Clint Moe**  
+1 952 221 1380  
clint.moe@cushwake.com

3500 American Blvd W  
Suite 200  
Bloomington, MN 55431  
T +1 952 831 1000



©2024 Cushman & Wakefield. All rights reserved. The information contained in this communication is strictly confidential. This information has been obtained from sources believed to be reliable but has not been verified. NO WARRANTY OR REPRESENTATION, EXPRESS OR IMPLIED, IS MADE AS TO THE CONDITION OF THE PROPERTY (OR PROPERTIES) REFERENCED HEREIN OR AS TO THE ACCURACY OR COMPLETENESS OF THE INFORMATION CONTAINED HEREIN, AND SAME IS SUBMITTED SUBJECT TO ERRORS, OMISSIONS, CHANGE OF PRICE, RENTAL OR OTHER CONDITIONS, WITHDRAWAL WITHOUT NOTICE, AND TO ANY SPECIAL LISTING CONDITIONS IMPOSED BY THE PROPERTY OWNER(S). ANY PROJECTIONS, OPINIONS OR ESTIMATES ARE SUBJECT TO UNCERTAINTY AND DO NOT SIGNIFY CURRENT OR FUTURE PROPERTY PERFORMANCE.

