

# LAND LEASE

## Prime Parcel Available

### Miramar Parkway & Red Road, Miramar, FL

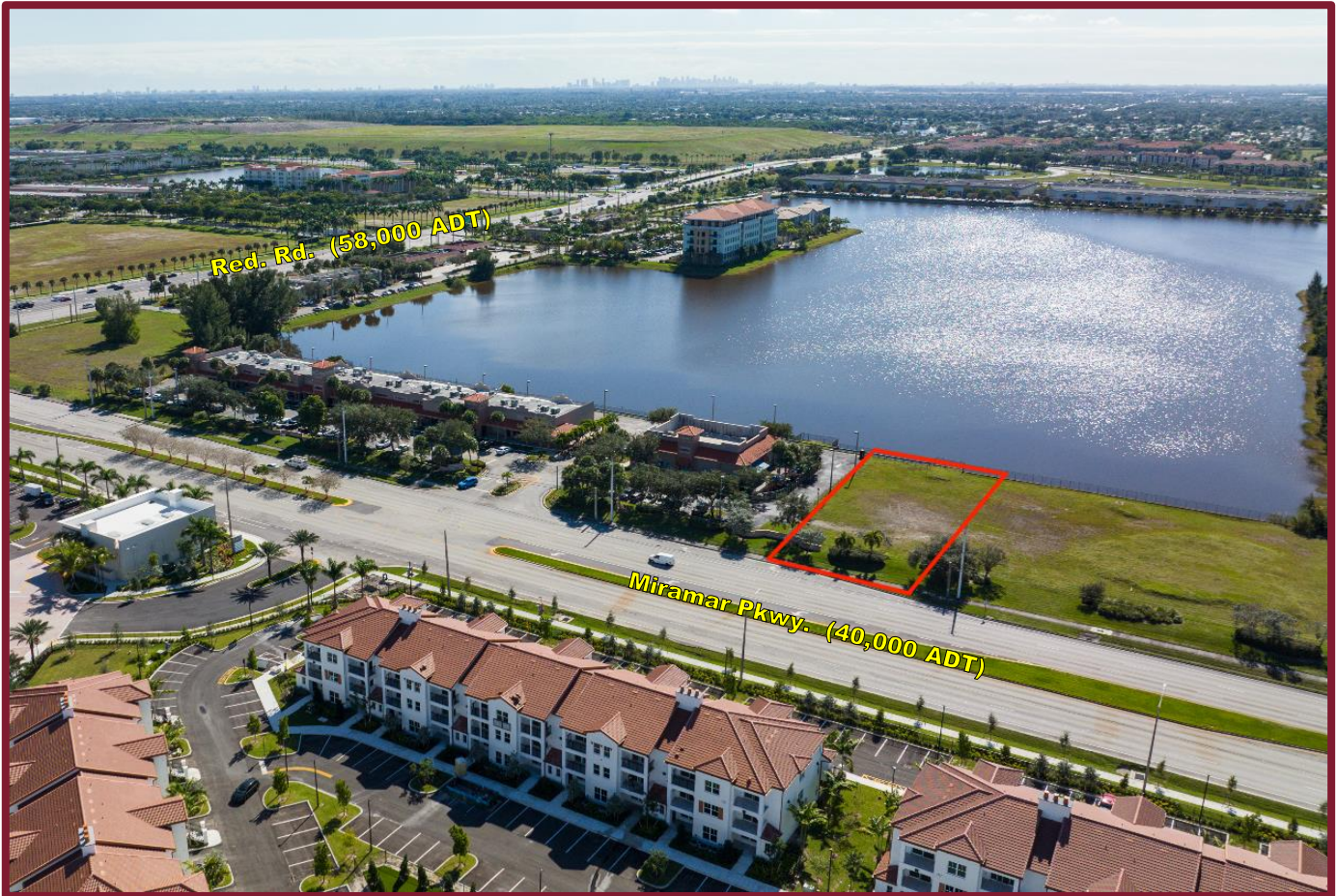

**Parcel Size:** 0.48 Acres  
(86.75' x 240' = 20,800 SF±)

- Finished and permit ready
- No onsite retention required
- Small drive-thru user only (coffee, etc.)
- Traffic Count: 98,000 ± ADT



<b>Population:</b>	<b>1 Mile:</b> 12,812	<b>3 Mile:</b> 181,500	<b>5 Mile:</b> 435,864
<b>Average HH Income:</b>	<b>1 Mile:</b> \$96,584	<b>3 Mile:</b> \$96,082	<b>5 Mile:</b> \$112,961
<b>Daytime Demos:</b>	<b>1 Mile:</b> 16,300	<b>3 Mile:</b> 70,983	<b>5 Mile:</b> 179,537

# Prime Parcel Available

SW Corner of Miramar Parkway & Red Road  
Miramar, Florida 33025

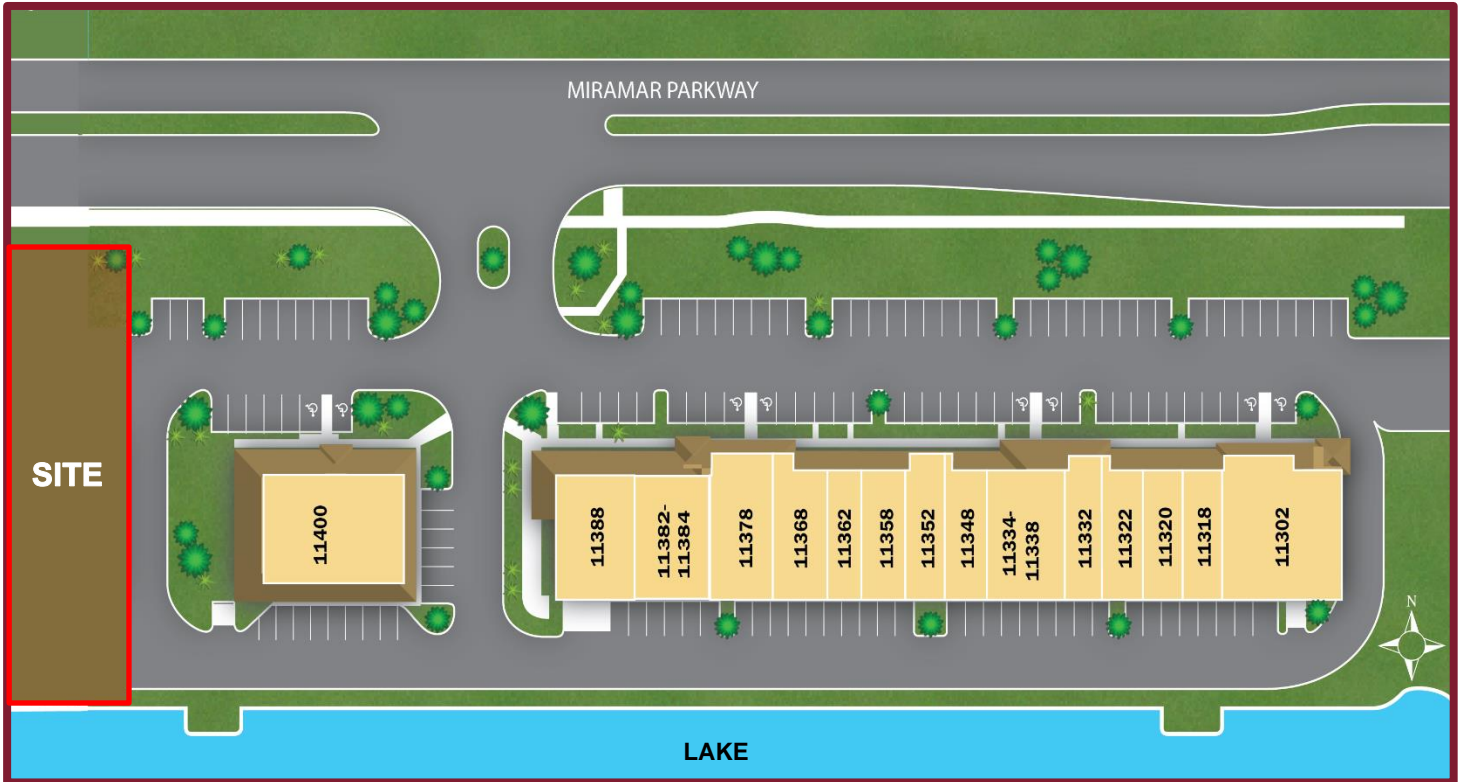

## PROPERTY HIGHLIGHTS:

- High visibility at major intersection, with close and convenient access to Florida Turnpike and I-75.
- Regional trade area, centrally located on Miami-Dade/Broward county line. Great for businesses catering to both counties.
- Down the street from the Miramar Park of Commerce (over 5,000,000 SF)
- Close vicinity to Miramar City Hall & Municipal Complex (500,000 SF)
- Corridor is booming with commercial & residential development.
  - 2,500± multi-family apartments are near completion or under construction with another 2,500 planned.
  - The Park Miramar, a new upscale mix-use development community with 325,000 SF of retail; 110,000 SF Class-A Office; 2,825 contemporary style homes and a 180 key boutique hotel to be completed in 2026.

## FOR LEASING INFORMATION

INVESTMENT MANAGEMENT ASSOCIATES, INC.  
2151 S. Le Jeune Road, Suite 202  
Coral Gables, FL 33134

T: 305.661.0110 | [www.ima-re.com](http://www.ima-re.com)

