



# 1000 MAIN

CONNECTED. MODERN. PROVEN.

SUITE 1800



**CONNECTED. MODERN. VERSATILE.**

- Full Floor - 28,963 RSF
- High-end finishes throughout
- Partially furnished
- Amazing views of Downtown Houston



EXISTING FLOOR PLAN - LEVEL 18

- 28,963 RSF
- Floor-To-Ceiling Windows
- Ceiling Height: 9'
- Floor-To-Deck Height: 13'
- 26 Offices
- 8 Conference Rooms
- 2 Break Rooms

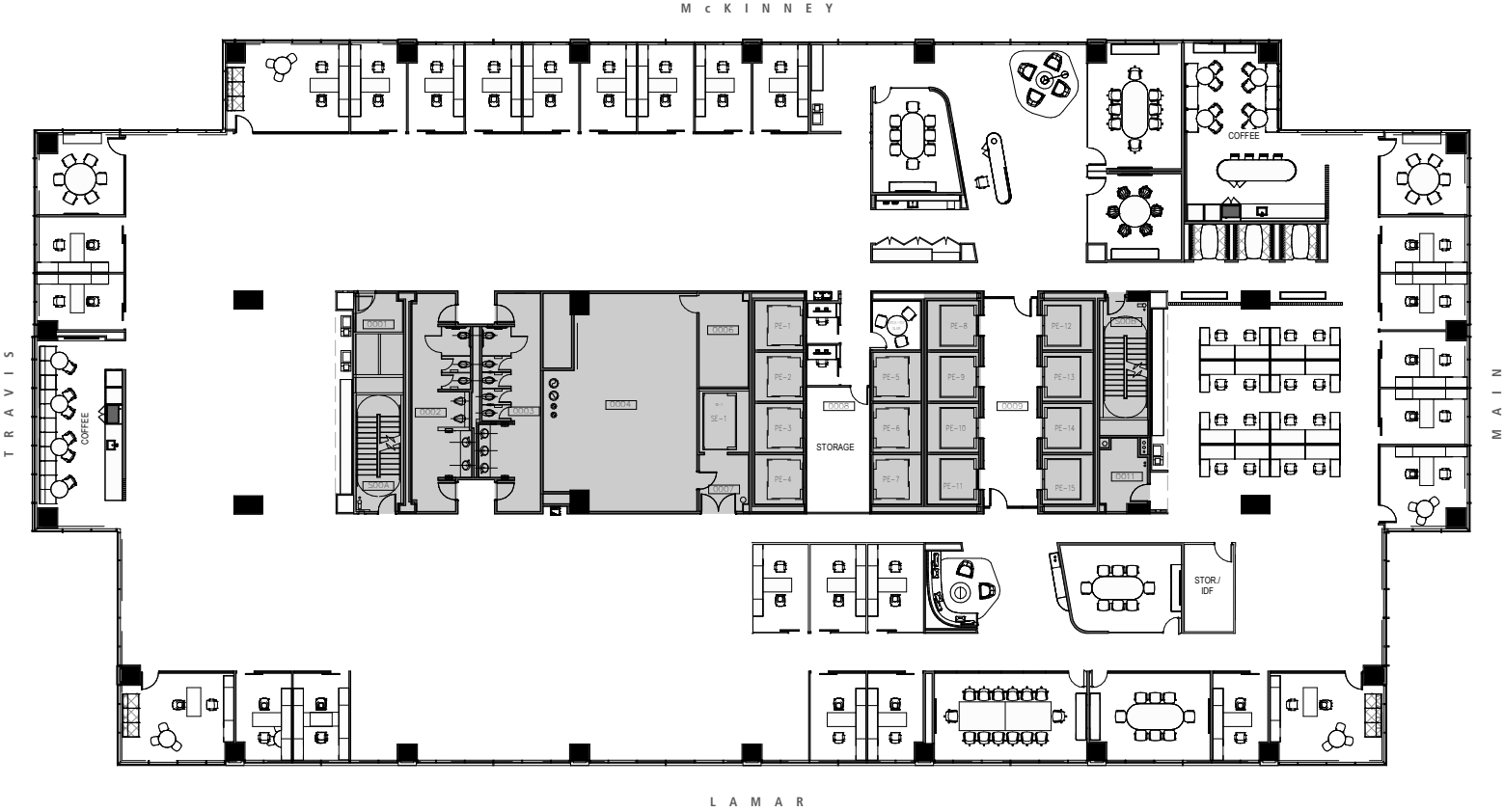

PROPOSED FLOOR PLAN CONCEPT - LEVEL 18

- 28,963 RSF
- Floor-To-Ceiling Windows
- Ceiling Height: 9'
- Floor-To-Deck Height: 13'
- 34 Offices
- 82 Workstations
- 8 Conference Rooms
- 2 Break Rooms

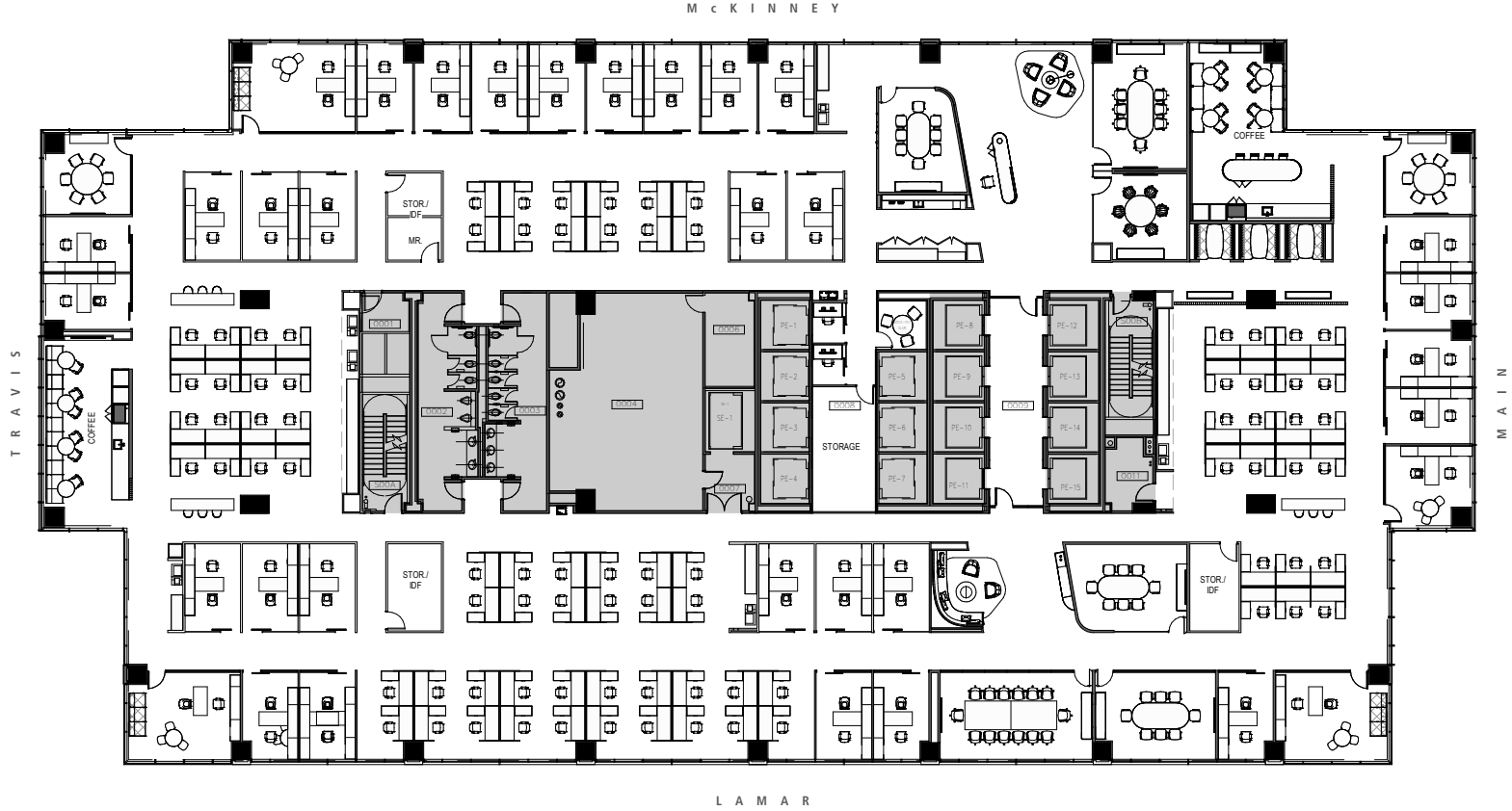



Private Office



Workstations



Primary Break Room



Secondary Break Room

1000  
MAIN



Connected. Modern. Proven.

**LEASING CONTACT**

---

**Wade Bowlin** | Principal and Managing Director  
D +1 713 209 5753  
wade.bowlin@avisonyoung.com

**Marti Grizzle**  
D +1 713 209 5809  
marti.grizzle@avisonyoung.com

Avison Young  
1000 Main Street, Suite 2400  
Houston, TX 77002

**AVISON  
YOUNG**

