

4509 WEST ADAMS

STREET RETAIL SPACE AVAILABLE

W. Adams
BOULEVARD



2,993 SF AVAILABLE

Located in a prominent location on West Adams Boulevard and Wellington Road, 4509 West Adams boasts a premier corner retail opportunity, totaling in 2,993 SF. This is a premier location for retail or service in an excellent amenity to the creative office and lively intersection.

4509 WEST ADAMS
STREET RETAIL SPACE AVAILABLE

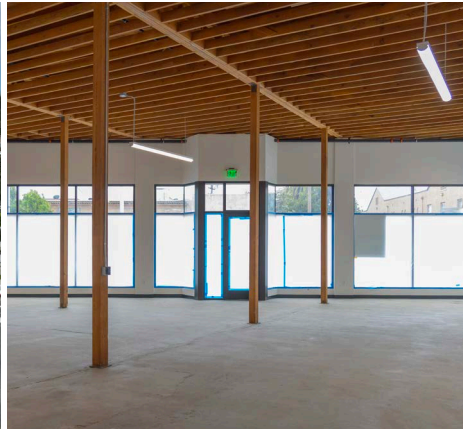
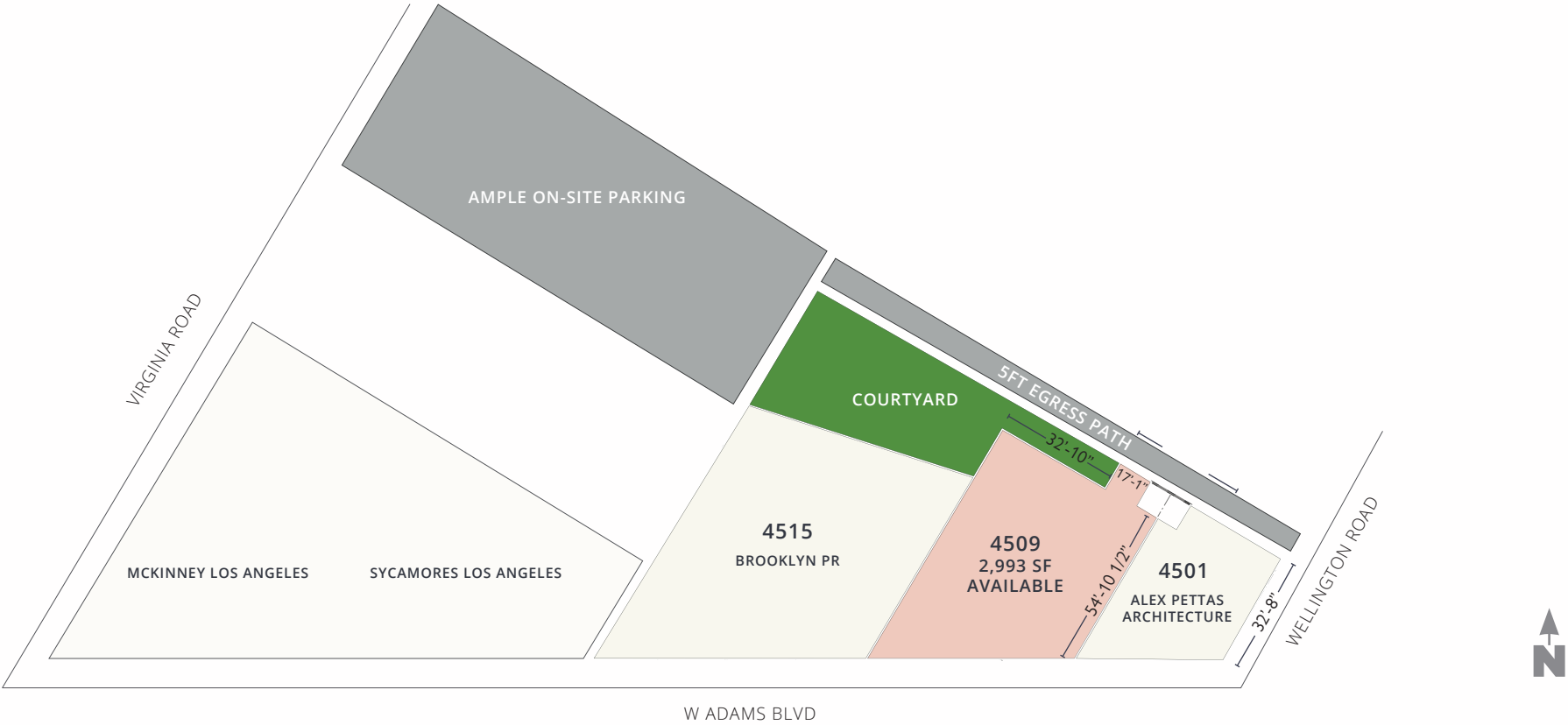

PROMINENT CORNER SPACE ON
WELLINGTON RD

PREMIER

LOCATION FOR RETAIL OR
SERVICE USE

IMMEDIATE ACCESS TO THE I-10
FREEWAY VIA CRENSHAW

WEST ADAMS NEIGHBORHOOD

W. Adams
BOULEVARD



VICKY'S ALL DAY



ALSACE HOTEL



CENTO



FARMHOUSE KITCHEN

24K+

DAILY TRAFFIC COUNT FROM
ADAMS BOULEVARD

1,253,632

2024 POPULATION
WITHIN A 5-MILE RADIUS

504,654

2024 HOUSEHOLDS
WITHIN A 5-MILE RADIUS

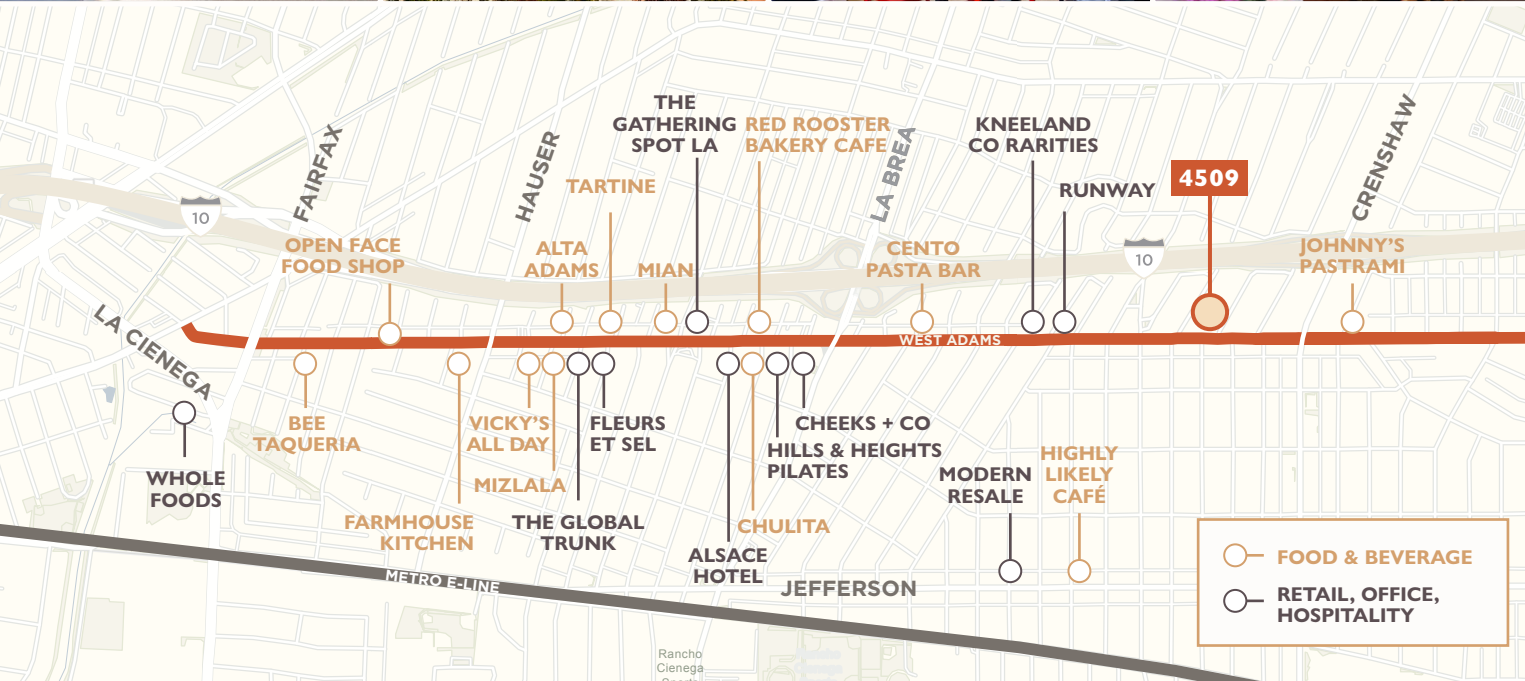

FOR RETAIL LEASING INFORMATION:

JENNIFER MEADE #01298843

323.860.9523 | jmeade@cimgroup.com