

**FOR LEASE**



ALEXANDER & BALDWIN

**CBRE**



# Kakaako Commerce Center

875 WAIMANU STREET, HONOLULU, HI 96813



# Kakaako Commerce Center

**Discover the Kakaako Commerce Center, a six-level warehouse/office complex located in one of Honolulu's most exciting areas to live, work, play!**

Strategically located in the heart of urban Honolulu, the Kakaako Commerce Center is within a half-mile radius of downtown Honolulu, Ward Center, Blaisdell Arena, and Ala Moana. Just 0.5 miles from the H-1, the location ensures a hassle-free commute, complemented by convenient on-site parking options available for monthly purchase.

Designed for optimal functionality, the Kakaako Commerce Center boasts amenities such as a common area loading dock, elevator access, and 24/7 security. In addition to practicality, the location will encourage a healthy work-life balance, allowing you to thrive professionally and personally.

Immerse yourself in the vibrant Kakaako community, where diverse dining options, ranging from trendy cafes to upscale restaurants, cater to every palate. Need a nature break? Kakaako Waterfront Park is just moments away.

**Welcome to a workplace that goes beyond the ordinary, defining a new standard for work-life integration.**

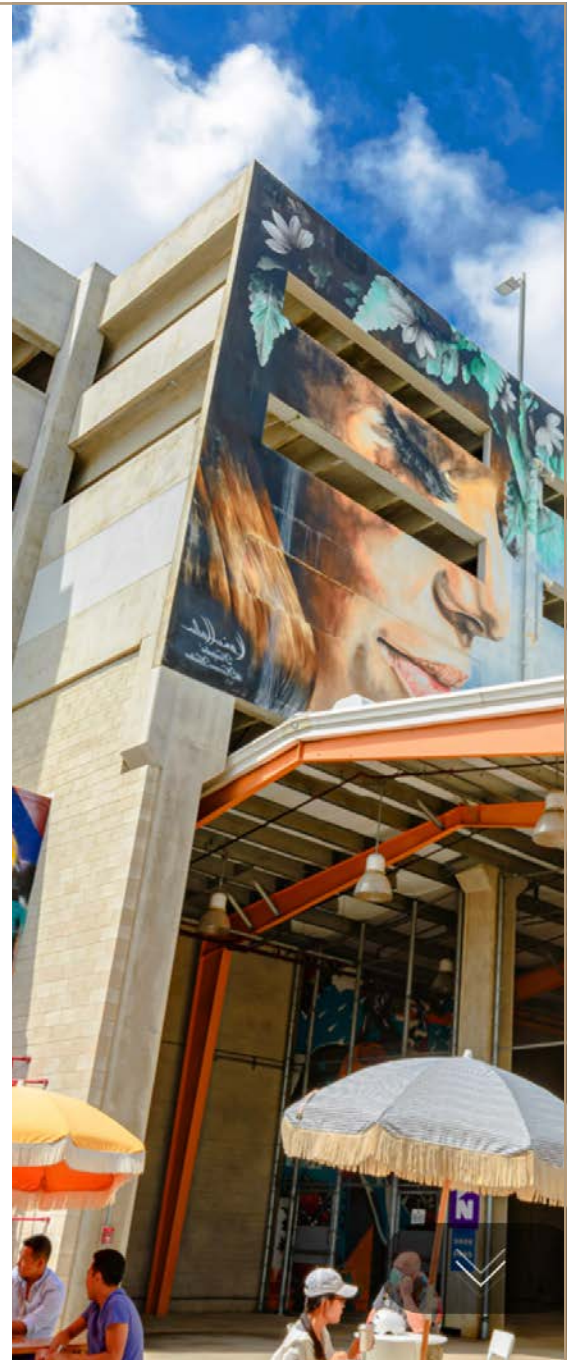

**Kakaako Waterfront Park  
Just 1 Mile Away**



**SALT at Our Kakaako  
Just .7 Miles Away**

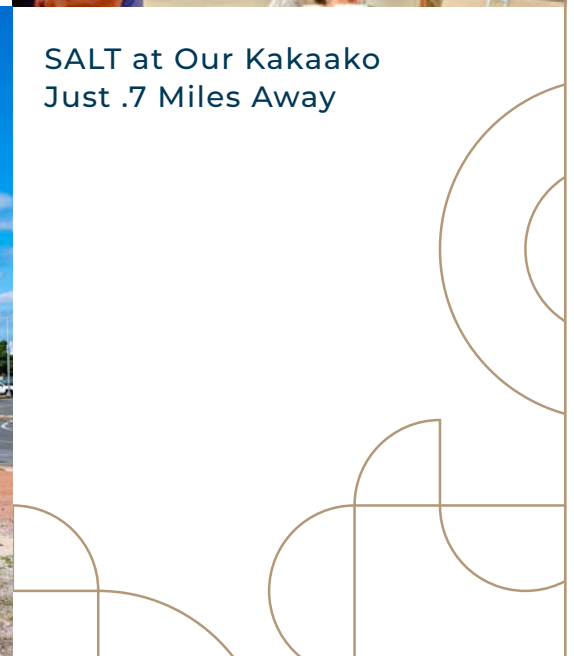

## KEY FEATURES



Highly desired central location in the heart of vibrant Kakaako



Speed ramp access all floors, accommodating large vehicles



Common area loading dock with with high and low docks



Landmark building with elevator access, including freight elevator service



24/7 access, on-site security and Common area restrooms



Electricity included in rent



Ample on-site parking available

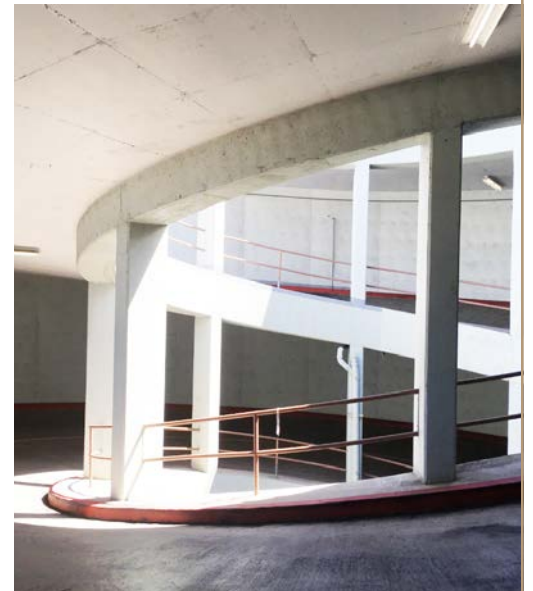

*Elevate your professional life at Kakaako Commerce Center —*



# CONTACT



**JIE MING XIE**

Vice President

Lic. RS-73904

808-541-5154

[Jie.Xie@cbre.com](mailto:Jie.Xie@cbre.com)

© 2026 CBRE, Inc. All rights reserved. This information has been obtained from sources believed reliable but has not been verified for accuracy or completeness. CBRE, Inc. makes no guarantee, representation or warranty and accepts no responsibility or liability as to the accuracy, completeness, or reliability of the information contained herein. You should conduct a careful, independent investigation of the property and verify all information. Any reliance on this information is solely at your own risk. CBRE and the CBRE logo are service marks of CBRE, Inc. All other marks displayed on this document are the property of their respective owners, and the use of such marks does not imply any affiliation with or endorsement of CBRE. Photos herein are the property of their respective owners. Use of these images without the express written consent of the owner is prohibited.

JMX:RMP\_ID54\_KCC-875Waimanu\_03.27.26

# FOR LEASE

## Kakaako Commerce Center

875 WAIMANU STREET, HONOLULU, HI 96813

FLOOR 2

### SUITE INFORMATION

- Street Front Access
- Air Conditioned
- Parking Available \$90/Month Per Stall
- Telecom Available
- Base Rent: \$1.20/SF per Month
- Cam: \$1.06/SF per Month  
(Includes Water/Sewer/Electric)

### INDUSTRIAL SPACE

Suite #	Size	Term	Available
226	1,189 SF	Negotiable	Immediately

### CONTACT

#### JIE MING XIE

Vice President

Lic. RS-73904

**808-541-5154**

Jie.Xie@cbre.com

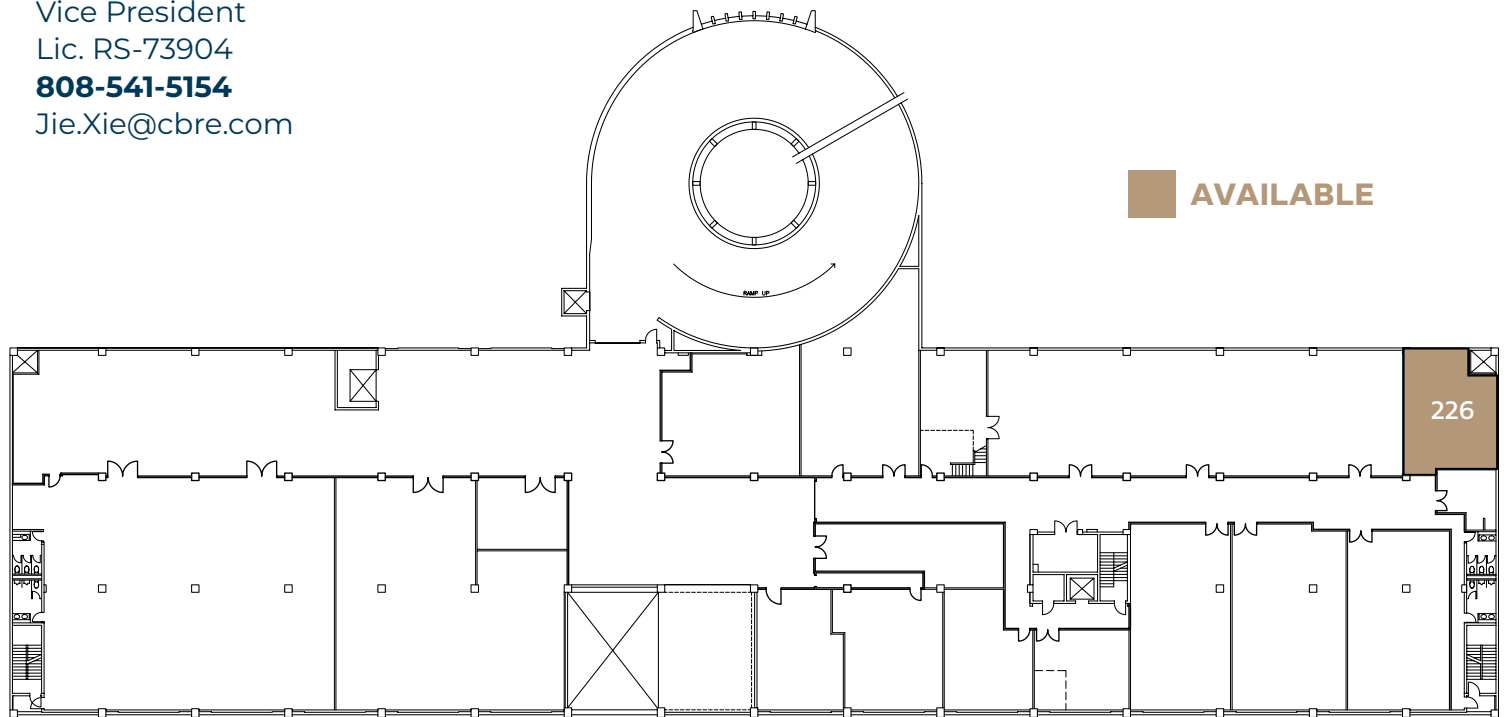

ALEXANDER & BALDWIN



cbre.com/hawaii

# FOR LEASE

## Kakaako Commerce Center

875 WAIMANU STREET, HONOLULU, HI 96813

FLOOR 3

### SUITE INFORMATION

- Street Front Access
- Air Conditioned
- Parking Available \$90/Month Per Stall
- Telecom Available
- Base Rent: \$1.20/SF per Month
- Cam: \$1.06/SF per Month  
(Includes Water/Sewer/Electric)

### INDUSTRIAL SPACE

Suite #	Size	Term	Available
306	877 SF	Negotiable	Immediately
314	3,013 SF	Negotiable	Immediately
340	536 SF	Negotiable	Immediately
342	1,382 SF	Negotiable	Immediately
345	1,068 SF	Negotiable	Immediately
347	564 SF	Negotiable	Immediately

### CONTACT

#### JIE MING XIE

Vice President

Lic. RS-73904

**808-541-5154**

Jie.Xie@cbre.com

### VIRTUAL TOURS

314

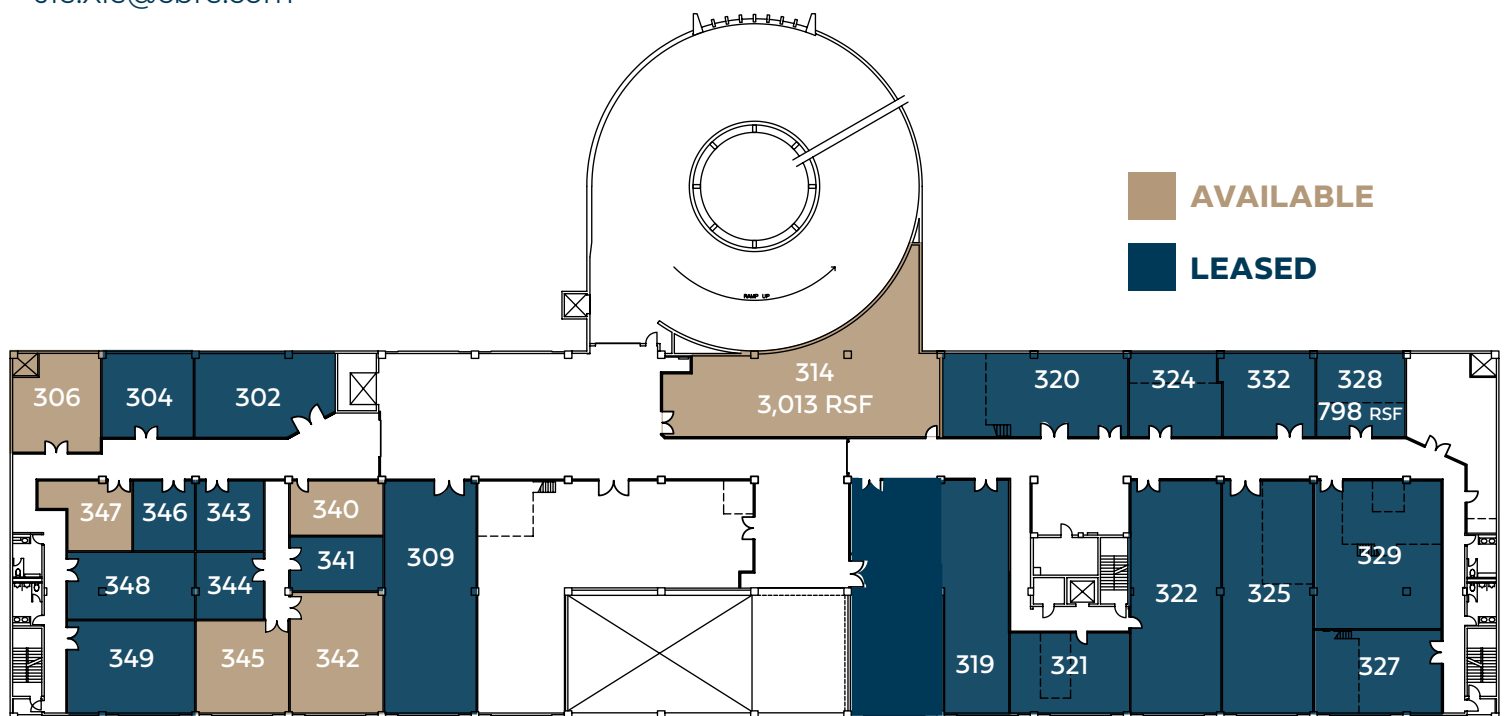

ALEXANDER & BALDWIN



cbre.com/hawaii

# FOR LEASE

## Kakaako Commerce Center

875 WAIMANU STREET, HONOLULU, HI 96813

FLOOR 5

### SUITE INFORMATION

- Street Front Access
- Air Conditioned
- Parking Available \$90/Month Per Stall
- Telecom Available
- Base Rent: \$1.20/SF per Month
- Cam: \$1.06/SF per Month  
(Includes Water/Sewer/Electric)

### INDUSTRIAL SPACE

Suite #	Size	Term	Available
503	744 SF	Negotiable	Immediately

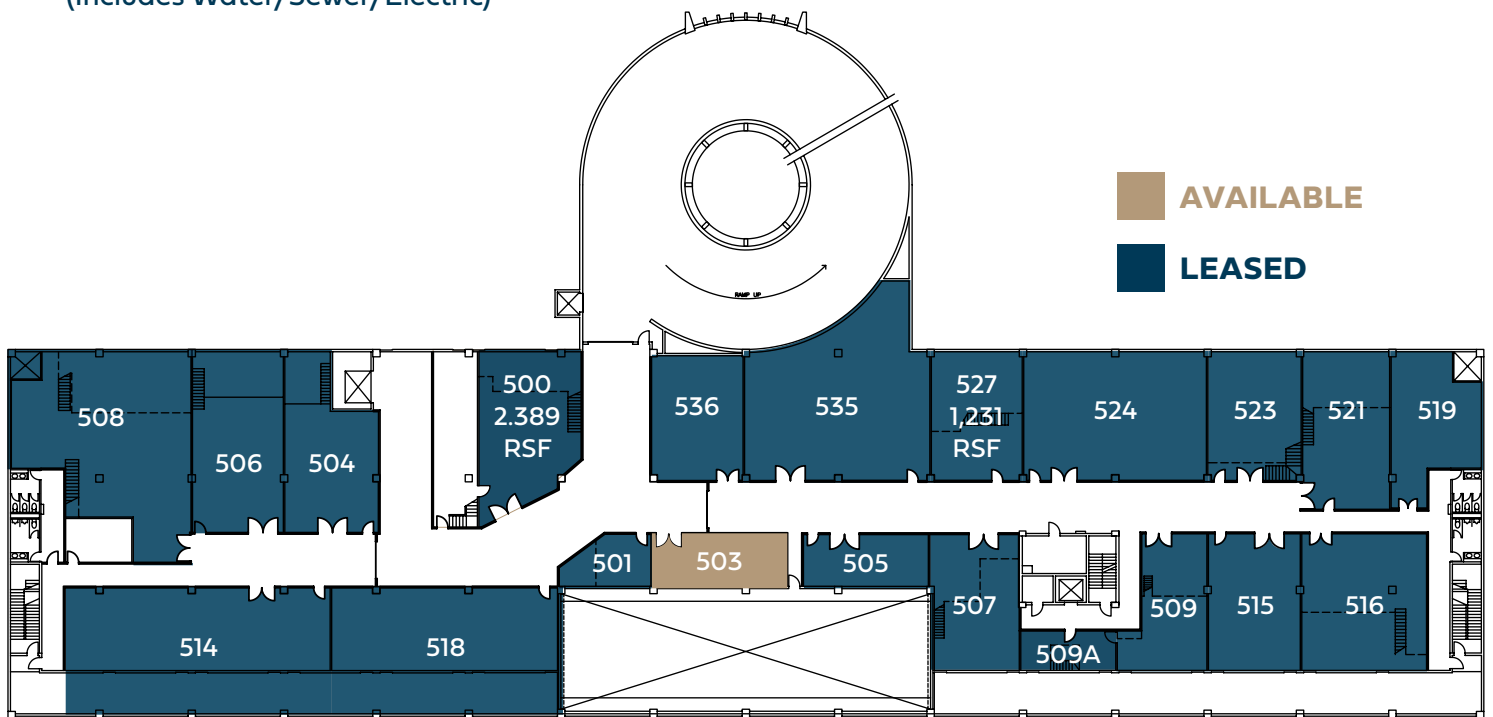

### CONTACT

#### JIE MING XIE

Vice President

Lic. RS-73904

**808-541-5154**

Jie.Xie@cbre.com



ALEXANDER & BALDWIN



[cbre.com/hawaii](https://cbre.com/hawaii)