

*J.B. Parrish, Inc.*

**1066 41<sup>st</sup> Ave #105**  
(SUITE #105 HIGHLIGHTED)



**FUTURE RAIL  
TRAIL**

**FOR SALE**  
**COMMERICAL CONDOMINIUM**  
**41<sup>ST</sup> AVE - ADJACENT TO RAIL TRAIL**

## TABLE OF CONTENTS

03	Executive Summary
05	Property Photos
06	Location Map
07	Site Plan
08	Disclaimer

---

## EXCLUSIVELY LISTED BY

Carol Lezin | DRE #00878937  
831-247-2610

---

**JR Parrish, Inc.**  
**Commerical Real Estate**

*JR Parrish, Inc.*



## EXECUTIVE SUMMARY

1066 41st Ave #105

APN: 034-711-01

---

## LISTING PRICE

\$685,000

---



BUILDING  
+/- 900 SF



PARCEL SIZE  
+/- 900 SF



ZONING  
PD

## PROPERTY DESCRIPTION

Currently improved and ready to reopen as a retail take-out food and to-go juice bar.

Awesome location adjacent to the future Rail Trail, with outdoor seating and plenty of parking.

Convert to an office for a trendy small office located on the Rail Trail.

---

## ADDITIONAL FEATURES

- Tons of Onsite Parking
- Ceiling Height of 10<sup>FT</sup>
- Polished Concrete Flooring
- Zoned PD/planned Development
- Vacant and Ready to Occupy

1066 41<sup>ST</sup> AVE

## PROPERTY DETAILS

APN 034-711-01

---

Address 1066 41<sup>st</sup> Ave #105

---

County Santa Cruz

---

Market Bay Area

---

SubMarket Santa Cruz County

---

Building Size +/- 900 SF

---

Land Acres +/- 900 SF

---

Ownership Type Fee Simple

## PROPERTY FEATURES

Number of Parcels 1

---

Zoning Type P D

---

Number of Stories 1

---

Parking Ratio 19 Shared

## FINANCIAL SUMMARY

Offering Price \$685,000

1066 41<sup>ST</sup> AVE

EXTERIOR PHOTO



# LOCATION MAP

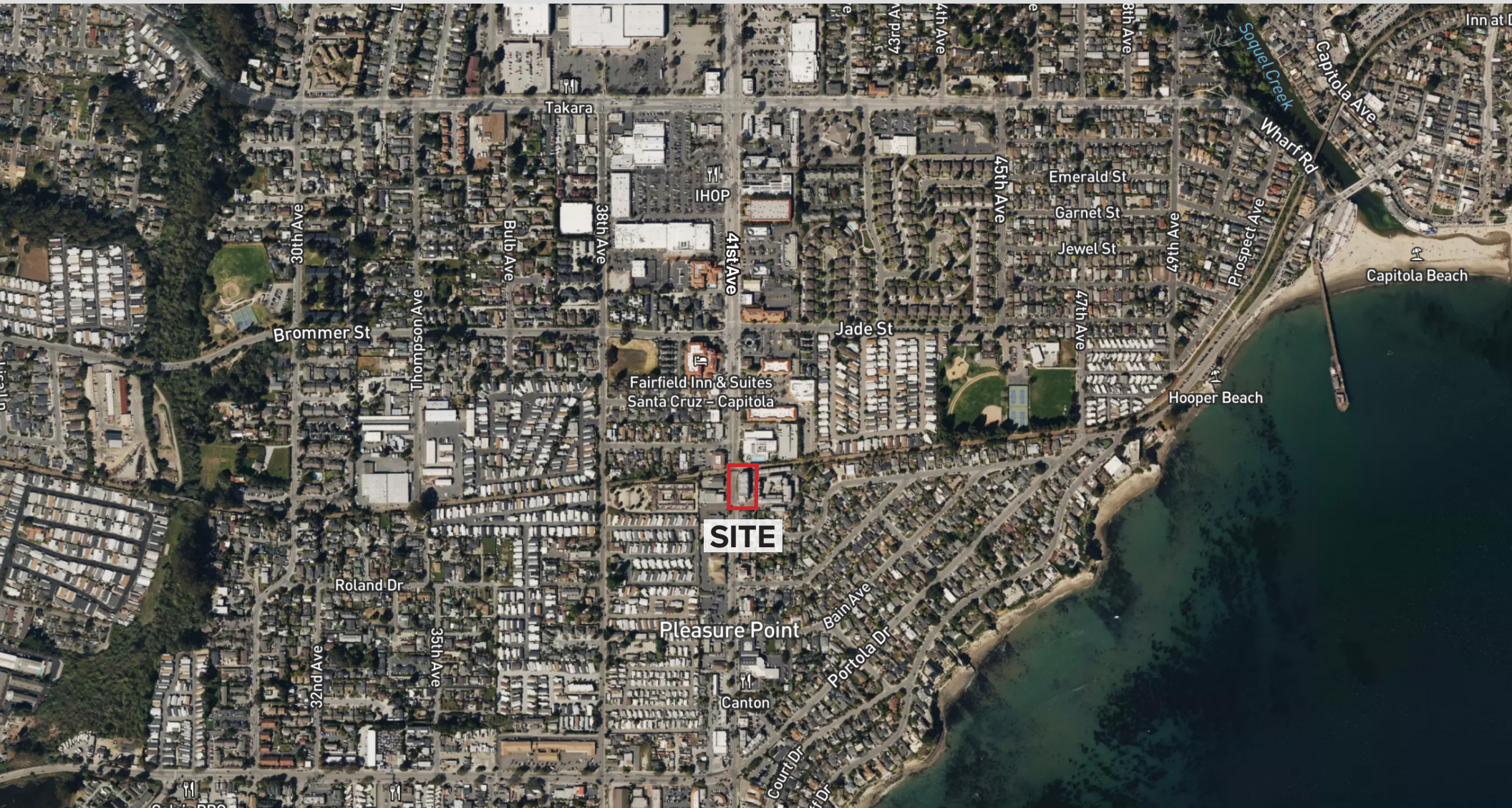

# SITE PLAN

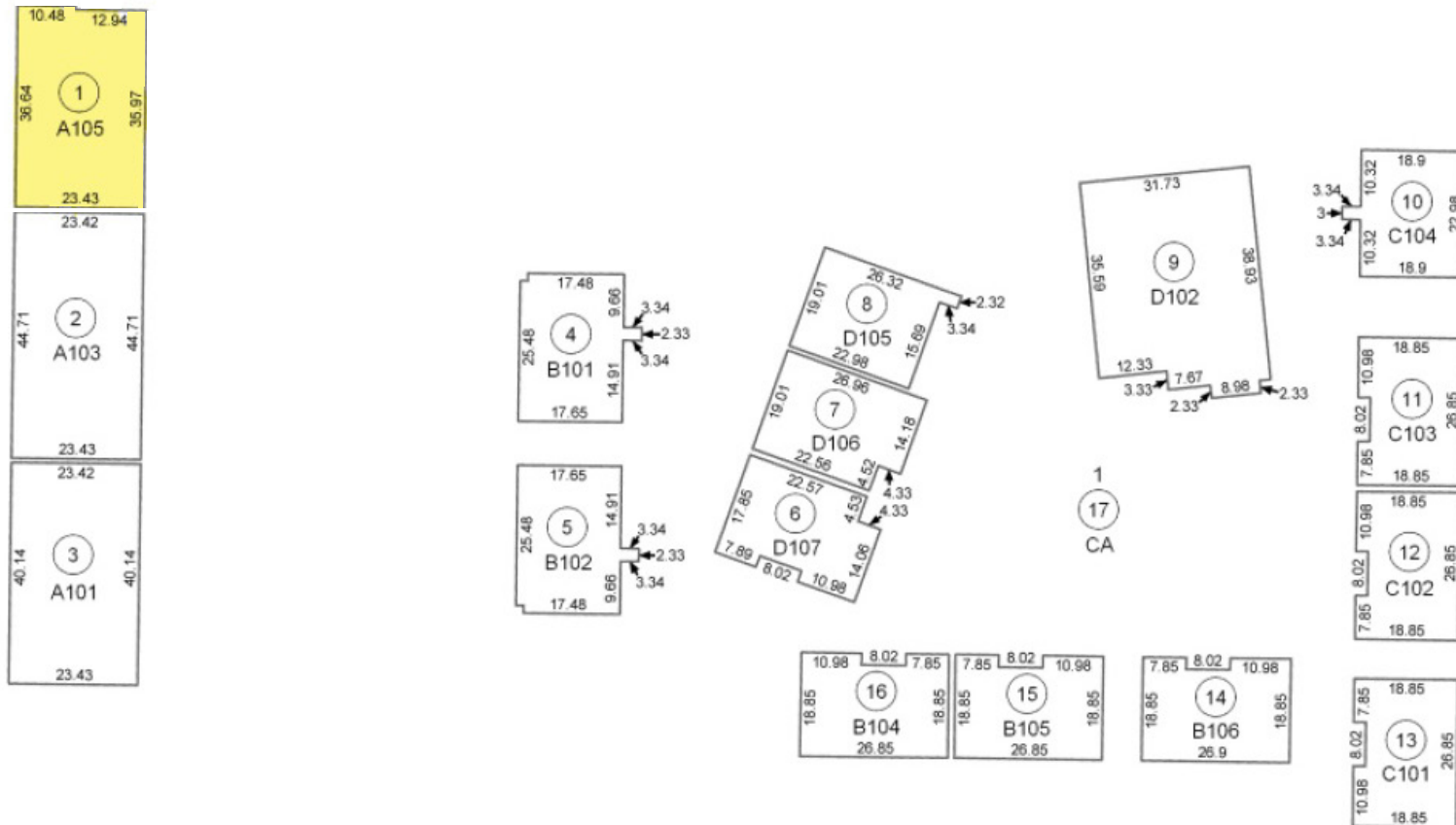

# DISCLAIMER

JR Parrish, Inc (JRP) hereby advises all prospective purchasers of property as follows:

All materials and information received or derived from JRP and its directors, officers, agents, advisors, affiliates and or any third party sources are provided without representation or warranty as to completeness, veracity, or accuracy, condition of the property, compliance or lack of compliance with applicable governmental requirements, developability or suitability, financial performance of the property, projected financial performance of the property for any party's intended use or any and all other matters. Neither JRP and its directors, officers, agents, advisors, or affiliates makes any representation or warranty, express or implied, as to accuracy or completeness of the any materials or information provided, derived, or received. Materials and information from any source, whether written or verbal, that may be furnished for review are not a substitute for a party's active conduct of its own due diligence to determine these and other matters of significance to such party. JRP will not investigate or verify any such matters or conduct due diligence for a party unless otherwise agreed in writing.

EACH PARTY SHALL CONDUCT ITS OWN INDEPENDENT INVESTIGATION AND DUE DILIGENCE. Any party contemplating or under contract or in escrow for a transaction is urged to verify all information and to conduct their own inspections and investigations including through appropriate third party independent professionals selected by such party.

## EXCLUSIVELY LISTED BY

---

Carol Lezin | DRE #00878937  
831-247-2610

The logo for J.R. Parrish, Inc. is written in a stylized, cursive script. The letters are black and have a fluid, handwritten appearance. The 'J' and 'R' are particularly large and prominent, with the 'Parrish, Inc.' following in a smaller, similar script.