

Property for Sale | New Development

700 Eastgate South Drive, Cincinnati, OH 45245

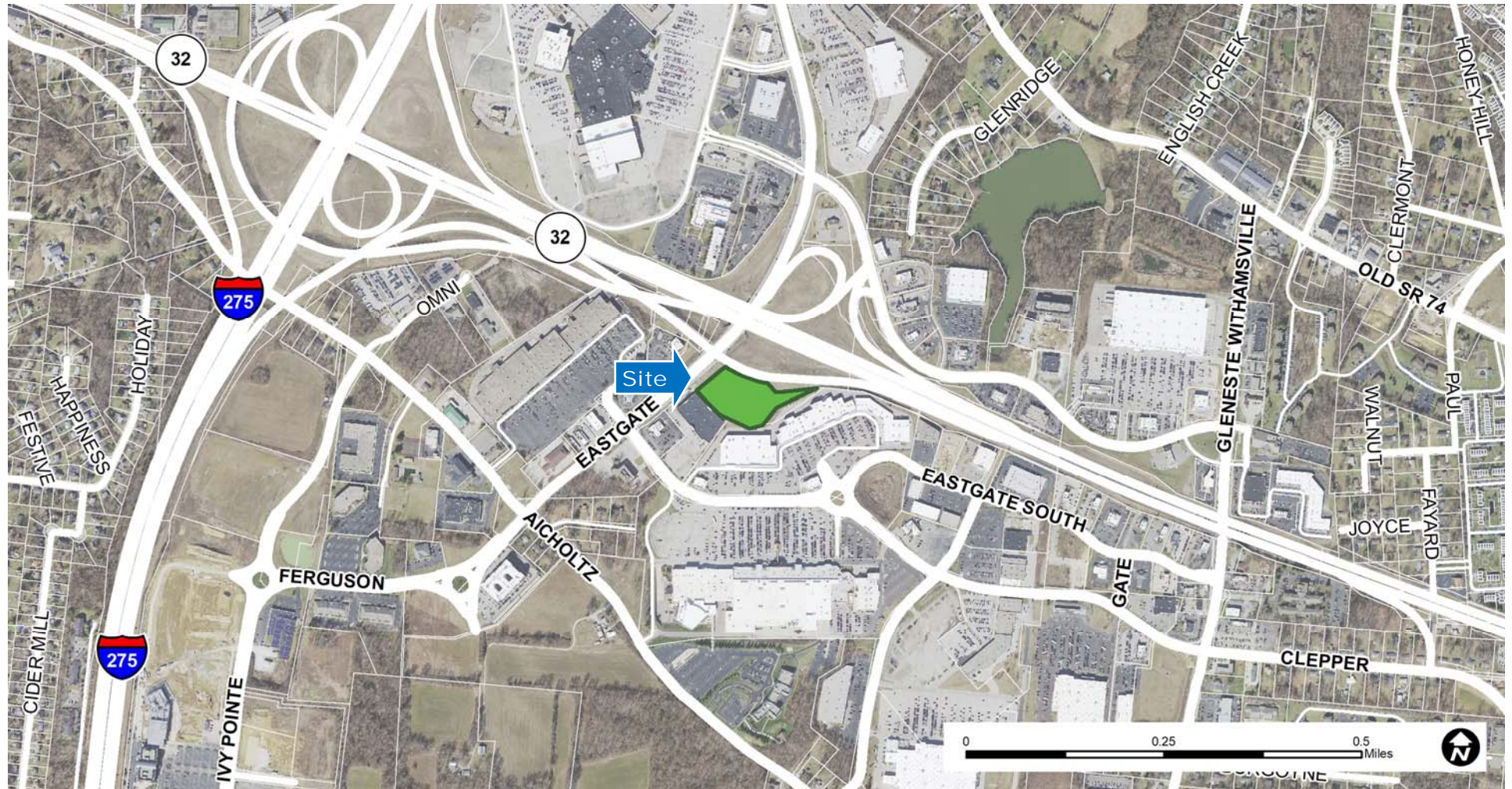

Site Vicinity Map



Mark McCormack

Development Director

MMcCormack@utclermont.gov

513.947.7323

Cory Wright

Township Administrator

CWright@utclermont.gov

513.752.1471

Information 3.34 Acres

Potential Uses (Zoned B-1)
Commercial, Restaurant, Hotel,
Institutional, Entertainment

Population

Union Township: 50,480

Clermont County: 211,972

Access

High visibility to SR-32

Distance to I-275— 1.4 Miles

Distance to SR-32 - 0.8 Miles

Property for Sale | New Development

700 Eastgate South Drive, Cincinnati, OH 45245



Zoning Map

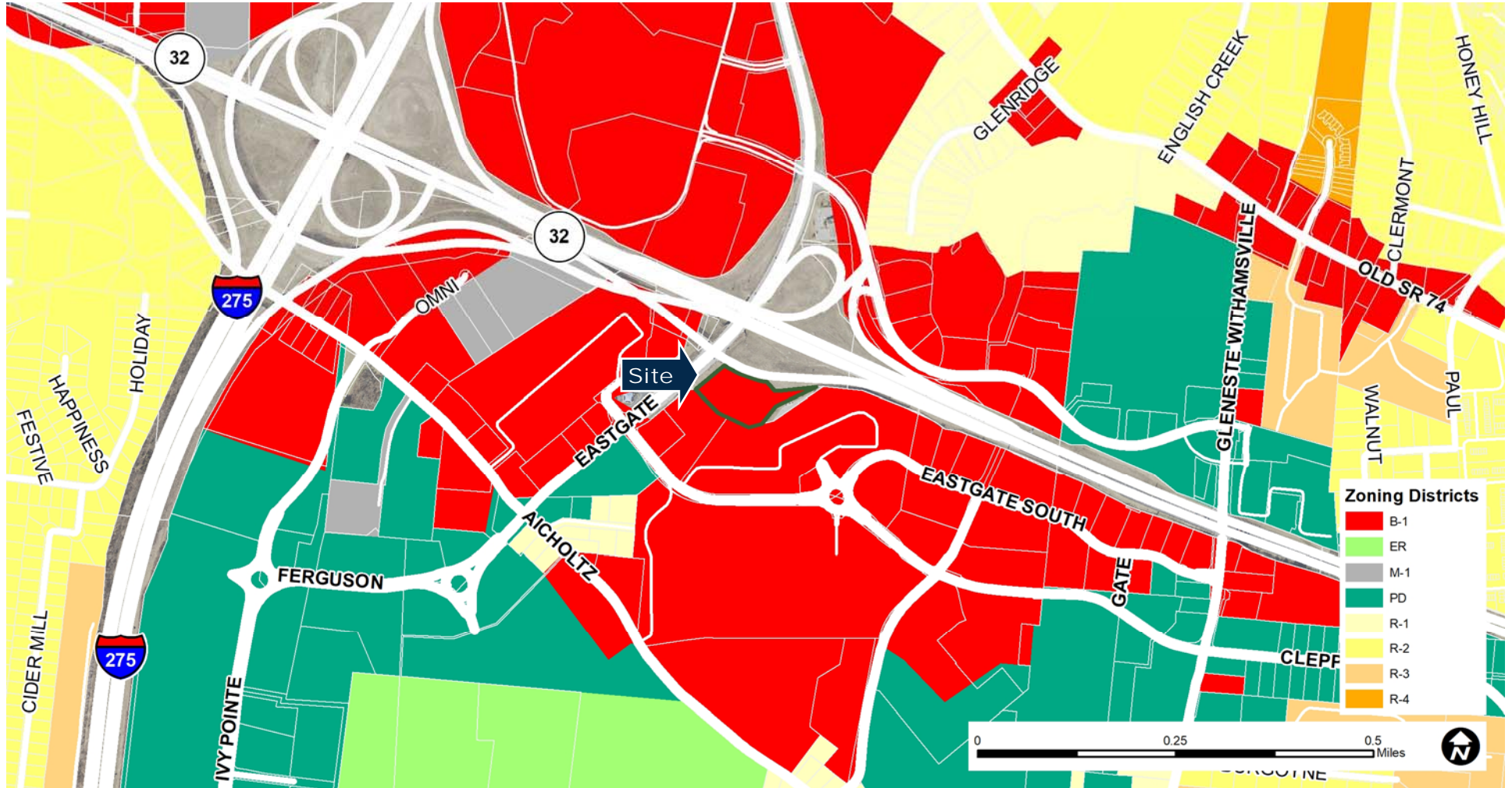

Mark McCormack

Development Director

MMcCormack@utclermont.gov

513.947.7323

Cory Wright

Township Administrator

CWright@utclermont.gov

513.752.1471

Information 3.34 Acres

Potential Uses (Zoned B-1)
Commercial, Restaurant, Hotel,
Institutional, Entertainment

Property for Sale | New Development

700 Eastgate South Drive, Cincinnati, OH 45245



Site Map

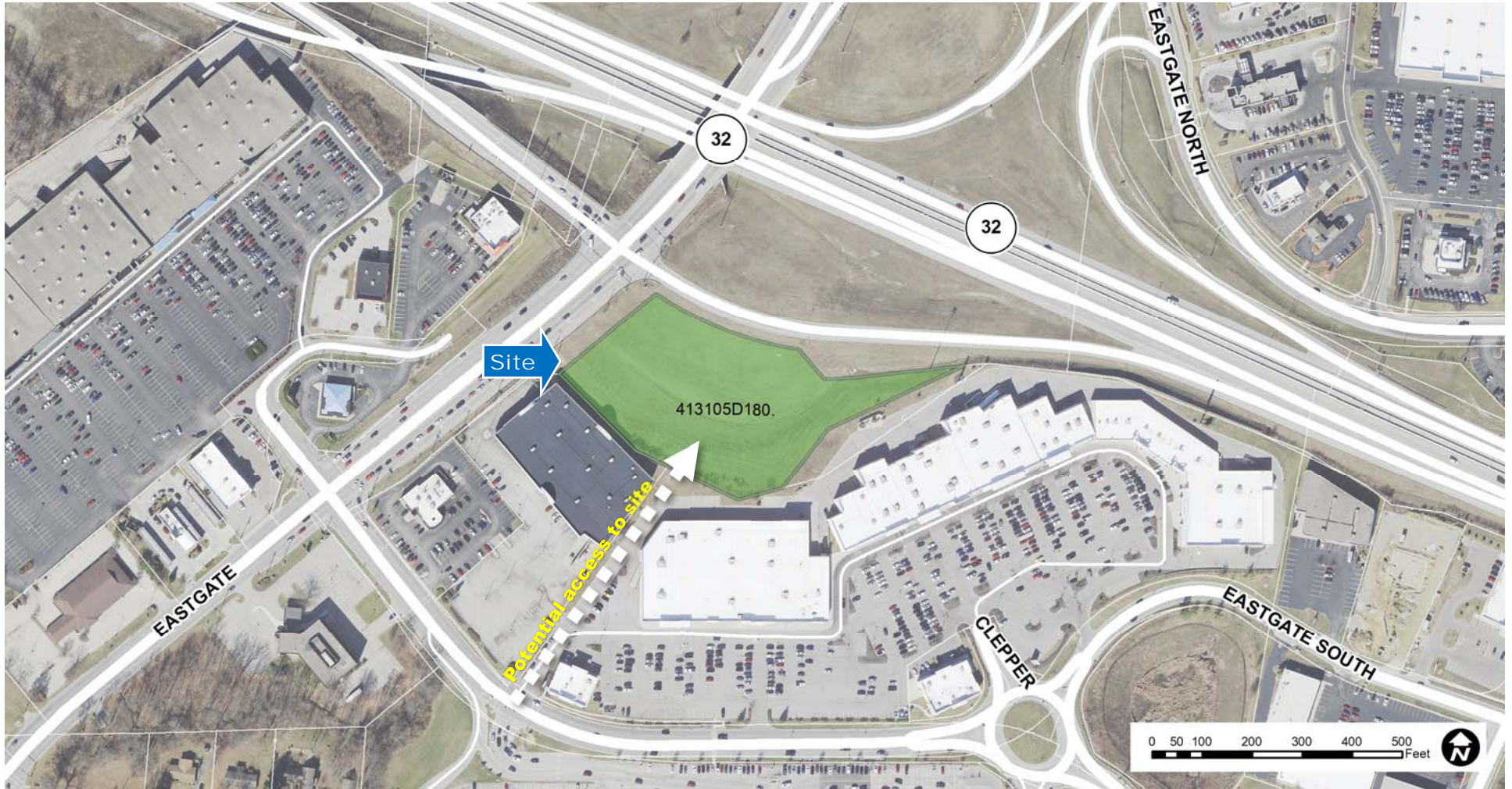

Mark McCormack

Development Director

MMcCormack@utclermont.gov

513.947.7323

Cory Wright

Township Administrator

CWright@utclermont.gov

513.752.1471

Information 3.34 Acres

Potential Uses (Zoned B-1)
Commercial, Restaurant, Hotel,
Institutional, Entertainment

Population

Union Township: 50,480

Clermont County: 211,972

Access

High visibility to SR-32

Distance to I-275— 1.4 Miles

Distance to SR-32 - 0.8 Miles

Property for Sale | New Development

700 Eastgate South Drive, Cincinnati, OH 45245



Eastgate Area Business Map



Mark McCormack

Development Director

MMcCormack@utclermont.gov

513.947.7323

Cory Wright

Township Administrator

CWright@utclermont.gov

513.752.1471

Access

High visibility to SR-32

Distance to I-275— 1.4 Miles

Distance to SR-32 - 0.8 Miles

Average Daily Traffic Counts

I-275 — 78,200

SR-32 — 31,650

Eastgate S Dr — 5,850

Eastgate Blvd — 15,700

Clepper Dr — 4,350

Eastgate Square Dr—5,650

Property for Sale | New Development

700 Eastgate South Drive, Cincinnati, OH 45245



Pictures of the Site



Mark McCormack

Development Director

MMcCormack@utclermont.gov

513.947.7323

Cory Wright

Township Administrator

CWright@utclermont.gov

513.752.1471

Information 3.34 Acres

Potential Uses (Zoned B-1)
Commercial, Restaurant, Hotel,
Institutional, Entertainment

Population

Union Township: 50,480

Clermont County: 211,972

Access

High visibility to SR-32

Distance to I-275— 1.4 Miles

Distance to SR-32 - 0.8 Miles

Property for Sale | New Development

700 Eastgate South Drive, Cincinnati, OH 45245



Pictures of the Site



Mark McCormack

Development Director

MMcCormack@utclermont.gov

513.947.7323

Cory Wright

Township Administrator

CWright@utclermont.gov

513.752.1471

Information 3.34 Acres

Potential Uses (Zoned B-1)
Commercial, Restaurant, Hotel,
Institutional, Entertainment

Population

Union Township: 50,480

Clermont County: 211,972

Access

High visibility to SR-32

Distance to I-275— 1.4 Miles

Distance to SR-32 - 0.8 Miles