

# FIRST CLASS OFFICE SPACE FOR LEASE

5301 Shawnee Road  
Alexandria, Virginia



- 5,600 SF available-*divisible 2,000 SF and greater*
- Modern build-out with recent upgrades
- Direct view of streams and park that offers walking trails
- Covered garage parking
- Balcony with outdoor seating
- Competitive rent
- Granite atrium, lobby, & bathrooms



- Prominent well-landscaped 2.45-acre site
- Responsive Ownership & Property Management provided by Cafferty Commercial Real Estate Services
- Blue reflective windows provide cost savings
- Immediate access to I-395, I-495 & I-95
- Loading dock with leveler

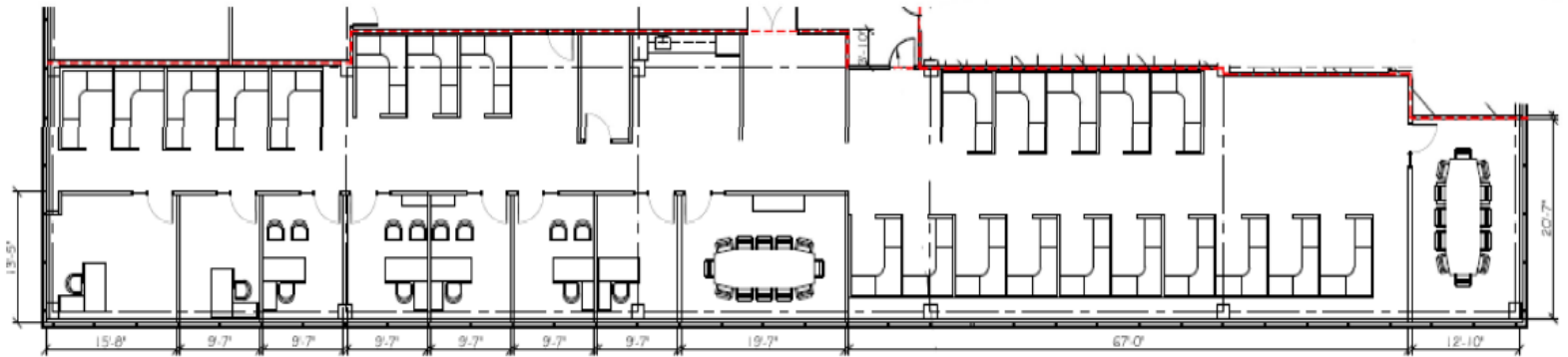

Leasing Contact:  
Tom Cafferty, CRE, SIOR  
(703) 517-5804  
[TDCAfferty@caffertycommercial.com](mailto:TDCAfferty@caffertycommercial.com)