

FOR LEASE

Owned and Operated by  LINK

# 535 Getty Court

Suites A-D | Benicia, Ca | Available Immediately

±28,224 SF



**LEASING INFO  
& CONTACT**

Tony Binswanger, SIOR	+1 925 296 7728   <a href="mailto:tony.binswanger@cbre.com">tony.binswanger@cbre.com</a>
Brooks Pedder, SIOR	+1 925 296 7729   <a href="mailto:brooks.pedder@cbre.com">brooks.pedder@cbre.com</a>
Bo Harkins	+1 925 296 7727   <a href="mailto:bo.harkins@cbre.com">bo.harkins@cbre.com</a>

**CBRE**

This is not an offer or acceptance of an offer to lease space. A lease will only be offered or made in a written agreement signed by landlord. No representation or warranty of any kind is made by landlord unless set forth in a written definitive lease executed by the landlord.



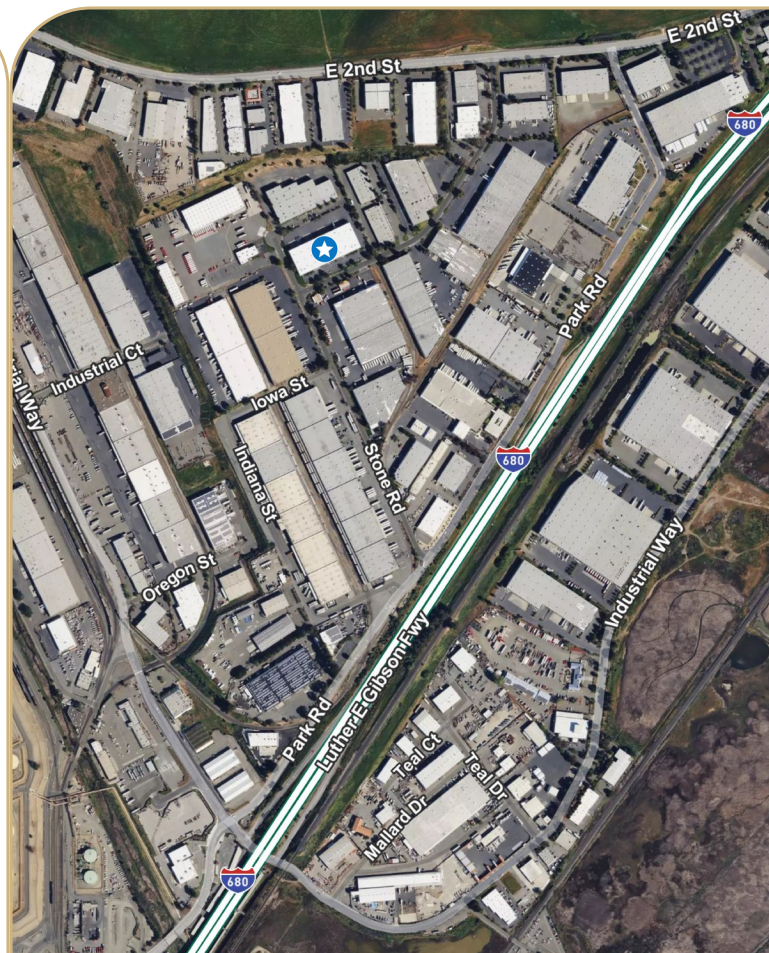
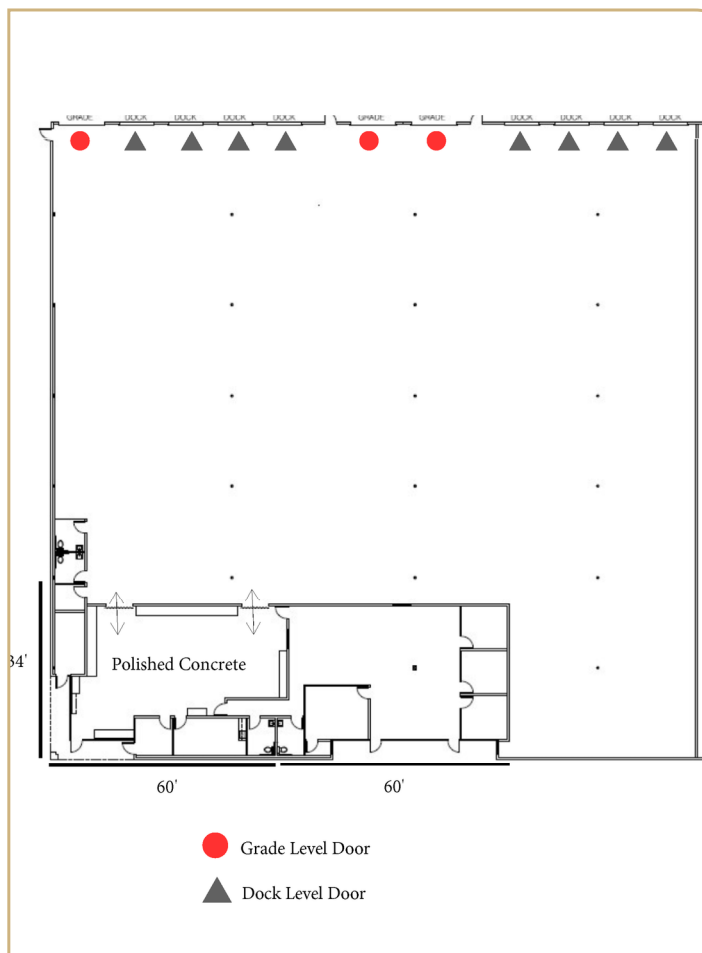

## PROPERTY HIGHLIGHTS

- ±28,224 SF
- Dimensions: ±168' W x ±168' D

### Office Features

- ±4,200 SF
- Reception
- Breakroom
- Four (4) Restrooms total (Two serving office, Two serving warehouse)
- Multiple Private Offices
- Bullpen Area

### Warehouse Features

- ±24,024 SF
- Loading: Eight (8) Dock-high doors (9' x 10')
- Three (3) grade-level doors (12'x14')
- Clear Height: ±24' min
- Column Spacing: ±24' x ±48'
- Sprinklered: .495/2,000 gpm
- Power: ±400 amps@277/480 (to be verified)
- Concrete tilt-up construction
- Insulated Warehouse
- LED lighting throughout

### Lease Rate

- Call Broker

## CONTACT

Tony Binswanger, SIOR  
Executive Vice President  
+1 925 296 7728  
tony.binswanger@cbre.com  
Lic. 01861701

Bo Harkins  
First Vice President  
+1 925 296 7727  
bo.harkins@cbre.com  
Lic. 01943785

Brooks Pedder, SIOR  
Vice Chair  
+1 925 296 7729  
brooks.pedder@cbre.com  
Lic. 00902154

CBRE, Inc  
1676 N California Blvd  
Suite 500  
Walnut Creek, CA 94596  
www.cbre.com/walnutcreek  
Lic. 00409987