

Colliers

PACIFIC DOOR & FRAME
Cal West Materials

For Lease

7016 Motz Street, Paramount, CA

Property Highlights

- Part of Larger 20,000 SF Free Standing Building
- Secured, Attractive Business Park Setting
- High Clearance, Excellent Truck Circulation
- Convenient Access to 710, 91, 105 Freeways

Building Features

- 50' x 100' Configuration
- +/-800 SF Modern Office Area
- 20' Ceiling Height
- T-5 Energy Efficient Lighting
- 100 Amps, 240 Volts, 3 Phase, 4 Wire
- 14' x 14' Grade Level Door
- Dock High Loading via Shared Loading Dock

Aerial



Riley Heaton

Senior Associate

License No. 02002525

+1 323 278 3118

riley.heaton@colliers.com

Colliers

865 S Figueroa Street

Suite 3500

Los Angeles, CA 90017

7016 Motz Street, Paramount, CA

Site Plan

.0'00L

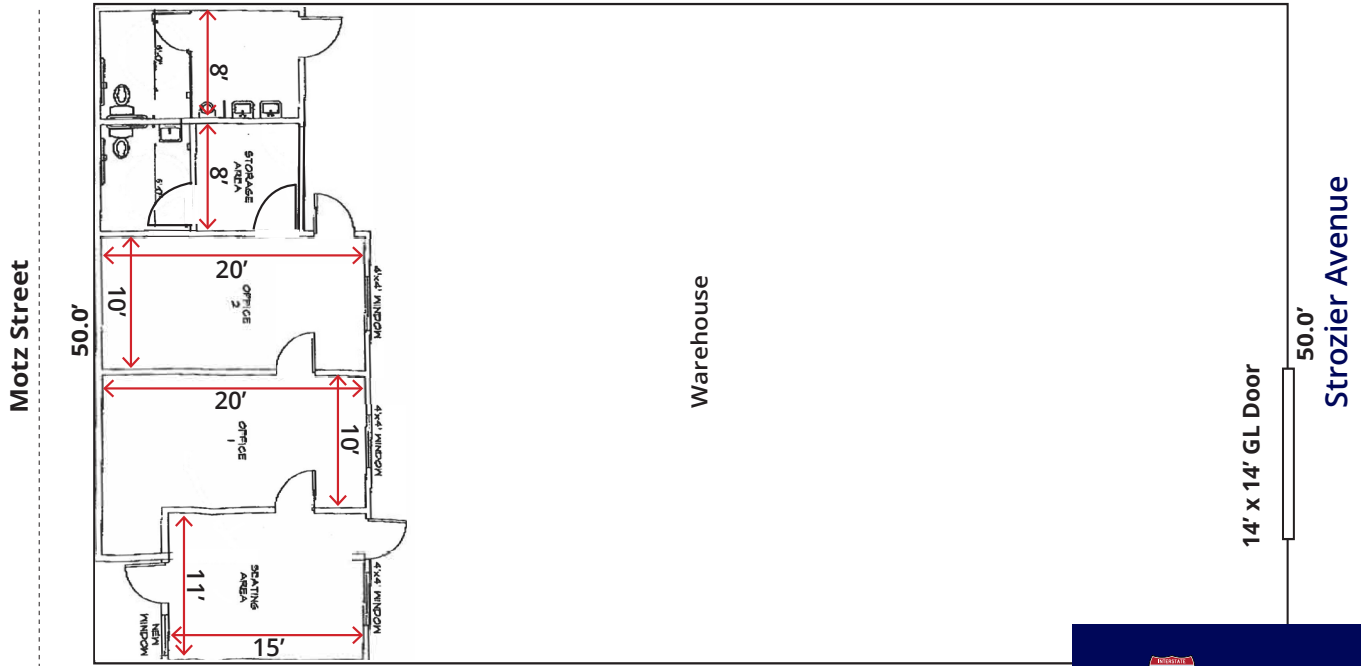

.0'00L

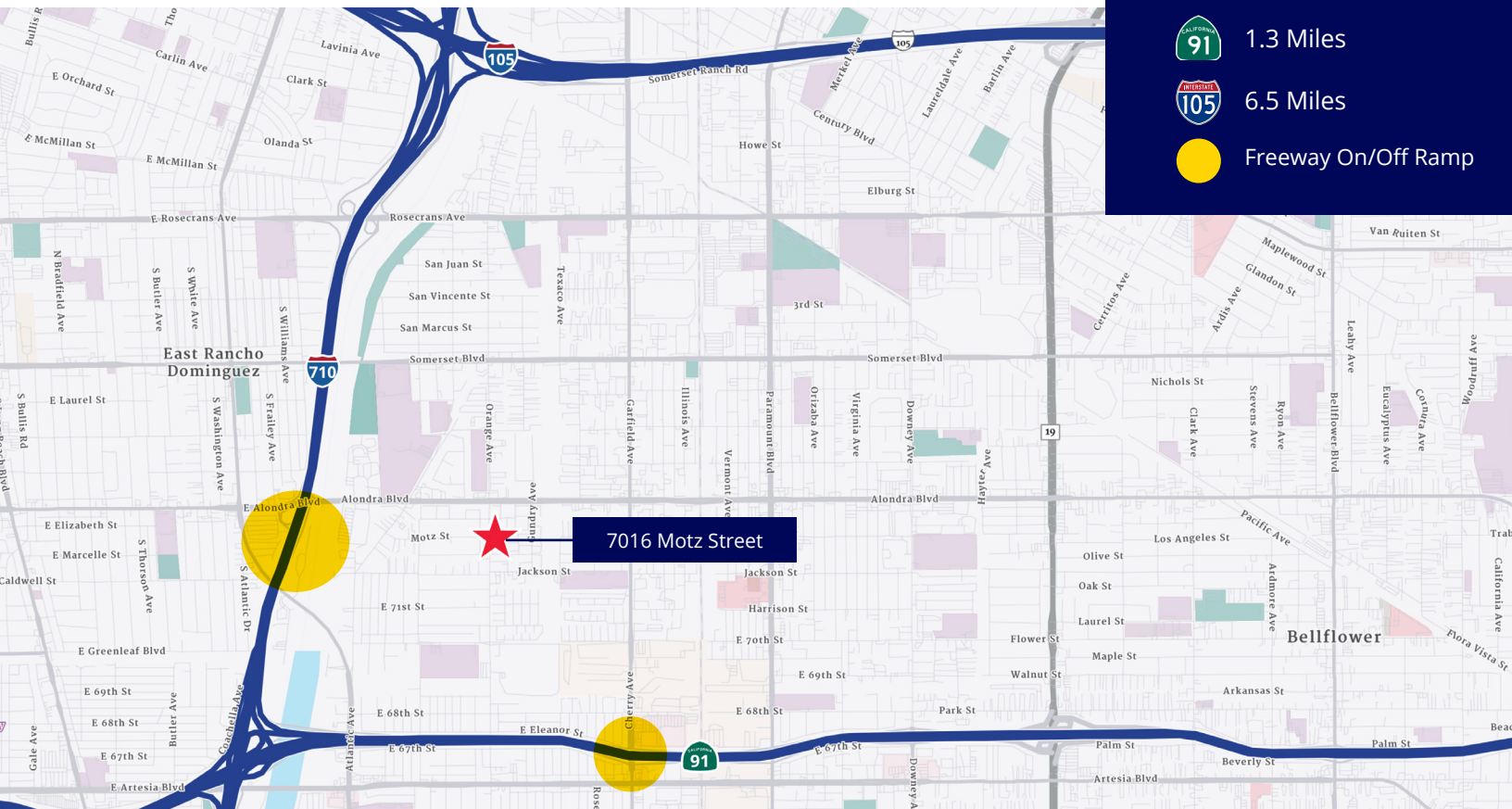

Riley Heaton
 Senior Associate
 License No. 02002525
 +1 323 278 3118
 riley.heaton@colliers.com

