

# FOR SALE

±12,545 SF INDUSTRIAL BUILDING

3220-3226 Pendleton Ave, Santa Ana, CA



## PROPERTY FEATURES

- ± 12,545 SF Freestanding Building
- ± 24,394 SF Lot Size
- 17' Clear Height
- 6 Ground Level Doors
- 400 Amps of Power / 3 Phase (Verify)
- Fenced Yard
- Single Tenant or Multi-Tenant Building

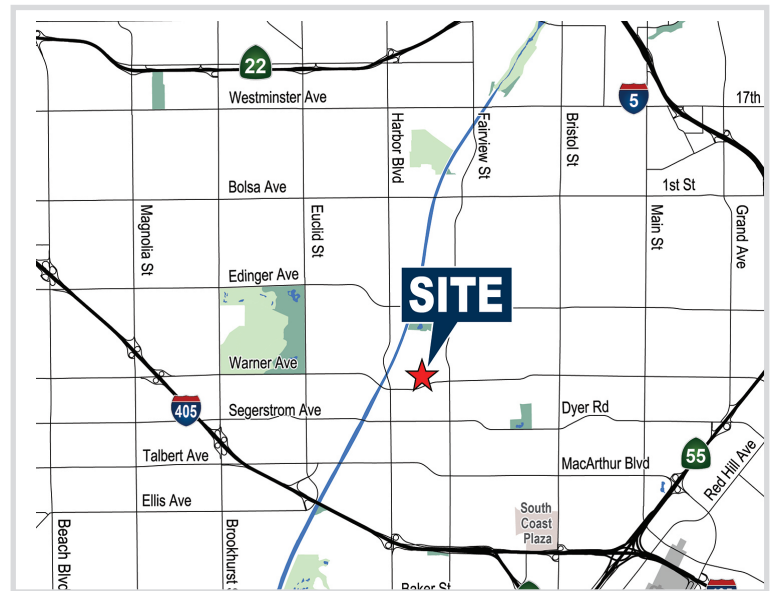

**STAN KWAK**  
Senior VP | Partner  
Lic. #01824776  
(714) 935-2327  
skwak@voitco.com

**SELDEN MCKNIGHT**  
Vice President | Partner  
Lic. #02027919  
(714) 935-2323  
smcknight@voitco.com

**JORDAN HAYNES**  
Associate  
Lic. #02083655  
(714) 935-2329  
jhaynes@voitco.com

**Voit**  
REAL ESTATE SERVICES

**CLIENT**  
RESOURCE GROUP

2400 E. Katella Avenue, Suite 750  
Anaheim, CA 92806  
www.VoitCo.com

# FOR SALE

±12,545 SF INDUSTRIAL BUILDING

3220-3226 Pendleton Ave, Santa Ana, CA

## SITE PLAN

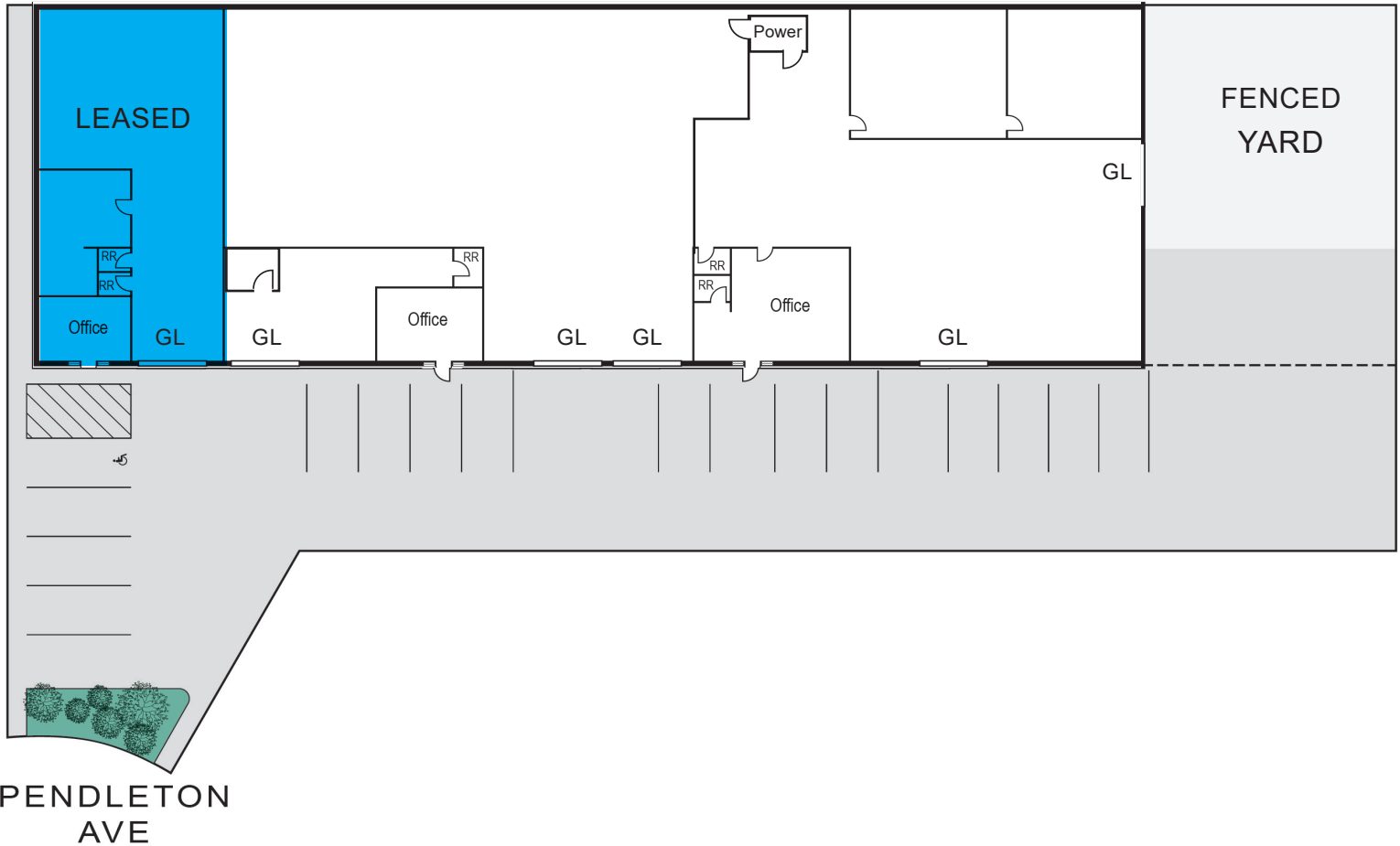

Note: Drawing not to scale. Measurements and sizes are approximate and are subject to change.

**STAN KWAK**  
Senior VP | Partner  
Lic. #01824776  
(714) 935-2327  
skwak@voitco.com

**SELDEN MCKNIGHT**  
Vice President | Partner  
Lic. #02027919  
(714) 935-2323  
smcknight@voitco.com

**JORDAN HAYNES**  
Associate  
Lic. #02083655  
(714) 935-2329  
jhaynes@voitco.com

**Voit**  
REAL ESTATE SERVICES | **CLIENT**  
RESOURCE GROUP  
2400 E. Katella Avenue, Suite 750  
Anaheim, CA 92806  
www.VoitCo.com