

# FOR LEASE

## CONTRACTOR'S STORAGE YARD, OFFICES AND WAREHOUSES

1731 Leslie Street, San Mateo, CA 94402



### Property Highlights

- Asking Rent: \$8,500 Per Month Gross
- Total Building Size: ±4,300 SF
  - Office: ±550 SF
  - Shop: ±1,400 SF
  - Warehouse: ±950 SF
  - Detached Dock High Warehouse: ±1,400 SF
- Trailer: ±320 SF (40' x 8')
- Lot Size: ±12,922 SF
  - Fully Secured Yard with Gate: ±8,200 SF
- Drive-Ins: 1 Total (10'w x 11'h)
- 3 Phase Heavy Power
- Air Compressor
- Grade-level and Dock Loading
- Zoning: M1 (District Manufacturing) & TOD/H (Transit Oriented Development / Housing Opportunities Overlay)



[M1 Zoning Info](#)



[TOD/H Zoning Info](#)

### Contact Agents for More Details



**ANDREW PECEIMER**  
 Senior Commercial Real Estate Advisor  
 DRE # 00993289  
 M: 650.208.4971  
 O: 650.344.4300  
[apeceimer@cbc Burlingame.com](mailto:apeceimer@cbc Burlingame.com)



**GARRETT SWARTZ**  
 Commercial Real Estate Advisor  
 DRE # 02178894  
 M: 925.222-0933  
 O: 650.352.3302  
[gswartz@cbc Burlingame.com](mailto:gswartz@cbc Burlingame.com)



1575 Bayshore Highway, Suite 100,  
 Burlingame CA 94010



# FOR LEASE

## CONTRACTOR'S STORAGE YARD, OFFICES AND WAREHOUSES

1731 Leslie Street, San Mateo, CA 94402

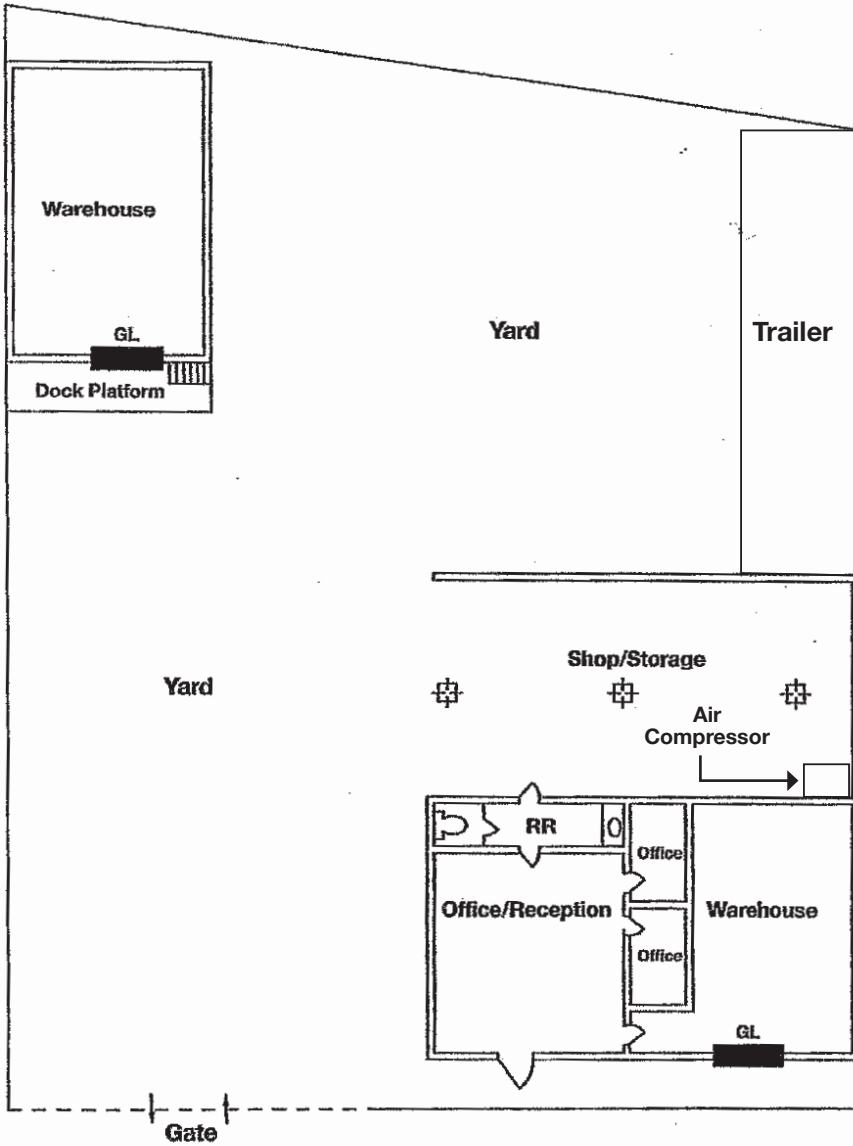

\*Not to Scale



Shop



Yard and Trailer

### Contact Agents for More Details



**ANDREW PECEIMER**  
 Senior Commercial Real Estate Advisor  
 DRE # 00993289  
 M: 650.208.4971  
 O: 650.344.4300  
[apeceimer@cbcburlingame.com](mailto:apeceimer@cbcburlingame.com)



**GARRETT SWARTZ**  
 Commercial Real Estate Advisor  
 DRE # 02178894  
 M: 925.222-0933  
 O: 650.352.3302  
[gswartz@cbcburlingame.com](mailto:gswartz@cbcburlingame.com)



1575 Bayshore Highway, Suite 100,  
 Burlingame CA 94010



©2024 Coldwell Banker Real Estate LLC, dba Coldwell Banker Commercial Westbay Real Estate Group. All rights reserved. Coldwell Banker Commercial® and the Coldwell Banker Commercial logo are registered service marks owned by Coldwell Banker Real Estate LLC. Coldwell Banker Real Estate LLC, dba Coldwell Banker Commercial Affiliates fully supports the principal of the Fair Housing Act and the Equal Opportunity Act. Each office is independently owned and operated. The information provided is deemed reliable, but it is not guaranteed to be accurate or complete, and it should not be relied upon as such. This information should be independently verified before any person enters into a transaction based upon it.