

18537 COLLIER AVENUE
LAKE ELSINORE, CA 92530

FOR SUBLEASE
±4,625 SF INDUSTRIAL BUILDING



FOR MORE INFORMATION, PLEASE CONTACT:

CAREY PASTOR | Senior Vice President

858.336.4666 | cpastor@cbcsocalgroup.com

CalDRE License # 01403298



COLDWELL BANKER
COMMERCIAL
SC

18537 COLLIER AVENUE
LAKE ELSINORE, CA 92530

FOR SUBLEASE
±4,625 SF INDUSTRIAL BUILDING



PROPERTY HIGHLIGHTS

- 4,625 SF Industrial Building
- Office improvements include reception area, 3 private office, 2 restrooms, open office area, and wet bar
- 16-18' warehouse clear height
- 1 – 12'w x 14'h roll up 2
- 2 man door in warehouse
- 400 Amp 120/208v electrical panel
- Shared yard space
- Master Lease Expires 10/31/26. Potential for longer / direct lease
- **Offered for sublease at \$6,136.00 per month**

18537 COLLIER AVENUE

LAKE ELSINORE, CA 92530

FOR SUBLEASE
±4,625 SF INDUSTRIAL BUILDING

FLOOR PLAN

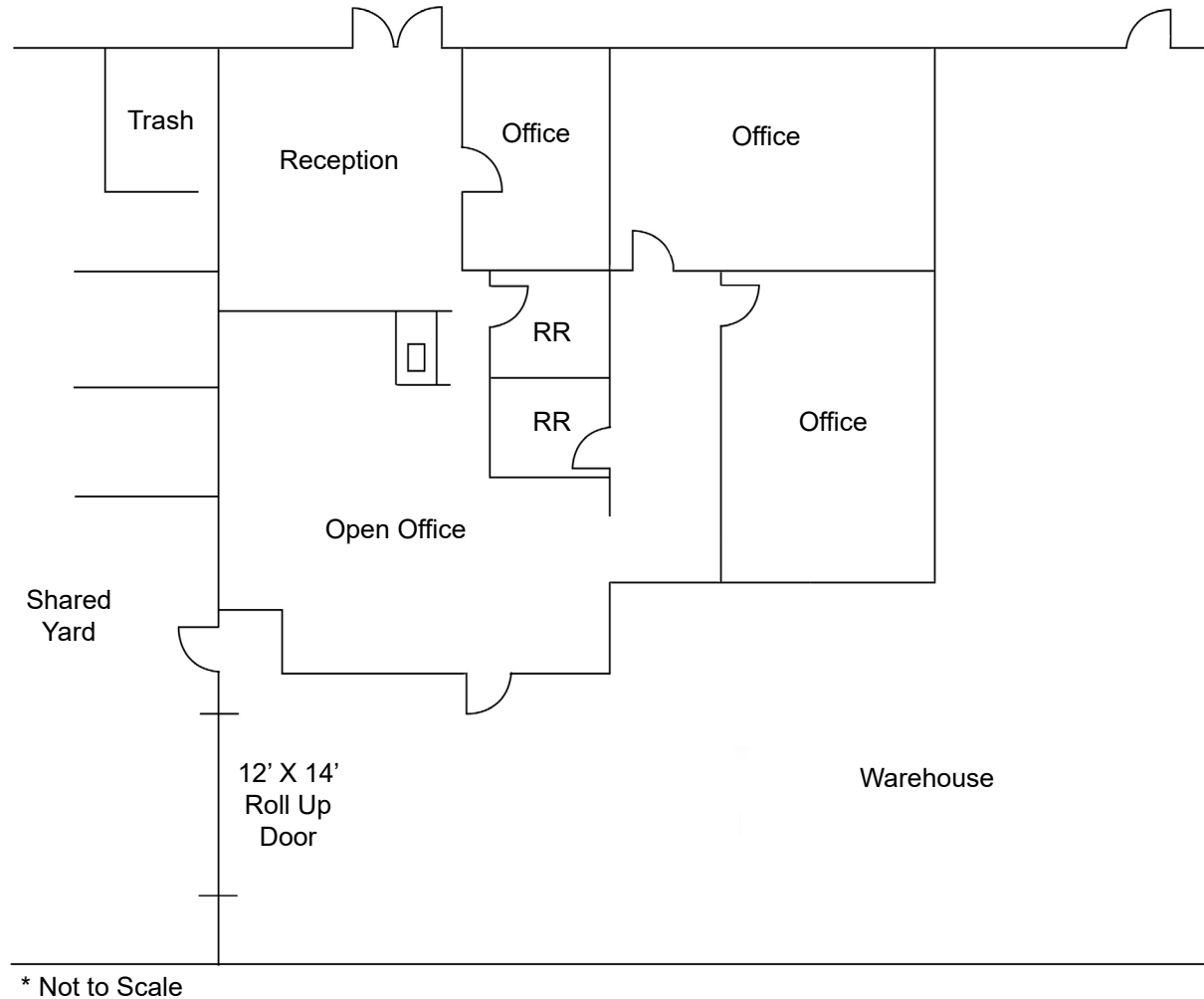

18537 COLLIER AVENUE

LAKE ELSINORE, CA 92530

FOR SUBLEASE
±4,625 SF INDUSTRIAL BUILDING



Coldwell Banker Commercial and the Coldwell Banker Commercial Logo are registered service marks licensed to Coldwell Banker Commercial Affiliates. Each Office is Independently Owned and Operated. All information contained herein has been obtained from sources deemed reliable. However, no warranty or guarantee is made as to the accuracy of the information.

CalDRE License # 02089395

18537 COLLIER AVENUE
LAKE ELSINORE, CA 92530

FOR SUBLEASE
±4,625 SF INDUSTRIAL BUILDING



FOR MORE INFORMATION, PLEASE CONTACT:

CAREY PASTOR
Senior Vice President
858.336.4666
cpastor@cbcsocalgroup.com
CalDRE # 01403298

27368 Via Industria | Suite 102
Temecula | California | 92590
t 951.200.7683 | f 951.755.1738
cbcsocalgroup.com



COLDWELL BANKER
COMMERCIAL
SC