

PROPOSED MEZZANINE PLAN

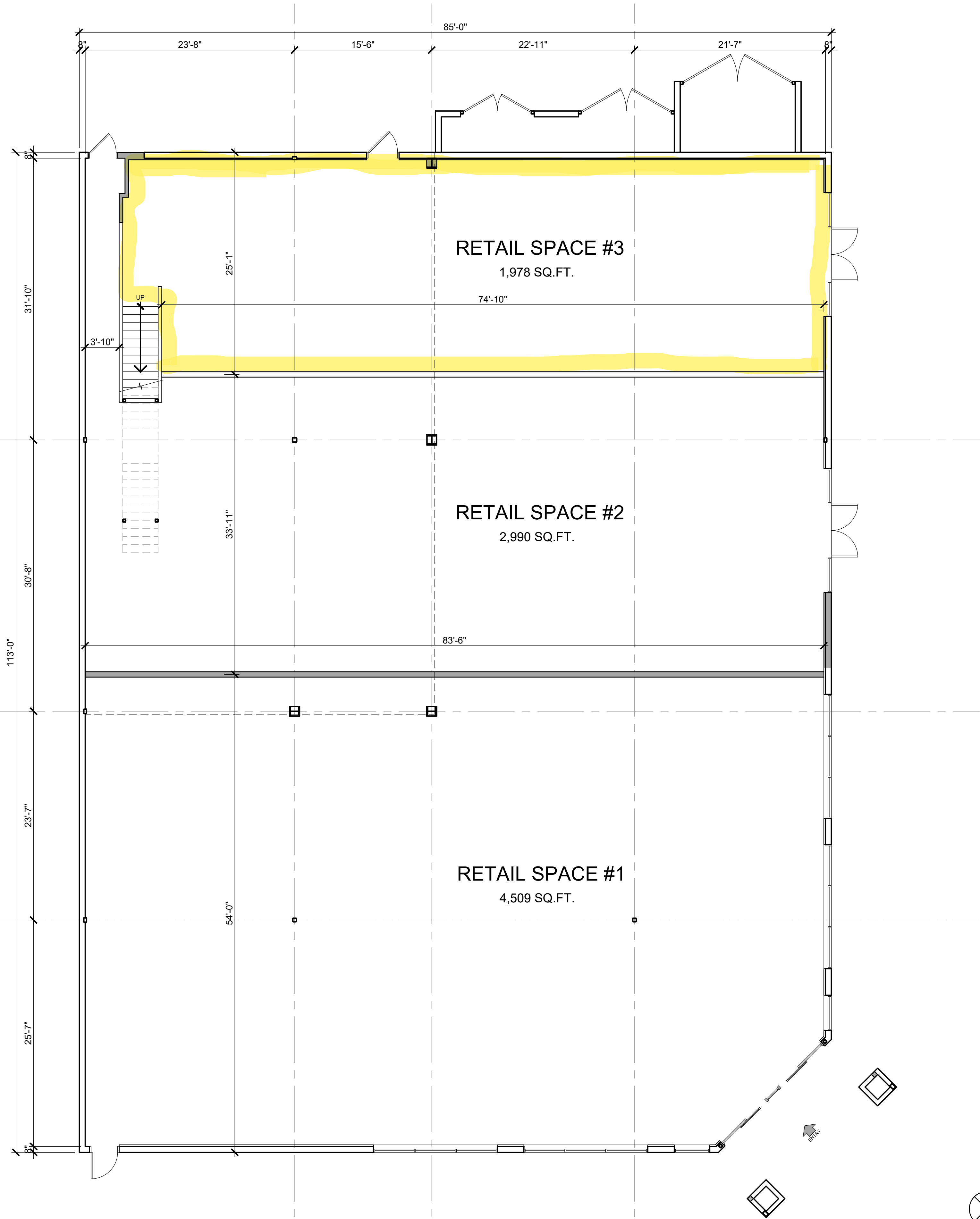

PROPOSED FLOOR PLAN



FIRESTONE CENTER
PROPERTIES, LLC
714 S PLYMOUTH BLVD.
LOS ANGELES, CA 90005

This plan and concept drawings are property of AMOR ARCHITECTURAL CORPORATION. This drawing is loaned without other consideration than the agreement and condition that it is not to be reproduced, copied, or otherwise disposed of, directly or indirectly, and is not to be used in whole or in part to assist in making or to furnish any information for the making of drawings, prints, apparatus or parts thereof. The acceptance of this drawing will be construed as an acceptance of the foregoing conditions and as an admission of the exclusive ownership of the plan and concept drawings of AMOR ARCHITECTURAL CORPORATION. This is a conceptual plan only and is subject to changes. AMOR ARCHITECTURAL CORPORATION makes no warranty nor representation to its accuracy.

PROPOSED LANDLORD SHELL IMPROVEMENT

9018-9020 FIRESTONE BLVD,
DOWNEY, CA 90241

A2429

2025.04.22

9431 HAVEN AVE, SUITE 212
RANCHO CUCAMONGA, CA 91730
909.259.9971 TEL.
909.944.8409 FAX.
www.AmorArch.com



A1.1