

**FOR SALE OR LEASE**  
**±40,800 SF ON ±5 ACRES**

**10500 S. HARLAN ROAD**  
**FRENCH CAMP, CA 95231**



**FOR MORE INFORMATION, PLEASE CONTACT:**

**STEVE DUNN**  
Senior Director  
+1 209 992 0953  
[steve.dunn@cushwake.com](mailto:steve.dunn@cushwake.com)

**TYSON VALLENARI**  
Executive Managing Director  
+1 510 919 2328  
[tyson.vallenari@cushwake.com](mailto:tyson.vallenari@cushwake.com)

3255 West March Lane  
Stockton, California 95219  
[cushmanwakefield.com](http://cushmanwakefield.com)



©2025 Cushman & Wakefield. All rights reserved. The information contained in this communication is strictly confidential. This information has been obtained from sources believed to be reliable but has not been verified. NO WARRANTY OR REPRESENTATION, EXPRESS OR IMPLIED, IS MADE AS TO THE CONDITION OF THE PROPERTY (OR PROPERTIES) REFERENCED HEREIN OR AS TO THE ACCURACY OR COMPLETENESS OF THE INFORMATION CONTAINED HEREIN, AND SAME IS SUBMITTED SUBJECT TO ERRORS, OMISSIONS, CHANGE OF PRICE, RENTAL OR OTHER CONDITIONS, WITHDRAWAL WITHOUT NOTICE, AND TO ANY SPECIAL LISTING CONDITIONS IMPOSED BY THE PROPERTY OWNER(S). ANY PROJECTIONS, OPINIONS OR ESTIMATES ARE SUBJECT TO UNCERTAINTY AND DO NOT SIGNIFY CURRENT OR FUTURE PROPERTY PERFORMANCE.



# PROPERTY HIGHLIGHTS

**OFFICE:** ±28,800 SF  
**SHOP:** ±8,000 SF  
**COVERED STORAGE:** ±4,000 SF

Zoned Industrial General (I-G)

Great I-5 Freeway Visibility & Access  
More than 100,000 Vehicles Per Day

Large Paved & Fenced Yard

Excellent Owner/User or Multiple Tenant Investment Property

Office furniture, cubicles and other items  
may be available with purchase or lease



# BUILDING HIGHLIGHTS

**Office Building  $\pm 28,800$  SF ( $\pm 14,400$  SF per Floor)**

2 Story with elevator and multiple entrances

Can be demised into smaller multi-tenant office areas

Multiple Breakrooms, Restrooms, Private Offices, Conference Rooms and Training Rooms on each floor and throughout the building





# BUILDING HIGHLIGHTS

## Shop Building ±8,000 SF Plus 300 SF Shop Office in Back

Ceiling/Clear Height ±20' to ±22'

7 Grade Level Roll Up Shop Doors (14'x16')  
With Automated Openers

Lube Pit, Compressor with Air Hoses, Wash Rack,  
Fueling Facility, (4) Space Heaters

## Covered Storage Building ±4,000 SF

Multiple Bays - Some with Doors



# FLOOR PLAN

## 1ST FLOOR

±14,400 SF OFFICE + 8,000 SF SHOP

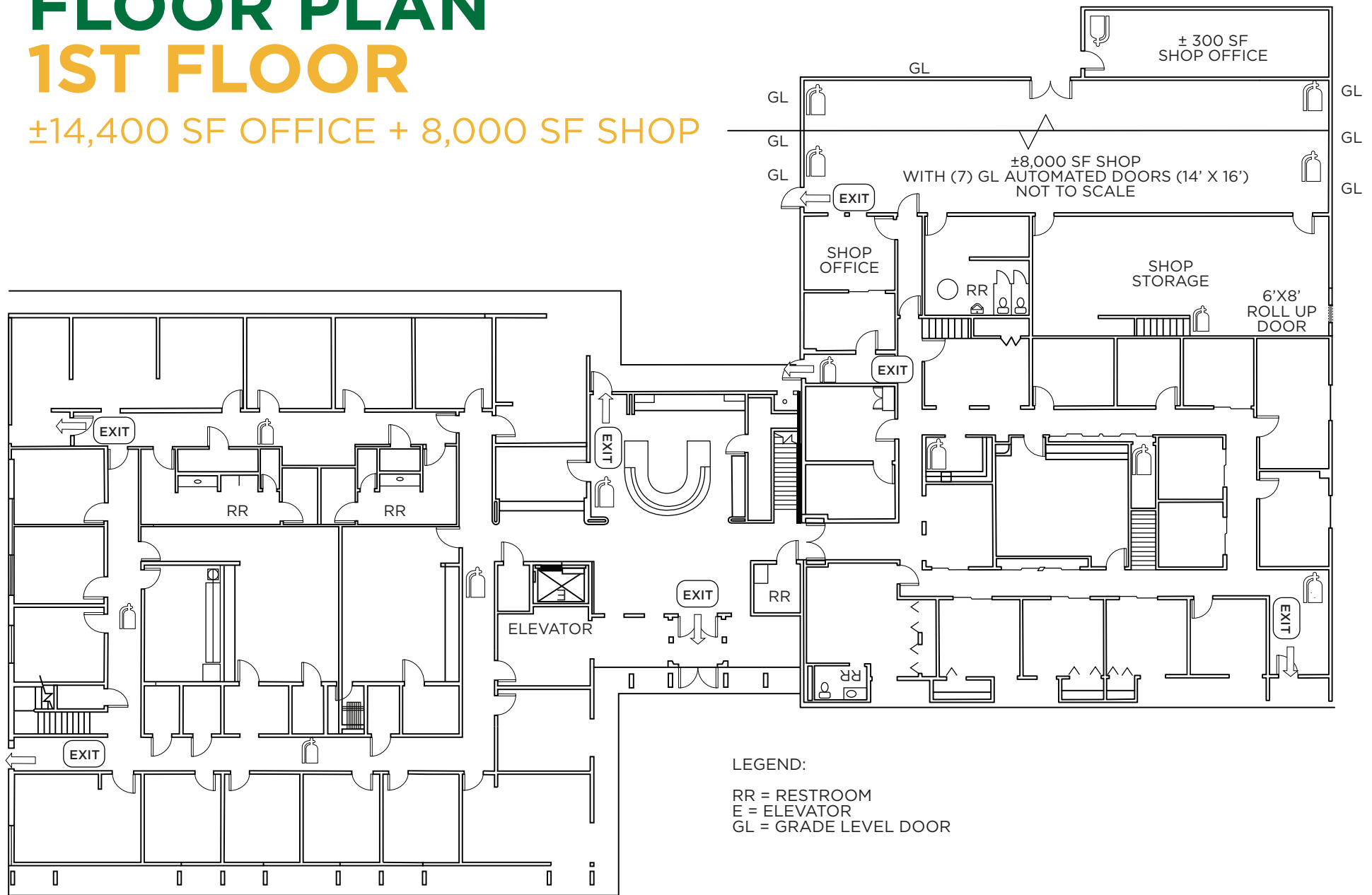

±14,400 SF





# AERIAL MAP

Port of Stockton

Sacramento

Port of Oakland

UPRR Lathrop  
Intermodal Yard

Miles

9 Miles

55 Miles

65 Miles

2 Miles





# AMENITY MAP



## FOR MORE INFORMATION, PLEASE CONTACT:

**STEVE DUNN**  
Senior Director  
+1 209 992 0953  
steve.dunn@cushwake.com

**TYSON VALLENARI**  
Executive Managing Director  
+1 510 919 2328  
tyson.vallenari@cushwake.com

3255 West March Lane  
Stockton, California 95219  
[cushmanwakefield.com](http://cushmanwakefield.com)

