

# LEASE

6323 DOGWOOD DR.

6317-6325 Dogwood Dr. Milton, FL 32570



## PROPERTY DESCRIPTION

Warehouse/ Industrial with Office Available for Lease at the intersection of Dogwood Dr. and Stewart St. Additional opportunity for laydown yard as the property includes a total of 5.15 acres zoned HCD with 606 Ft of road frontage on Dogwood Dr. with an AADT of 17,200 reported by the DOT. Available Unit includes 10x10 Roll up door, 12 Ft ceiling height, 130 SF of office space, single restroom and 100% climate controlled.

## PROPERTY HIGHLIGHTS

- Climate Controlled. Immediate Occupancy. Laydown Yard Available. Signage. Roll Up Door. 12 Ft Ceiling Height

## OFFERING SUMMARY

Lease Rate:	\$20.00 SF/yr (NNN)
Number of Units:	1
Available SF:	1,291 SF
Lot Size:	5.15 Acres
Building Size:	6,250 SF

DEMOGRAPHICS	1 MILE	3 MILES	5 MILES
Total Households	1,301	8,088	15,194
Total Population	3,162	18,890	37,053
Average HH Income	\$55,144	\$64,880	\$64,837

**Melissa Glyptis Simpson**  
(850) 733-6532



**COLDWELL BANKER**  
**COMMERCIAL**  
REALTY

# LEASE

**6323 DOGWOOD DR.**  
6317-6325 Dogwood Dr. Milton, FL 32570

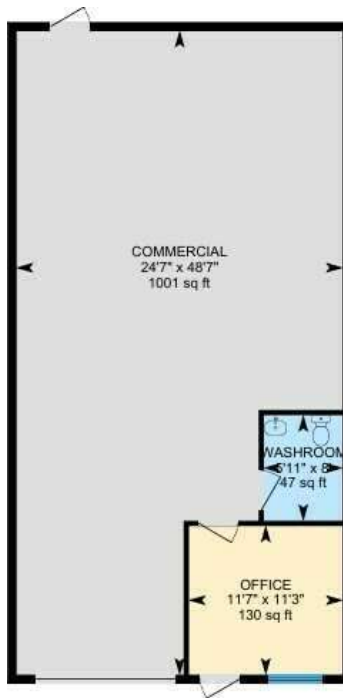

**Melissa Glyptis Simpson**  
(850) 733-6532



**COLDWELL BANKER**  
**COMMERCIAL**  
REALTY



# LEASE

**6317 DOGWOOD DR.**  
6317 Dogwood Dr. Milton, FL 32570

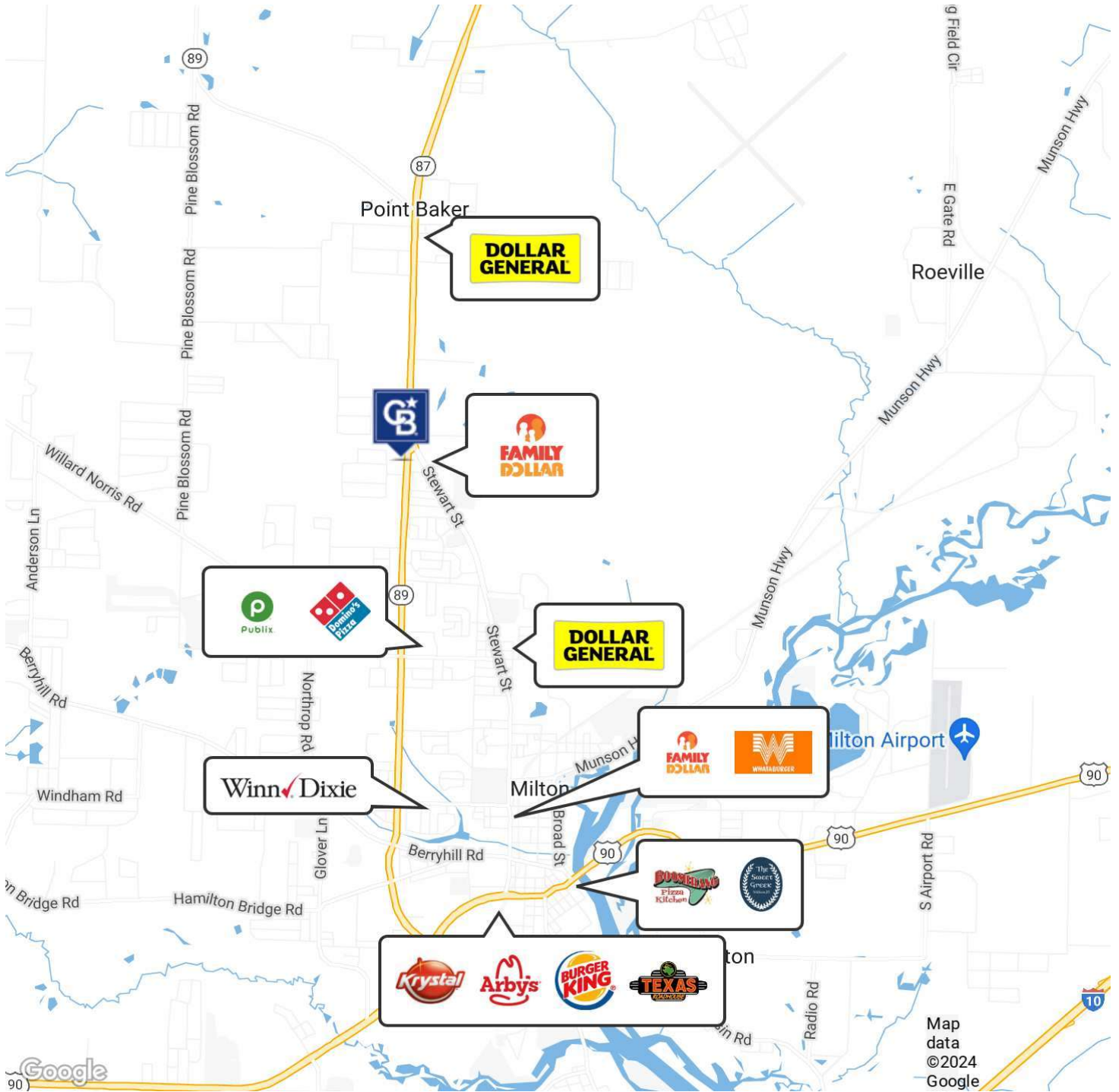

**Melissa Glyptis Simpson**  
(850) 733-6532



**COLDWELL BANKER**  
**COMMERCIAL**  
REALTY

# LEASE

**6317 DOGWOOD DR.**  
6317 Dogwood Dr. Milton, FL 32570

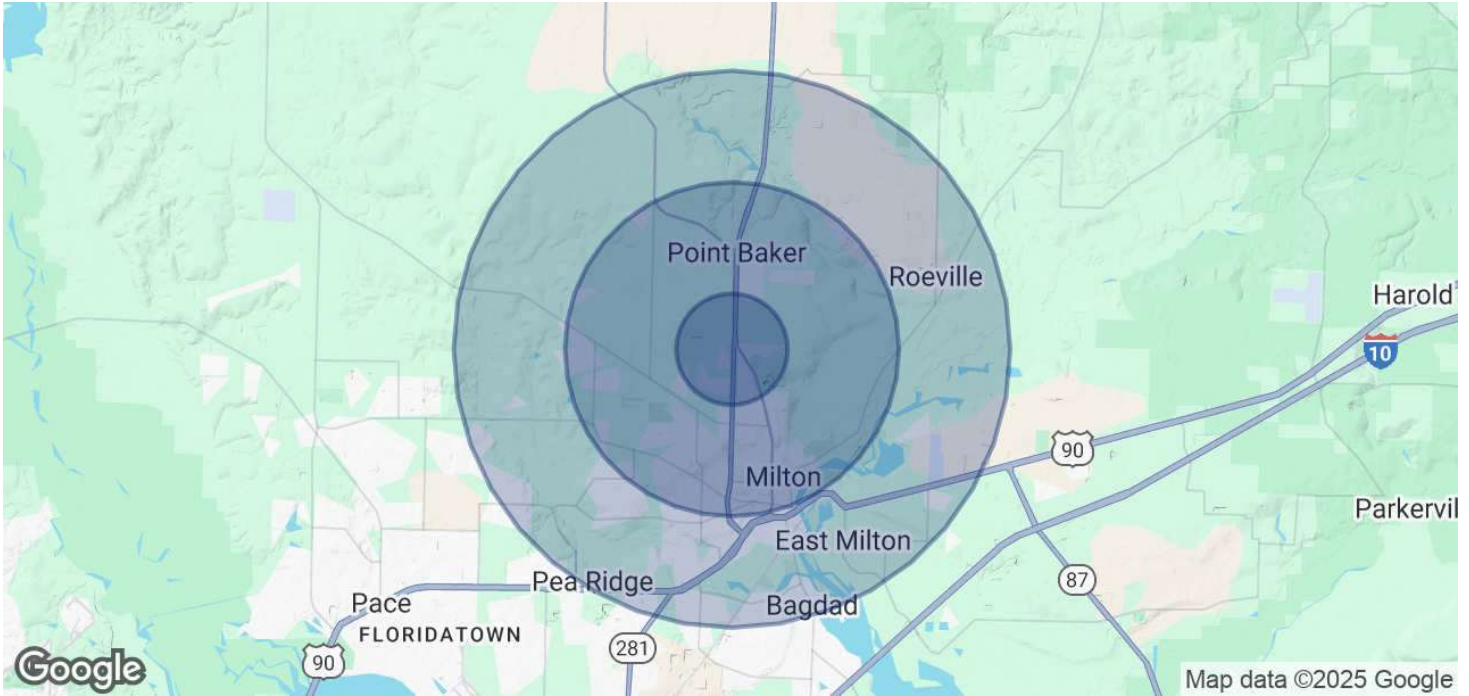

## POPULATION

	1 MILE	3 MILES	5 MILES
Total Population	3,162	18,890	37,053
Average Age	37.7	40.2	40.2
Average Age (Male)	35.1	39.1	39.3
Average Age (Female)	39.2	41.9	41.9

## HOUSEHOLDS & INCOME

	1 MILE	3 MILES	5 MILES
Total Households	1,301	8,088	15,194
# of Persons per HH	2.4	2.3	2.4
Average HH Income	\$55,144	\$64,880	\$64,837
Average House Value	\$126,353	\$159,472	\$157,661

2020 American Community Survey (ACS)

**Melissa Glyptis Simpson**  
(850) 733-6532



**COLDWELL BANKER**  
**COMMERCIAL**  
REALTY