

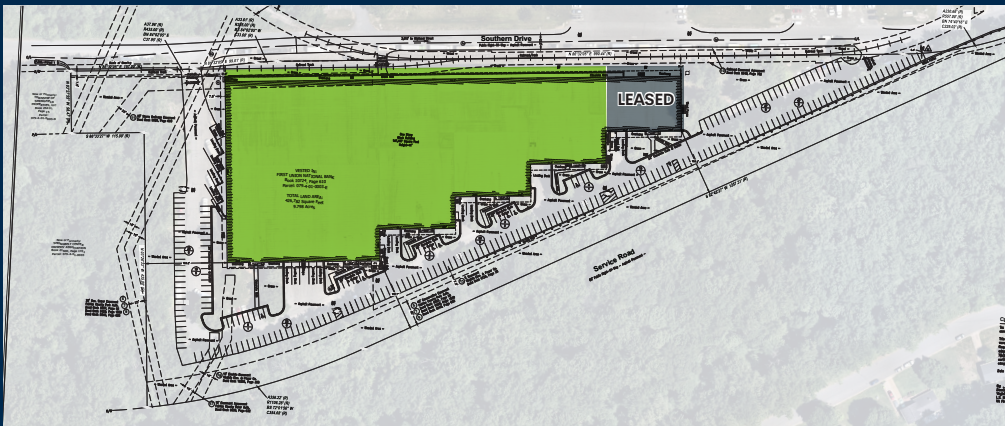

## SPRINGFIELD BUSINESS CENTER

7700 Southern Drive, Springfield, VA 22150



### Specifications

**20,309 - 151,910 sq ft**  
AVAILABLE

- **20,409 sq ft**  
7706 SOUTHERN DR
- **23,142 sq ft**  
7710 SOUTHERN DR
- **30,937 sq ft**  
7720 SOUTHERN DR
- **77,422 sq ft**  
7726-7230 SOUTHERN DR

**Minutes from I-495, I-395,  
and I-95**

**11 miles from Reagan  
International Airport IDCA**

**14 miles from Washington,  
DC**



**24'**  
CLEAR HEIGHT

**30' X 42'**  
COLUMNS

**16**  
DOCK POSITIONS

**1**  
DRIVE-IN

**1.55/1,000 sf**  
PARKING RATIO

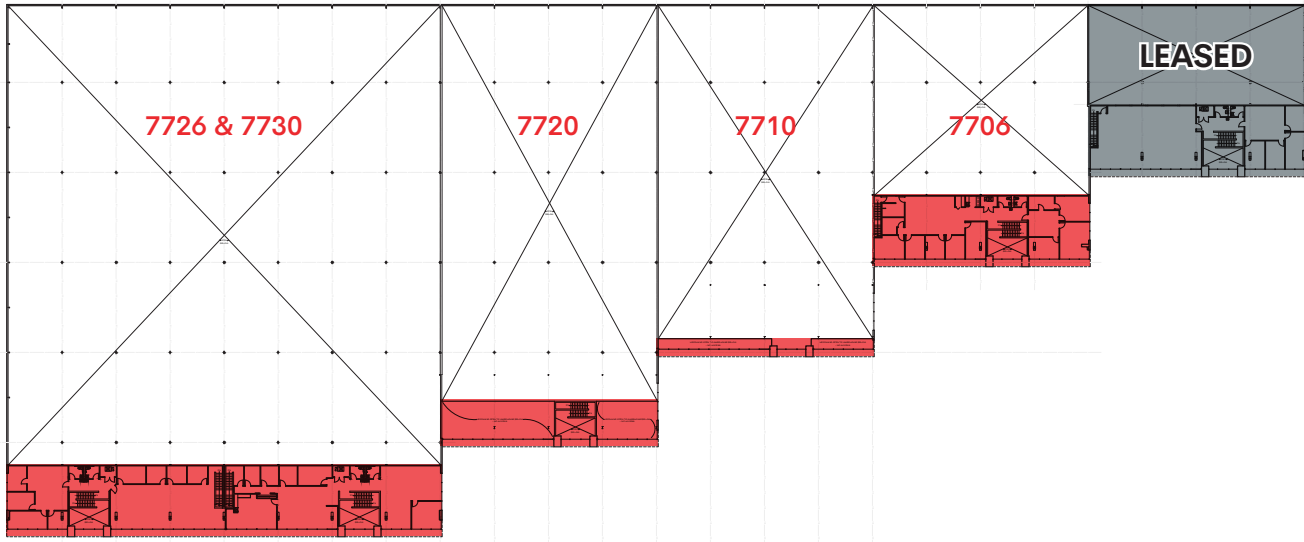

Second Floor

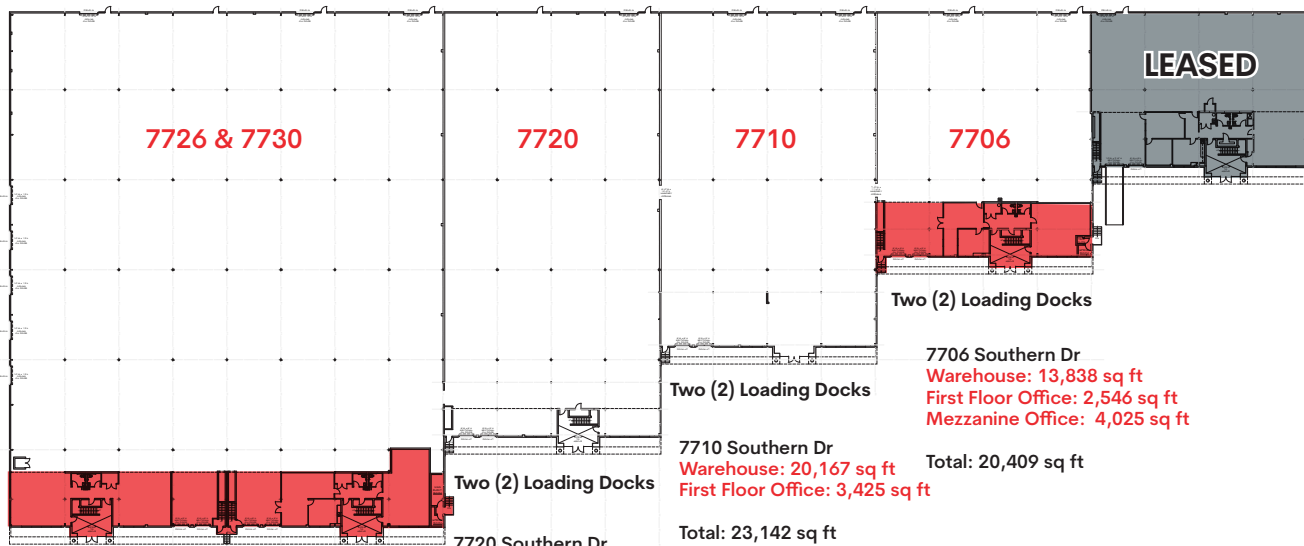

20,409 - 151,910 sq ft

First Floor















## Area Map & Key Distances

# Brookfield Properties

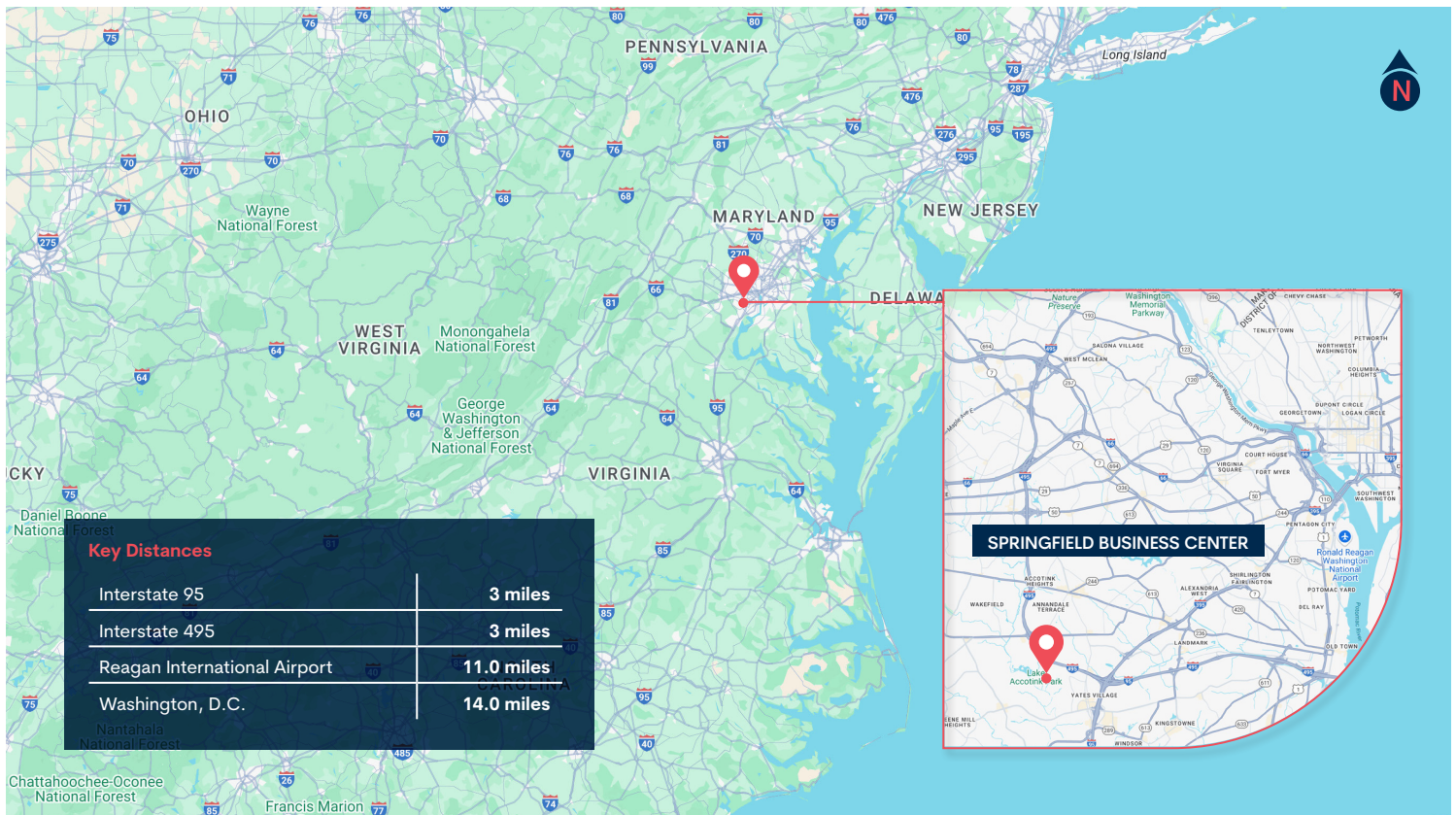

## Contacts



**John Dettliff**  
D 703.485.8831  
[john.dettliff@jll.com](mailto:john.dettliff@jll.com)

**Dan Coats**  
D 703.891.8410  
[dan.coats@jll.com](mailto:dan.coats@jll.com)

**Brookfield Properties**

**Peyton Murray**  
D 404 941 8558  
[peyton.murray@brookfieldproperties.com](mailto:peyton.murray@brookfieldproperties.com)

Although information has been obtained from sources deemed reliable, neither Owner nor JLL makes any guarantees, warranties or representations, express or implied, as to the completeness or accuracy as to the information contained herein. Any projections, opinions, assumptions or estimates used are for example only. There may be differences between projected and actual results, and those differences may be material. The Property may be withdrawn without notice. Neither Owner nor JLL accepts any liability for any loss or damage suffered by any party resulting from reliance on this information. If the recipient of this information has signed a confidentiality agreement regarding this matter, this information is subject to the terms of that agreement. ©2021. Jones Lang LaSalle IP, Inc. All rights reserved.