

860 Levoy

Sorenson Research Park

860 West Levoy Drive
Taylorsville, Utah

Up To **76,275 SF** Available



Office/Lab | For Lease

Brand New Amenities &
Common Area Upgrades

Premier Redevelopment By:

INTEGRA
CRE

FFKR ARCHITECTS



Leasing Information:

Chris Kirk, Sior
Managing Director
+1 801 947 8385
chris.kirk@colliers.com

Rusty Lugo
Vice President
+1 801 947 8377
rusty.lugo@colliers.com





Key Features



**Zoned RD
Research & Development**



**Unparalleled access to
the Salt Lake Valley &
Wasatch Front**



**Tenant Improvement
Allowance to support a
Lab/Flex user**



**New Common Area
Upgrades**

Building Highlights

- Located on 4500 S./4700 S. Expressway
- 2 Minutes to I-15, 6 Minutes to I-215
- Large Monument Sign
- Crown Signage Available
- Restaurant and Hotel Amenities Nearby
- 4.5/1,000 SF Parking Ratio
- Two-Story Atrium Lobby
- Emergency Generator
- Dropped Ceiling and HVAC (Temperature Controlled) Throughout Building
- Potential to Convert Office to Lab Spectacular Wasatch Mountain Views
- 5-min walk to Jordan River Parkway Trail

Internet carriers available:

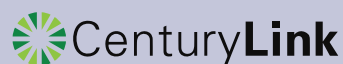

Up To **76,275 SF** Available

Integra CRE purchased 860 Levo in 2023 as a redevelopment project to re-envision the building with a complete common area upgrade, common area conference room, premier fitness center, and new professional pickleball court.

Stunning new lobby showcasing luxurious high-end finishes, is underway! Enjoy comfortable breakout seating, cutting-edge technology, and an exclusive perk: common area conference rooms and a large training room available to all tenants.



Premier modern fitness center with high end equipment, yoga studio, private showers, and lockers.



Professional pickleball court with patio seating.



1st Floor | 22,693 RSF

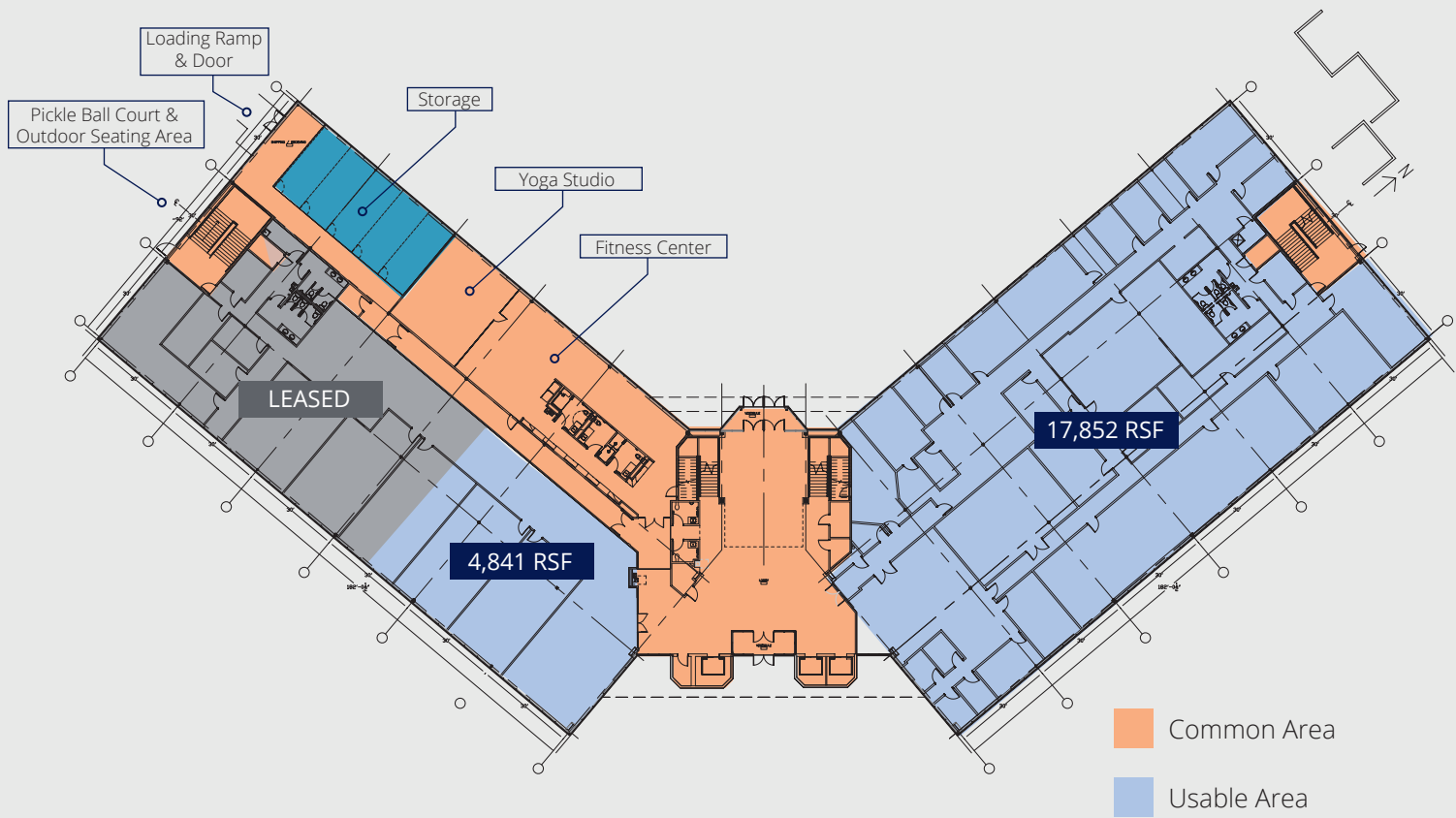

Potential Lab User

- Zoned R&D
- Emergency Generator
- Vertical Shafts for Venting
- Loading Ramp & Overhead Door



2nd Floor | 35,846 RSF

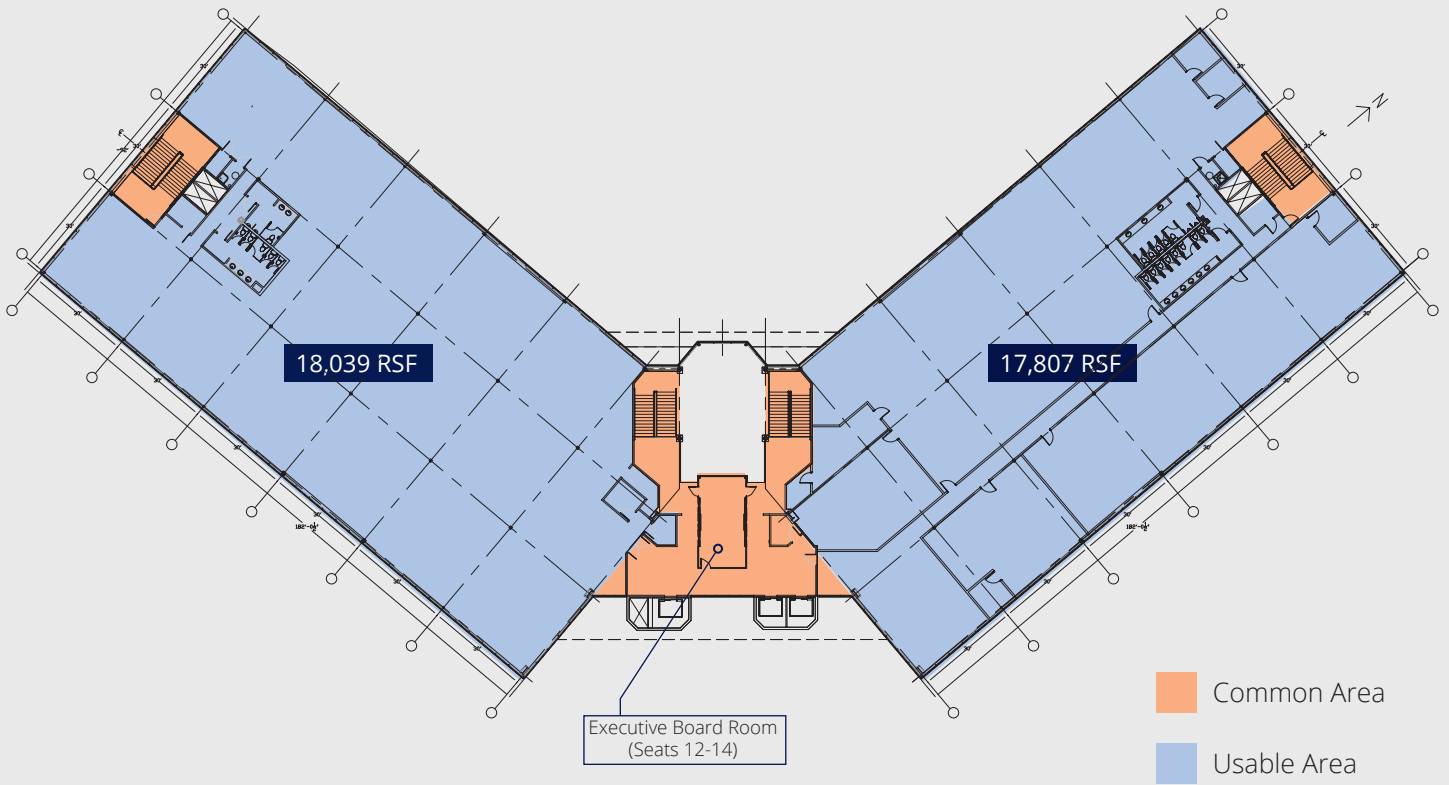

3rd Floor | 17,736 RSF

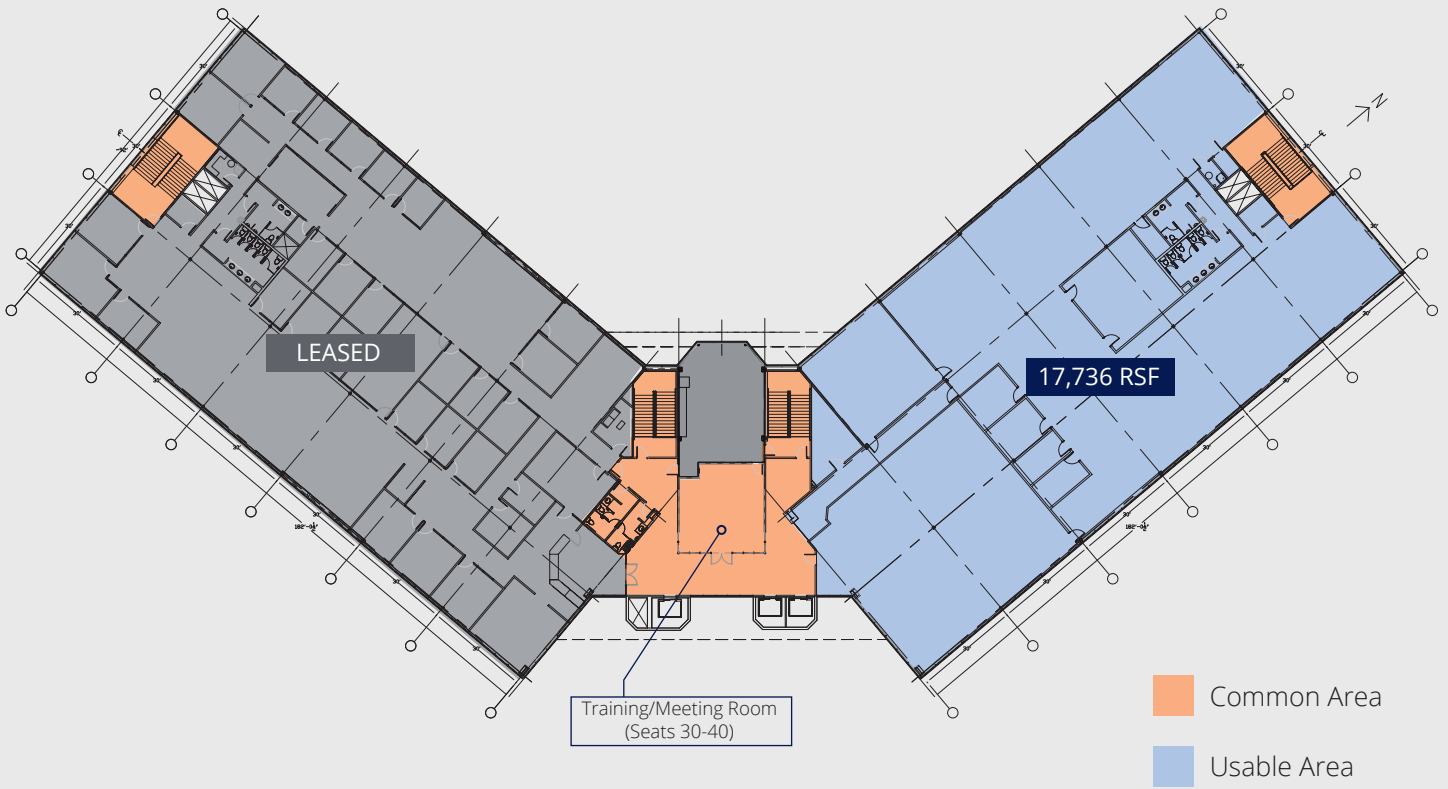



860 Levoy | Sorenson Research Park

A well-established suburban office park at the center of the Salt Lake Valley, only 10 minutes to Downtown SLC, 14 minutes to SLC International Airport, and 20 minutes to the Point of the Mountain/Silicon Slopes.

Midvalley Connector

Bus rapid transit delivers fast, comfortable, and cost-effective transit service with more frequent bus service, larger capacity buses, and dedicated bus lanes.

Projected Daily Ridership:

2,200 - 2,700



Transit Access



11 Minutes to Murray Central Station



Direct Route Every 1/2 Hour

 701 TRAX BLUE LINE

 703 TRAX RED LINE

 750 FRONTRUNNER

860 Levoy

860 West Levoy Drive | Taylorsville, Utah

Office/Lab | For Lease

Brand New Amenities &
Common Area Upgrades

Premier Redevelopment By:

INTEGRA
CRE

FFKR ARCHITECTS

ENGAGE
CONTRACTING

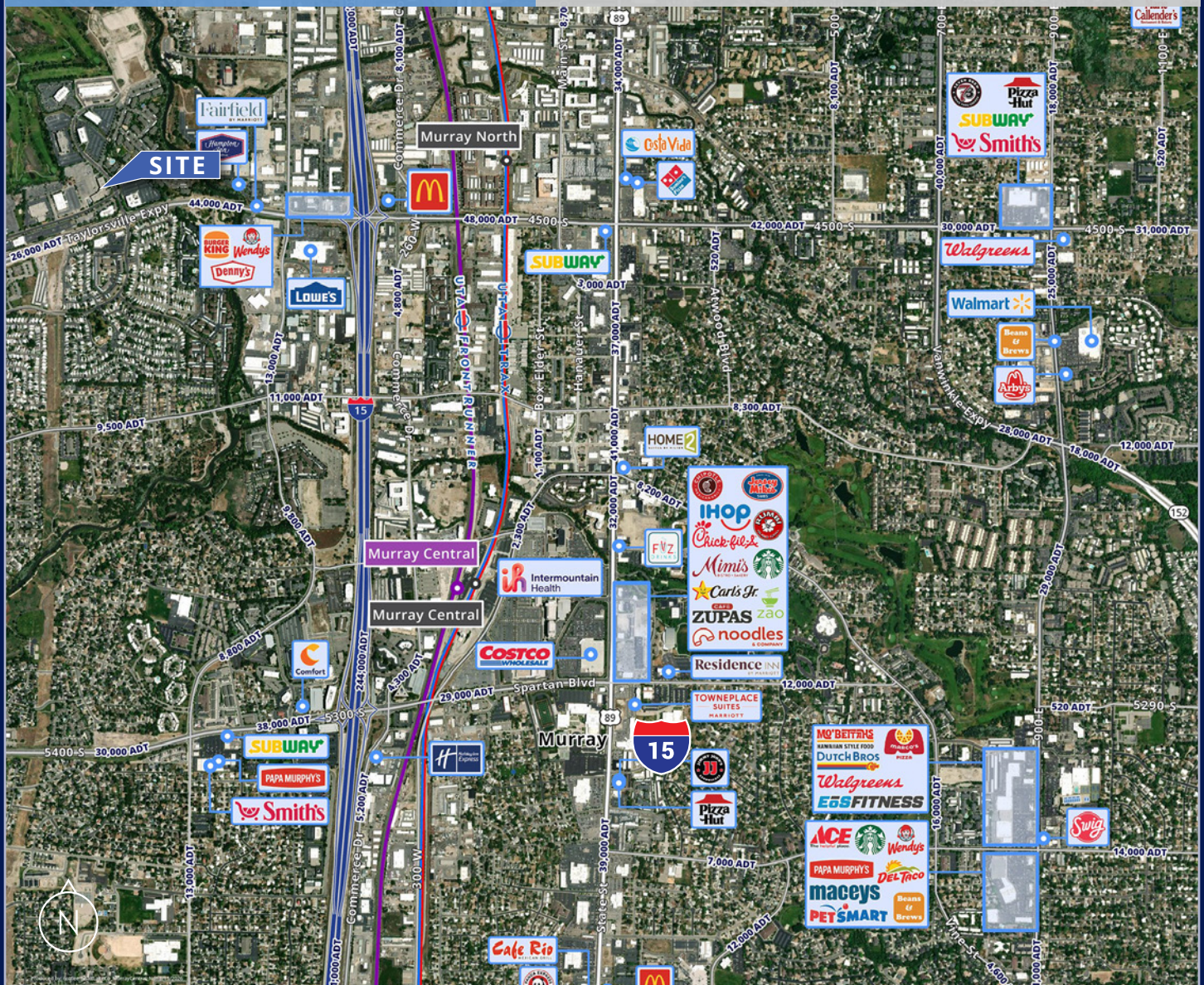

Colliers
111 S. Main St., Suite 2200
Salt Lake City, UT 84111
Main: +1 801 947 8300
colliers.com

Leasing Information:

Chris Kirk, sior
Managing Director
+1 801 947 8385
chris.kirk@colliers.com

Rusty Lugo
Vice President
+1 801 947 8377
rusty.lugo@colliers.com

This document has been prepared by Colliers International for advertising and general information only. Colliers International makes no guarantees, representations or warranties of any kind, expressed or implied, regarding the information including, but not limited to, warranties of content, accuracy and reliability. Any interested party should undertake their own inquiries as to the accuracy of the information. Colliers International excludes unequivocally all inferred or implied terms, conditions and warranties arising out of this document and excludes all liability for loss and damages arising there from. This publication is the copyrighted property of Colliers International and/or its licensor(s). ©2026. All rights reserved.