

14 miles  
TO DOWNTOWN PORTLAND

25 miles  
TO PORT OF PORTLAND

24 miles  
TO PDX AIRPORT

8 miles  
TO 

2.2 miles  
TO 

3 miles  
TO 

187 miles  
TO SEATTLE, WA

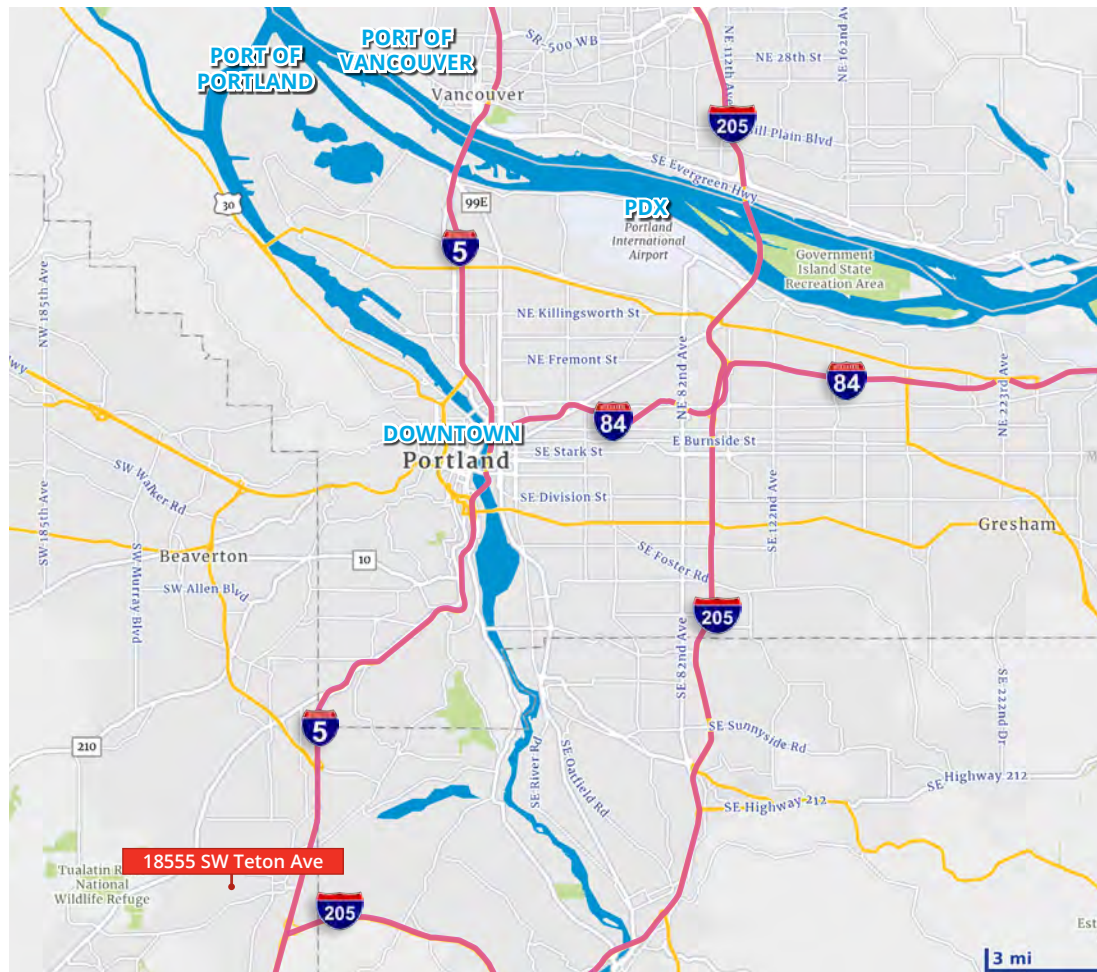

1855 SW Teton Avenue - Corporate Neighbors

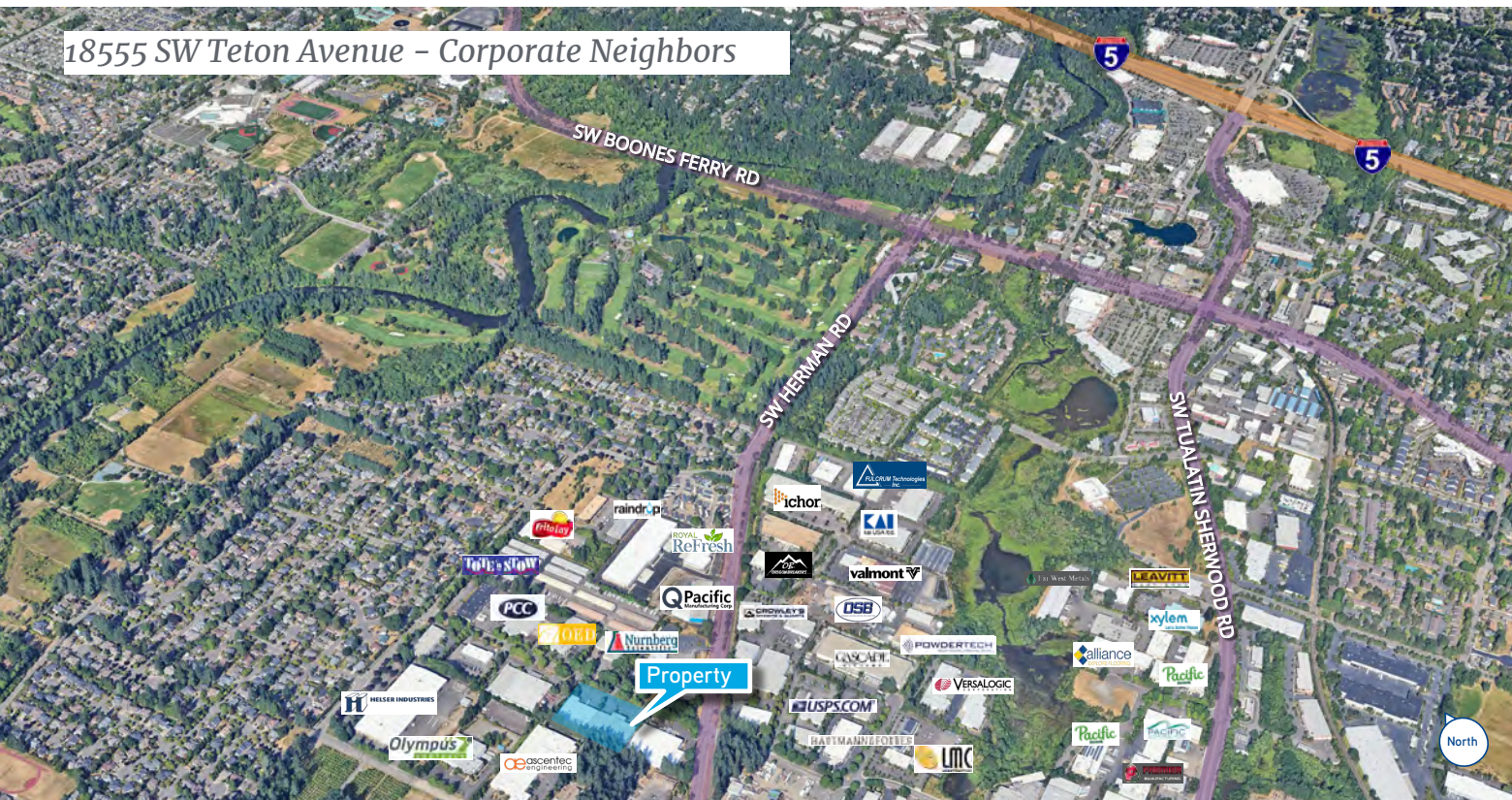

Contact us:  
Jerry Matson, SIOR, MBA  
Vice Chairman  
+1 503 499 0077  
jerry.matson@colliers.com

Brian Yoakum, SIOR  
Senior Vice President  
+1 503 499 0070  
brian.yoakum@colliers.com

Tom Knecht, SIOR  
Vice President  
+1 503 499 0069  
tom.knecht@colliers.com



[CLICK HERE TO VIEW PROPERTY VIDEO](#)

**Jerry Matson, SIOR, MBA**  
Vice Chairman  
+1 503 499 0077  
jerry.matson@colliers.com

**Brian Yoakum, SIOR**  
Senior Vice President  
+1 503 499 0070  
brian.yoakum@colliers.com

**Tom Knecht, SIOR**  
Vice President  
+1 503 499 0069  
tom.knecht@colliers.com

**Colliers**  
851 SW Sixth Avenue, Suite 1200  
Portland, Oregon 97204  
Main: +1 503 223 3123  
colliers.com

## Teton Industrial Complex 39,846 SF for Lease

1855 SW Teton Ave., Tualatin, OR 97067

Excellent opportunity to lease a Class B industrial building in the most sought-after submarket in the Portland MSA.

This property features exceptional access to I-5 and is centered in an outstanding corporate neighborhood. Just over 20 minutes from Portland International Airport and the Port of Portland's Terminal 6, Teton Industrial Complex offers an outstanding location with immediate access to labor and support services

39,846 SF of well-maintained industrial space on 3.18 acres.



**Available  
Now!**

Call for Rates

Accelerating success.

## Space Overview

39,846 SF with 11,788 SF office

24' clear height

2,000A/400V 3-phase power well-distributed throughout

8 dock doors and 1 grade doors

Wet sprinkler system

**EXISTING ONSITE WASTEWATER TREATMENT INFRASTRUCTURE AND DISCHARGE PERMIT**

982 SF outdoor employee area

52 car parking spaces

Light manufacturing zoning (ML)

Outstanding corporate neighborhood

Located in business-friendly Washington county



## 18544 - 18555 SW Teton Ave - Building Plan

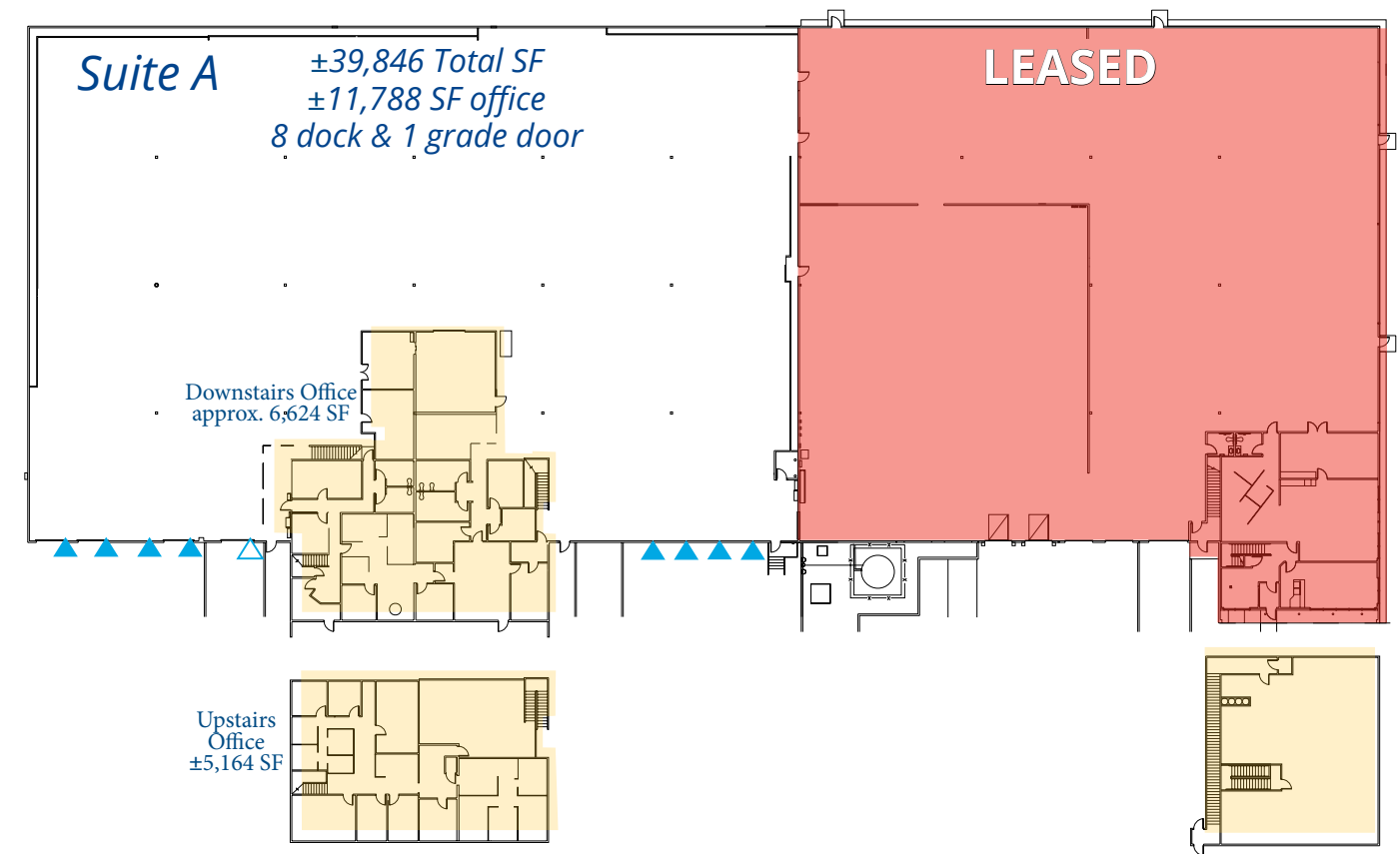

Contact us:  
**Jerry Matson, SIOR, MBA**  
Vice Chairman  
+1 503 499 0077  
jerry.matson@colliers.com

**Brian Yoakum, SIOR**  
Senior Vice President  
+1 503 499 0077  
brian.yoakum@colliers.com

**Tom Knecht, SIOR**  
Vice President  
+1 503 499 0066  
tom.knecht@colliers.com

