

FOR SALE OR LEASE

PRIME COMMERCIAL PROPERTY

5420 Hickory St
PANAMA CITY, FL 32404



Lease Rate: \$10.2 NNN per Sq Ft | **Price:** Offered at \$2,800,000

- Size: 21,184 Sqft
- Acreage: 2.5
- Zoning: Mixed Use
- Parking: 4 per thousand, with room to expand
- Fully Renovated
- Executive Office Space
- Easy to Finish to Suit
- Centrally Located
- Ample Parking
- Versatile Space
- Two Separate Entrances with Option to Sublet Part of the Building

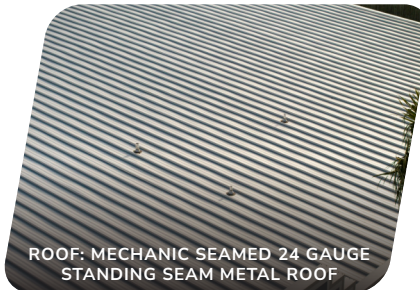

ROOF: MECHANIC SEAMED 24 GAUGE
STANDING SEAM METAL ROOF



RED IRON CLEAR SPAN BEAMS



KURT FADDEN

☎ (321)890-5364
✉ Kurt.fadden@exprealty.com
🌐 ThefaddenMcKelvieGroup.com



ANDREW MCKELVIE

☎ (850)-630-1905
✉ Andrew.McKelvie@exprealty.com
🌐 ThefaddenMcKelvieGroup.com

THE
FADDEN-
MCKELVIE
GROUP

exp
REALTY

FOR SALE OR LEASE

PRIME COMMERCIAL PROPERTY

5420 | **Hickory St**
PANAMA CITY, FL 32404



KURT FADDEN

☎ (321)890-5364

✉ Kurt.fadden@exprealty.com

🌐 ThefaddenMcKelvieGroup.com



ANDREW MCKELVIE

☎ (850)-630-1905

✉ Andrew.McKelvie@exprealty.com

🌐 ThefaddenMcKelvieGroup.com



FOR SALE OR LEASE

PRIME COMMERCIAL PROPERTY

5420 | **Hickory St**
PANAMA CITY, FL 32404



KURT FADDEN

☎ (321)890-5364

✉ Kurt.fadden@exprealty.com

🌐 ThefaddenMcKelvieGroup.com



ANDREW MCKELVIE

☎ (850)-630-1905

✉ Andrew.McKelvie@exprealty.com

🌐 ThefaddenMcKelvieGroup.com



FOR SALE OR LEASE

PRIME COMMERCIAL PROPERTY

5420 | **Hickory St**
PANAMA CITY, FL 32404

Impact Fitness
5420 Hickory Street
Panama City, Florida 32404

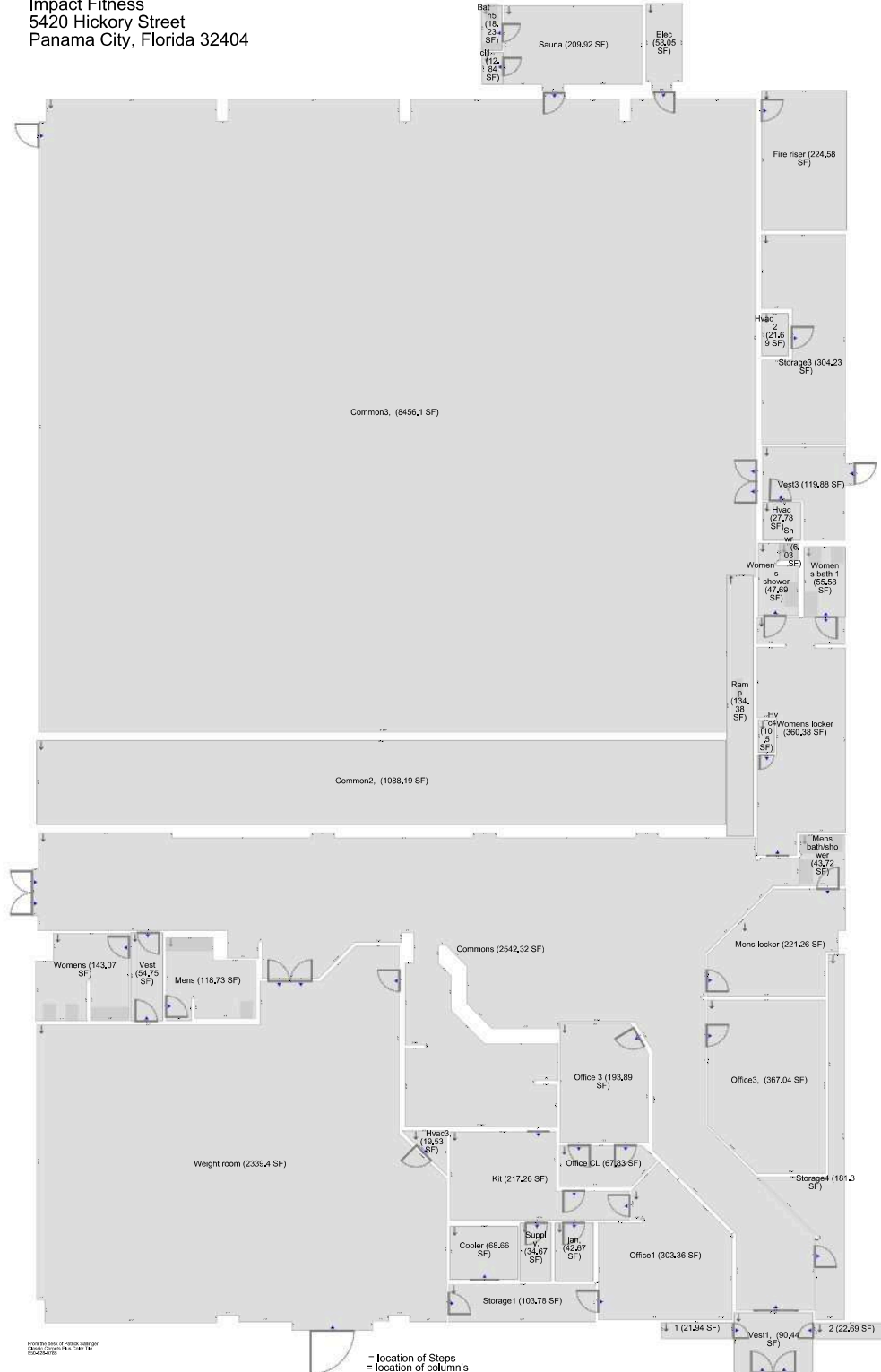

Not to be scaled for construction



KURT FADDEN

(321)890-5364

Kurt.fadden@exprealty.com

ThefaddenMcKelvieGroup.com



ANDREW MCKELVIE

(850)-630-1905

Andrew.McKelvie@exprealty.com

ThefaddenMcKelvieGroup.com

