

# 609 Second Avenue

Between 33rd & 34th Streets | Murray Hill



Space A

Space B

# 609 Second Avenue

Between 33rd & 34th Streets | Murray Hill

Space A: 1,432 SF Ground Floor  
1,295 SF Basement

Space B: 1,731 SF Ground Floor

FRONTAGE: A: 21' | B: 18.5'

CEILING HEIGHT: 13.6'

POSSESSION: ASAP

TRANSPORTATION: 

## HIGHLIGHTS:

- Boutique luxury condominium building
- High foot traffic area in dense residential neighborhood
- Excellent national co-tenancy
- Neighboring tenants include: *NYU Langone, Chipotle, Charlotte's Cafe, Starbuck, AMC Kips Bay 15, Fairway, Crunch Fitness, Row House, Area Pilates, & more*

CONTACT OUR BROKERS FOR MORE INFORMATION:

**MADDY SOFFER**  
MSoffer@ksrny.com  
347.752.3350

**CAROLINA AZIZ**  
CAziz@ksrny.com  
516.640.6961

**IKE BIBI**  
IBibi@ksrny.com  
347.417.2860

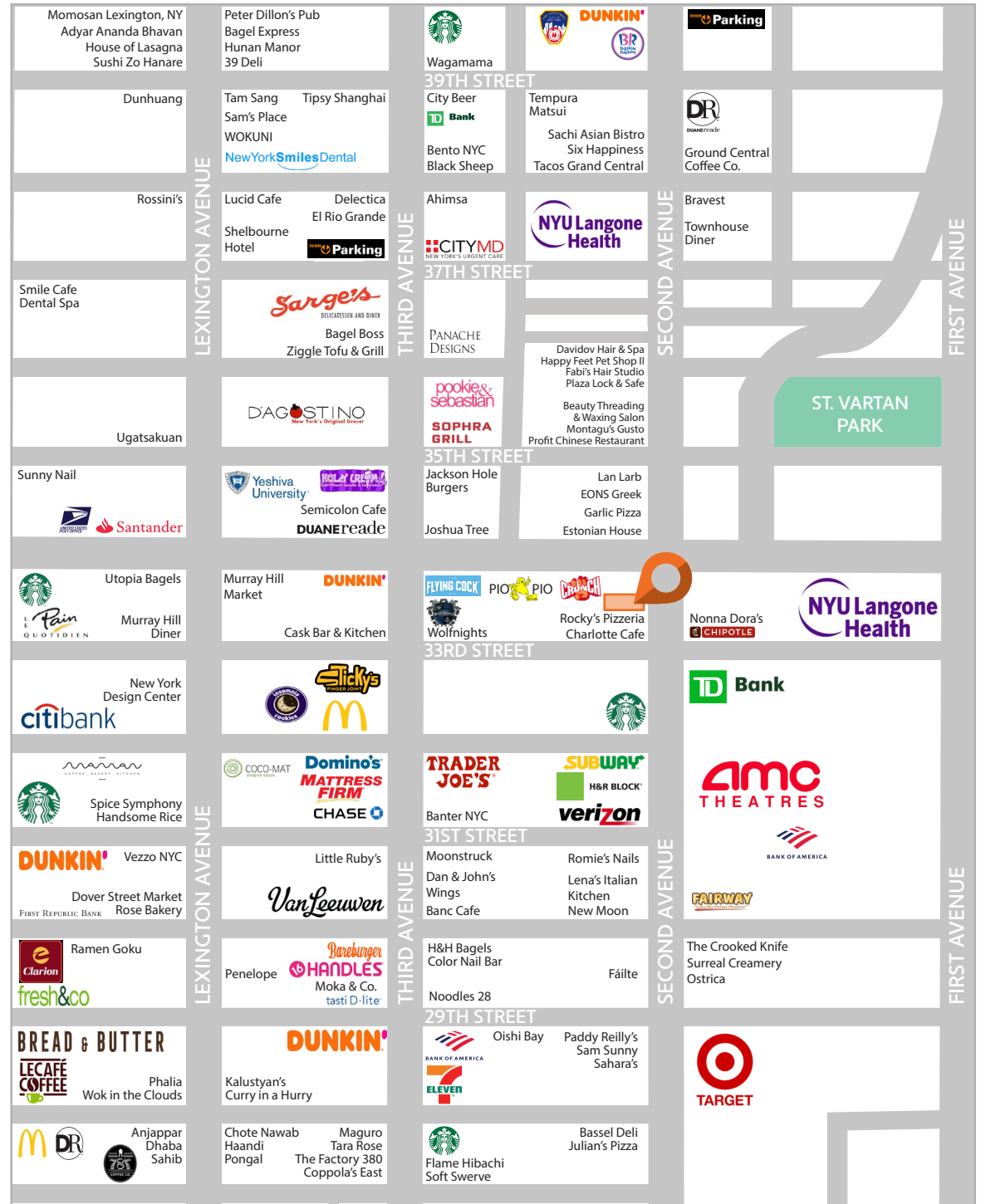

# 609 Second Avenue

Between 33rd & 34th Streets | Murray Hill

## Floor Plans: Ground Floor

- Space A - 1,432 SF
- Space B - 1,731 SF

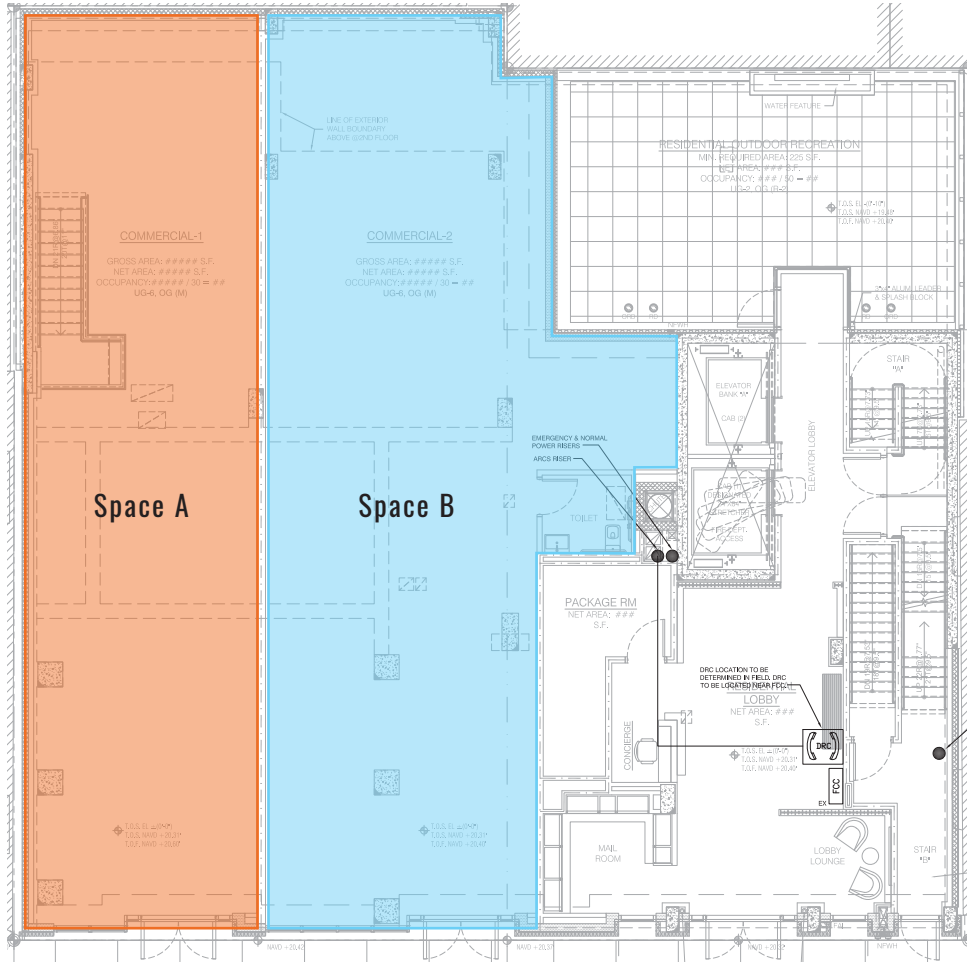

## Cellar

- Space A - 1,295 SF

