

For Lease Class A Professional Office

Majestic Square
211 King Street, Charleston, South Carolina 29401

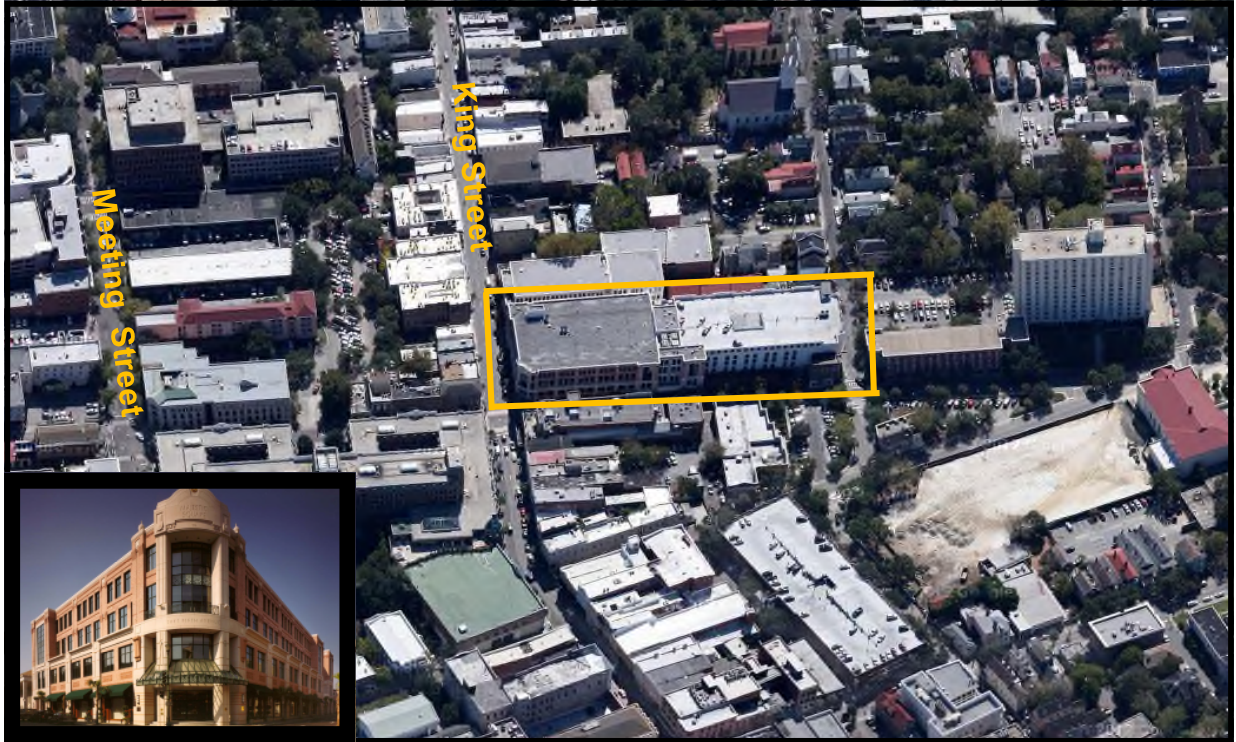

Summary:

- Located in Majestic Square, one of Charleston's finest office properties
- Prime location downtown at the corner of King and Market Streets above Forever 21
- Suite 100 is approximately 2,659 sf and includes grand reception area, break room, work room, three spacious private offices with large windows overlooking King Street and a large appointed conference room
- Lease rate is \$39.00 per square foot per year full service with Class A amenities
- Guaranteed parking is available in the adjacent Majestic Square parking deck at an additional cost
- Within walking distance to the Charleston business district's restaurants, banks and retail
- MLS #30214786

EDWARD G. ROBINSON IV
211 King Street, Suite 300 • Charleston, South Carolina 29401
843.864.3760 Mobile • 843.722.2615 Office • 843.722.6449 Fax
erobinson@thebeachcompany.com

BEACH
COMMERCIAL
A DIVISION OF THE BEACH COMPANY

For Lease

Class A Professional Office

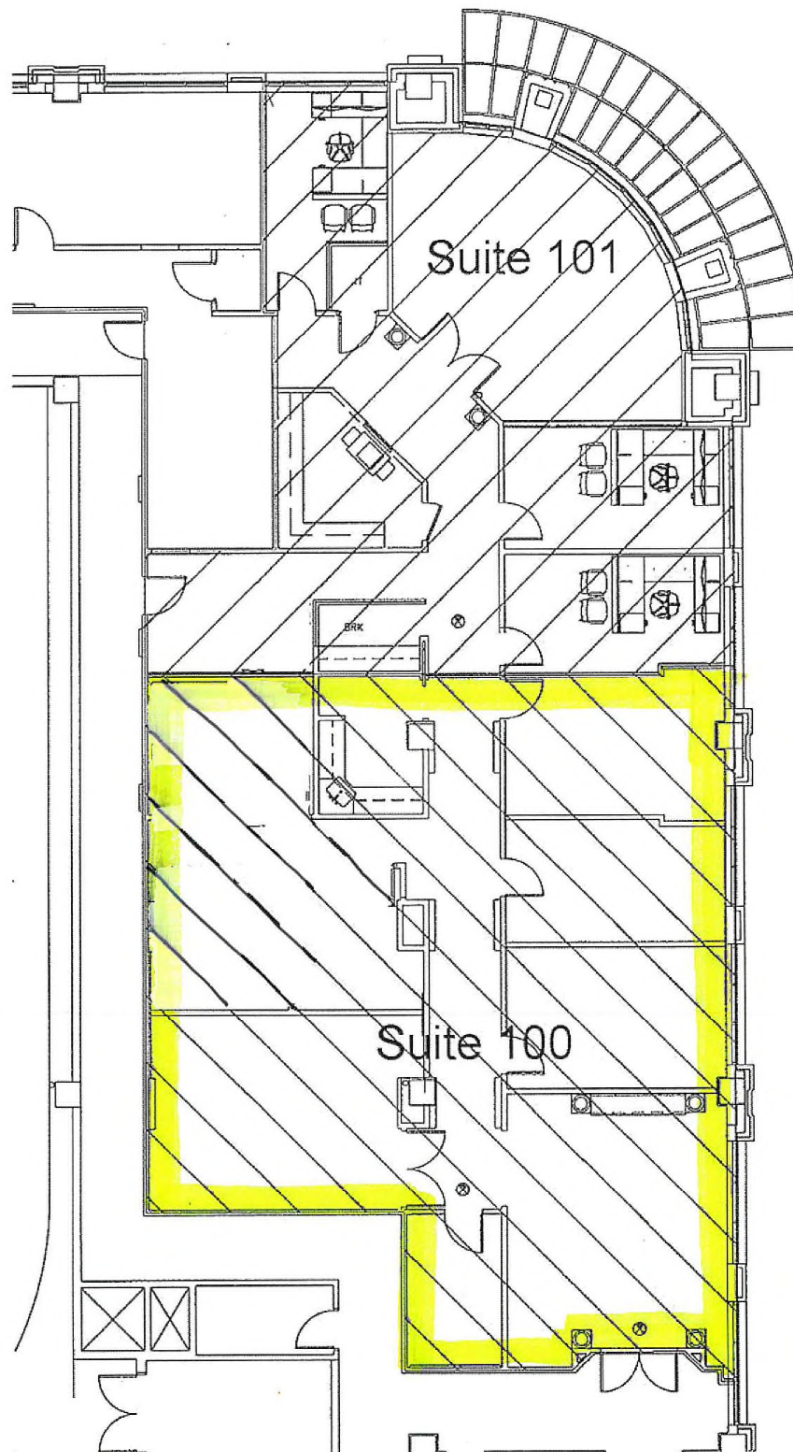

EDWARD G. ROBINSON IV

211 King Street, Suite 300 • Charleston, South Carolina 29401
843.864.3760 Mobile • 843.722.2615 Office • 843.722.6449 Fax
erobinson@thebeachcompany.com

BEACH
COMMERCIAL

A DIVISION OF THE BEACH COMPANY

For Lease

Class A Professional Office



Specifications:

- Charleston County
- City of Charleston
- Tax Map #457-08-02-026
- Majestic Square was built in 1994
- Building is 42,000 sf
- Suite is on the first floor above retail
- Three elevators access the Building
- High profile King Street address in a landmark building
- Some furniture pieces may be available
- Some high-end furniture may be available

EDWARD G. ROBINSON IV

211 King Street, Suite 300 • Charleston, South Carolina 29401
843.864.3760 Mobile • 843.722.2615 Office • 843.722.6449 Fax
erobinson@thebeachcompany.com

BEACH
COMMERCIAL
A DIVISION OF THE BEACH COMPANY