

DESIGNED BY: BRM  
 DATE: JUNE 2024

BRYAN R. MAHLKE  
 TXPE 122050  
 24-JUNE-2024  
 FOR REVIEW

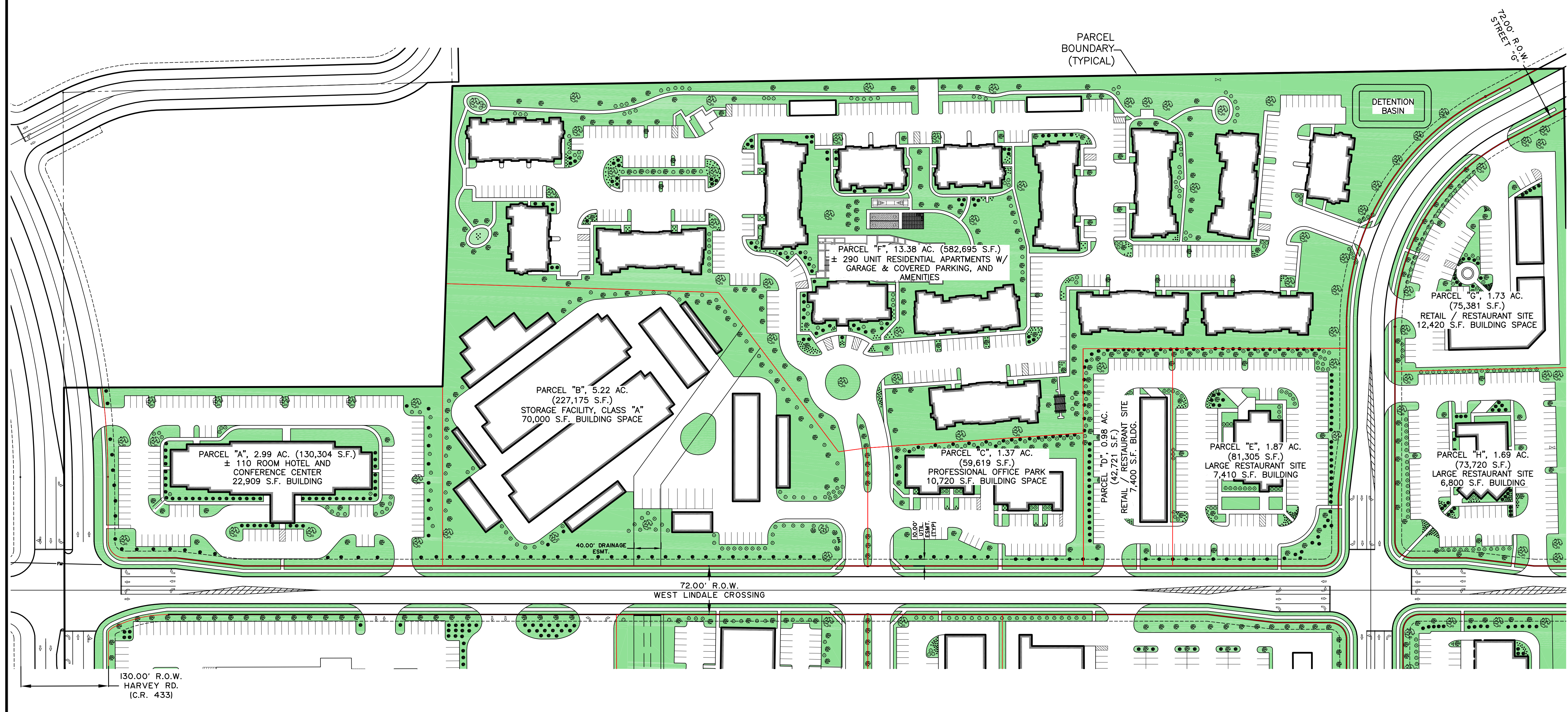

1321 SOUTH BROADWAY  
 SUITE 110  
 WAXAHACH, TEXAS 75080  
 (940) 597-2122

THE C.T. BRANNON CORPORATION  
 A PROFESSIONAL ENGINEERING FIRM  
 LICENSE NO. 19686  
 EXPIRES 12/31/2024

© COPYRIGHT 2024. THE C.T. BRANNON CORPORATION. UNAUTHORIZED REUSE OR REPRODUCTION IS PROHIBITED.

**CONCEPTUAL  
 MASTER PLAN**  
 FOR  
**LINDALE CROSSING WEST  
 LINDALE, SMITH COUNTY, TEXAS**

NO.	DATE	REVISIONS	REMARKS

ISSUED FOR:  
**PRELIMINARY  
 FOR  
 REVIEW ONLY**

PROJECT NO.  
 24132  
 SHEET NO.  
**EX.04**

**NORTH TRACT**