



## PROPERTY FEATURES

**AVAILABLE:** ±4,050 SF Industrial Space

**RATE:** \$1.20/SF + \$.075/SF CAM

**DOORS:** Two (2) Ground Level Doors

- Two (2) Secured Parking Spots
- 200 Amp, 240V, 3 Phase Power
- Clear Span Warehouse
- Clean Multi Tenant Industrial Unit
- Close Proximity to Ports of Long Beach and Los Angeles

**VIRTUAL TOUR**

**CLICK HERE**

**LOCAL EXPERTISE. INTERNATIONAL REACH. WORLD CLASS.**

**Max P. Eddy**

Associate | DRE# 02163858

P: 562.354.2538

E: meddy@leelalb.com

**Garrett Massaro** <sup>SIOR</sup>

Principal | DRE# 01771471

P: 562.354.2516

E: gmassaro@leelalb.com

**Brandon Carrillo**

Principal | DRE# 01745362

P: 562.354.2510

E: bcarrillo@leelalb.com

Copyright © Lee & Associates. All rights reserved. No part of this work may be reproduced or distributed without written permission of the copyright owner. The information contained in this report was gathered by Lee & Associates from sources believed to be reliable. Lee & Associates, however, makes no representation concerning the accuracy or completeness of such information and expressly disclaims any responsibility for any inaccuracy contained herein.

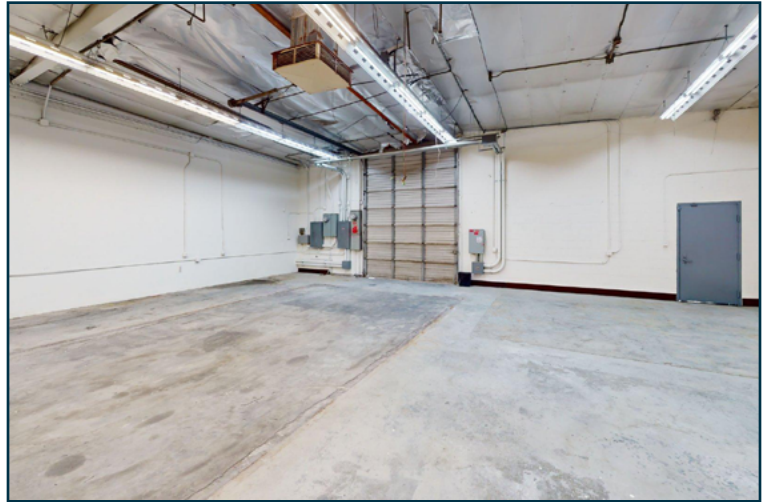

LOCAL EXPERTISE. INTERNATIONAL REACH. WORLD CLASS.

**Max P. Eddy**

Associate | DRE# 02163858

P: 562.354.2538

E: meddy@leelalb.com

**Garrett Massaro** SIOR

Principal | DRE# 01771471

P: 562.354.2516

E: gmassaro@leelalb.com

**Brandon Carrillo**

Principal | DRE# 01745362

P: 562.354.2510

E: bcarrillo@leelalb.com

Copyright © Lee & Associates. All rights reserved. No part of this work may be reproduced or distributed without written permission of the copyright owner. The information contained in this report was gathered by Lee & Associates from sources believed to be reliable. Lee & Associates, however, makes no representation concerning the accuracy or completeness of such information and expressly disclaims any responsibility for any inaccuracy contained herein.



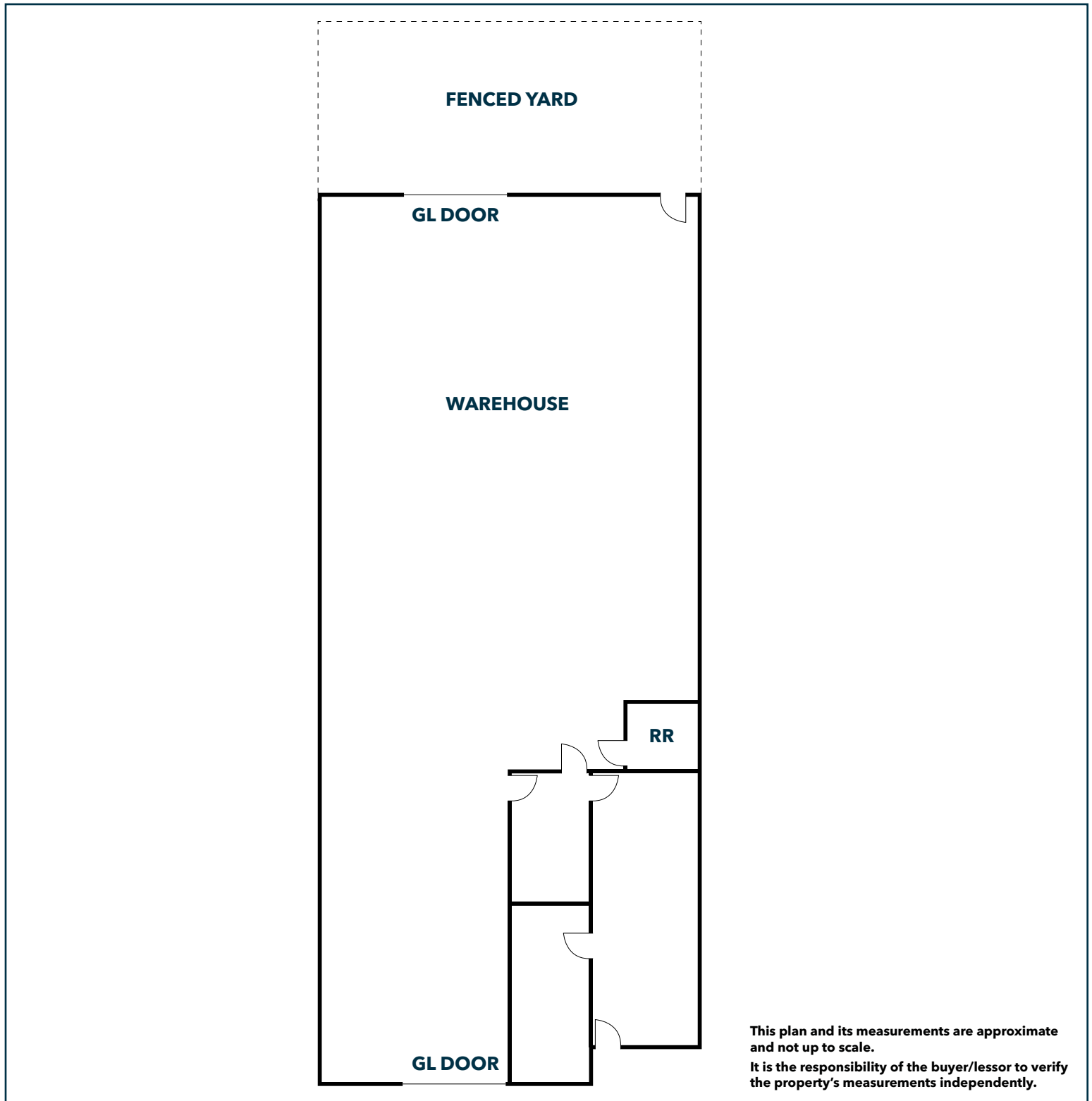

LOCAL EXPERTISE. INTERNATIONAL REACH. WORLD CLASS.

## Max P. Eddy

Associate | DRE# 02163858

P: 562.354.2538

E: meddy@leelalb.com

## Garrett Massaro <sup>SIOR</sup>

Principal | DRE# 01771471

P: 562.354.2516

E: gmassaro@leelalb.com

## Brandon Carrillo

Principal | DRE# 01745362

P: 562.354.2510

E: bcarrillo@leelalb.com

Copyright © Lee & Associates. All rights reserved. No part of this work may be reproduced or distributed without written permission of the copyright owner. The information contained in this report was gathered by Lee & Associates from sources believed to be reliable. Lee & Associates, however, makes no representation concerning the accuracy or completeness of such information and expressly disclaims any responsibility for any inaccuracy contained herein.