

FOR SUBLEASE ► RETAIL

+/- 10,980 SF AVAILABLE

2530 Chester Ave, Bakersfield, CA 93301

APN: 005-341-05-00-6, County of Kern

PROPERTY DETAILS

- **LEASE RATE: CONTACT BROKER FOR PRICING**
- SPACE AVAILABLE: +/- 10,980 SF
- RETAIL SHOWROOM
- (1) ROLL-UP DOOR WITH ACCESS TO 26TH ST
- (1) ROLL-UP DOOR WITH ALLEY ACCESS
- ON-SITE PARKING WITH 21 SPACES
 - BACK PORTION SECURED & FULLY-FENCED WITH SLIDING GATE
 - AMPLE STREET PARKING AVAILABLE
- ACROSS THE STREET FROM ADVENTIST HEALTH & KAISER PERMANENTE
- CLOSE PROXIMITY TO CA-204 & CA-178 FREEWAYS
- CENTRAL DOWNTOWN CORE LOCATION
- TRAFFIC COUNT - CHESTER AVE: +/- 19,800 ADT
- ZONING: C-2, CITY OF BAKERSFIELD



OLIVIERI COMMERCIAL GROUP
9810 Brimhall Road
Bakersfield, CA 93312
www.oliviericommercial.com

*For additional information
please contact:*

Giana Olivieri
Senior Vice President
LIC. #01973774
(661) 616-4453
giana@oliviericommercial.com

Anthony Olivieri, CCIM, CRX
President
LIC. #01325989
(661) 617-1850
anthony@oliviericommercial.com



The information above has been obtained from sources believed reliable. While we do not doubt its accuracy we have not verified it and make no guarantee, warranty or representation about it. It is your responsibility to independently confirm its accuracy and completeness. Any projections, opinions, assumptions or estimates used are for example only and do not represent the current or future performance of the property. The value of this transaction to you depends on tax and other factors which should be evaluated by your tax, financial and legal advisors. You and your advisors should conduct a careful, independent investigation of the property to determine to your satisfaction the suitability of the property for your needs. Logos are for identification purposes only and may be trademarks of their respective companies.



The information above has been obtained from sources believed reliable. While we do not doubt its accuracy we have not verified it and make no guarantee, warranty or representation about it. It is your responsibility to independently confirm its accuracy and completeness. Any projections, opinions, assumptions or estimates used are for example only and do not represent the current or future performance of the property. The value of this transaction to you depends on tax and other factors which should be evaluated by your tax, financial and legal advisors. You and your advisors should conduct a careful, independent investigation of the property to determine to your satisfaction the suitability of the property for your needs. Logos are for identification purposes only and may be trademarks of their respective companies.

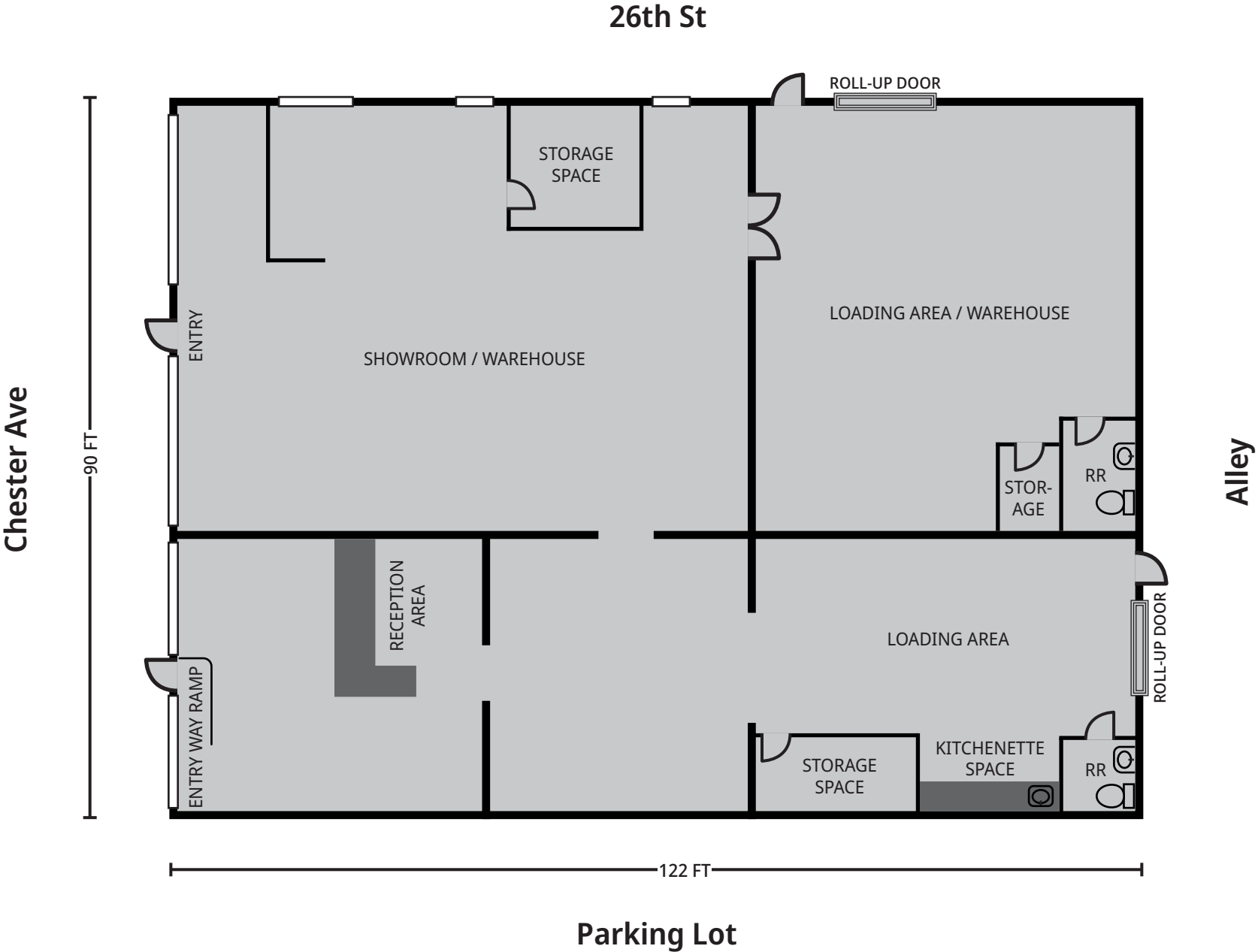

PHOTOS

(Reception, Loading Area, Showroom, Warehouse)

2530 Chester Ave, Bakersfield, CA 93301



The information above has been obtained from sources believed reliable. While we do not doubt its accuracy we have not verified it and make no guarantee, warranty or representation about it. It is your responsibility to independently confirm its accuracy and completeness. Any projections, opinions, assumptions or estimates used are for example only and do not represent the current or future performance of the property. The value of this transaction to you depends on tax and other factors which should be evaluated by your tax, financial and legal advisors. You and your advisors should conduct a careful, independent investigation of the property to determine to your satisfaction the suitability of the property for your needs. Logos are for identification purposes only and may be trademarks of their respective companies.

1-Mile Radius

KEY FACTS

11,021

Population



Average
Household Size

33.6

Median Age

\$42,820

Median Household
Income

BUSINESS



2,388

Total Businesses



29,073

Total Employees

INCOME



\$42,820

Median Household
Income



\$25,680

Per Capita Income



\$14,024

Median Net Worth

3-Mile Radius

KEY FACTS

123,780

Population



Average
Household Size

31.9

Median Age

\$45,391

Median Household
Income

BUSINESS



7,387

Total Businesses



83,346

Total Employees

INCOME



\$45,391

Median Household
Income



\$20,581

Per Capita Income



\$20,720

Median Net Worth

5-Mile Radius

KEY FACTS

298,983

Population



Average
Household Size

32.6

Median Age

\$57,984

Median Household
Income

BUSINESS



12,539

Total Businesses



139,205

Total Employees

INCOME



\$57,984

Median Household
Income



\$25,492

Per Capita Income



\$56,024

Median Net Worth



The information above has been obtained from sources believed reliable. While we do not doubt its accuracy we have not verified it and make no guarantee, warranty or representation about it. It is your responsibility to independently confirm its accuracy and completeness. Any projections, opinions, assumptions or estimates used are for example only and do not represent the current or future performance of the property. The value of this transaction to you depends on tax and other factors which should be evaluated by your tax, financial and legal advisors. You and your advisors should conduct a careful, independent investigation of the property to determine to your satisfaction the suitability of the property for your needs. Logos are for identification purposes only and may be trademarks of their respective companies.