

CCI Management, Inc.

FOR LEASE

21 West Road



21 West Road Towson, Maryland 21204

AVAILABLE FOR LEASE

- Suite 111: 1,350 RSF
- Suite 150: 1,604 RSF
- \$22.50 PSF - Full Service
- 2 Story medical building
- 4 Parking spaces per 1,000 square foot
- Strategically located near the intersection of Baltimore Beltway (I-695) and York Road (Rt 45)

FOR INFORMATION CONTACT:

Robert J. Licata
410.583.8905
rjlicata@ccimgmt.com

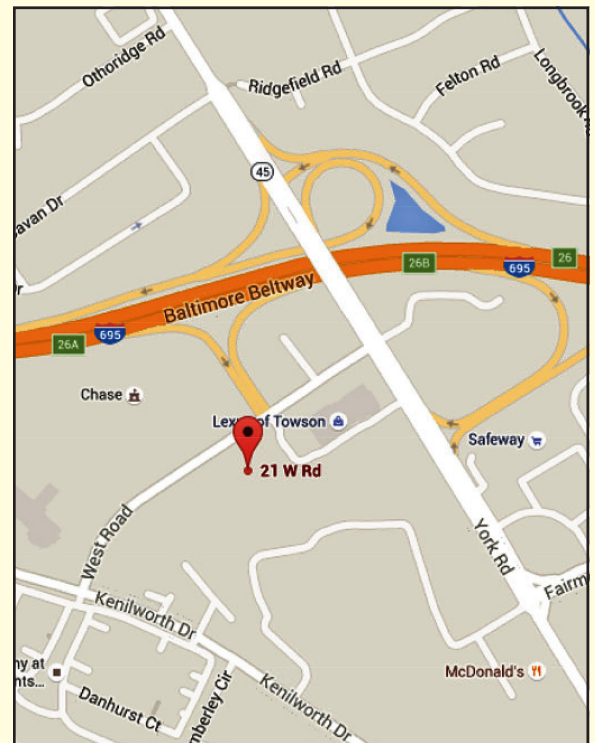

CCI Management, Inc.

PNC-Towson Building
409 Washington Avenue, Suite 1015
Towson, Maryland 21204
410.583.9600

WHILE WE HAVE NO REASON TO DOUBT THE ACCURACY OF ANY OF THE INFORMATION SUPPLIED, WE CANNOT, AND DO NOT, GUARANTEE ITS ACCURACY. ALL INFORMATION SHOULD BE INDEPENDENTLY VERIFIED PRIOR TO A PURCHASE OR LEASE OF THE PROPERTY. WE ARE NOT RESPONSIBLE FOR ERRORS, OMISSIONS, MISUSE, OR MISINTERPRETATION OF INFORMATION CONTAINED HEREIN & MAKE NO WARRANTY OF ANY KIND, EXPRESS OR IMPLIED, WITH RESPECT TO THE PROPERTY OR ANY OTHER MATTERS.

AVAILABLE FOR LEASE

- Suite 111: 1,350 RSF

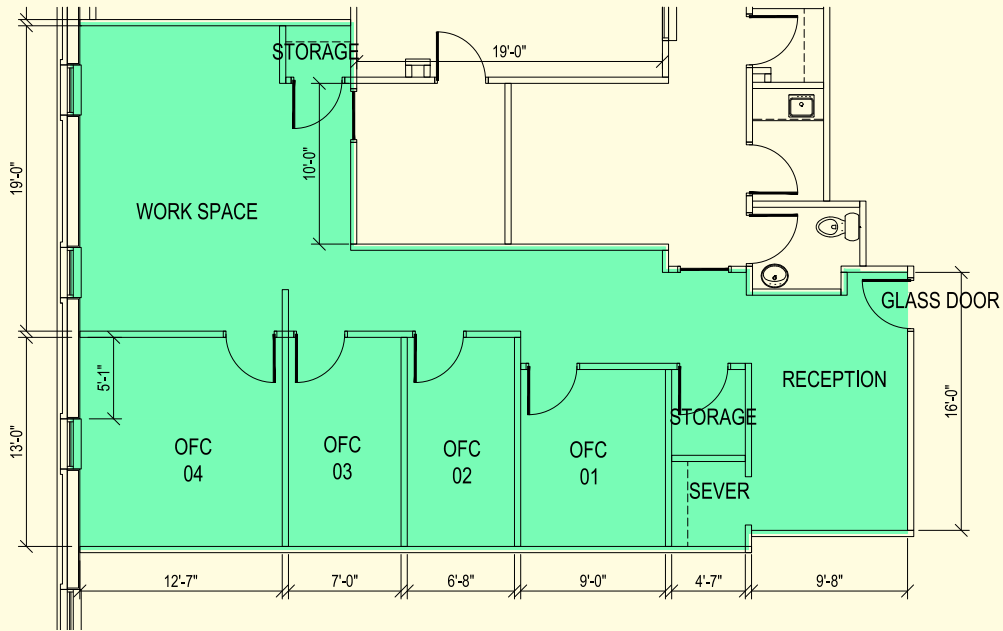

AVAILABLE FOR LEASE

- Suite 150: 1,604 RSF

