

MOVE-IN CONDITION SPACE

As exclusive subleasing agent, we are pleased to offer the following prime office space:

SPACE DETAILS

PREMISES	Partial 5 th Floor – 4,055 RSF
TERM	Through July 31, 2023
RENTAL RATE	Upon Request
POSSESSION	Immediate

SPACE FEATURES

- High end existing installation with two (2) private offices/conference centers, pantry, open work area with 22 workstations.
- Fully furnished and wired

PROPERTY FEATURES

- Class A Modern Office Building
- Energy Star rated
- Convene Conference Center
- Wired Certified Gold
- Parking Garage



For more information, contact:

Frank Cento
212.709.0745
Frank.Cento@cushwake.com

Ben Schaufler
212.709.0731
Ben.Schaufler@cushwake.com

One World Trade Center
45th Floor, Suite B
New York, NY 10007

cushmanwakefield.com

New York

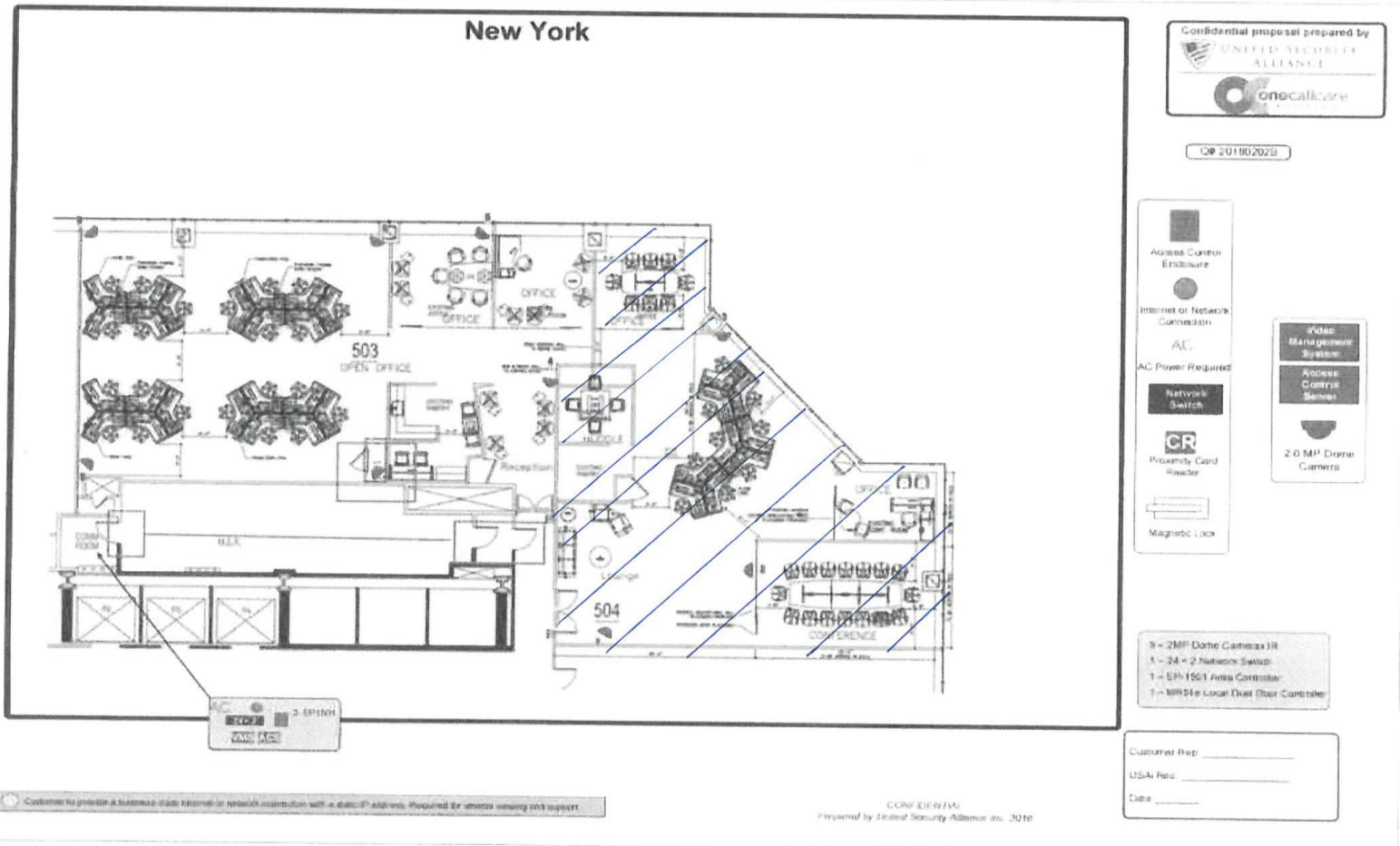

For more information, contact:

Frank Cento
212.709.0745
Frank.Cento@cushwake.com

Ben Schaufler
212.709.0731
Ben.Schaufler@cushwake.com

One World Trade Center
45th Floor, Suite B
New York, NY 10007

cushmanwakefield.com



For more information, contact:

Frank Cento

212.709.0745

Frank.Cento@cushwake.com

Ben Schaufler

212.709.0731

Ben.Schaufler@cushwake.com

One World Trade Center
45th Floor, Suite B
New York, NY 10007

cushmanwakefield.com