

Medical Office | For Lease

CBRE

Spring Medical Plaza

Newly Constructed, 3-Story Class A
Medical Office Building

21848 Holzwarth Rd
Spring, TX 77388
www.cbre.com/properties

11,598 RSF Available For Lease - Spaces range from 2,687 to 5,097 RSF



JWC
JACOB WHITE CONSTRUCTION

Spring Medical Plaza

21848 Holzwarth Rd, Spring, TX 77388



Highlights

Newly Constructed, 3-Story Class A Medical Office Building

- 55,354 RBA
- Availability: 2,687 RSF to 5,097 RSF
- High-end interior finishes
- High efficiency building systems
- 5 per 1,000 parking ratio; surface parking
- Covered patient drop-off
- Gurney elevators
- Monument signage opportunities
- Easy access to the Grand Parkway and I-45
- Physician investment opportunity

3

Stories

55K

Rentable Building Area (SF)

2024

Year Built

2nd Floor



3rd Floor

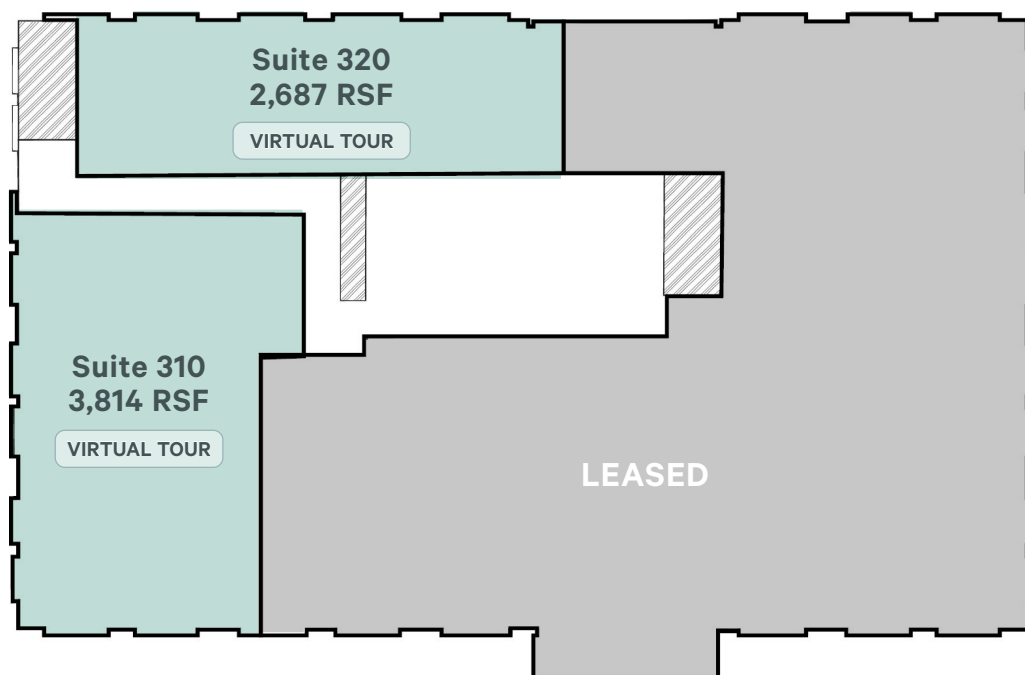

Spring Medical Plaza

21848 Holzwarth Rd, Spring, TX 77388



DEMOGRAPHICS - 3 MILES



2023 POPULATION

73,168



DAYTIME POPULATION

76,904



AVG HOUSEHOLD
INCOME

\$123,423



MEDIAN HOME
VALUE

\$279,540

INSURANCE MIX - 3 MILES

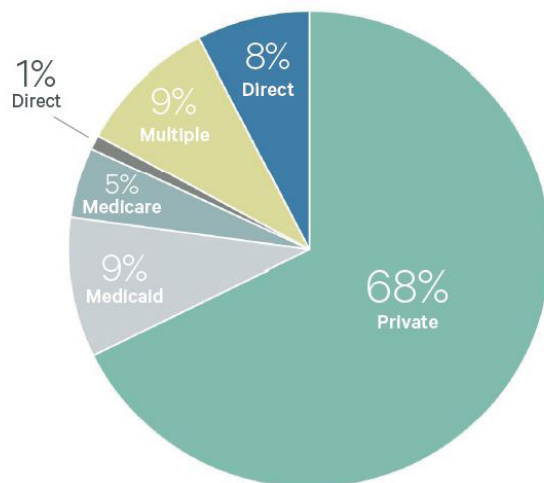

PRIVATE MEDICAID MEDICARE
MILITARY MULTIPLE DIRECT

For Lease



Spring Medical Plaza

21848 Holzwarth Rd, Spring, TX 77388

For Lease



CLICK ON THE MAP
FOR GOOGLE MAP VIEW

Contact Us

Brandy Bellow Spinks

Senior Vice President

+1 713 726 6100

brandy.bellow@cbre.com

Lane Kane

Senior Associate

+1 904 305 7633

lane.kane@cbre.com

Angela Barber

Vice President

+1 832 455 6945

angela.barber@cbre.com

© 2025 CBRE, Inc. All rights reserved. This information has been obtained from sources believed reliable, but has not been verified for accuracy or completeness. You should conduct a careful, independent investigation of the property and verify all information. Any reliance on this information is solely at your own risk. CBRE and the CBRE logo are service marks of CBRE, Inc. All other marks displayed on this document are the property of their respective owners, and the use of such logos does not imply any affiliation with or endorsement of CBRE. Photos herein are the property of their respective owners. Use of these images without the express written consent of the owner is prohibited.