

BUILD TO SUIT OR GROUND LEASE



SR 60 & 90TH AVE VERO BEACH, FLORIDA

Don DeWoody

📞 (561) 729-7000
✉ don.dewoody@landmarkcra.com

Alfredo Sanchez

📞 (561) 301-7690
✉ alfredo.sanchez@landmarkcra.com

Guy Quattlebaum

📞 (561) 725-8204
✉ guy.quattlebaum@landmarkcra.com

HIGHLIGHTS

- High visibility location serving western Indian River County and I-95 highway traffic
- Cross access with signalized intersection at SR60 & 90th Ave.
- High growth area with many new retailers recently opened or under development
- Future growth planned around the site including the Corrigan Ranch development totaling 3,200 residential units and 12 million sf of commercial space.

OFFERING SUMMARY

Zoning: CG	SIZE
Parcel 1	2.03 ac
Parcel 2	2.72 ac

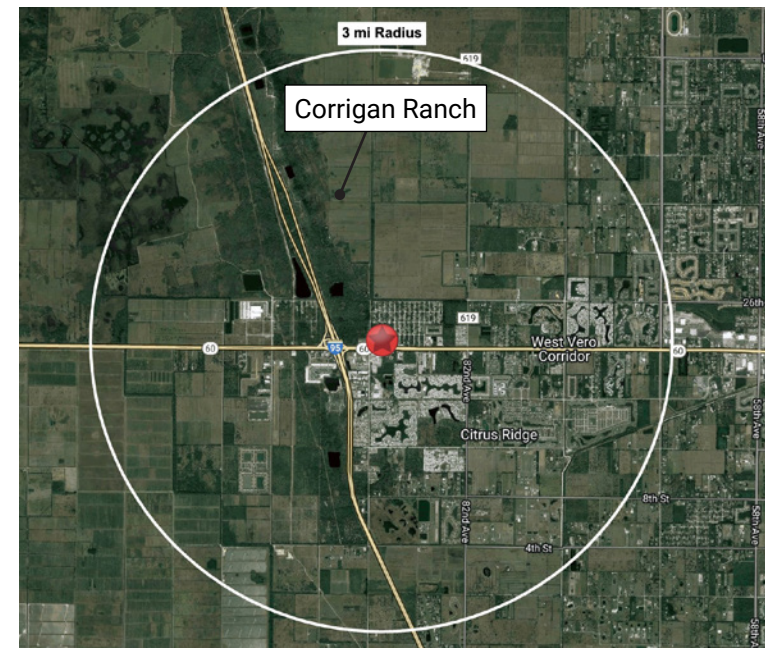

DEMOGRAPHICS (3 mi)



Population
13,310



Daytime
Population
3,303



Average HH
Income
\$73,559



Median
Age
62.2



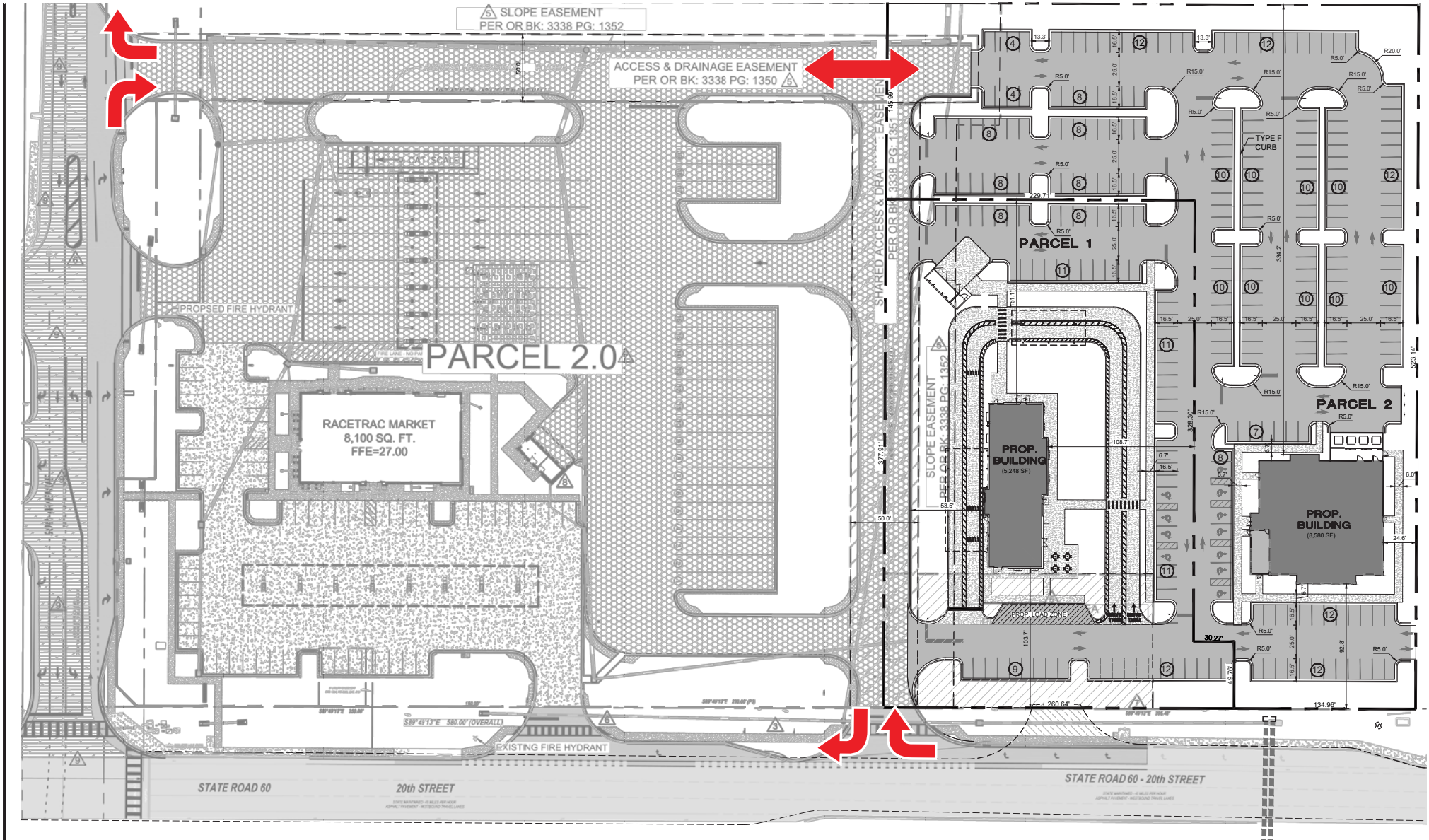

Landmark

P.O. Box 1625, West Palm Beach, FL 33402
(561) 729-7000
www.LandmarkCRA.com

Don DeWoody

☎ (561) 729-7000
✉ don.dewoody@landmarkcra.com

Alfredo Sanchez

☎ (561) 301-7690
✉ alfredo.sanchez@landmarkcra.com

Guy Quattlebaum

☎ (561) 725-8204
✉ guy.quattlebaum@landmarkcra.com

