

Argento on 67th

67th Ave & Pinnacle Peak Rd
Glendale, AZ 85310



New commercial development in Arrowhead

23423 N 67th Avenue, Glendale, AZ 85310 | Delivering in Q1 2025



Conceptual rendering

Property Highlights

- Retail or medical shop space available
- High growth area
- Average household income \$160,000 within 5 miles
- Zoned C-1
- 67th avenue widening to six lanes

Melka Capital
20715 N Pima Rd #108
Scottsdale, AZ 85255
480.841.6277
www.melkacapital.com

This document has been prepared by Melka Capital for advertising and general information only. Melka Capital makes no guarantees, representations or warranties of any kind, expressed or implied, regarding the information including, but not limited to, warranties of content, accuracy and reliability. Any interested party should undertake their own inquiries as to the accuracy of the information. Melka Capital excludes unequivocally all inferred or implied terms, conditions and warranties arising out of this document and excludes all liability for loss and damages arising there from. This publication is the copyrighted property of Melka Capital and/or its licensor(s). © 2024. All rights reserved. This communication is not intended to cause or induce breach of an existing listing agreement. Melka Capital, LLC.

Conceptual Site Plan

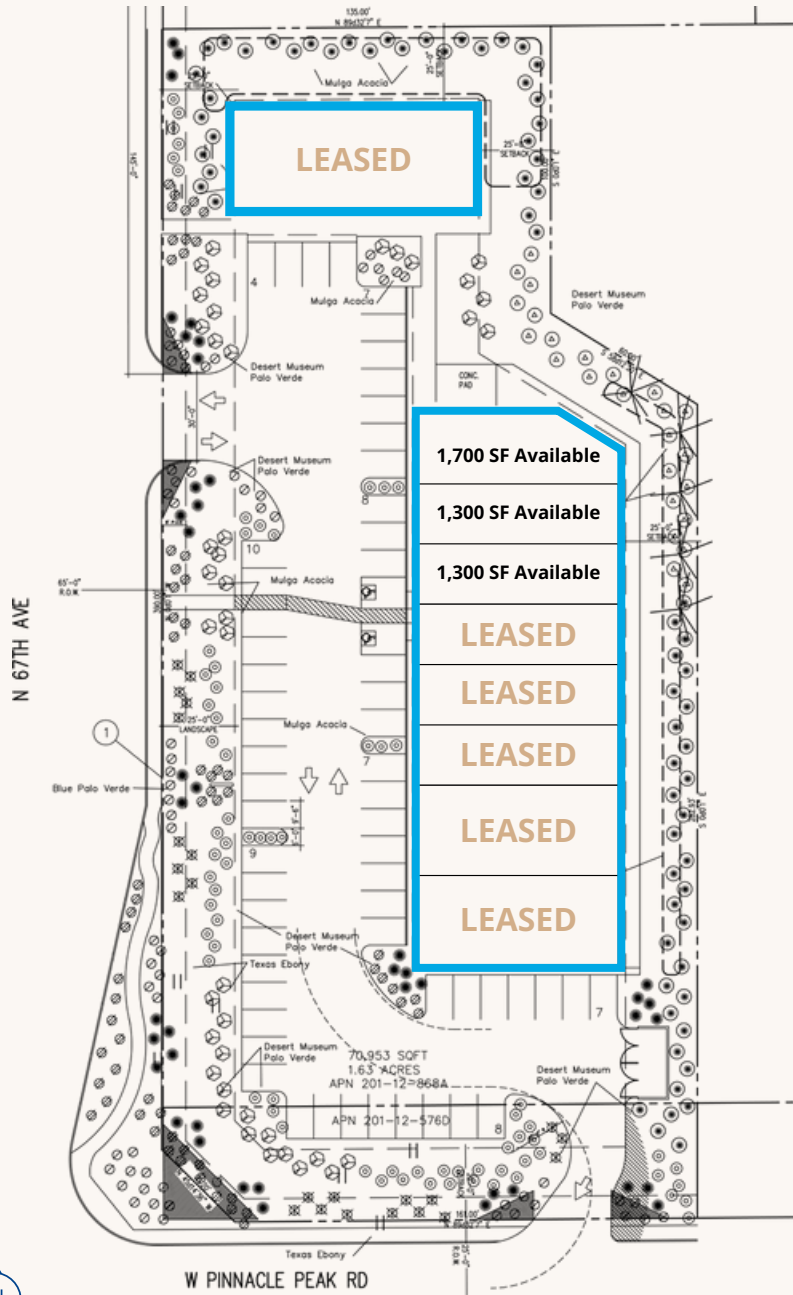

DEMOGRAPHICS WITHIN 5 MILES



Current Population
201,717



Annual Growth 2010-2023
1.1%



Daytime population
56,209



Average household income
\$160,621



Peoria Sunrise Mountain Preserve

Happy Valley School

Terramar Academy of the Arts

Happy Valley Rd ±33,293 VPD

Glendale Community College North



Las Brisas Elementary School

Bayer Private School



Shops Available

Pinnacle Peak Rd

Pinnacle Peak Rd



Pinnacle Pointe Academy

Mountain Ridge High School



±32,902 VPD

Copper Creek Elementary School



LIFETIME





Melka Capital
20715 N Pima Rd #108
Scottsdale, AZ 85255
480.841.6277
www.melkacapital.com



Single Family Housing
(coming soon)

Peoria Sunrise
Mountain
Preserve

Ludden
Mountain

±33,293 VPD

Happy Valley
Rd

Site

Pinnacle Peak
Rd

N 59th Ave

Thunderbird
Conservation
Park

DOLLAR TREE
Great Clips
Walgreens
Fry's
SONIC

Deer Valley Rd

83rd Ave

75th
Ave

67th Avenue (±33,902 VPD)

McDonald's
TESLIE'S
verizon
DUNKIN'
SAFEMART
babbo
SUBWAY

±125,094 VPD

101

Beardsley Rd

The Village at Arrowhead
chico's BBVA
francesca's
nēktar PET-MARKET
ups
PEI at&t

FIREHOUSE
SUBS
ACE
Hardware
BURGER
KING
Oggi's
99¢

