

2100

BARTOW AVENUE



WORK. SHOP. DINE. PLAY.

**Excellent office opportunity
in mixed use development**



2100

BARTOW AVENUE

Available direct space:

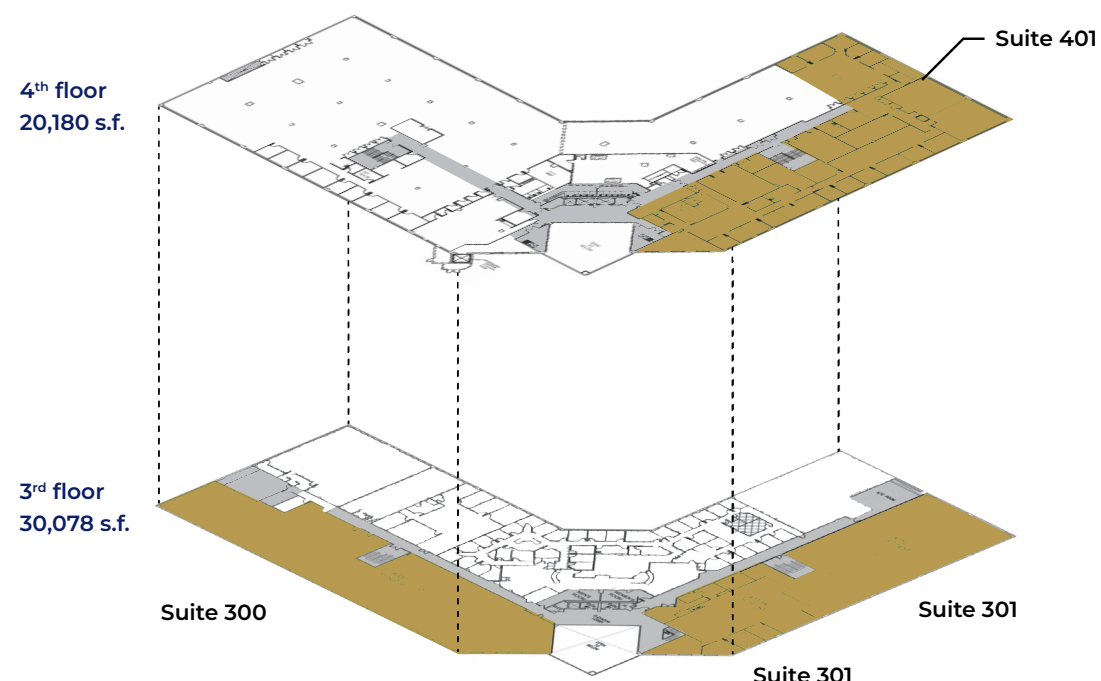

2100

BARTOW AVENUE

Bay Plaza Shopping Center

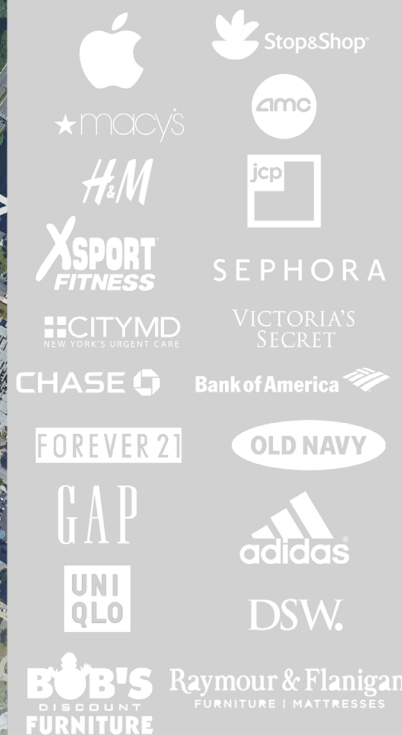

Premier office location with unparalleled access

Building features:

- Mixed-use development
- Excellent transportation system
- Visibility from I-95 and the Hutchinson Parkway
- Immediate access to major roadways
- Large blocks of contiguous space available
- Ample surface parking
- Over 20,000 households within walking distance of Bay Plaza
- Long standing professional ownership
- Great location for recruitment
- Tenant Exclusive Elevator/Private Entrance Available

Complex amenities:

- On-site management
- 24-hour security
- State-of-the-art 37,000+ SF 24 hour X Sport Fitness
- Over 150 stores, services & restaurants, including
- 10 in complex amenities
- Minutes from the proposed Co-op Metro-North station

Over 150 stores, services & restaurants, including:

Fast Food

Starbucks
Chipotle
Burger King
Popeyes
Sarku Japan
Shake Shack
Panera
Moe's
Halal Platters

Dine in

Red Lobster
Olive Garden
Hook and Reel
Dallas BBQ
Outback Steakhouse
Bed Stuy Fish Fry
Sabrosito
Koi Sushi

Services

Pharmacy
Medical & Dental
Stop & Shop
Beauty
Spa
Nail Salon
Gym

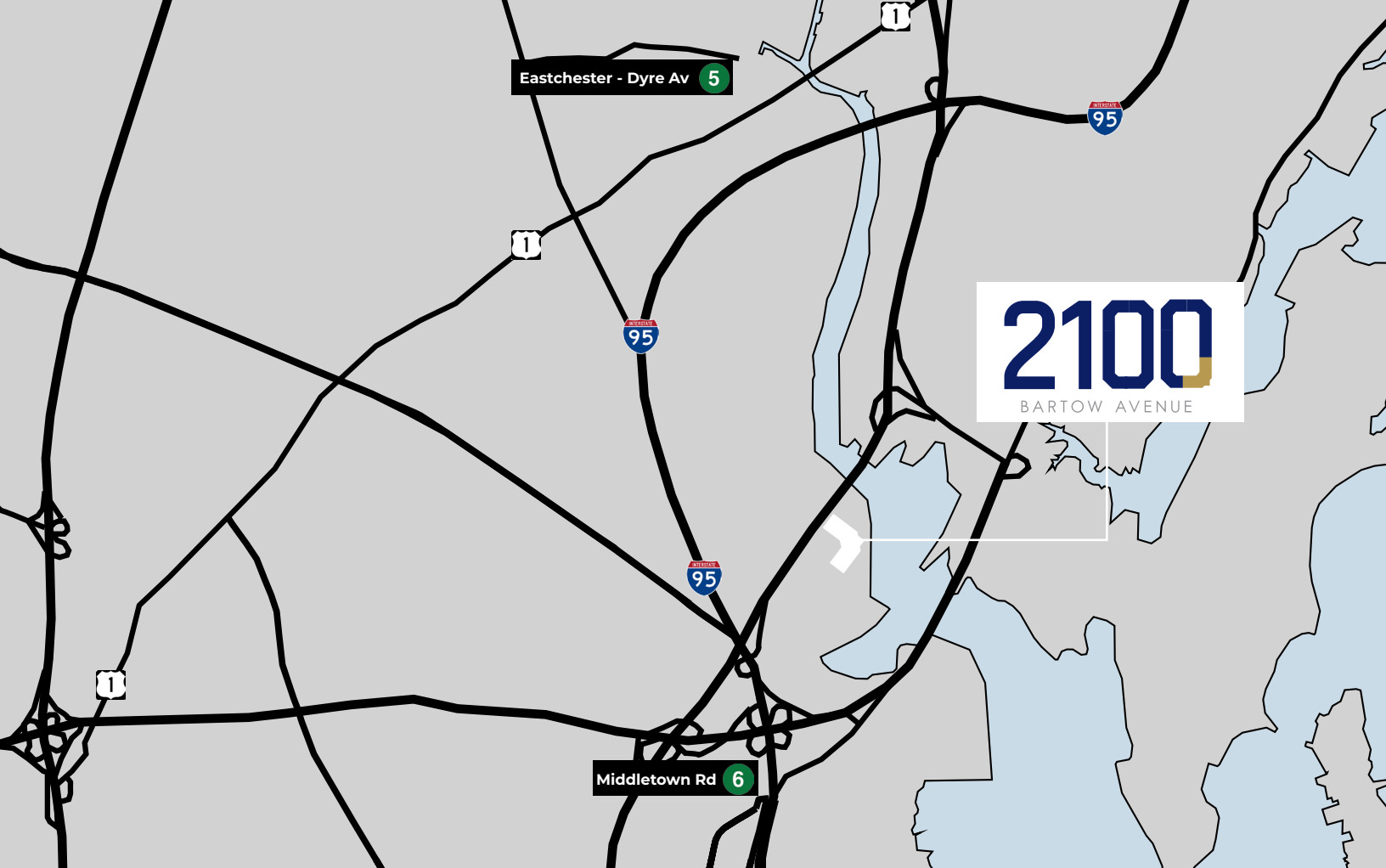

AL GUTIERREZ
+1 203 399 1387
al.gutierrez@jll.com

MARY GRACE SEARLES
+1 203 399 1406
marygrace.searles@jll.com



Although information has been obtained from sources deemed reliable, neither Owner nor JLL makes any guarantees, warranties or representations, express or implied, as to the completeness or accuracy as to the information contained herein. Any projections, opinions, assumptions or estimates used are for example only. There may be differences between projected and actual results, and those differences may be material. The Property may be withdrawn without notice. Neither Owner nor JLL accepts any liability for any loss or damage suffered by any party resulting from reliance on this information. If the recipient of this information has signed a confidentiality agreement regarding this matter, this information is subject to the terms of that agreement. ©2024. Jones Lang LaSalle IP, Inc. All rights reserved.

