



**THE DIKMAN  
COMPANY**

Licensed Real Estate Broker

Commercial/Industrial Real Estate Services

**Raising the Bar in Customer Satisfaction**

## **8,971 SF Warehouse Space Available for Lease 420 Ware Boulevard, Unit C, Tampa, FL 33619**

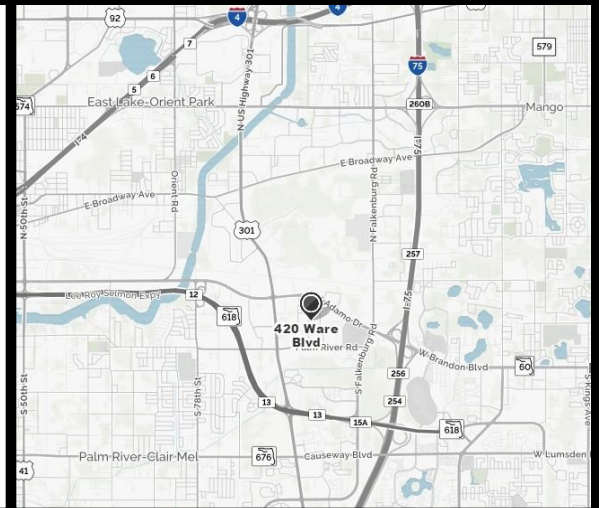

- **GREAT East Tampa location! Just off Adamo (SR 60) Only 4.5 miles to I-4, less than 1 mile to US Hwy 301, and 1.5 miles to I-75**
- **20' Clear Height**
- **5 dock high overhangs**
- **\$6.50/sf NNN; Operating expenses estimated at \$2.34/sf**
- **8,971 SF with 1,129 SF office**
- **3 phase power; 400 amp 120/208 volt**
- **Front load; concrete block construction**
- **Big Ass Fan to help with airflow in warehouse**



**Erika Zipfel Thompson**  
**SIOR Member Associate**  
Licensed Real Estate Associate  
Commercial/Industrial Brokerage

813-215-4342 (cell)  
erika@dikman.com

**Sales**  
**Leasing**  
**Property Management**  
**Development**  
**Tenant Representation**  
**Investment Counseling**  
**Asset Analysis**

No warranty or representation, expressed or implied, is made as to the accuracy of the information contained herein, and same is submitted subject to errors, omissions, change of price, rental or other conditions, withdrawal without notice, and to any special conditions by our principals.



**THE DIKMAN  
COMPANY**  
Licensed Real Estate Broker  
Commercial/Industrial Real Estate Services

**Raising the Bar in Customer Satisfaction**

**8,971 SF Warehouse Space Available for Lease  
420 Ware Boulevard, Unit C, Tampa, FL 33619**

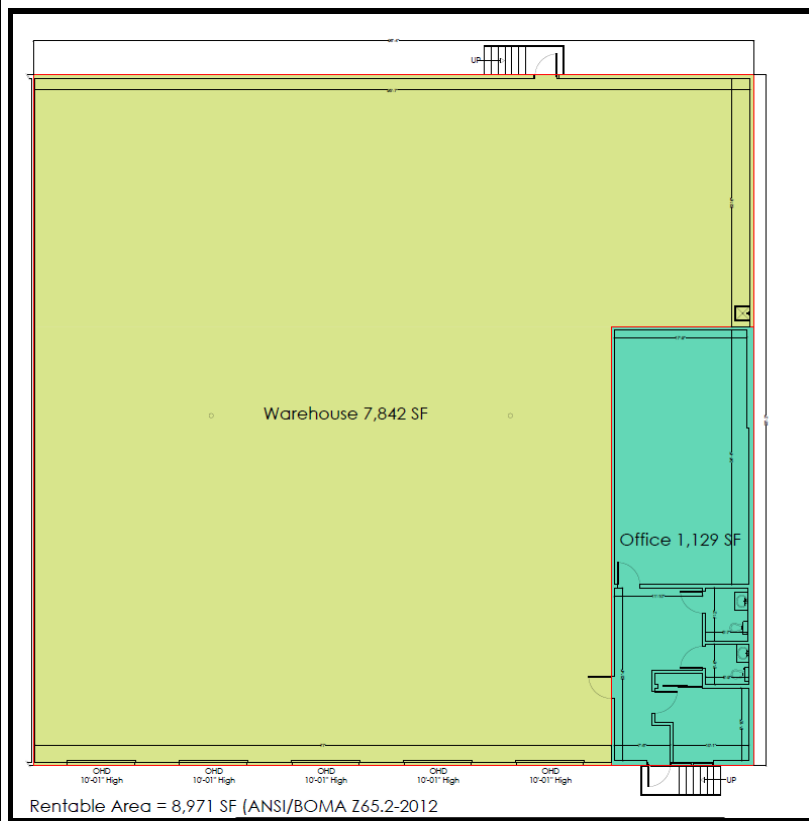

**Erika Zipfel Thompson**  
**SIOR Member Associate**  
Licensed Real Estate Associate  
Commercial/Industrial Brokerage

813-215-4342 (cell)  
erika@dikman.com

**Sales  
Leasing  
Property Management  
Development  
Tenant Representation  
Investment Counseling  
Asset Analysis**

No warranty or representation, expressed or implied, is made as to the accuracy of the information contained herein, and same is submitted subject to errors, omissions, change of price, rental or other conditions, withdrawal without notice, and to any special conditions by our principals.