

For Sublease

1551 Sandspur Road

Maitland, FL 32751



Up to 13,043± sf available

**AVISON
YOUNG**

Jordan Bohannon
Senior Vice President
407.219.3502
jordan.bohannon@avisonyoung.com



Sublease Overview

Avison Young is pleased to present the opportunity to sublease up to 5,572± SF - 13,043± RSF of recently built-out office space at 1551 Sandspur Road. The building location provides convenient access off Interstate-4 and Maitland Boulevard with access to nearby amenities, including Genesis Health Club, hotels, and restaurants. The suite is positioned off the building main lobby with a glass double door entrance and interior improvements suitable for a regional or corporate office.

PROPERTY HIGHLIGHTS

EASY ACCESS TO INTERSTATE-4

NEWLY RENOVATED LOBBY

**HIGHLY VISIBLE FROM
MAITLAND BOULEVARD**

SUBLEASE THROUGH APRIL 6, 2031

4/1,000 SF PARKING RATIO

**FURNITURE, FIXTURES AND
EQUIPMENT - NEGOTIABLE**

**GENESIS HEALTH CLUB, HOTELS
AND RESTAURANTS NEARBY**

SUBLEASE RATE - NEGOTIABLE



Floorplan

5,572± - 13,043± SF

SUBLEASE EXPIRES 04/06/31

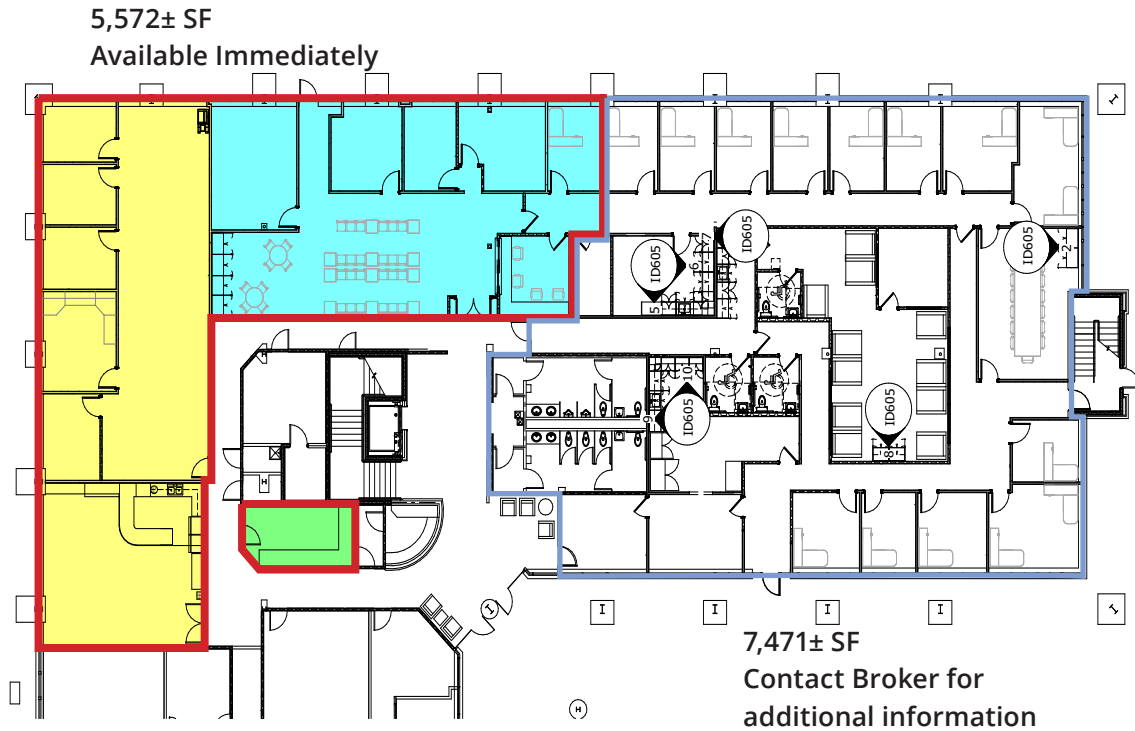

© 2024 Avison Young - Florida, LLC. All rights reserved. E. & O.E.: The information contained herein was obtained from sources which we deem reliable and, while thought to be correct, is not guaranteed by Avison Young.

**AVISON
YOUNG**

Jordan Bohannon

Senior Vice President

407.219.3502

jordan.bohannon@avisonyoung.com

Photos

