

RETAIL SPACE FOR LEASE

5976 MEIJER DRIVE

Milford, OH 45150



TC Bartoszek
tc@lee-associates.com
D 513.588.1840

LEE & ASSOCIATES
COMMERCIAL REAL ESTATE SERVICES

All information furnished regarding property for sale, rental or financing is from sources deemed reliable, but no warranty or representation is made to the accuracy thereof and same is submitted to errors, omissions, change of price, rental or other conditions prior to sale, lease or financing or withdrawal without notice. No liability of any kind is to be imposed on the broker herein.

RETAIL SPACE FOR LEASE

5976 MEIJER DRIVE

Milford, OH 45150

FOR LEASE: 1,604 SF

PRICING: \$20.00 PSF NNN + \$7.42 PSF

- Fronts Meijer and Butterbee's
- Rapidly growing area
- Excellent parking
- Attractive, highly visible center
- Corner traffic light
- Join Jersey Mike's, Hot Head Burritos, Jets Pizza, and more

TRAFFIC COUNTS:

- SR 28 at Meijer Dr. – 27,709 VPD



RETAIL SPACE FOR LEASE

5976 MEIJER DRIVE

Milford, OH 45150

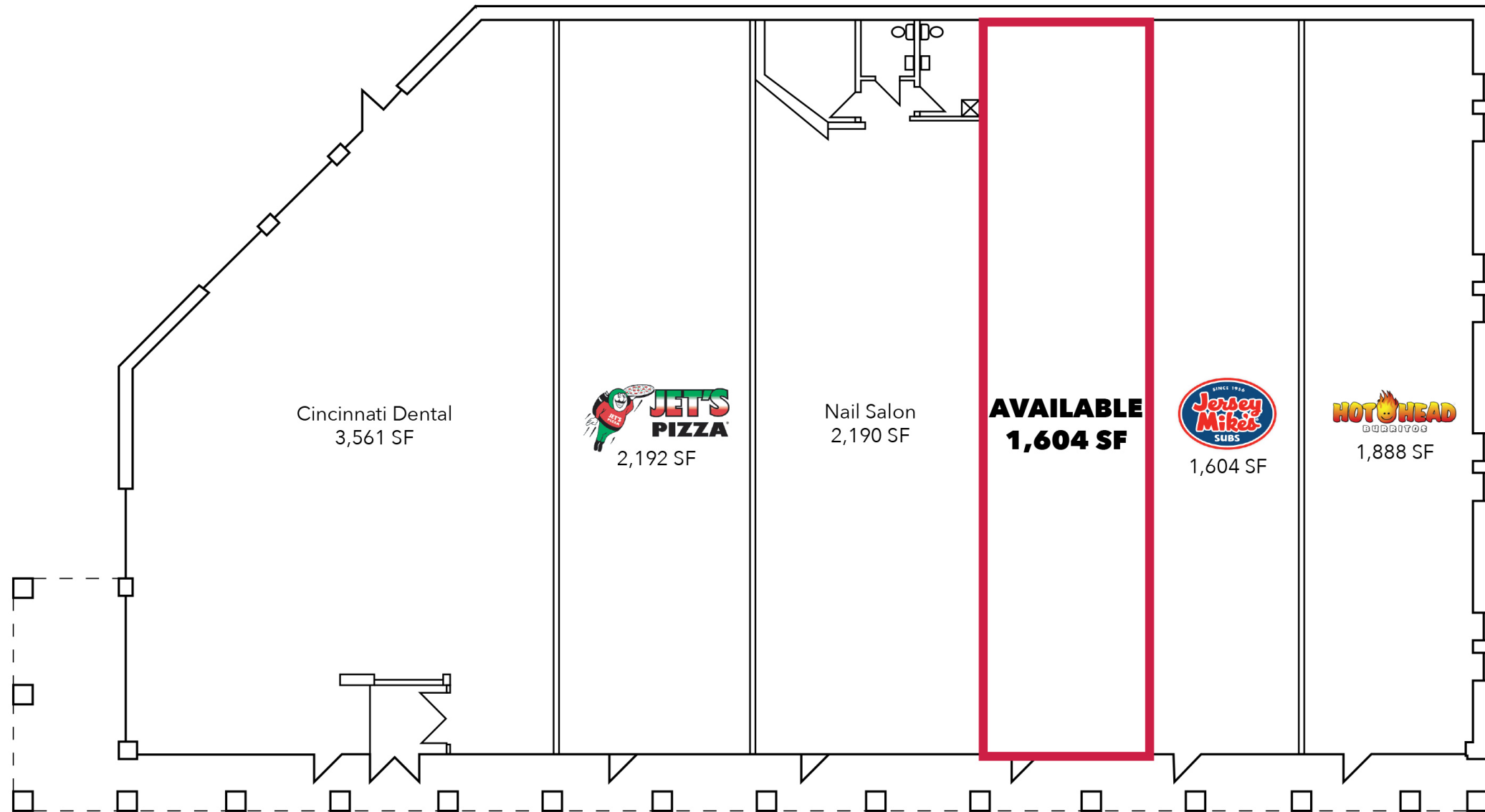

RETAIL SPACE FOR LEASE

5976 MEIJER DRIVE

Milford, OH 45150

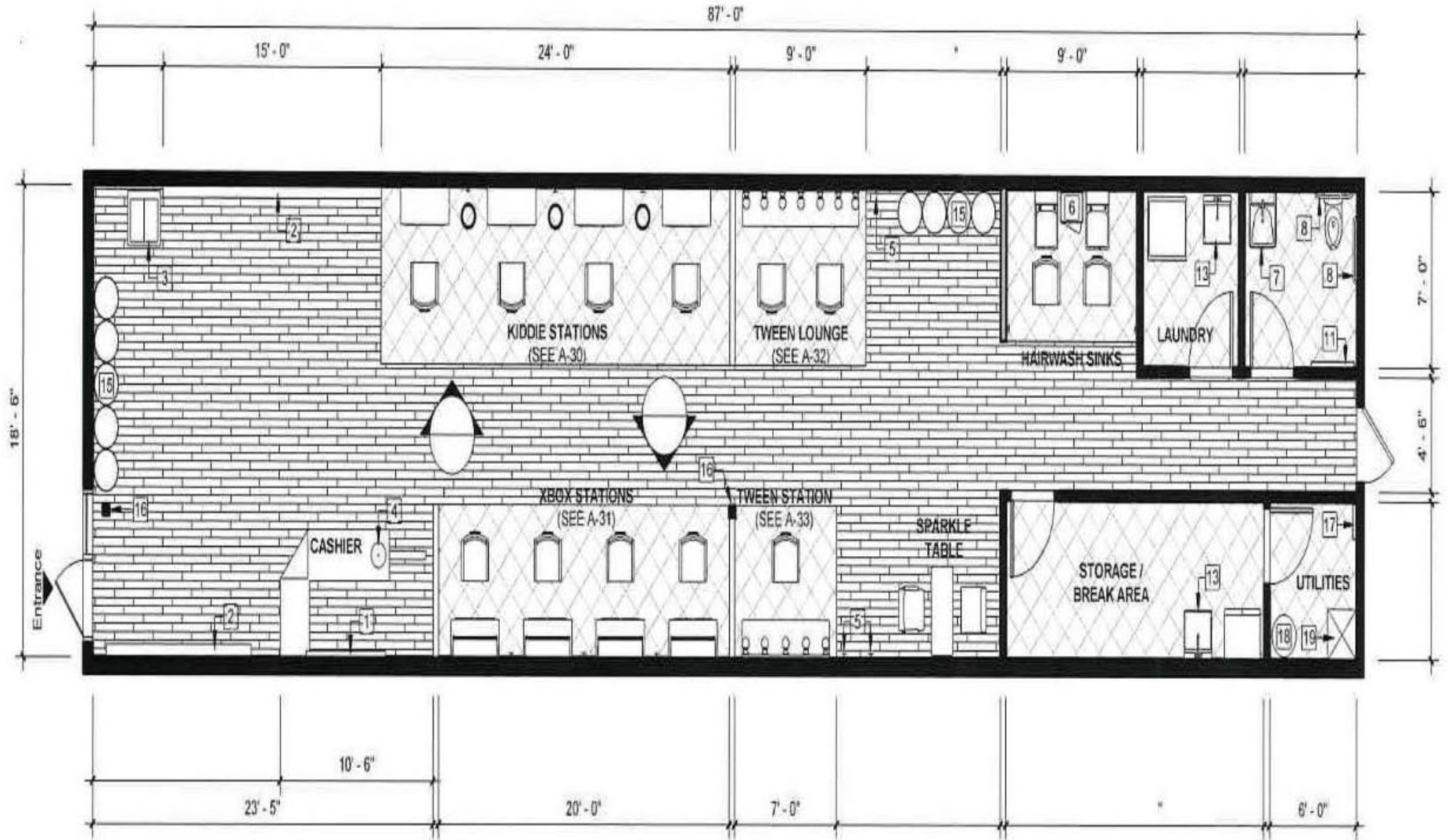

AERIAL



AERIAL

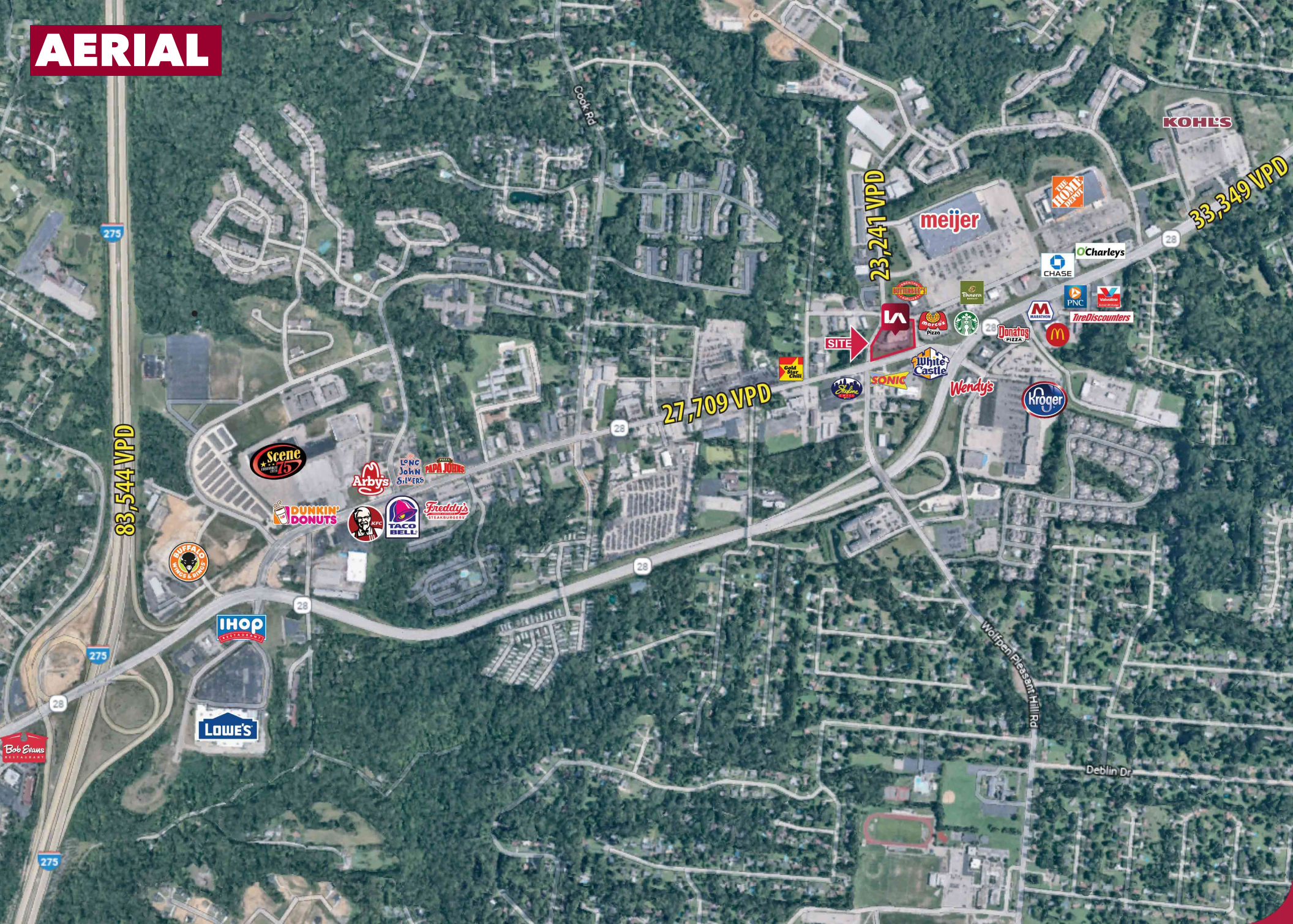

DEMOGRAPHICS

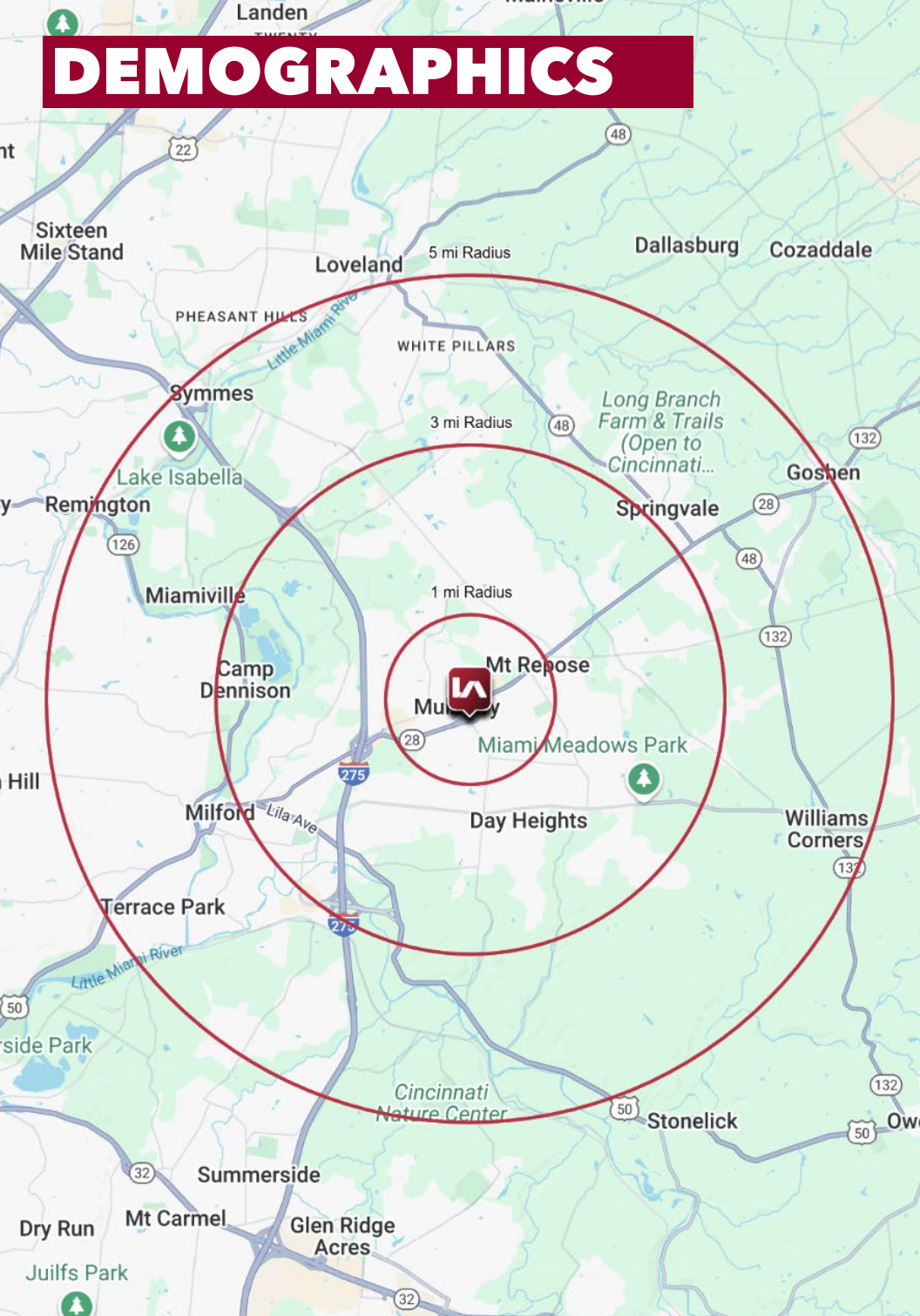

	1 MI RADIUS	3 MI RADIUS	5 MI RADIUS
POPULATION			
2025 Estimated Population	8,052	43,447	76,519
2030 Projected Population	8,071	44,233	77,660
2020 Census Population	7,690	42,563	75,282
2010 Census Population	7,154	40,361	71,449
Projected Annual Growth 2025 to 2030	-	0.4%	0.3%
Historical Annual Growth 2010 to 2025	0.8%	0.5%	0.5%
HOUSEHOLDS			
2025 Estimated Households	3,372	17,069	29,554
2030 Projected Households	3,431	17,658	30,464
2020 Census Households	3,231	16,566	28,645
2010 Census Households	2,909	15,197	26,283
Projected Annual Growth 2025 to 2030	0.4%	0.7%	0.6%
Historical Annual Growth 2010 to 2025	1.1%	0.8%	0.8%
AGE			
2025 Est. Population Under 10 Years	12.1%	11.6%	11.5%
2025 Est. Population 10 to 19 Years	12.5%	13.3%	13.9%
2025 Est. Population 20 to 29 Years	12.0%	10.3%	9.8%
2025 Est. Population 30 to 44 Years	18.6%	20.0%	19.3%
2025 Est. Population 45 to 59 Years	17.4%	18.9%	19.7%
2025 Est. Population 60 to 74 Years	17.8%	17.7%	17.9%
2025 Est. Population 75 Years or Over	9.7%	8.1%	7.9%
2025 Est. Median Age	40.5	40.9	41.4
MARITAL STATUS & GENDER			
2025 Est. Male Population	49.2%	49.8%	50.1%
2025 Est. Female Population	50.8%	50.2%	49.9%
2025 Est. Never Married	28.5%	25.4%	24.5%
2025 Est. Now Married	45.9%	52.8%	55.4%
2025 Est. Separated or Divorced	17.6%	15.3%	14.0%
2025 Est. Widowed	8.1%	6.4%	6.0%
INCOME			
2025 Est. HH Income \$200,000 or More	16.3%	17.4%	22.1%
2025 Est. HH Income \$150,000 to \$199,999	8.2%	11.9%	12.4%
2025 Est. HH Income \$100,000 to \$149,999	17.5%	20.1%	19.0%
2025 Est. HH Income \$75,000 to \$99,999	11.9%	12.1%	11.7%
2025 Est. HH Income \$50,000 to \$74,999	17.6%	14.7%	13.6%
2025 Est. HH Income \$35,000 to \$49,999	9.7%	8.5%	7.3%
2025 Est. HH Income \$25,000 to \$34,999	7.6%	5.8%	5.2%
2025 Est. HH Income \$15,000 to \$24,999	5.4%	4.8%	4.1%
2025 Est. HH Income Under \$15,000	5.8%	4.8%	4.6%
2025 Est. Average Household Income	\$115,470	\$130,925	\$150,299
2025 Est. Median Household Income	\$81,653	\$102,506	\$117,468
2025 Est. Per Capita Income	\$48,569	\$51,524	\$58,143
2025 Est. Total Businesses	225	1,315	2,309
2025 Est. Total Employees	2,250	15,383	24,482