

High-Traffic Arapahoe Retail Lease

3340 ARAPAHOE AVE | BOULDER, CO

Size: 640 SF

Rate: \$2,000/mo NNN

Available: 1/1/2025



LOCATION, LOCATION...

28,000 cars drive by per day. Countless pedestrians walk by. Bikes pedal by. Scooters scoot by. Busses stop by. Someone probably hops by on a pogo stick every now and again. The point is: this place has serious visibility and exposure. Arapahoe is one of Boulder's main drags, and now your business could make a home in the middle of the action. After all, being seen is a big part of being successful.

PROPERTY HIGHLIGHTS

- High-traffic retail on Arapahoe
- Building and monument signage
- Open layout ready for buildout
- Plenty of parking
- Private restroom



LEARN MORE ABOUT THIS PROPERTY
MarketRealEstate.com

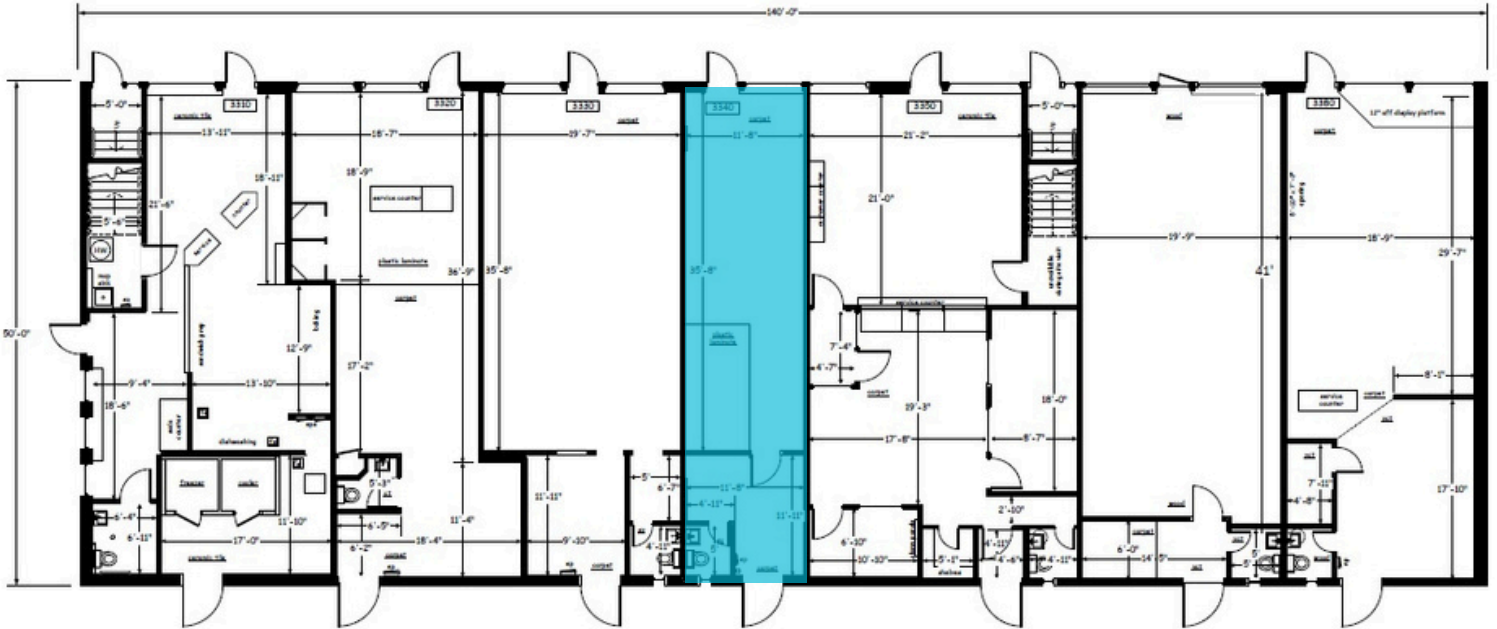

TODD WALSH, CCIM

303 444 5040 Todd@MarketBoulder.com

LEARN MORE ABOUT THIS PROPERTY
MarketRealEstate.com