

Presented by Donnie Walker, Walker Realty Group, KW Commercial

11510 Nacogdoches Rd | San Antonio, TX 78217
PROPERTY INFORMATION SHEET



This image has been digitally enhanced using AI rendering tools.

Property Overview

Attribute	Details
Building Size	±8,007 SF
Lot Size	±0.60 Acres
Zoning	C-3
Construction	Tilt-wall with metal building addition
Layout	±10–15% office ±85–90% warehouse
HVAC	4 AC units (15-20+ years of age)

Access	Two driveway entrances
Bays	Three roll-up bays
Power	3-Phase available
Yard	Fully fenced and secured
Subdividable	Yes – flexible layout for multi-tenant or single-user use

Strategic Location

11510 Nacogdoches Rd offers unmatched access to San Antonio’s major highways and commercial corridors:

- Interstate 35 (≈ 2.5 miles east) — Direct route to Downtown San Antonio (≈20 min), New Braunfels (≈35 min), Austin (≈1.15 hr), and Laredo.
Critical NAFTA trade and logistics corridor.
- Loop 410 (≈ 3 miles southwest) — Connects to San Antonio International Airport and all major business districts.
- Wurzbach Parkway (≈ 1 mile west) — Efficient cross-town connector between I-35 and US-281.
- Thousand Oaks Drive — High-traffic arterial with excellent exposure and retail/service synergy.

Area Highlights

- Stable submarket near Zachry Cement Plant and other long-term industrial users.
- Within 15 minutes of San Antonio International Airport and I-35 logistics corridor.
- Surrounded by contractor yards, auto repair, manufacturing, and supply operations.

City of San Antonio – Northeast Corridor (NEC) Revitalization Program

This property lies within the City’s NEC Revitalization Area, which supports reinvestment and infrastructure upgrades along the Nacogdoches/Perrin Beitel corridor. Benefits include potential façade grants, design assistance, and small business incentives.

Link: <https://www.sa.gov/Directory/Departments/Planning/Corridor-Plans/NEC>

Functional Advantages

- Tilt-wall construction with metal addition for strength and flexibility.

- Two driveways for efficient circulation and truck access.
- Three large bays ideal for deliveries, fleet service, or warehouse operations.
- Fully fenced yard.
- 3-Phase power.
- Partially conditioned warehouse.

Key Benefits

Prime NE San Antonio location with I-35, Loop 410, and Wurzbach Parkway access.

C-3 Zoning

Tilt-wall construction with metal addition and fenced yard.

Located within NEC Revitalization Zone for long-term growth potential.

Call/text Donnie Walker, KW Commercial for more information.

210-378-0878

donnie@walkertexasre.com

C:\Project Work Files\Walker Realty Group\11510 Nacogdoches Road - San Antonio, Texas\180-01-01 11510 Nacogdoches Road As-Built Floor Plan 01-01.dwg , Plotted on: Jan 20, 2026 - 1:37pm

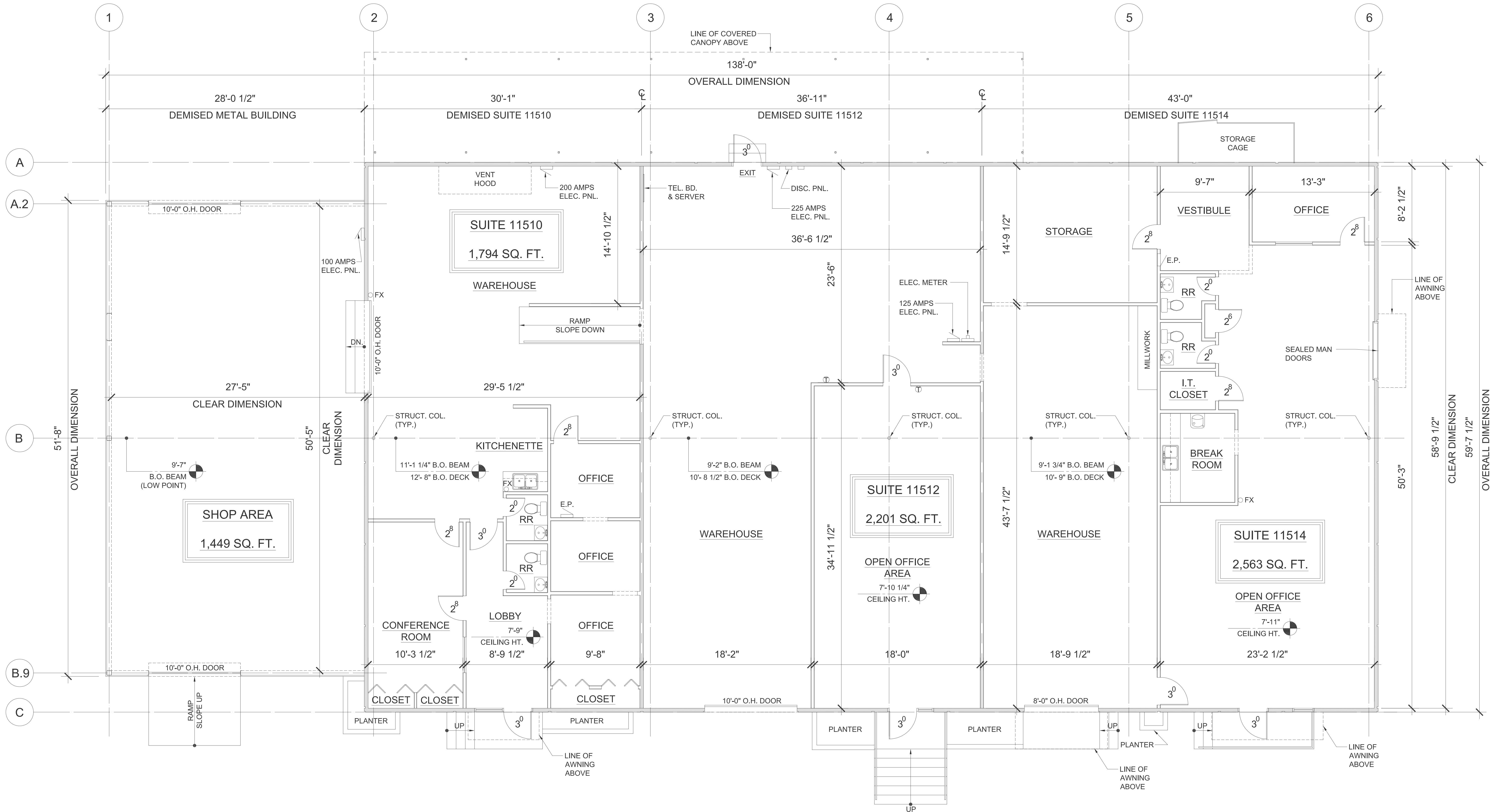

SF SUMMARY

SHOP AREA (METAL BLDG.)	1,449 SF
SUITE 11510	1,794 SF
SUITE 11512	2,201 SF
SUITE 11514	2,563 SF
TOTAL	8,007 SF

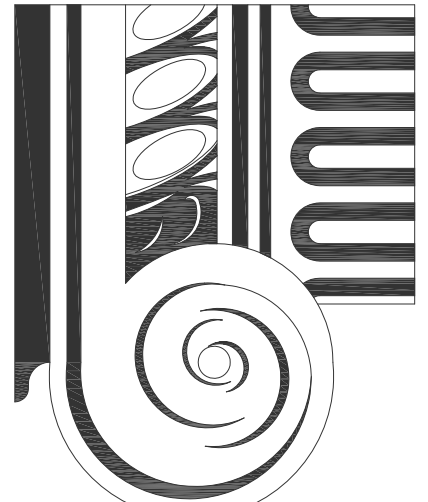

PHONE: 214-507-2486
EMAIL: kssgreek1969@att.net

ISSUED
1-20-26

NOT FOR CONSTRUCTION
THIS DRAWING MAY NOT BE USED FOR REGULATORY
APPROVAL, PERMITTING, OR CONSTRUCTION
KONSTANTINOS SOTIROPOULOS
TEXAS REGISTRATION NO. 12570

Office / Warehouse Building
11510 Nacogdoches Road
San Antonio, TX 78217
Lease Outline Drawing

Project No. 180.01.01

SHEET
LP

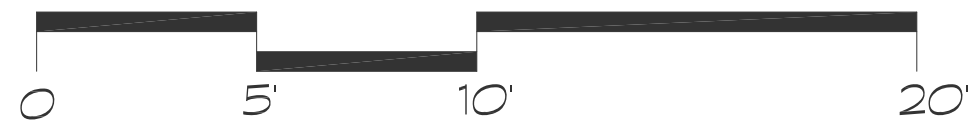

LEASING FLOOR PLAN

180-01-01 Leasing Floor Plan 01-01

