

Prime Corner Restaurant Opportunity in Williamsburg, Brooklyn
Address: 571 Lorimer Street, Brooklyn, NY 11211 – Corner of
Metropolitan Ave

Seize this rare opportunity to acquire a standout corner location in one of Williamsburg's most coveted intersections. Positioned at the high-traffic junction of Lorimer St and Metropolitan Ave, this space is just steps away from the recently renovated L Train Lorimer/Metropolitan Ave station, ensuring steady foot traffic.

Key Features:

Below Market Rent at \$10,400/month with real estate taxes of \$1,200/month

Rooftop Space: Custom-made greenhouse structure enables year-round usage, with stunning views over Metropolitan Ave.

Public Assembly Permit for 150 people (75 per floor)
Separate Liquor Licenses for Each Floor until 2 AM – smooth transfer process with a supportive relationship from the community board

Fully Equipped Kitchen: Unique Airstream “Bulleit” trailer setup with gas connections, griddle, charcoal grill, deep fryer, steam table, and walk-in refrigerator

ADA Compliance: Elevator provides full legal access to the rooftop, alongside ADA-compliant restrooms on both floors

Charming Dining Areas: Street-level dining room plus an upper floor with a second restroom

Cooperative Landlord: 10 years remaining on the lease with the option for a brand new 15-year lease for the right operator

This turn-key operation includes all kitchen and bar equipment as-is and offers a seamless transition for an incoming operator with the potential for long-term stability. Don't miss out on this premier space in Williamsburg's vibrant culinary scene.

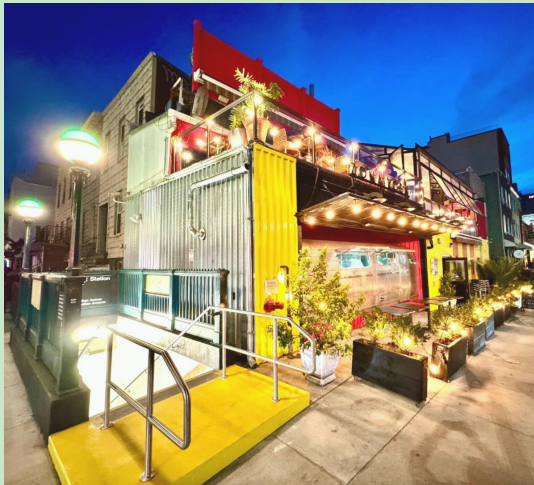



Joe Robinson | 2474 Marshall Avenue | North Bellmore, NY 11710 US

[Unsubscribe](#) | [Update Profile](#) | [Constant Contact Data Notice](#)



Try email marketing for free today!