



For sublease

7272 Kingspointe Parkway, Orlando, FL 32819

99,496± SF available

 JLL SEE A BRIGHTER WAY

Property details

Property specifications

- 99,496 SF available
- 8,074 ±SF of office
- 24' clear height
- 27 dock doors
- 2 drive-ins
- Rear load
- 40' x 45' column spacing
- 180' building depth
- ESFR fire protection
- 200 amps 277/480 volt power
- 185' truck court
- 1.25/1,000 SF parking ratio
- Trailer parking available
- Built in 2008
- Zoned I-P, City of Orlando
- Sublease through 10/31/2026
- \$6.32/SF NNN



	30 minutes	60 minutes	120 minutes
Total population	1,185,966	3,619,136	9,881,890
Total households	439,746	1,354,146	3,965,613
Average HH income	\$109,997	\$108,151	\$104,510
Total businesses	64,676	138,618	372,461
Total employees	722,407	1,474,609	3,795,572

Floor plan

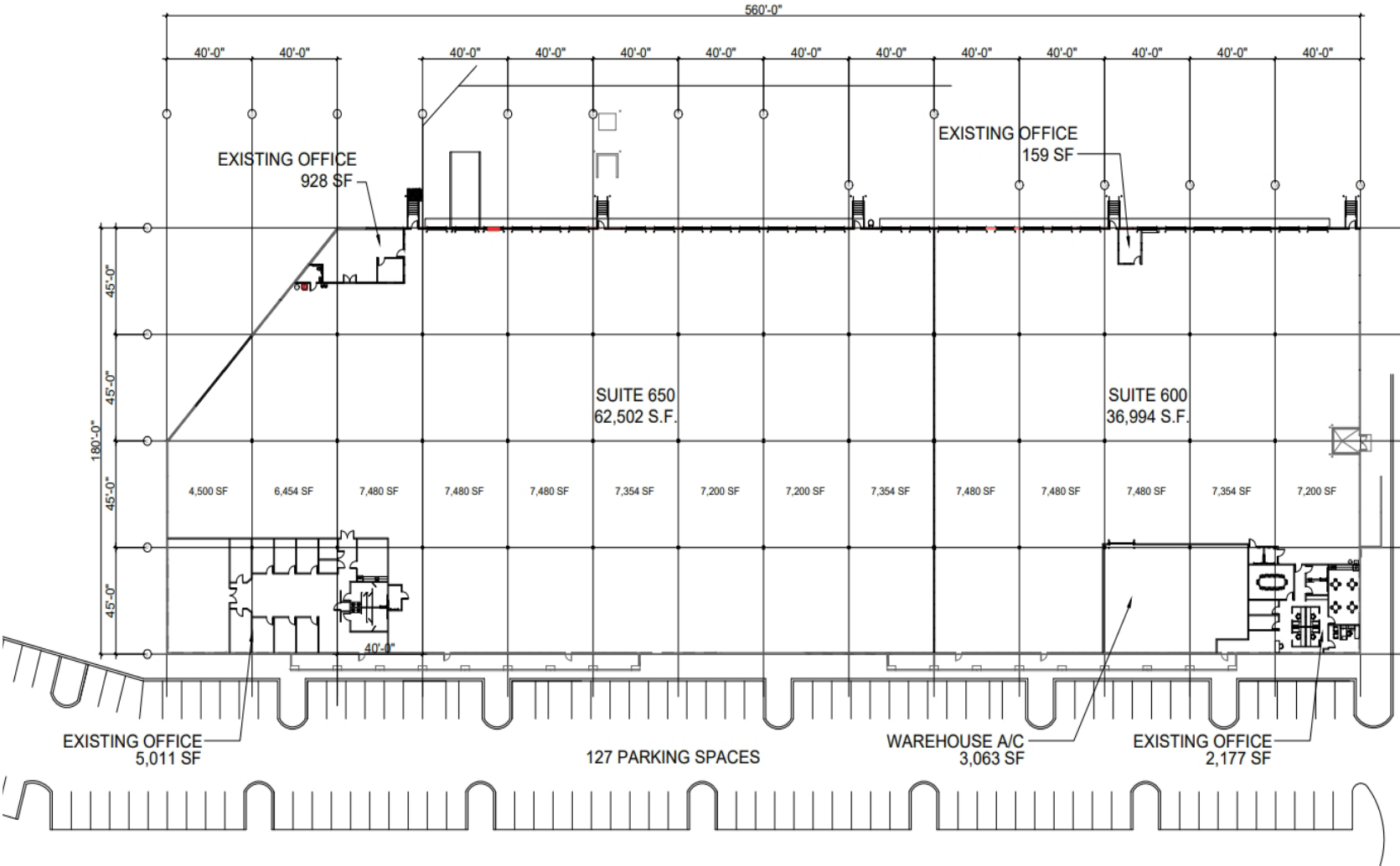

Location

Advantages

- Excellent access to Sand Lake Rd, John Young Pkwy, Orange Blossom Tr, and the Interstate 4-Florida's Turnpike interchange
- Minutes from Florida Mall, Universal Studios Florida theme parks and resorts, including the new EPIC Universe; Orange County Convention Center; the I-Drive tourist corridor; Orlando International Premium Outlets; Lockheed Martin; Orlando International Airport and downtown Orlando

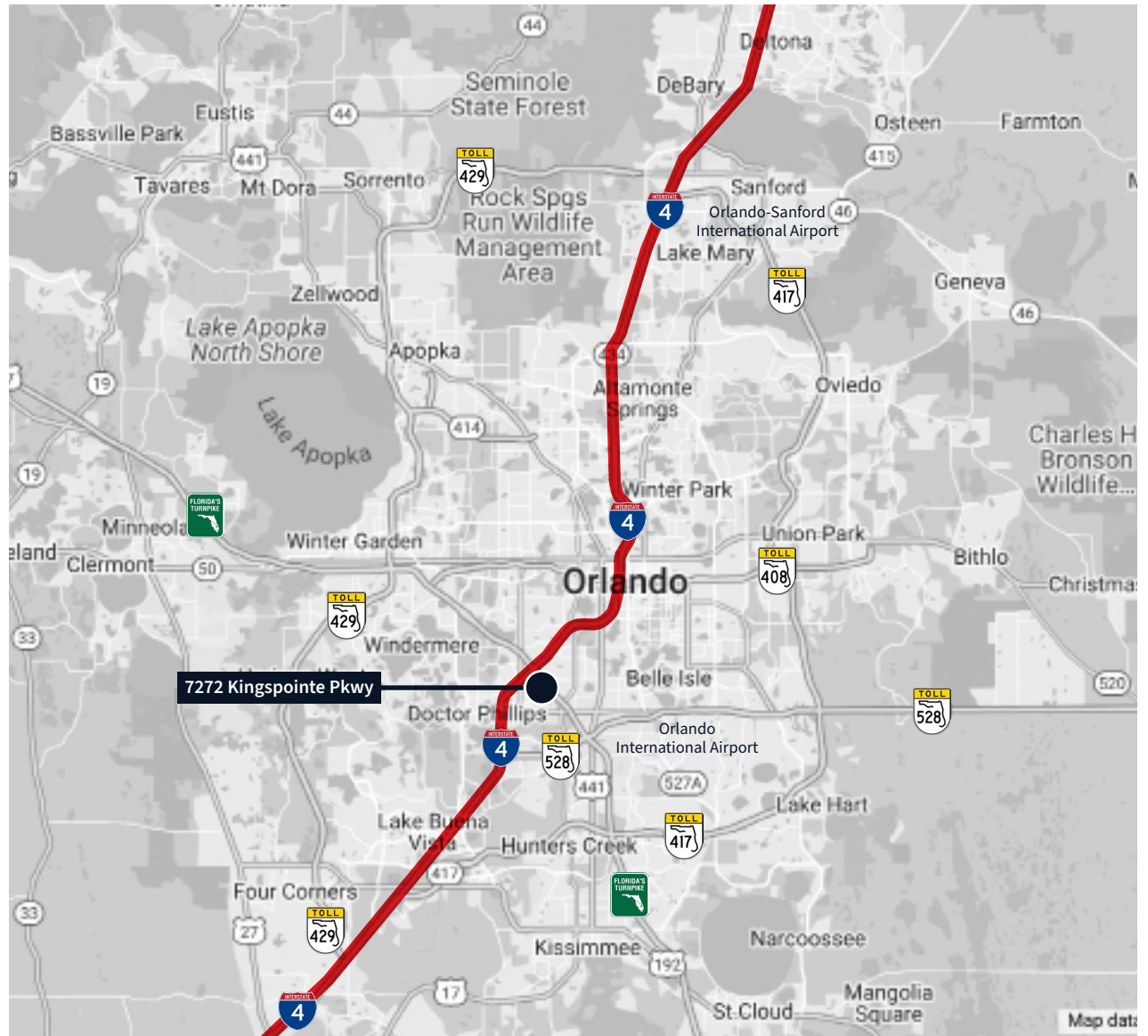

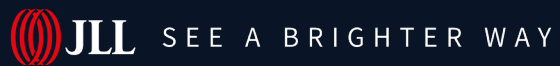

JLL

Cameron Montgomery

Vice President

407 982 8650

cameron.montgomery@jll.com

Although information has been obtained from sources deemed reliable, JLL does not make any guarantees, warranties or representations, express or implied, as to the completeness or accuracy as to the information contained herein. Any projections, opinions, assumptions or estimates used are for example only. There may be differences between projected and actual results, and those differences may be material. JLL does not accept any liability for any loss or damage suffered by any party resulting from reliance on this information. If the recipient of this information has signed a confidentiality agreement with JLL regarding this matter, this information is subject to the terms of that agreement. ©2025. Jones Lang LaSalle Brokerage, Inc. All rights reserved.

Jones Lang LaSalle Brokerage, Inc., a licensed real estate broker across the US | 250 South Orange Avenue, Suite 700P, Orlando, FL 32801