



FOR LEASE

- 12,724 Square Foot Industrial Building
- 2,274 Square Feet of Two Story Office Space
- 1 Ground Level Doors (12' x 14')
- 19 Parking Stalls
- 17' Minimum Clear Height
- 800 Amps 277/480 Volt (Verify)
- 3 Subfeeds to Electrical Stub Ups
- 3 Restrooms
- Fire Sprinklered
- Immediate Access to 15 and 91 Freeways



RYAN MOORE
Senior Vice President | Partner
909.545.8011
RMoore@voitco.com
Lic#01821438

RYAN SHATTUCK
Associate
714.514.5792
RShattuck@voitco.com
Lic#02228315

Voit
REAL ESTATE SERVICES

FOR LEASE - 12,724 SF

9121 PULSAR COURT, CORONA, CA

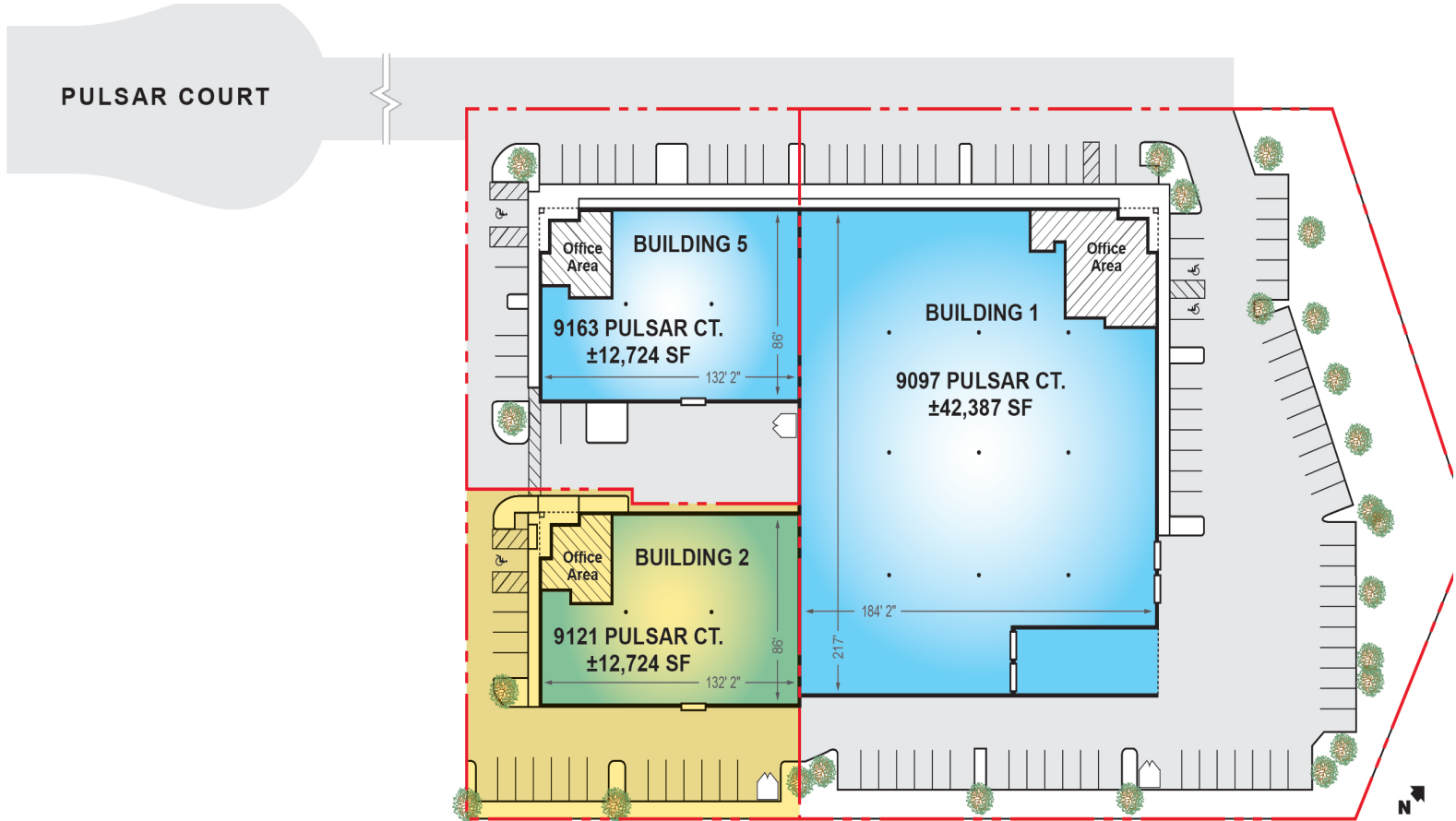

* Site Plan Not To Scale

RYAN MOORE
Senior Vice President | Partner
909.545.8011
RMoore@voitco.com
Lic#01821438

RYAN SHATTUCK
Associate
714.514.5792
RShattuck@voitco.com
Lic#02228315

Voit
REAL ESTATE SERVICES

FOR LEASE - 12,724 SF

9121 PULSAR COURT, CORONA, CA

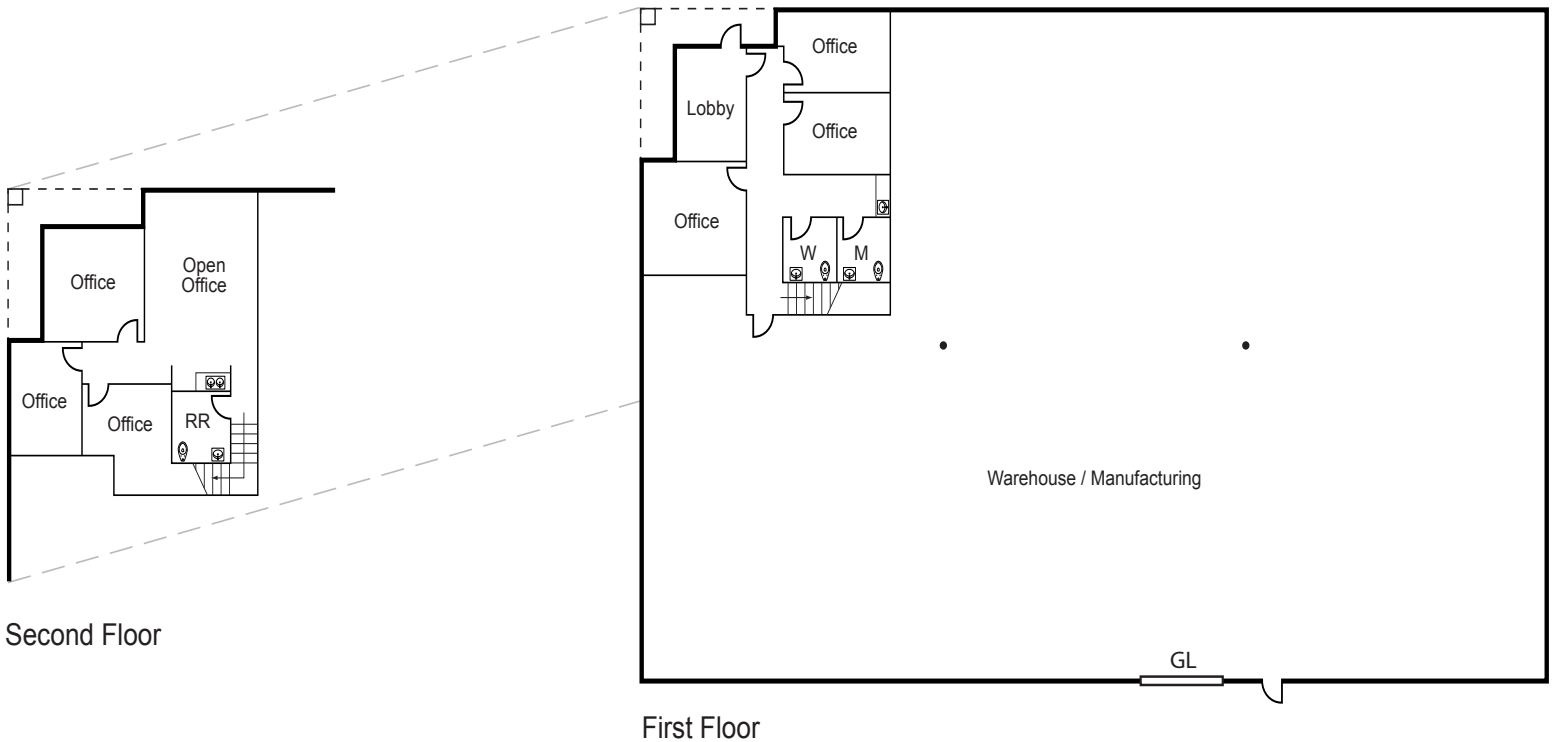

* Site Plan Not To Scale

RYAN MOORE
Senior Vice President | Partner
909.545.8011
RMoore@voitco.com
Lic#01821438

RYAN SHATTUCK
Associate
714.514.5792
RShattuck@voitco.com
Lic#02228315

Voit
REAL ESTATE SERVICES