

OFFICE SPACE FOR LEASE AT SUNSET POINTE PLAZA



25129 The Old Road, Stevenson Ranch, CA 91381

+/- 2,233 to 2,684 SF Available | \$2.70/SF Full Service Gross

VISIT US AT WWW.SUNSETPOINTEPLAZA.NET

CONTACTS:



Aaron Avila
Senior Vice President | DRE #02037778
Office: (661) 295-9300
Cell: (661) 993-9873
Aaron@crissmancommercial.com



Dean Cox
Senior Vice President | DRE #01331788
Office: (661) 295-9300
Cell: (661) 644-6120
Dean@crissmancommercial.com



CRISSMAN
COMMERCIAL SERVICES
LAND LEASING INVESTMENT MANAGEMENT

SUNSET POINTE PLAZA



This information contained herein was obtained from sources deemed to be reliable; however Crissman Commercial Services and RE/MAX of Santa Clarita make no guarantees, warranties or representations as to the completeness or accuracy thereof. | DRE #01013938



RE/MAX of Santa Clarita - Crissman Commercial Services is proud to present the Sunset Pointe Plaza Office Building. Conveniently located just off of the 5 Freeway in Stevenson Ranch, CA. Sunset Pointe Plaza offers newly renovated office spaces in a variety of configurations. Sunset Pointe Plaza has abundant parking and is in close proximity to a wide variety of amenities. Call us to book a tour today. 661-295-9300

SUITE #	SIZE (Rentable SF)	AVAILABLE	ASKING RATE
226	2,233 SF	Within 30 Days	\$2.70/SF/FSG
305	2,684 SF	Now	\$2.70/SF/FSG





CRISSMAN
COMMERCIAL SERVICES
LAND LEASING INVESTMENT MANAGEMENT

HIGHLIGHTS

- MOVE IN INCENTIVES AVAILABLE
- NEWLY RENOVATED SUITES, RESTROOMS & COMMON AREAS
- PROFESSIONALLY MANAGED
- CLOSE PROXIMITY TO I-5 FREEWAY
- NEAR A WIDE VARIETY OF AMENITIES
- 24/7 ACCESS
- USPS BOX ON SITE
- SUITES & COMMON AREAS CLEANED DAILY
- SECURITY SYSTEM THROUGHOUT COMMON AREAS
- ABUNDANT PARKING





Suite 226: 2nd Floor
2,233 Square Feet

- Three Private Offices + Large Bullpen Area
- Private Balcony
- Extensive Window Line / Natural Light
- Open Configuration Allows for Custom Build Out

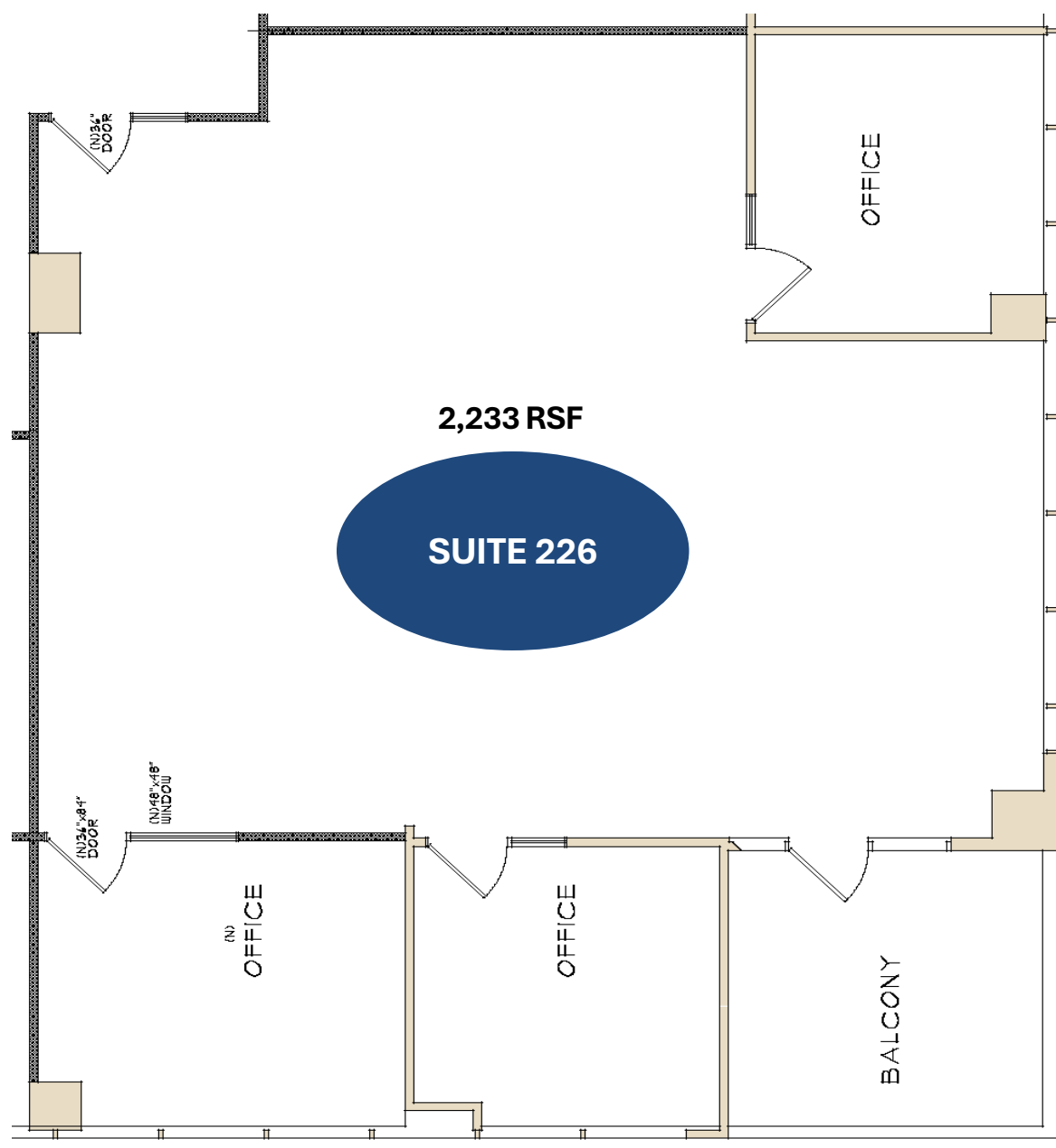



CRISSMAN
COMMERCIAL SERVICES
LAND LEASING INVESTMENT MANAGEMENT

SUITE 226



This information contained herein was obtained from sources deemed to be reliable; however Crissman Commercial Services and RE/MAX of Santa Clarita make no guarantees, warranties or representations as to the completeness or accuracy thereof. | DRE #01013938



Suite 305: 3rd Floor

2,684 Square Feet

- Four Private Offices & Large Bullpen Area
- Large Windows / Natural Light
- Copy/Break Room + Storage Closet

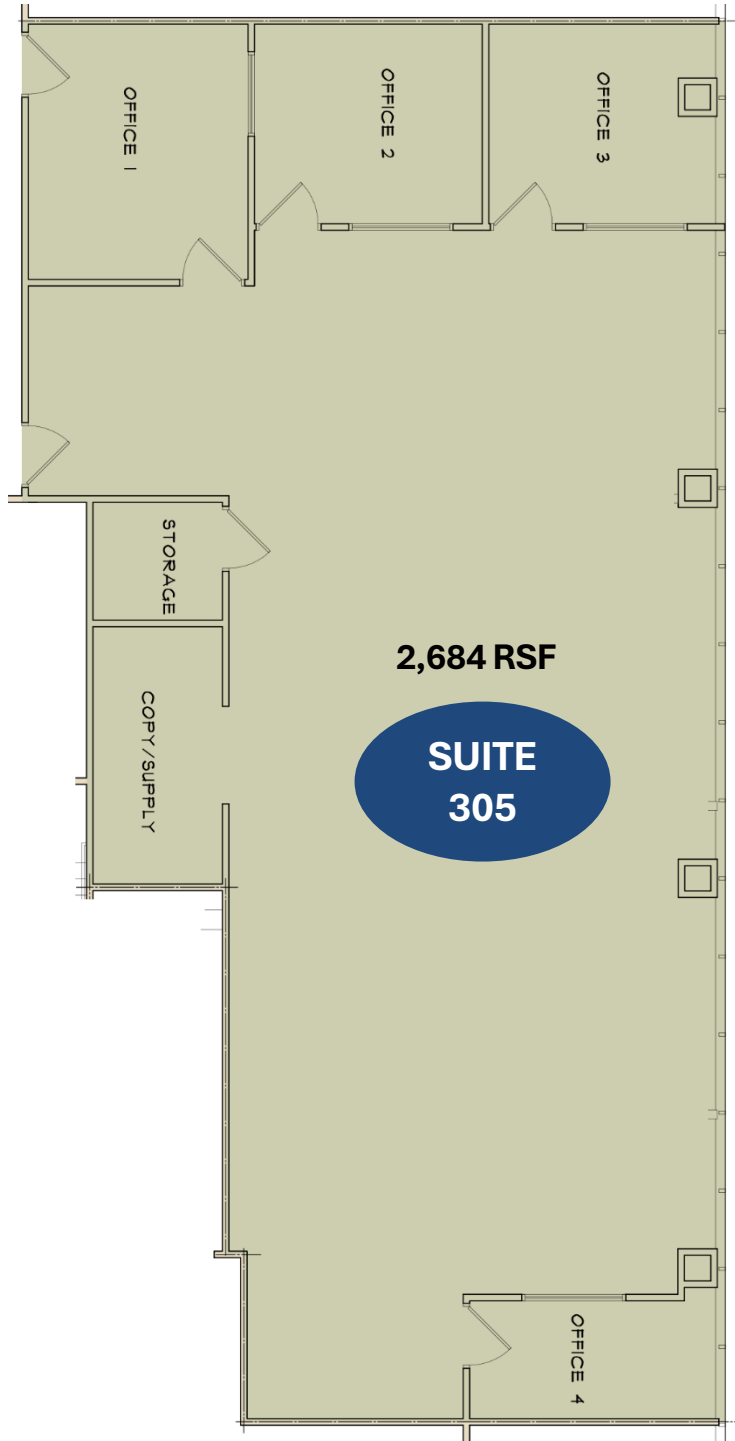



CRISSMAN
COMMERCIAL SERVICES
LAND LEASING INVESTMENT MANAGEMENT

SUITE 305



This information contained herein was obtained from sources deemed to be reliable; however Crissman Commercial Services and RE/MAX of Santa Clarita make no guarantees, warranties or representations as to the completeness or accuracy thereof. | DRE #01013938