

6776 54th AVENUE NORTH
ST PETERSBURG FL 33709



**MEDICAL OFFICE
FOR SALE OR
FOR LEASE**

**FOR SALE
\$1,300,000**

**FOR LEASE
\$18 - \$22 PSF NNN**

6776 54th Avenue North
St Petersburg FL 33709

4,972 SF
FOR LEASE

Jim Allen
Senior Vice President Leasing & Brokerage
813-629-0743
jim.allen@FlagshipHP.com
www.MedicalBroker.com

Sydney Alvarez
Associate
813-833-4199
sydney.alvarez@FlagshipHP.com



6776 54TH AVENUE NORTH
ST PETERSBURG FL 33709



©2024 The information contained herein was obtained from sources believed reliable; however, Flagship Healthcare Properties makes no guarantees, warranties, or representations as to the completeness or accuracy thereof. The presentation of this property is submitted subject to errors, omissions, changes of price or conditions prior to sale or lease, or withdrawal without notice.





4,972 SF IN 3 CONTIGUOUS

Suite A - 1,837 SF

- Class A build out
- 4 Wet exams rooms
- 2 Offices
- Waiting room
- Lab/Nurse station
- Reception/Administrative area
- Kitchen
- 2 Bathrooms
- 3 Storage closets
- Near term lease expiration

Suite B - 1,518 SF - \$22 PSF/NNN

- Class A build out / Excellent Condition
- 3-4 Wet exam rooms
- 2 Offices
- Waiting room
- Lab/Nurse station
- Reception/Administrative area
- Kitchen
- 2 Bathrooms
- Storage closet

Suite C - 1,617 SF - \$18 PSF/NNN

- 1 Large open treatment/office area
- Kitchen/lab area
- 2 bathrooms
- Landlord may provide build out allowance

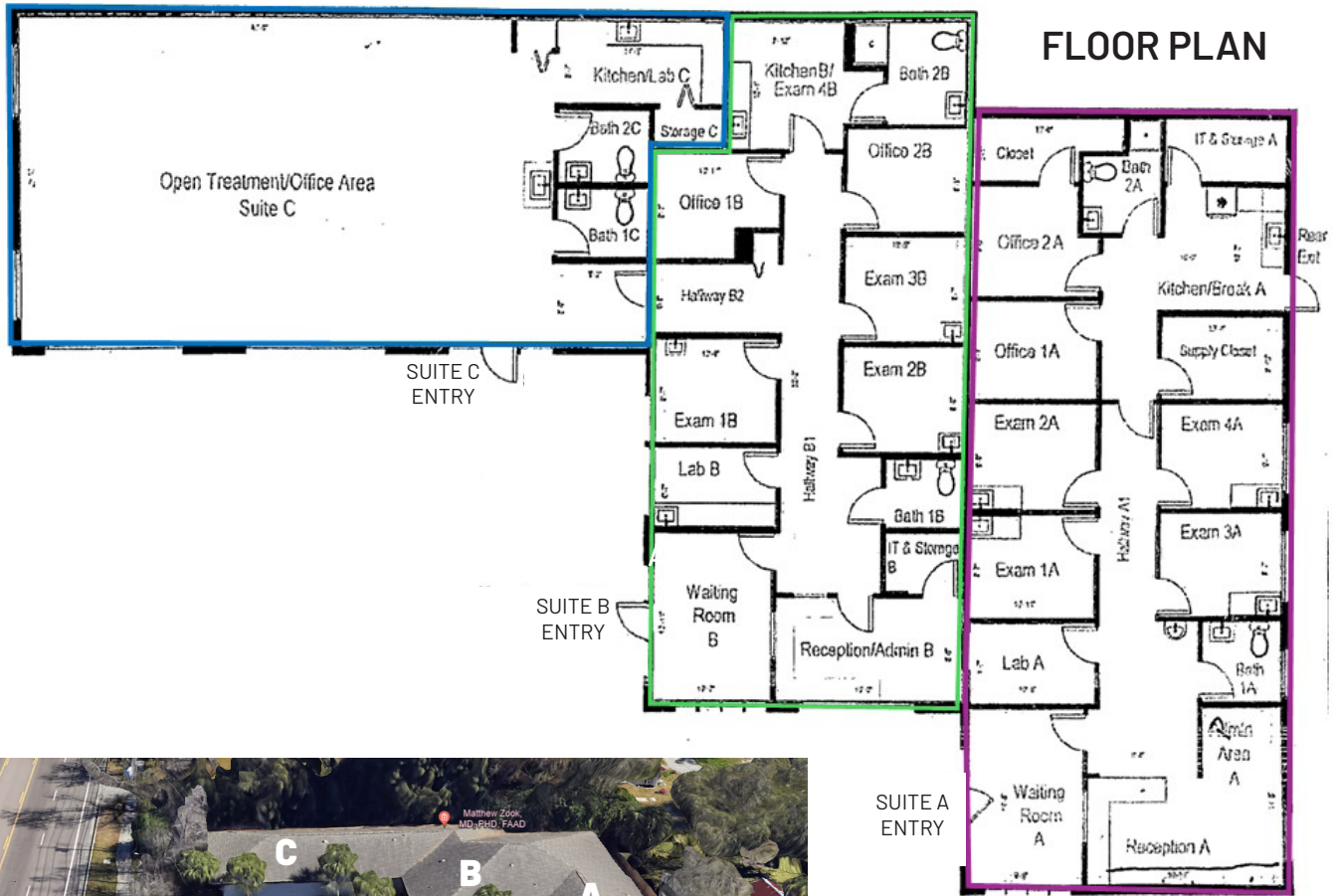

PARKING:
5 / 1,000 - Surface parking



6776 54TH AVENUE NORTH
ST PETERSBURG FL 33709

15 MINUTE DRIVE TIME MAP

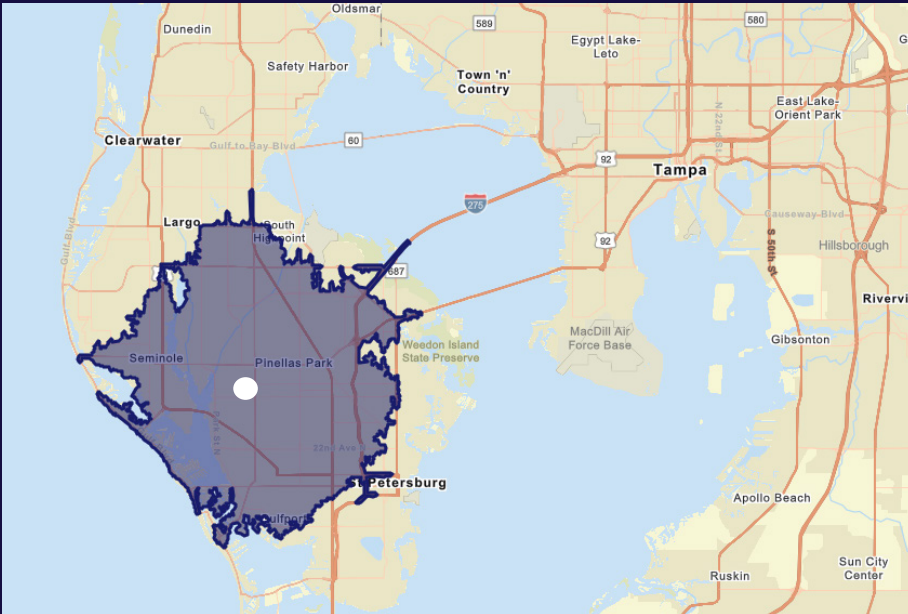

6776 54th Avenue North

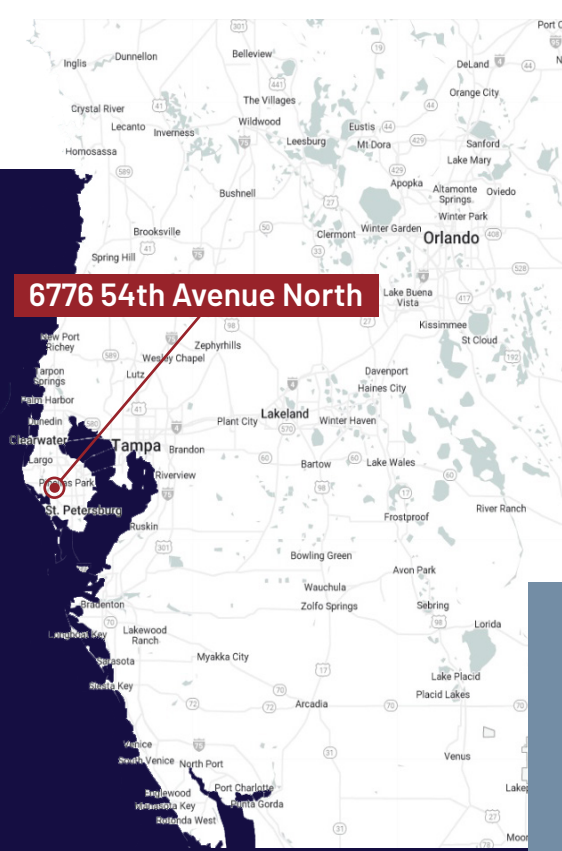

AREA DEMOGRAPHICS
15 Minute Drive Time



TOTAL POPULATION
2023 - 325,974
2028 - 323,512



TOTAL HOUSEHOLD
2023 - 148,302
2028 - 150,166



AVG HOUSEHOLD INCOME
2023 - \$88,746
2028 - \$104,143

CLINICIAN SF FOR UNDERSERVED DEMAND BY SPECIALTY*

SPECIALTY	NEED IN PROVIDERS 5 YEAR POP. GROWTH	60% OF TOTAL MARKET SHARE	SF NEEDED TO SATISFY REQUIREMENT
Pediatrics & Neonatology	66.60%	39.96	59,940 SF
Obstetrics & Gynecology	19.10%	11.46	17,190 SF
Cardiovascular	12.80%	7.68	11,520 SF
Oncology & Hematology	10.00%	6.00	9,000 SF
Radiology	9.90%	5.94	8,910 SF
Ophthalmology	5.80%	3.48	5,220 SF
Nephrology	5.40%	3.24	4,860 SF
Primary Care	2.10%	1.26	1,890 SF

10.00
Additional Demand
ONCOLOGY/HEMATOLOGY



60%
Total Market Share



1,500 SF
Avg SF Per
Physician



9,000 SF
Additional Medical
Office Needed to
Meet Demand

*Advisory Board



6776 54TH AVENUE NORTH
ST PETERSBURG FL 33709



CALL US ABOUT 6776 54TH AVENUE NORTH



Jim Allen
Senior Vice President Leasing & Brokerage
813-629-0743
jim.allen@FlagshipHP.com
www.MedicalBroker.com



Sydney Alvarez
Associate
813-833-4199
sydney.alvarez@FlagshipHP.com



FLAGSHIP

HEALTHCARE PROPERTIES

2202 N Westshore Blvd, Suite 200
Tampa FL 33607

www.FlagshipHP.com